

Handset Interface	2-2
Accessing Functions.....	2-3
Touch Panel	2-4
Using Touch Panel.....	2-4
Menu Operations.....	2-6
Main Menu.....	2-6
Using Simplified Menus (Simple Menu)	2-9
Spinguru Menu.....	2-10
Using Spinguru Menu.....	2-11
Accessing Functions.....	2-13
Shortcuts Menu & Key Shortcut	2-13
Toggling Active Functions (Multi Job)	2-14
Standby Shortcuts.....	2-15

Motion Control	2-16
Mobile Manners.....	2-18
Security Codes	2-19
Basic Tools.....	2-20
My Details & Basic Tools	2-20
Double Number.....	2-21
Using Double Number	2-21
Modes.....	2-22
Additional Functions	2-24

2

Basic Operations



Handset Interface

Handset Operations

Use handset keys, Touch Panel or Motion Control.

Handset Keys

Use Keypad, etc. with Slider open; supports all handset operations.



Vector Pad

Multi Selector touch sensor area. Adjust finger pressure to control scroll speed, or make circular motion for Spinguru Menu.



Use center area for operations; using edges may inhibit cursor movement/scroll speed.

Touch Panel

Touch menu items, Softkeys or icons with Slider open or closed.



Motion Control

Move handset (e.g., shake it left or right, turn it over, etc.) to access functions, enlarge/reduce fonts or images, navigate functions, and more. (Complete setup beforehand.)

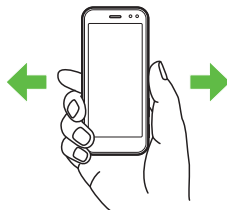

Landscape Orientation

Hold handset in landscape; press Camera Key to release shutter, or watch TV in widescreen.

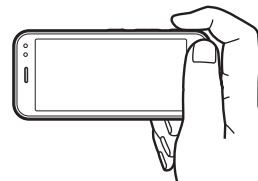

Accessing Functions

Use the following methods as needed.

Main Menu

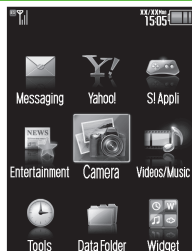

Repeat menu item selection.

Select menu items

Use shortcuts

Circle finger around Vector Pad

Spinguru Menu



Access recommended/frequently used functions or operation history, etc.

Shortcuts



Access assigned functions (changeable).

Standby Shortcuts



Save functions to Standby.

Quick Operations (Handset Keys Only)

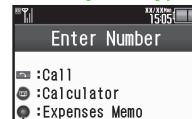

Enter numbers to access functions. To activate functions, press the corresponding key.

Access a function in Shortcuts menu while another is active, then toggle function windows as needed.



Using Touch Panel

2

Basic Operations

Touch Display to select menu items, open functions, scroll pages, etc.
Available with Slider open or closed (regardless of orientation).

Basic Operations

Tap



Tap item to open corresponding function; execute Softkey functions/operations.

Double Tap

Tap Display twice in rapid succession (within approximately 0.6 seconds).

Long Touch



Touch item for 1+ seconds to execute corresponding function/operation.

Drag



Touch Display and drag finger to move item or scribble/sketch; release finger when complete.

Swipe



Swipe a finger across Display to scroll.

Spread & Pinch

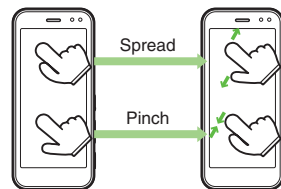

Spread or pinch your fingers across Display to enlarge or reduce images, etc.

Advanced



● Adjusting Touch vibration (P.2-24)

Operational Examples

Selection & Execution

Tap item to open or execute corresponding function/operation.

Tap **Data Folder**

The result is the same as highlighting an item with and pressing .

Two Taps

When corresponding Options menu is available, etc., tapping item may only select (highlight) it; tap the item again to execute function/operation.

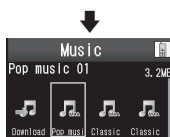
Tap **Music** twice

Music folder opens

The result is the same as highlighting an item with and pressing .

Screen Scroll

To see items outside Display area, swipe a finger across Display in opposite direction.



Swipe right



Left portion appears

Alternatively, drag finger across Display.

Enlarge & Reduce

Spread or pinch your fingers across Display to enlarge or reduce images, etc.



Enlarged

- Double-tapping images, etc. may also enlarge/reduce them.
- On Internet page or before saving captured image, Long Touch area/portion to enlarge it.

Open Menus

Tap **Options** or Long Touch Display to open menu.



Long Touch Display



Menu opens

Important Touch Panel Usage Notes

- Touch Panel may not respond in these situations:
 - Use with gloved fingers/fingernails
 - Use of pens, pencils or other sharp objects
 - Use with objects placed on/against Display
- To prevent malfunctions, do not:
 - Touch Display with wet fingers
 - Subject Display to force/pressure
 - Place labels or stickers over Display
- Calibrate Touch Panel (**P.2-8**) to improve response.



Main Menu

Opening Main Menu



■ Touch Panel

■ Handset Key

Window Description



Main Menu Items

Messaging	Open/create messages, etc.
Yahoo!	Browse the Internet
S! Appli	Use S! Applications including games
Entertainment	Receive news, play/download media files, etc.
Camera	Capture images or record video
Videos/Music	Access various media services
Tools	Manage schedules, set Alarm, scan QR Codes, etc.
Data Folder	Open files saved on handset/Memory Card
Widget	Use Mobile Widgets
TV	Watch/record TV programs
Phone	Search contacts, add entries, etc.
Settings	Customize handset interface, sounds, etc.



Follow these steps to open **World Clock** via handset keys or Touch Panel:

Menu Navigation (Handset Keys)

Press **○** in Standby

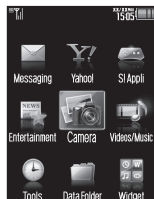

Open
Main Menu

Use **○** to
highlight **Tools**

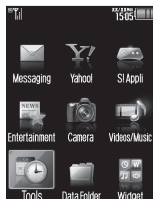

Select Item

Use **○** to highlight
Clock/Gauge tab



Open Tab

Use **○** to highlight
World Clock



Select Item



Tap **MENU** in Standby



Tap **Tools**

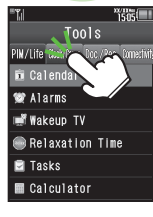

Tap **Clock/Gauge** tab



Tap **World Clock**

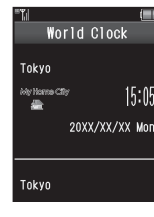

Menu Navigation (Touch Panel)

2

Basic Operations



Escape/Return (Handset Keys)

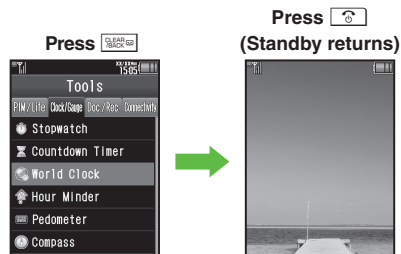

Navigate Back

Return to Standby



Escape/Return (Touch Panel)

Calibrating Touch Panel

Calibrate Touch Panel to improve response.
Hold handset normally during calibration.

1 ➔ **Settings** ➔ **Phone/** **tab**

2 **Touch Panel**

3 **Correct Touch Panel**

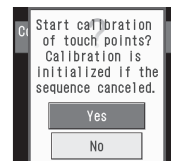

4 **Yes**
• Follow onscreen instructions.

Undo Calibration

• If calibration does not improve response,
follow these steps to restore default setting:

After 4,



Using Simplified Menus (Simple Menu)

Simple Menu Features

Activate Simple Menu to reduce available handset functions and simplify menus.

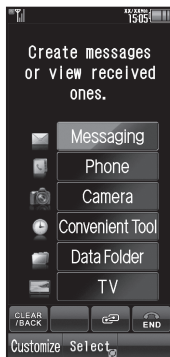

- Fonts are enlarged and appear in bold.
- Clock is enlarged (Calendar is hidden).

Menu Items

Messaging	Received Msg., Create Msg., Drafts, Templates, Sent Messages, Unsent Msg., Create SMS
Phone	Phone Book, Add New Entry, Call Log, Play Messages, Answer Phone, Call Voicemail, My Details, Speed Dial/Mail
Camera	Photo Camera, Video Camera, Album, Scan Barcode, Scan Card, Kanji Grabber, Review
Convenient Tool	Calendar, Alarms, Calculator, Assignment, Dictionary, Notepad, S! GPS Navi, Pedometer, Compass, S! Friend's Status, S! Circle Talk, Double Number, Change Menu
Data Folder	-
TV	-

Key assignments are largely the same as those in Standard Menu.

Activating Simple Menu

- MENU** ➔ **Settings** ➔ In Sound/Display menu, **Change Menu**

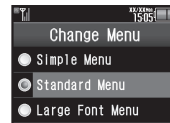

- Alternatively, Long Press

- Simple Menu**

While Using an Incompatible Function

- End the function before activating Simple Menu.

Canceling Simple Menu

- MENU** ➔ **Convenient Tool** ➔ **Change Menu** ➔ **Standard Menu**



Spinguru Menu

Basics

Circle finger around Vector Pad; keep moving finger to highlight functions suitable for time of day/situation, or frequently used/recently opened files/records, etc.

- Available in Standby and while using functions.
- Alternatively, make a circle on Standby Display to open Spinguru Menu.
- Alternatively, Long Touch  Softkey to open Spinguru Menu with Slider closed.

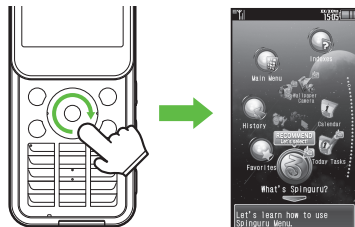

Spinguru Menu

- Spinguru Menu is available in landscape orientation as well.

Menu Description

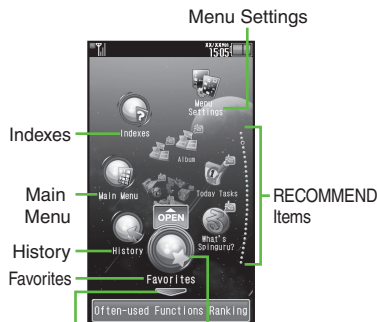

Example: Spinguru Menu opened in Standby



Lower Level/
Sub Menu
Indicator

- If Spinguru Menu is opened while using functions, corresponding menu items also appear.
- Favorites (gateway to frequently used functions) appears from the second day after the first use of handset.
- Tap **How to use** in Spinguru Menu to open operational instructions.

Menu Navigation

Tap  to access lower level/Sub Menu;
tap  to return.

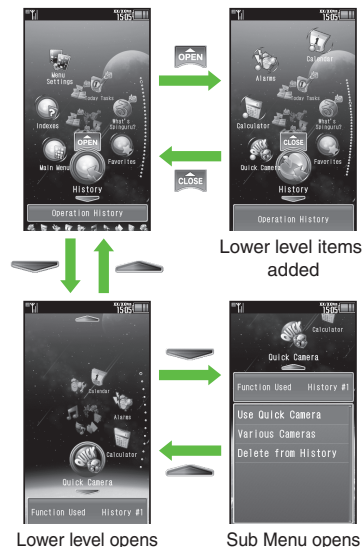

Using Spinguru Menu

Opening Functions

General Items

- 1 Circle finger on Standby Display



- Spinguru Menu opens.

- 2 Highlight item



- 3 Tap the item

- Menu/window opens.

Deleting Functions from Spinguru Menu
After ②, **Delete Convenience**
 Yes

Favorites & History

- 1 In Spinguru Menu, tap *Favorites or History*



- 2



- Lower level opens.

- 3 Highlight item

- 4 Tap the item

- Follow onscreen instructions.

Deleting Functions from Favorites or History
After ③, **Delete from Favorites**
or **Delete from History** **Yes**

Main Menu

- 1 In Spinguru Menu, tap *Main Menu*



- 2

- 3 Highlight item

- 4 Tap the item

- Follow onscreen instructions.

Advanced

- Sorting Favorites items ● Deleting all Favorites items ● Deleting all History items ● Restoring deleted general items (P.2-24)



Indexes (Japanese)

Search for functions by initial character of terms or keywords.

1 In Spinguru Menu, highlight *Indexes*



2

• Character icons appear.

3 Highlight icon ➡

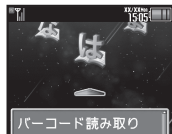

4 Tap function

• Follow onscreen instructions.

Spinguru Menu Settings

Follow these steps to reset Spinguru Menu:

1 In Spinguru Menu, highlight *Menu Settings*



2

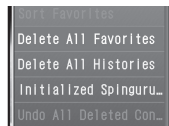

3 *Initialized Spinguru Menu*

4 *Yes*

Toggling View

Tap **SWITCH** to toggle Spinguru Menu between linear and spiral views. In linear view, tap to access lower level items/Sub Menu; tap to return.



Spinguru Menu
(linear view)

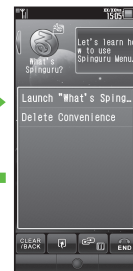

Lower level/
Sub Menu opens



Advanced

- Setting scroll speed ● Setting Spinguru Menu opening method ● Setting Spinguru Menu spin speed ● Calibrating Vector Pad (P.2-24)



Shortcuts Menu & Key Shortcut

Shortcuts Menu

Access assigned functions via Shortcuts menu.

1 Long Touch

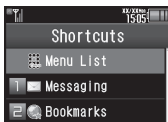

Shortcuts Menu

2 Select function

- Menu/window opens.



Changing Default Shortcuts







- In ❷, highlight numbered function
 ➔ **Options** ➔ **Assign Function** ➔
 Select menu item ➔ Select new item
- To assign menu items, highlight one and tap **Assign**.

Assigning Files & Folders

- In ❷, highlight numbered function
 ➔ **Options** ➔ **Assign Data** ➔ **Select file/folder**
- For folders, tap **Set this folder**.

Key Shortcut

In Standby, Long Press ,  or  to access assigned functions.

	Open S! Mail Composition window
	Open PC Site Browser menu
	Create new Phone Book entries
	Activate/cancel Bluetooth®
	Activate/cancel Infrared
	Activate Familink Remote

Changing Assigned Functions

Follow these steps to assign Calculator to  (Long Press):

1 MENU ➔ Settings ➔ Phone/ tab

2 Set Key Shortcut



Key Shortcut Menu

3 Long press

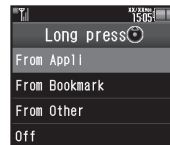

4 From Appli

5 Tools ➔ In PIM/Life menu, Calculator

Bookmark

- In ❷, **From Bookmark** ➔ Select title
 ➔ **Yes**

Infrared, Show Secret Data, Etc. On/Off

- In ❷, **From Other** ➔ Select item

Canceling Assigned Function

- In ❷, **Off**

Advanced

-  ● Changing item order ● Restoring default shortcuts (P.2-4)



Toggling Active Functions (Multi Job)

Multi Job Feature

Access a function in Shortcuts menu while another is active.

While browsing the Internet

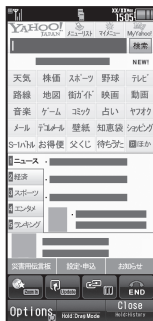

①

Open Calendar

②

Toggle windows





Check schedules

- Multi Job may not activate from some menus/windows (e.g., ringtone/ringvideo selection, etc.).
- Multi Job is disabled while  (gold) appears.

Using Multi Job

①

In a function window, .
In text entry windows, Long Touch .

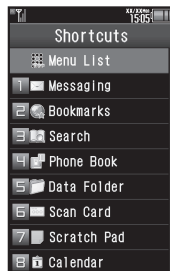

②

Select function



- Menu/window opens.

③

To toggle active windows, 



④

END → Multi Job ends

- If a confirmation appears, follow onscreen prompts.



Standby Shortcuts

Paste shortcuts to functions, files, folders, etc. to Standby for easy access.

Saving Shortcuts to Standby

If **OPEN** does not appear, tap **Widget On**.

1 OPEN

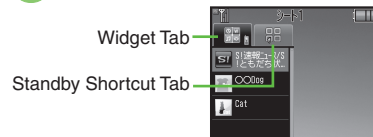

2 tab



3 Drag item to Standby

- Corresponding icon appears in Standby.
- >> appears when more items are available.

4 CLOSE

Saving from Menu/Window

- In Options menu, tap **Set as StbyShortcut** (may not appear for some items); select sheet as needed.

Using Handset Keys

Use to select **OPEN** ➔

Select item ➔ Specify target location ➔ Assign

- After pressing , Long Press to activate pointer navigation; select widgets, etc. (To cancel pointer navigation, Long Press.)

Using Shortcuts

If no icon appears, tap **Widget On**.

1 Select icon

- Menu/window opens or command is executed.

Using Handset Keys

Use to highlight icon ➔

Toggle Sheets

Toggle sheets to use Standby Shortcuts and widgets pasted on each sheet. If no icon appears, tap **Widget On**.

1 Swipe finger left or right across Display

- Sheet name appears at the top, then disappears.
- Save Standby Shortcuts as needed; corresponding icons appear on the current sheet.

Using Locked Sheets

Enter Handset Code ➔ OK

Using Handset Keys

(press to toggle sheets)

Removing Shortcuts from Standby

1 Long Touch icon

2 Remove

3 Yes

Advanced

- Sorting icons
- Moving icons
- Moving icons to front/back
- Removing icons at once
- Editing sheet names
- Locking sheets (P.2-24 - 2-25)



Motion Control

Motion Sensor tracks handset orientation or movement. Move handset to navigate pages, access functions, etc.

- Cancel Keypad Lock and activate Display first. (Not necessary for activating Quick Silent.)
- Adjust Motion Sensor (**P.2-25**) before using Motion Control for the first time.
- Activate Motion Control by function beforehand.

Turn Over

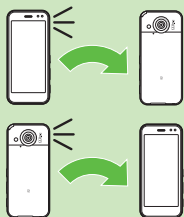

Activate Quick Silent

Turn handset over to instantly mute ringer and stop vibration.

Ringer

Incoming Calls,
Alarms, etc.

Vibration

Incoming Calls,
Alarms, etc.

- Some tones may not be silenced.

Open Quick Shortcut

Shake handset left and right approximately three times in Standby to access assigned functions.

- Change assigned functions as needed.

Re-search Signal

Portrait Orientation
Landscape Orientation

Shake Left/Right

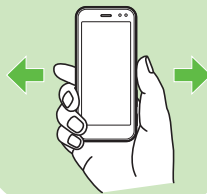

Navigate Functions

Shake to the left to navigate back, or right to navigate forward.

Music

Music Player

Channels

Digital TV

Images

Data Folder
(Pictures)

Pages

Document
Viewer

Multi Job

Shake to the left or right to toggle active windows.

Toggle Windows

Multi Job



Shake Forward or Backward

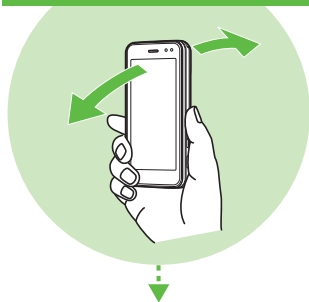

Zoom In/Zoom Out

Shake forward to enlarge, or backward to reduce.

Fonts

Yahoo! Keitai
Message Window

Zoom Image

Data Folder
(Pictures)

Zoom Page

PC Site Browser
Direct Browser
Document Viewer

Toggling Motion Control On/Off

1 **MENU** ➔ **Settings** ➔
Phone/ **tab**

2 **Motion Control**

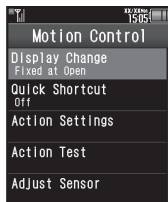

Motion Control Menu

3 **Action Settings**

4 **Select function**

5 **On or Off**

Enabling Quick Shortcut

1 **In Motion Control menu,**
Quick Shortcut

2 **Switch On/Off**

3 **On**

Activating Show Secret Data Temporarily

Enter Handset Code ➔ Shake handset left or right ➔ OK

- Use Keypad to enter Handset Code.
- Show Secret Data is canceled when Display goes dark in Standby.

Important Motion Control Usage Notes

- Hold/shake handset correctly to avoid unintended results.
- Motion Control may be unavailable while handset is ringing/vibrating.
- Confirm there is ample space for Motion Control use; hold handset firmly and shake it gently to avoid injury/breakage. Do not shake handset roughly; handset may slip, resulting in injury or damage.

2

Basic Operations

Advanced

- Setting Display rotation method
- Changing Quick Shortcut items
- Deleting Quick Shortcut items
- Restoring default Quick Shortcut items
- Practicing Motion Control actions
- Adjusting Motion Sensor (P.2-25)



Mobile Manners

Please use your handset responsibly. Use these basic tips as a guide. Inappropriate handset use can be both dangerous and bothersome. Please take care not to disturb others when using your handset. Adjust handset use according to your surroundings.

- Power it off in theaters, museums and other places where silence is the norm.
- Refrain from using it in restaurants, hotel lobbies, elevators, etc.
- Observe signs and instructions regarding handset use aboard trains, buses, etc.
- Refrain from use that interrupts the flow of pedestrian or vehicle traffic.

Manner Mode

Mutes most handset function sounds.

1 (Long)

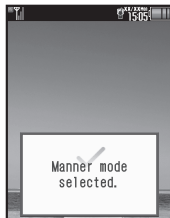

- Manner mode is set.

When Manner Mode is Active

- Ringtones and other sounds are muted.
- 941SH vibrates for transmissions/alerts.
- Shutter click still sounds at fixed volume.
- To unmute Speaker temporarily while playing music, etc., follow these steps:

During playback,  ➔ OK ➔ Yes or No

Canceling Manner Mode

 (Long)

Offline Mode

Temporarily suspends all transmissions.

1 **MENU** ➔ **Settings** ➔ **Network tab**

2 **Offline Mode**

3 **On**

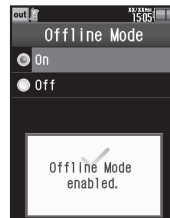

- Offline Mode is set.

Canceling Offline Mode
In , **Off**

Advanced

-  ● Changing handset modes ● Creating a custom mode ● Resetting Mode Settings (P.2-26)



Security Codes

These codes are required for handset use.

- Write down Security Codes.
- Do not reveal Security Codes. SoftBank Mobile is not liable for misuse or damages.

Handset Code	9999 by default; use or change some functions
Administrator Code	9999 by default; required for Reset Settings, Reset All, Direct Browser Lock, Proxy Setting, etc.
Center Access Code	4-digit code selected at contract; access Optional Services via landlines or change contract details
Network Password*	4-digit code selected at contract; restrict incoming/outgoing calls (Call Barring)

*Change as needed.

Incorrect Code Entry

- Message appears for incorrect code entries; retry.
- If Network Password is incorrectly entered three times consecutively, Call Barring settings are locked. To resolve, Network Password and Center Access Code must be changed.

Changing Security Codes

Enter four to eight digits.

Changing Handset Code

- 1** **MENU** ➔ **Settings** ➔ **Phone/**  **tab**
- 2** **Locks**

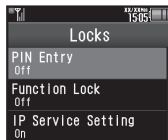

Locks Menu

- 3** **Chg. Handset Code**

- 4** **Enter current Handset Code** ➔ **OK**

- 5** **Enter new Handset Code** ➔ **OK**

- 6** **Re-enter new Handset Code** ➔ **OK**
 - To change Administrator Code subsequently, tap **Yes**.

Changing Administrator Code

- 1** In **Locks** menu, **Administrator Setting**
- 2** **Change Administrator Code**
- 3** **Enter current Administrator Code** ➔ **OK**
- 4** **Enter new Administrator Code** ➔ **OK**
- 5** **Re-enter new Administrator Code** ➔ **OK**



My Details & Basic Tools

My Number

1 MENU ➔ Phone ➔ My Details



- Alternatively, press ➔ 0 .
- Handset phone number and the name entered at initial setup appear.

Editing My Details

After 1, highlight tab ➔ Highlight item
➔ Edit ➔ Select item ➔ Edit ➔ Save

VeilView

Activate VeilView to prevent peeking.

1 (Long)

Canceling VeilView

(Long)

Pen Light

1 (Long)

- Mobile Light illuminates.

2 Side Key ➔ Mobile Light goes out

Important Pen Light Usage Note

- Do not point Pen Light at people or look at it directly.

Battery Meter

1 MENU ➔ Tools ➔ Clock/Gauge tab

2 Battery Meter

- Approximate battery strength appears.

Battery Strength %

- 100% may not appear even when battery is full. This is by design; not a malfunction.

Phone Help

1 MENU ➔ Tools ➔ Doc./Rec. tab

2 Phone Help

3 Select item

- For *Indicators*, tap a category.

Advanced

- Clearing My Details ● Selecting My Details items to send ● Toggling My Details in Dual Mode ● Setting battery strength indicator pattern
- Changing VeilView pattern/density (P.2-26)



Using Double Number

Manage two accounts (Line A and Line B, with separate phone numbers and mail addresses) on one handset.

- Double Number requires a separate contract and basic monthly fee.
- Outside Japan, any Line B messaging charges are applied to Line A.
- For more information, contact SoftBank Mobile Customer Center, General Information (P.17-42).

Two Phone Numbers & Two Mail Addresses

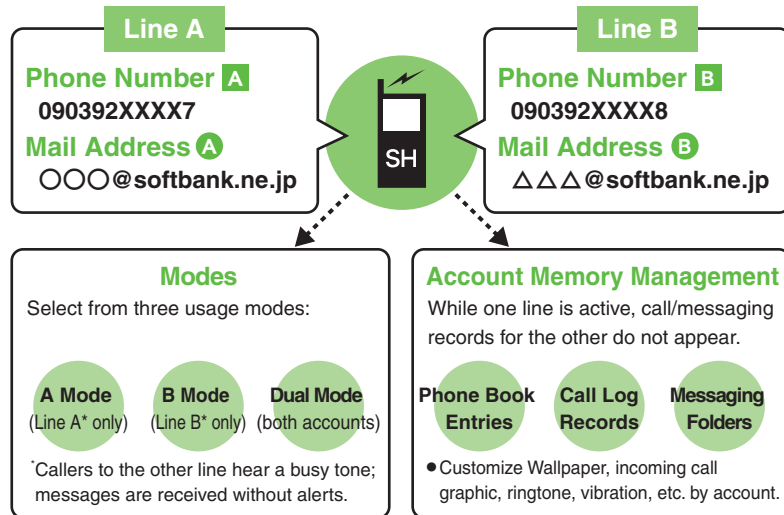

Activating Double Number

Make sure signal is stable.

- 1 **MENU** ➔ **Settings** ➔ **Phone/** **tab**
- 2 **Double Number**
- 3 **Switch On/Off**
- 4 **On**
- 5 **Enter Handset Code** ➔ **OK** ➔ **Yes**

Canceling Double Number

In 4, **Off** ➔ 5

- When Double Number is canceled:
 - Line B calls and SMS messages are redirected to Line A Phone Number.
 - Initial portion of Line B S! Mail is redirected to Line A. (Full messages are irretrievable.)
 - Double Number account is not affected.



Modes

Activate **A Mode** to use Line A only, **B Mode** to use Line B only, or **Dual Mode** to use both accounts.

A Mode

Receive Calls to Line A Only

- Place calls or send messages via Line A.

A Mode & B Mode Precautions

- Line indicators do not appear in Phone Book entries, message lists, Call Log records, etc.
- When an operation affects information on the other line, a confirmation appears. Follow onscreen prompt(s).

B Mode

Receive Calls to Line B Only

- Place calls or send messages via Line B.

B Mode Restrictions

- Handset connects to the Internet via Line A. (During Internet connections, place/receive calls via Line B.)
- S! Friend's Status, S! Circle Talk and Decoration Call are unavailable.

Advanced

- Omitting Handset Code entry when switching modes
- Renaming Double Number modes
- Showing indicator for calls missed or new mail on idle line
- Hiding Internet connection confirmation (P.2-27)



Dual Mode

Receive Calls to Both Accounts

- Place calls or send messages via Line A (or the account of record for Phone Book entries or Call Log records) by default; toggle accounts as required.

Phone Book Entries

Specify A, B or Dual.

Messaging

Select Line A or Line B.
Sender Address changes accordingly.

Calling

Select Line A or Line B.
Caller ID changes accordingly.

- Line type indicators appear in Phone Book entries, message lists, Call Log records, etc.

Switching Modes

- MENU** ➔ **Settings** ➔ **Phone/**  **tab** ➔ **Double Number**
- Double Mode**
- Select mode**
 - For **B Mode**, a confirmation appears.
- Enter Handset Code** ➔ **OK**
- Yes**

In Dual Mode

During an operation, if prompt window below appears, select a line.



If customizable by line, line indicator appears bottom right; tap indicator to switch.



If line selection is otherwise required, follow onscreen prompts.

Advanced





- Switching modes with handset keys
- Rejecting calls to either line in Dual Mode
- Setting main line for Dual Mode (P.2-27)





Touch Panel



Adjusting Touch vibration	<small>[Start Here]</small> MENU ➤ Settings ➤ Phone/  tab ➤ Touch Panel ➤ Touch Reaction ➤ See below
	Touch Vibration Off in Manner Mode On(Except Manner Mode)
	Touch Vibration Always Off Off

Spinguru Menu

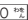
Sorting Favorites items	Open Spinguru Menu ➤ Highlight Menu Settings ➤  ➤ Sort Favorites ➤ Yes
Deleting all Favorites items	Open Spinguru Menu ➤ Highlight Menu Settings ➤  ➤ Delete All Favorites ➤ Yes
Deleting all History items	Open Spinguru Menu ➤ Highlight Menu Settings ➤  ➤ Delete All Histories ➤ Yes
Restoring deleted general items	<small>[Start Here]</small> Open Spinguru Menu ➤ Highlight Menu Settings ➤  ➤ See below
	All Items
	Undo All Deleted Convenience ➤ Yes
	One Item
	Select Undo XX ➤ Yes
Setting scroll speed	MENU ➤ Settings ➤ Phone/  tab ➤ Vector Pad Settings ➤ Scroll Speed ➤ Select speed





Setting Spinguru Menu opening method	MENU ➤ Settings ➤ Phone/  tab ➤ Vector Pad Settings ➤ Launch Spinguru Menu by ➤ Select method
Setting Spinguru Menu spin speed	MENU ➤ Settings ➤ Phone/  tab ➤ Vector Pad Settings ➤ Jog Speed ➤ Select speed
Calibrating Vector Pad	MENU ➤ Settings ➤ Phone/  tab ➤ Vector Pad Settings ➤ Correct Vector Pad ➤  (Long)

Shortcuts

Changing item order	Long Touch  ➤ Highlight numbered function ➤ Options ➤ Move ➤ Select target location
Restoring default shortcuts	Long Touch  ➤ Highlight numbered function ➤ Options ➤ Set to Default ➤ Yes

Standby Shortcut



Operations in Standby

Sorting icons	 ➤ Options ➤ Sort Icon ➤ Select option • Widgets may also be sorted depending on the size.
Moving icons	 ➤ Options ➤ Move Mode ➤ Drag icon ➤ Confirm
Moving icons to front/back	 ➤  ➤ Highlight icon ➤ Options ➤ Operation ➤ To Front or To Back









Removing icons at once	Start Here  ➔ <i>Options ➔ Operate from List ➔ Remove ➔ See below</i>
	All Icons <i>Remove All ➔ Shortcut tab ➔ Highlight sheet ➔ Remove ➔ Yes</i>
	Selected Icons <i>Select & Remove ➔ Shortcut tab ➔ Select icon (✓) ➔ Complete selection ➔ Remove ➔ Yes</i>

Sheets

Editing sheet names	Start Here  ➔ <i>Options ➔ Settings ➔ Sheet Settings ➔ Change Sheet Name ➔ See below</i>
	Renaming <i>Select sheet ➔ Enter name ➔ Done</i>
	Resetting All Sheet Names <i>Reset ➔ Yes</i>
Locking sheets	Start Here  ➔ <i>Options ➔ Settings ➔ Sheet Settings ➔ Set Sheet Lock ➔ Enter Handset Code ➔ OK ➔ See below</i>
	Activating Lock <i>Select sheet ➔ On</i>
	Changing Method for Temporary Access <i>Unlock Method ➔ No Password</i> • Tap  to unlock sheet temporarily.

Motion Control

Setting Display rotation method	<i>MENU ➔ Settings ➔ Phone/ tab ➔ Motion Control ➔ Display Change ➔ Select method</i>
Changing Quick Shortcut items	<i>MENU ➔ Settings ➔ Phone/ tab ➔ Motion Control ➔ Quick Shortcut ➔ Shortcut Entry ➔ Portrait or Landscape ➔ Select menu item ➔ Select new item</i> • To assign menu items, highlight one and tap <i>Assign</i> .
Deleting Quick Shortcut items	<i>MENU ➔ Settings ➔ Phone/ tab ➔ Motion Control ➔ Quick Shortcut ➔ Shortcut Entry ➔ Highlight Portrait or Landscape ➔ Options ➔ Delete ➔ Yes</i>
Restoring default Quick Shortcut items	<i>MENU ➔ Settings ➔ Phone/ tab ➔ Motion Control ➔ Quick Shortcut ➔ Shortcut Entry ➔ Options ➔ Reset Settings ➔ Enter Handset Code ➔ OK ➔ Yes</i>
Practicing Motion Control actions	<i>MENU ➔ Settings ➔ Phone/ tab ➔ Motion Control ➔ Action Test ➔ Select item</i> • Follow onscreen instructions.
Adjusting Motion Sensor	<i>MENU ➔ Settings ➔ Phone/ tab ➔ Motion Control ➔ Adjust Sensor</i> • Follow onscreen instructions. • Avoid adjusting Motion Sensor near metal/magnetic objects or aboard trains or in vehicles.



Mode Settings

Changing handset modes	Start Here <i>MENU</i> ➤ <i>Settings</i> ➤ In Sound/Display menu, <i>Mode Settings</i> ➤ See below
	Selecting a Handset Mode Select mode
	Customizing Handset Modes Highlight mode ➤ <i>Edit</i> ➤ Select item ➤ Adjust settings • Not available for Normal mode.
Creating a custom mode	<i>MENU</i> ➤ <i>Settings</i> ➤ In Sound/Display menu, <i>Mode Settings</i> ➤ <i>Original</i> ➤ <i>Edit</i> ➤ Select item ➤ Adjust settings
Resetting Mode Settings	<i>MENU</i> ➤ <i>Settings</i> ➤ In Sound/Display menu, <i>Mode Settings</i> ➤ Highlight mode ➤ <i>Reset</i> ➤ Enter Handset Code ➤ <i>OK</i> ➤ <i>Yes</i>

My Details

Clearing My Details	<i>MENU</i> ➤ <i>Phone</i> ➤ <i>My Details</i> ➤ <i>Options</i> ➤ <i>Reset My Details</i> ➤ <i>Yes</i>
Selecting My Details items to send	<i>MENU</i> ➤ <i>Phone</i> ➤ <i>My Details</i> ➤ <i>Options</i> ➤ <i>Set Send Items</i> ➤ Select item (<input type="checkbox"/> / <input checked="" type="checkbox"/>) ➤ Complete selection ➤ <i>Confirm</i>
Toggling My Details in Dual Mode	<i>MENU</i> ➤ <i>Phone</i> ➤ <i>My Details</i> ➤ <i>Options</i> ➤ <i>Switch to B</i> or <i>Switch to A</i>

Battery Meter

Setting battery strength indicator pattern	<i>MENU</i> ➤ <i>Settings</i> ➤ In Sound/Display menu, <i>Display</i> ➤ <i>Mini Battery</i> ➤ Select pattern • Battery strength (appears as a percentage) is for reference only.
--	---



VeilView

Changing VeilView pattern/density	Start Here <i>MENU</i> ➤ <i>Settings</i> ➤ In Sound/Display menu, <i>Display</i> ➤ <i>VeilView</i> ➤ See below
	Pattern <i>Pattern Setting</i> ➤ Select pattern
	Pattern Scale <i>Scale Setting</i> ➤ Select scale or <i>Animation</i>
	Pattern Color <i>Color Setting</i> ➤ Select color
	Density <i>Density Setting</i> ➤ Adjust density ➤ <i>OK</i> • For <i>Density:2</i> or <i>Density:3</i> , adjust the pattern appearance for straight view.





Double Number



■ All Modes

Switching modes with handset keys	 (Long) ➤ Enter Handset Code ➤ OK ➤ Select mode ➤ Yes • For B Mode , a confirmation appears.
Omitting Handset Code entry when switching modes	MENU ➤ Settings ➤ Phone/  tab ➤ Double Number ➤ Password Entry ➤ Off ➤ Enter Handset Code ➤ OK
Renaming Double Number modes	MENU ➤ Settings ➤ Phone/  tab ➤ Double Number ➤ Mode Name ➤ Select mode ➤ Enter name ➤ Done ➤ Select icon

■ A Mode & B Mode

Showing indicator for calls missed or new mail on idle line	MENU ➤ Settings ➤ Phone/  tab ➤ Double Number ➤ Show Missed ➤ On
Hiding Internet connection confirmation	MENU ➤ Settings ➤ Phone/  tab ➤ Double Number ➤ Packet Warning ➤ Off • Available for B Mode.

■ Dual Mode

Rejecting calls to either line in Dual Mode	MENU ➤ Settings ➤ Phone/  tab ➤ Double Number ➤ Reject By Line ➤ Select line ➤ On
Setting main line for Dual Mode	MENU ➤ Settings ➤ Phone/  tab ➤ Double Number ➤ Send Priority ➤ Select option

