

S! Appli	10-2
Using S! Applications.....	10-2
Mobile Widget.....	10-3
Customizing Standby Display (Japanese).....	10-3

Additional Functions	10-6
Troubleshooting.....	10-10

10

S! Applications & Widgets



Using S! Applications

Try out the preloaded S! Applications or download and use 940SH-compatible S! Applications, including games.

- Refer to the S! Application's help menu or the source Internet site, etc. for operational instructions.
- Subscription to Keitai Wi-Fi is required to use S! Applications over Wi-Fi.

Remote Control (Famalink Remote)

- Use **ファミリンクリモコン for AQUOS S!** Application (Japanese) to control a TV, VCR, etc. via infrared.

- 1 ➔ **S! Appli** ➔
- 2 **S! Appli Library** ➔



S! Appli Library

- 3 **Select application** ➔

Network S! Applications

- A message appears indicating that Internet connection is required. Follow onscreen instructions.

Incoming Calls

- Incoming calls automatically pause S! Application.

Opening S! Appli Notification History

In , **Notification History** ➔

Exiting S! Applications

- 1

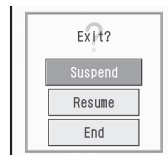

- 2 **End** ➔

Pausing S! Applications

In , **Suspend** ➔

Resuming S! Applications

➔ **Resume** ➔

- Select **Cancel** to open Main Menu and keep the S! Application paused. (Additional function activation may be disabled depending on the S! Application.)
- Select **End** to exit the S! Application.

Advanced

- Downloading S! Applications ● Adjusting S! Application sound volume ● Canceling surround effect ● Setting handset responses to incoming transmissions ● Setting S! Application to activate in Standby ● Setting Permissions ● Opening properties ● Moving S! Applications to Memory Card ● Changing S! Application settings ● Deleting S! Applications ● Restoring default S! Application settings ● Restoring default S! Appli Library ● Synchronizing Memory Card S! Applications with 940SH ● Opening Java™ license information (P.10-6 - 10-7)



Customizing Standby Display (Japanese)

Paste various widgets (applications) to Standby to access/activate information/functions immediately from Standby.

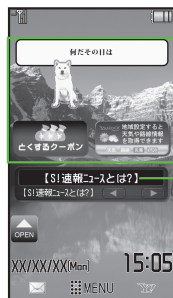

Widgets

S! Quick News &
S! Friend's Status Widget

Obtaining Widgets

1 ➡ **Widget** ➡



Mobile Widget Menu

2 **Widget Store** ➡

- Follow onscreen instructions.

Installing Widgets

- Some widgets may need to be installed manually; follow these steps:

[Mobile Widget Menu] **Widget Contents** ➡ ➡ **Select widget** ➡ ➡ **Install** ➡ ➡ **Yes** ➡

Activating Single Widgets

[Mobile Widget Menu] **Widget Contents** ➡ ➡ **Select widget** ➡ ➡

Deleting Widgets

1 In Mobile Widget menu, **Widget Contents** ➡

2 **Select widget** ➡

- S!速報ニュース/S!ともだち状況 cannot be deleted.

3 **Delete** ➡ ➡ **Yes** ➡

Deleting All Widgets

In 2, S!速報ニュース/S!ともだち状況 ➡

➡ **Delete All** ➡ ➡ **Enter**

Handset Code ➡ ➡ **Yes** ➡

- If there is a widget saved in Standby, a confirmation appears; follow onscreen prompt.

Advanced

- Opening properties
- Opening widget notification history
- Canceling automatic updates
- Receiving updates automatically while outside Japan
- Hiding confirmation outside Japan
- Disabling widget notifications
- Disabling cookies
- Deleting cookies (P.10-8)



Saving Widgets to Standby

- 1
- 2 Use to select (OPEN)

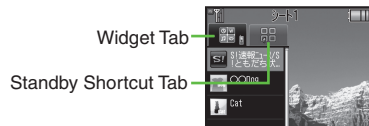

- 3 Select widget
- 4 Use to specify target location

Using Pointer

- After 1, Long Press to activate pointer navigation; select widgets, etc.
- To cancel pointer navigation, Long Press .

Using Widgets

- 1 Use to select widget

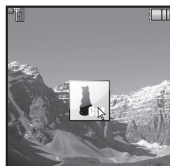

- 2
- Widget activates; follow onscreen instructions.

Using Sheets

Paste widgets and Standby Shortcuts on each sheet; toggle sheets to use them.

Toggling Sheets

- 1



- To toggle further, press or .
- Sheet name appears at the top, then disappears.
- Save widgets as needed; corresponding icons appear on the current sheet.

Advanced

- Logging in to Yahoo! JAPAN
- Moving widgets
- Slowing pointer speed
- Editing sheet names
- Locking sheets (And more on P.10-8 - 10-9)



Saving Widgets on Other Sheets

- 1 In Mobile Widget menu, **Widget Contents** ➡
- 2 Select widget ➡
- 3 Set as SthbyShortcut ➡



- 4 Select sheet ➡



- 5 Specify target location ➡

Advanced

- Removing widgets at once by sheet
- Adding news items
- Changing news scroll speed
- Showing unread news only
- Assigning members
- Managing members (P.10-9)

Removing Widgets from Standby

- 1 ➡ Use to select widget ➡
- 2 Operation ➡

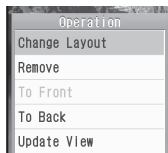

- 3 Remove ➡
- 4 Yes ➡

Using S! Quick News & S! Friend's Status Widget

940SH is preloaded with *S!速報ニュース/S!ともだち状況* (S! Quick News & S! Friend's Status widget) that shows S! Quick News and S! Friend's Status information in Standby.

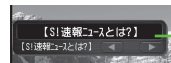

S! Quick News & S! Friend's Status Widget

View Settings

Setting View Pattern

- 1 ➡ Use to select S! Quick News & S! Friend's Status widget ➡
- 2 Settings ➡ ➡ Pattern Setting ➡
- 3 Select item ➡ (☒) ➡

Switching View

- 1 ➡ Use to select S! Quick News & S! Friend's Status widget ➡
 - 2 Operation ➡ ➡ Switch Pattern ➡
- Repeat the above steps to switch the view.



S! Applications

Downloading S! Applications	<p>● ➔ S! Appli ➔ ● ➔ S! Appli Library ➔ ● ➔ Download S! Appli ➔ ●</p> <ul style="list-style-type: none"> Follow onscreen instructions.
Adjusting S! Application sound volume	<p>● ➔ S! Appli ➔ ● ➔ Settings ➔ ● ➔ Application Volume ➔ ● ➔ Adjust level ➔ ●</p>
Canceling surround effect	<p>● ➔ S! Appli ➔ ● ➔ Settings ➔ ● ➔ Surround ➔ ● ➔ Off ➔ ●</p>
Setting handset responses to incoming transmissions	<p>Start Here ● ➔ S! Appli ➔ ● ➔ Settings ➔ ● ➔ Calls & Alarms ➔ ● ➔ See below</p>
	<p>Showing Calls Select item ➔ ● ➔ Show Call Notice ➔ ●</p>
	<p>Pausing S! Application for Incoming Mail Incoming Message ➔ ● ➔ Message Priority ➔ ●</p>
	<p>Showing Alarm Notice Alarm ➔ ● ➔ Alarm Notice ➔ ●</p>
	<p>Showing Incoming S! Appli Request Notice Notification ➔ ● ➔ Start Notice ➔ ●</p>

Setting S! Application to activate in Standby

Start Here ● ➔ S! Appli ➔ ● ➔ See below
<p>Activating Screensaver Settings ➔ ● ➔ Screensaver ➔ ● ➔ Switch On/Off ➔ ● ➔ On ➔ ●</p>
<p>Setting Screensaver S! Appli Library ➔ ● ➔ Select application ➔ ● ➔ As Screensaver ➔ ●</p> <ul style="list-style-type: none"> As Screensaver appears for compatible S! Applications. Screensaver may not start or operate correctly when an external device (Headphones, etc.) is connected to handset.
<p>Changing Screensaver Activation Time Settings ➔ ● ➔ Screensaver ➔ ● ➔ Activation Time ➔ ● ➔ Enter time ➔ ●</p>
<p>Disabling Automatic Screensaver Restart Settings ➔ ● ➔ Screensaver ➔ ● ➔ Stop Auto Start ➔ ● ➔ On ➔ ●</p>

Setting Permissions

Start Here ● ➔ S! Appli ➔ ● ➔ S! Appli Library ➔ ● ➔ Select application ➔ ● ➔ Permission ➔ ● ➔ See below
<p>Customizing Permissions for S! Appli Operations Select item ➔ ● ➔ Select option ➔ ●</p>
<p>Resetting Permission Settings Reset Settings ➔ ● ➔ Yes ➔ ●</p>

Opening properties

● ➔ S! Appli ➔ ● ➔ S! Appli Library ➔ ● ➔ Select application ➔ ● ➔ Details ➔ ●



Moving S! Applications to Memory Card	<p>● ➔ S! Appli ➔ ● ➔ S! Appli Library ➔ ● ➔ (Y) ➔ Select application ➔ ● (□/✓) ➔ Complete selection ➔ (☺) ➔ Move to Card ➔ ●</p> <ul style="list-style-type: none"> When an older version of the S! Application is saved, choose Yes or No and press ●. Repeat application selection step as needed before pressing (☺). Some S! Applications may not be moved to Memory Card.
Changing S! Application settings	<p>Start Here (●) ➔ S! Appli ➔ ● ➔ Settings ➔ ● ➔ See below</p> <p>Activating Notification Setting Notification Setting ➔ ● ➔ On ➔ ●</p> <p>Setting Backlight Status Backlight ➔ ● ➔ Switch On/Off ➔ ● ➔ Select option ➔ ●</p> <ul style="list-style-type: none"> Selecting Normal Settings applies Display Backlight settings. <p>Disabling Backlight Flashing Backlight ➔ ● ➔ Blink ➔ ● ➔ Off ➔ ●</p> <p>Disabling Vibration Vibration ➔ ● ➔ Off ➔ ●</p>
Deleting S! Applications	<p>● ➔ S! Appli ➔ ● ➔ S! Appli Library ➔ ● ➔ Select application ➔ (☺) ➔ Delete ➔ ● ➔ Yes ➔ ●</p> <ul style="list-style-type: none"> Handset Code may be required. Cancel Screensaver to delete Screensaver S! Application.

Restoring default S! Application settings	<p>● ➔ S! Appli ➔ ● ➔ Settings ➔ ● ➔ Set to Default ➔ ● ➔ Enter Handset Code ➔ ● ➔ Yes ➔ ●</p>
Restoring default S! Appli Library	<p>● ➔ S! Appli ➔ ● ➔ Settings ➔ ● ➔ Memory All Clear ➔ ● ➔ Enter Handset Code ➔ ● ➔ Yes ➔ ●</p> <ul style="list-style-type: none"> Delete IC Card data beforehand. (Procedures to delete IC Card data vary by Lifestyle-Appli; contact Osaifu-Keitai® service providers for details.) Memory All Clear deletes all downloaded S! Applications and Lifestyle-Applications; Near Chat access restriction will be canceled.
Synchronizing Memory Card S! Applications with 940SH	<p>● ➔ S! Appli ➔ ● ➔ Settings ➔ ● ➔ Synchronization ➔ ● ➔ Yes ➔ ●</p>
Opening Java™ license information	<p>● ➔ S! Appli ➔ ● ➔ Information ➔ ●</p>



Mobile Widget

■ Managing

Opening properties	<ul style="list-style-type: none"> Widget → Widget Contents → Select widget → Details Select widget other than <i>S!速報ニュース!ともだち状況</i>
--------------------	---------------------------------------------------------------------------------------------------------------------------------------------------------------

■ Widget History

Opening widget notification history	<ul style="list-style-type: none"> Start Here → Widget → Widget History → See below
	Showing All Text Select record → View full text
	Deleting a Record Select record → Delete → Yes
	Deleting All Records Select record → Delete All → Enter Handset Code → Yes

■ Settings

Canceling automatic updates	<ul style="list-style-type: none"> Widget → Settings → Auto Refresh → Off
Receiving updates automatically while outside Japan	<ul style="list-style-type: none"> Widget → Settings → AutoConnect Abroad → On
Hiding confirmation outside Japan	<ul style="list-style-type: none"> Widget → Settings → Set Use Abroad → Off

Disabling widget notifications	<ul style="list-style-type: none"> Widget → Settings → Notification Setting → Off
Disabling cookies	<ul style="list-style-type: none"> Widget → Settings → Cookies → Disabled
Deleting cookies	<ul style="list-style-type: none"> Widget → Settings → Delete Cookies → Yes

■ Operations in Standby

Selecting widget display option	<ul style="list-style-type: none"> Settings → Show Widget → Select option Choose Off to disable widget display even when is pressed.
Logging in to Yahoo! JAPAN	<ul style="list-style-type: none"> Yahoo!JAPAN log in Follow onscreen instructions. To log out, select Yahoo!JAPAN log out in the above steps.
Moving widgets	<ul style="list-style-type: none"> Use to select widget → Change Layout → Specify target location
Moving widgets to front/back	<ul style="list-style-type: none"> Use to select widget → Operation → To Front or To Back
Updating view	<ul style="list-style-type: none"> Use to select widget → Operation → Update View



Removing widgets at once by sheet	Start Here → → → <i>Operate from List</i> → → <i>Remove</i> → → See below
	All Widgets <i>Remove All</i> → → Select sheet → → Yes →
	Selected Widgets <i>Select & Remove</i> → → Select widget → → → Complete selection → → Yes →
Slowing pointer speed	→ → <i>Settings</i> → → <i>Cursor Speed</i> → → <i>Slow</i> →

■ Sheets

Editing sheet names	Start Here → → → <i>Settings</i> → → <i>Sheet Settings</i> → → <i>Change Sheet Name</i> → → See below
	Renaming Select sheet → → Enter name →
	Resetting All Sheet Names → Yes →
Locking sheets	Start Here → → → <i>Settings</i> → → <i>Sheet Settings</i> → → <i>Set Sheet Lock</i> → → Enter Handset Code → → See below
	Activating Lock Select sheet → → On →
	Changing Method for Temporary Access <i>Unlock Method</i> → → No Password → <ul style="list-style-type: none"> Press , then select and press to unlock sheet temporarily.

■ S! Quick News & S! Friend's Status Widget (S! Quick News)

Adding news items	→ Select S! Quick News & S! Friend's Status widget → → <i>Operation</i> → → <i>Content Menu</i> → → <i>Add News</i> → → <i>S! Quick News List</i> → → <i>登録はこちら</i> → → Select item → <ul style="list-style-type: none"> Follow onscreen instructions.
Changing news scroll speed	→ Select S! Quick News & S! Friend's Status widget → → <i>Operation</i> → → <i>Content Menu</i> → → <i>News Display</i> → → <i>News Speed</i> → → Select speed →
Showing unread news only	→ Select S! Quick News & S! Friend's Status widget → → <i>Operation</i> → → <i>Content Menu</i> → → <i>News Display</i> → → <i>Target News</i> → → <i>Unread Only</i> →

■ S! Quick News & S! Friend's Status Widget (S! Friend's Status)

Assigning members	→ Select S! Quick News & S! Friend's Status widget → → <i>Operation</i> → → <i>Content Menu</i> → → <i>Assign Member</i> → → Select category → → Select entry/member → → (Empty) →
Managing members	Start Here → → Select S! Quick News & S! Friend's Status widget → → Use to select member → → <i>Operation</i> → → <i>Content Menu</i> → → See below
	Deleting Members <i>Delete</i> → → Yes →
	Changing Member Order <i>Move</i> → → (Up) or (Down) →
	Changing Member Icons <i>Change Icon</i> → → Select Pictogram →



S! Applications



Cannot move S! Applications to Memory Card

- Memory Card memory may be low or the S! Application may already be saved.



S! Applications do not pause for incoming transmissions despite *Calls & Alarms* settings

- Regardless of setting, a notice appears for Screensaver S! Applications.



Keitai Wi-Fi connection failure confirmation appears upon starting S! Application

- Handset may be outside Wi-Fi range. Move into range or cancel **Switch from Wi-Fi to 3G** in Switch Notification.

