

Thank you for purchasing SoftBank 812SH s.

SoftBank 812SH s Supplementary Guide introduces major functions and operations.

For proper handset use, read this guide and SoftBank 812SH s Instruction Manual beforehand; keep both for reference.

Safety Precautions

Read "Safety Precautions" in SoftBank 812SH s Instruction Manual.



Contents

Key Assignments	2
Charging	3
Handset Power On/Off	4
Display Indicators	5
Main Menu & My Details	6
Manner Mode	7
Voice Calls	8
Call Log	9
Creating Phone Book Entries	10
Dialing from Phone Book	12
Change Menu	13
Sending S! Mail	14
Opening Received Mail & Replying	16
Capturing & Opening Still Images	18
Capturing & Sending Images	20
Wallpaper	22
Text Entry	24

Tip▶ In this SoftBank 812SH s Supplementary Guide, SoftBank 812SH s Instruction Manual is abbreviated as "Instruction Manual."

Key Assignments

- Open Main Menu
- Execute operation/function

- Select items
 - Move cursor
- Indicated in this guide as shown:

Down	Up/ Down	Left	Right	Left/ Right	Up/Down/ Left/Right

- ✕-ル ● Create S! Mail (Long Press)



- ☎ ● Initiate or answer calls

- A/a ● In text entry windows, toggle upper/lower case roman letters
- Open Shortcuts menu

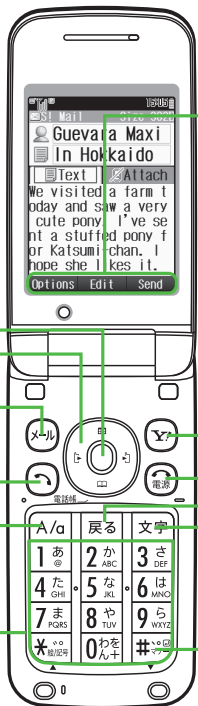
- 1 あ - # マナー ● Enter numbers/text



Softkeys

Function or operation assigned to ,  or  may appear at the bottom of Display.

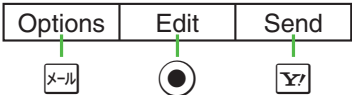

- Y? ● Open Yahoo! Keitai Main Menu

- ☎ ● Turn handset on/off (Long Press)
- End calls
- Exit functions

- 戻る ● Return to previous window
- Delete entries

- 文字 ● Change character entry mode

- # マナー ● Activate/cancel Manner mode (Long Press)

Charging

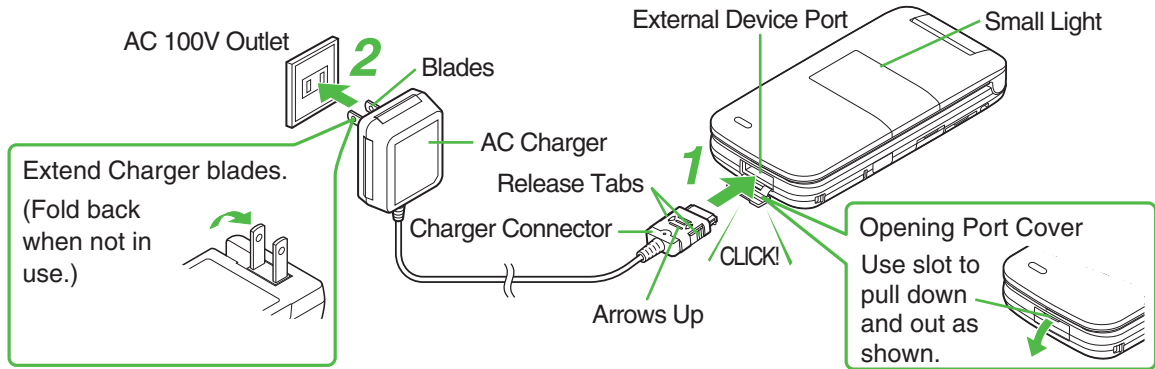

Use specified Charger only.

- 1 Open Port Cover to connect Charger**
- 2 Plug Charger into AC outlet**

- Small Light illuminates red while charging; may take up to approximately 150 minutes.
- When charging completes Small Light goes out.

After Charging

Unplug Charger, then disconnect handset

- Squeeze release tabs to remove connector.
- Replace Port Cover to protect External Device Port.

Handset Power On/Off

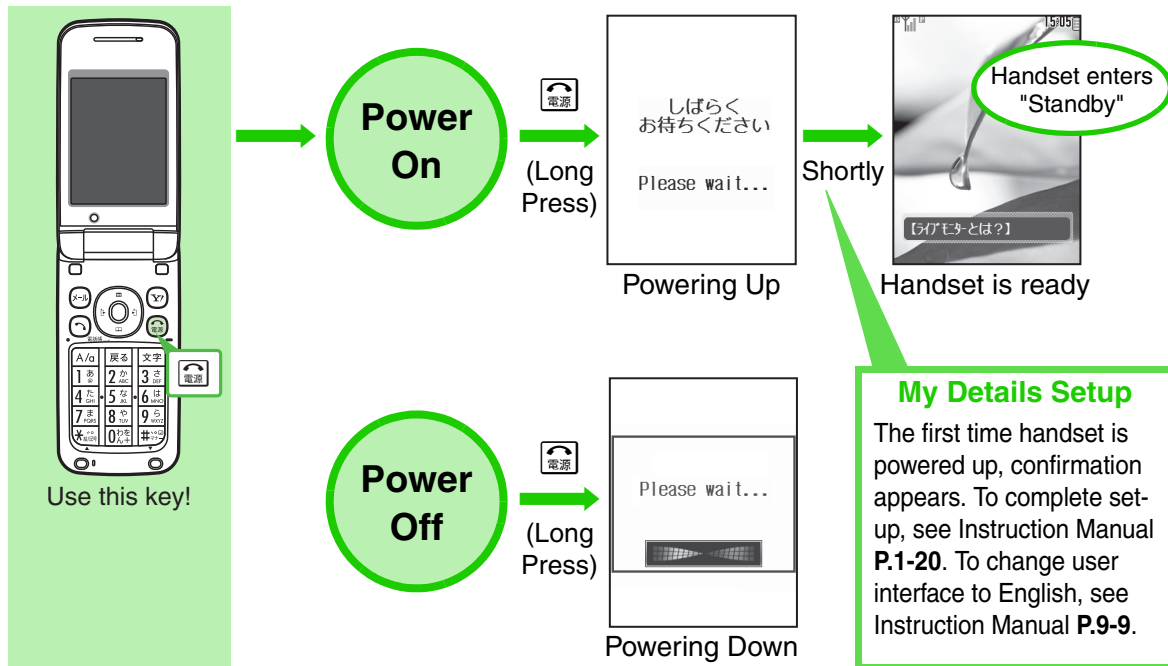

Display Indicators

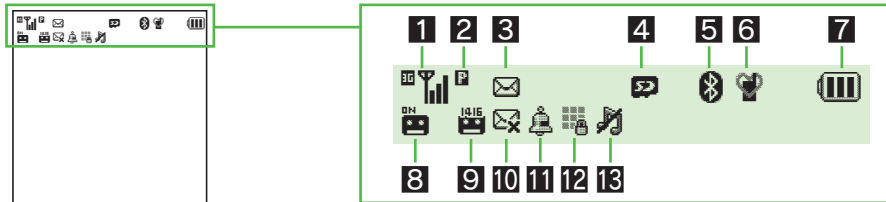

- 1** : Signal Strength
The more bars the better.
- 2** : Packet Transmission Available
 - : Incoming Voice Call
 - : Voice Call in Progress
 - : Packet Transmission Protocol Ready
- 3** : Unread Mail
 - : Unread Delivery Report
 - : Receiving Mail
 - : Sending Mail
- 4** : Memory Card Inserted
- 5** : Bluetooth[®] Transmission Ready
- 6** : Manner Mode Active
 - : Drive Mode Active
- 7** : Battery Strength
Indicator may appear vertically (e.g.).
- 8** : Answer Phone Active
 - : Answer Phone Active & Message Recorded
 - : Answer Phone Canceled & Message Recorded
- 9** : New Voicemail
- 10** : Message Delivery Failure
- 11** : Alarm Set
- 12** : Keypad Lock Active
- 13** : Ringtone Silent
 - : Ringtone Silent & Vibration Active

Manner Mode

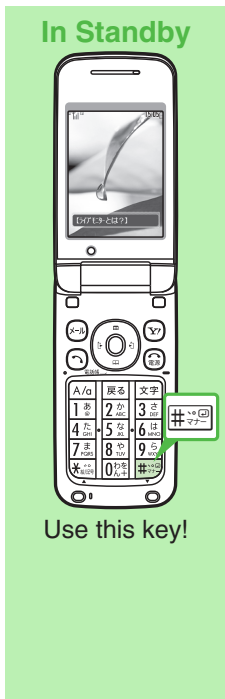

Activate

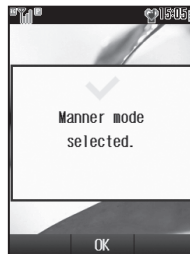
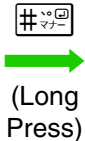

Manner mode
is set

Cancel

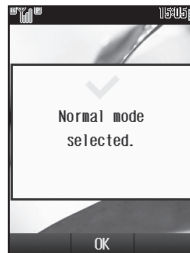
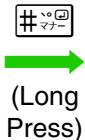

Manner mode
is canceled

When Manner Mode is Active

 appears.



Ringtones, Keypad tones,
etc. are muted, however,
Shutter click still sounds.

Voice Calls

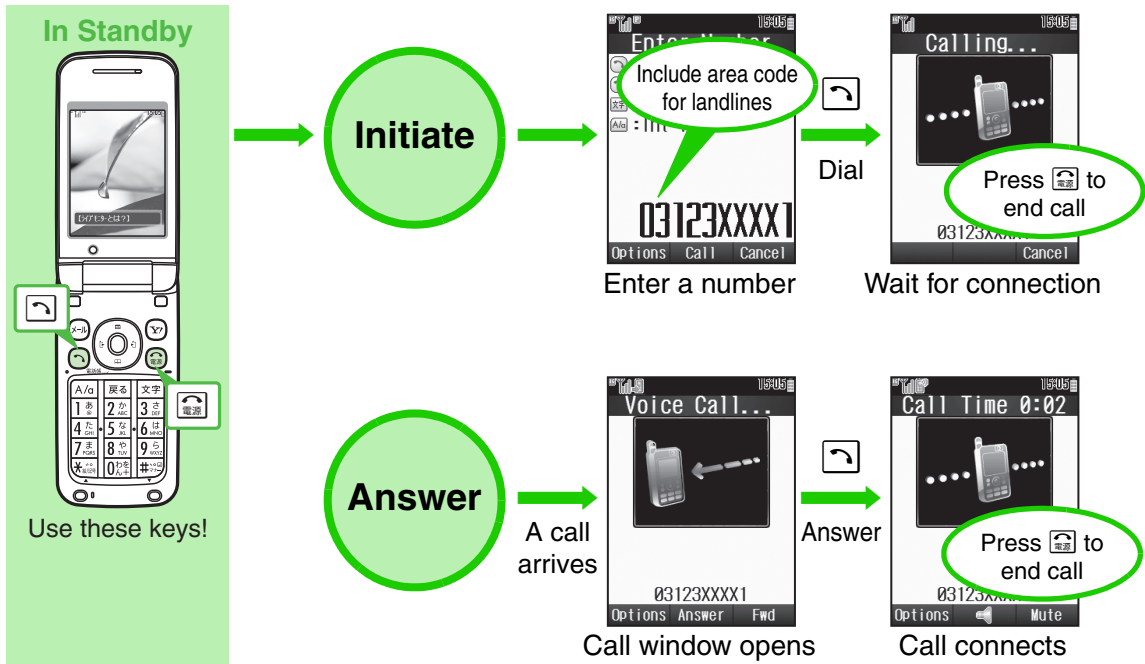

Call Log

Place calls from records of recently dialed numbers and received calls.

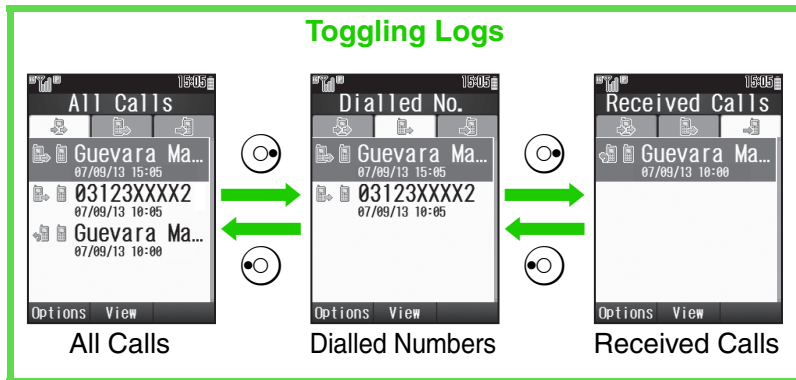
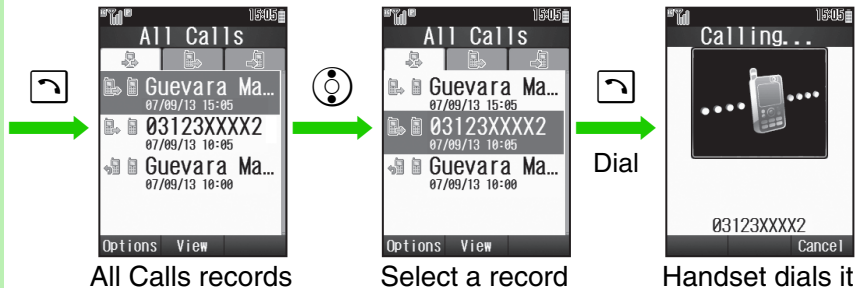
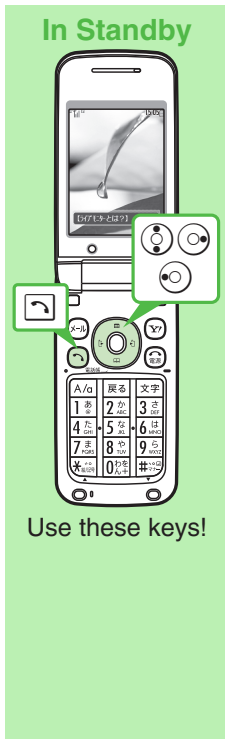

Creating Phone Book Entries

Example: To enter a last name and phone number

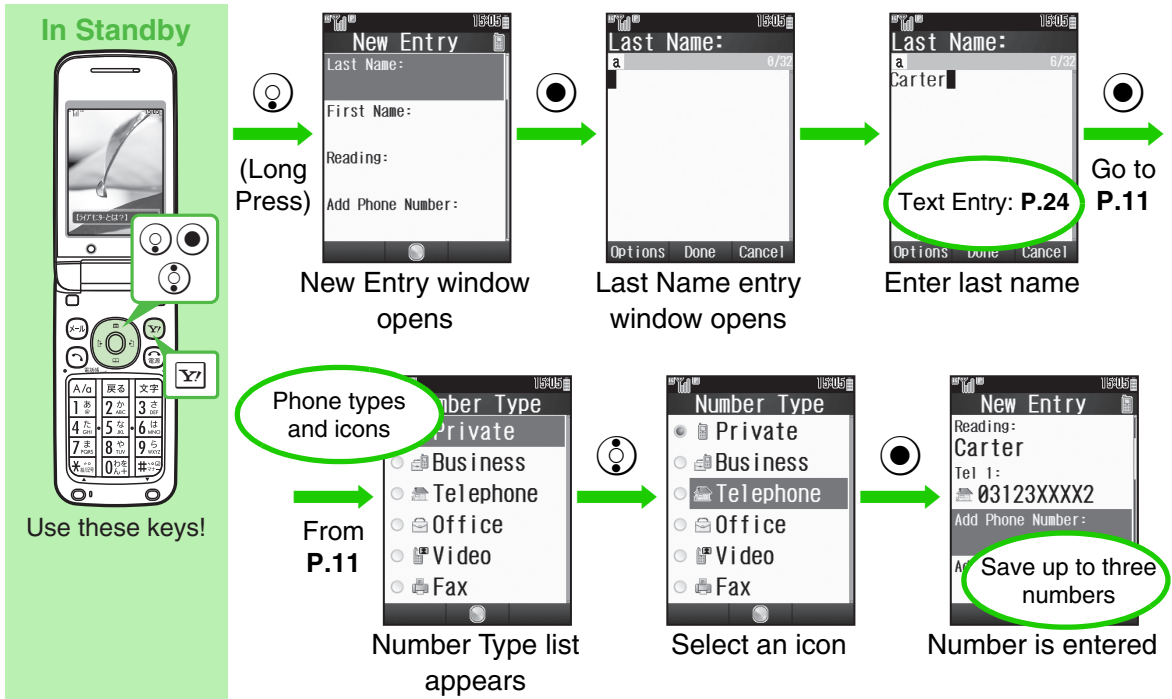

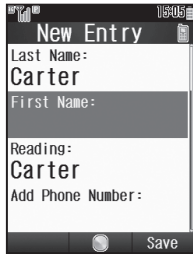

Reading is entered automatically



Select **Add Phone Number:**

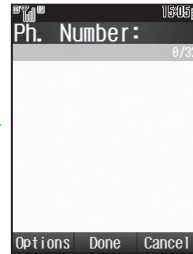

Phone Number entry window opens

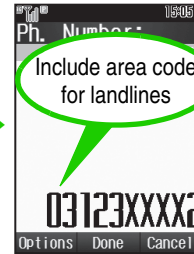

Enter a number



Go to P.10

Save From P.10



Entry is saved

Other Phone Book Entry Items

Add Email Address	Enter up to three addresses
Category	Sort entries into Categories
Picture	Set an image to appear for incoming calls/mail
Tone for	Set ringtone/ringvideo by caller/sender
Vib	Set vibration by caller/sender
Secret	Restrict access to Phone Book entries

Save address, birthday, and more in addition to the above items.

Dialing from Phone Book

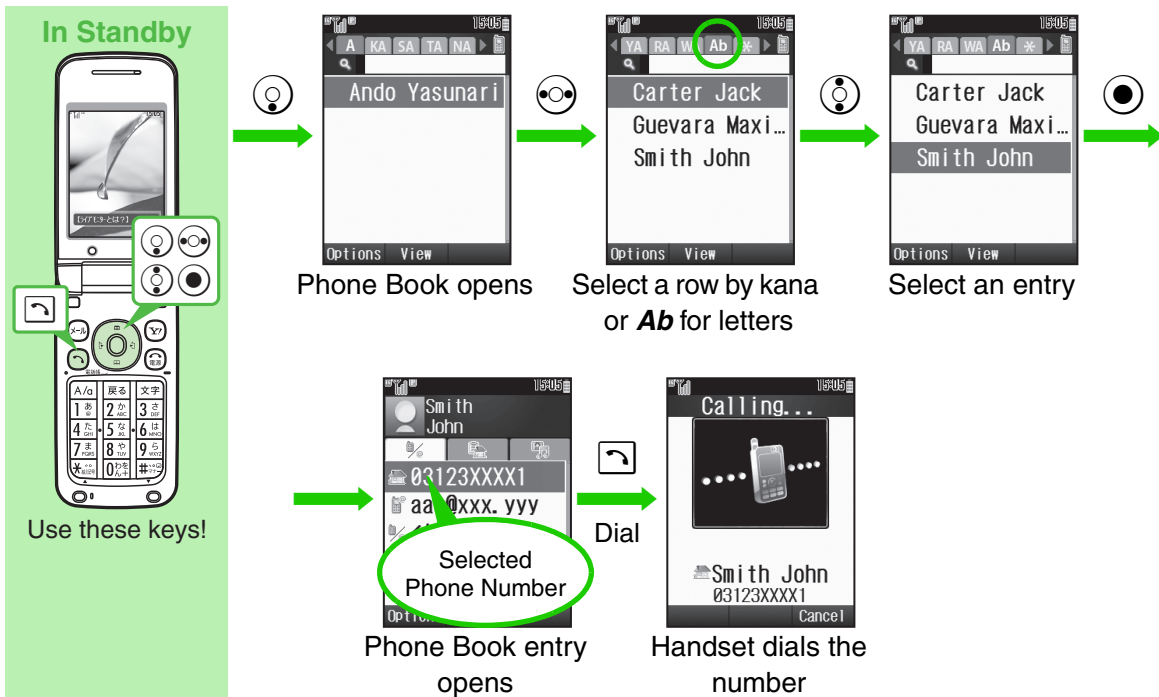

Change Menu

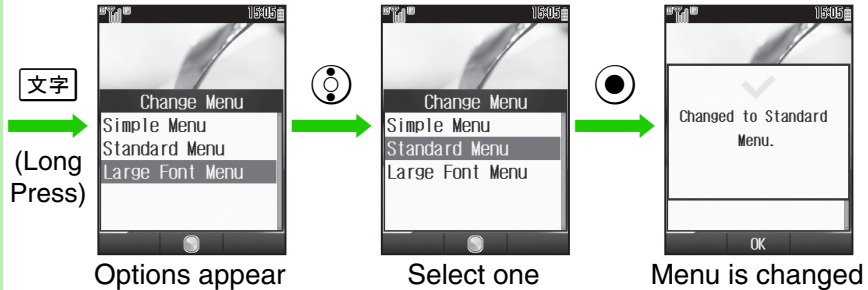
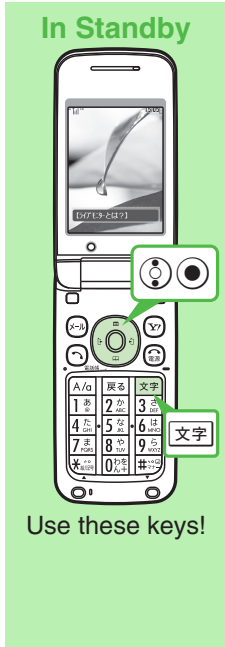

Handset Menu Options

Simple Menu	Simplified menus in large fonts
Standard Menu	All menus in Standard fonts
Large Font Menu	All menus in large fonts (default)

Sending S! Mail

Example: To send S! Mail to a number/address saved in Phone Book

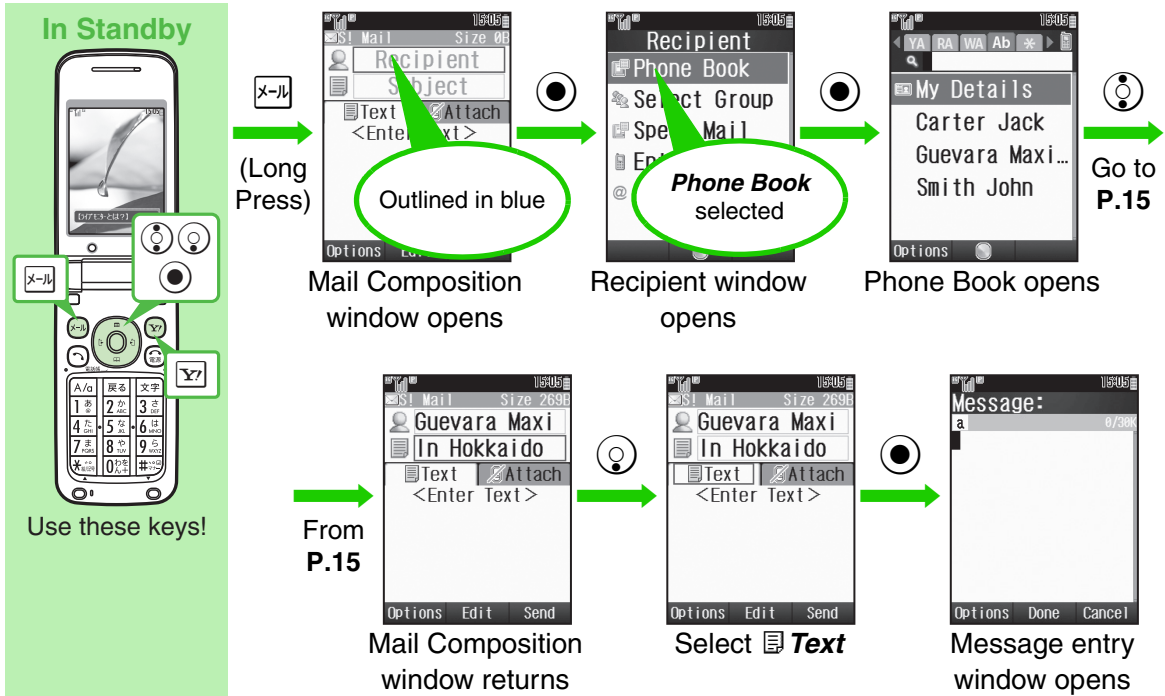



Select a recipient

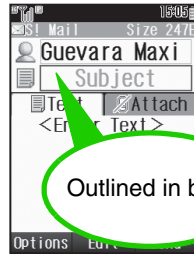

Mail Composition window returns

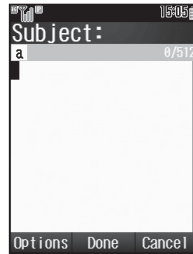

Subject entry window opens

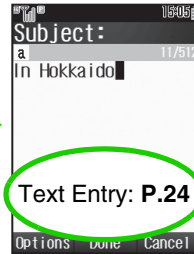

Enter subject



Go to P.14

From P.14



Enter a message



S! Mail is created

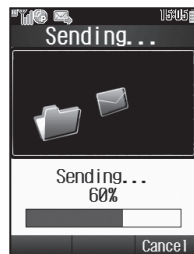

S! Mail is sent

Opening Received Mail & Replying

Example: To open newly received S! Mail and reply

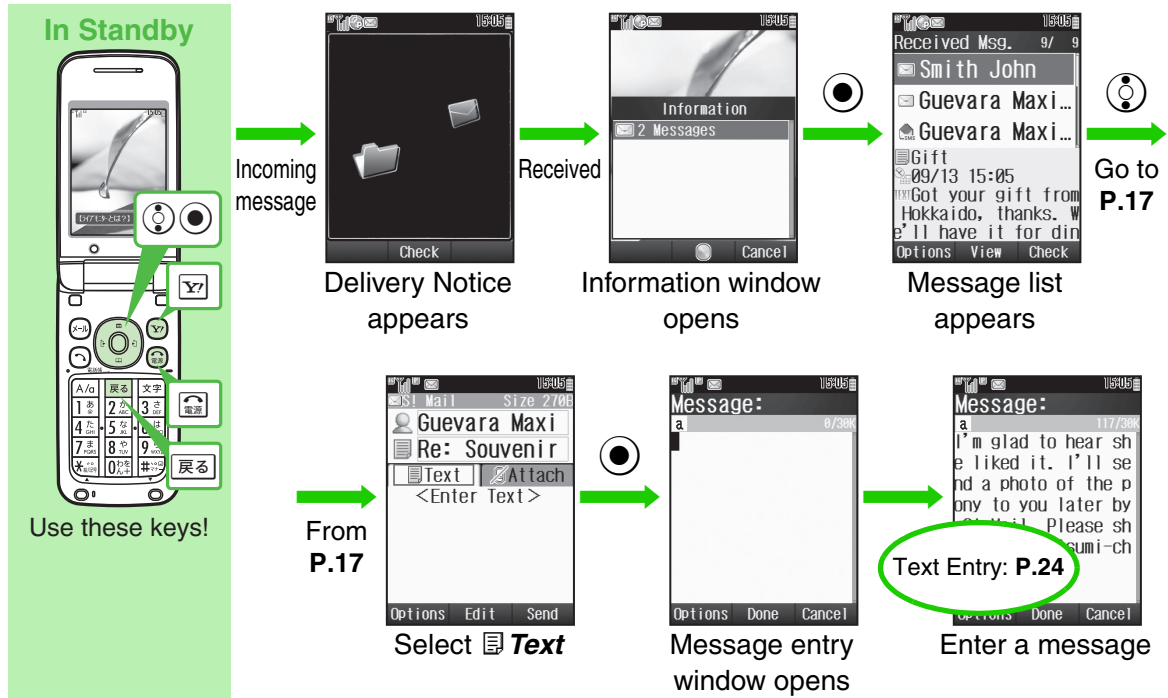



Select a message

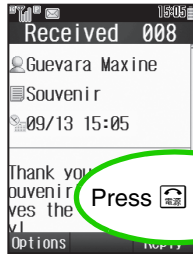

Message window opens



Reply

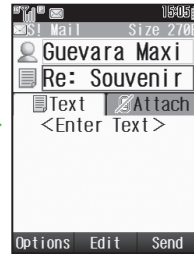

Mail Composition window opens



Go to P.16



From P.16



S! Mail is created



Send



S! Mail is sent

Subject
Entered prefaced with **Re:**. To edit it, select the field and press [Selection Icon].

Capturing & Opening Still Images

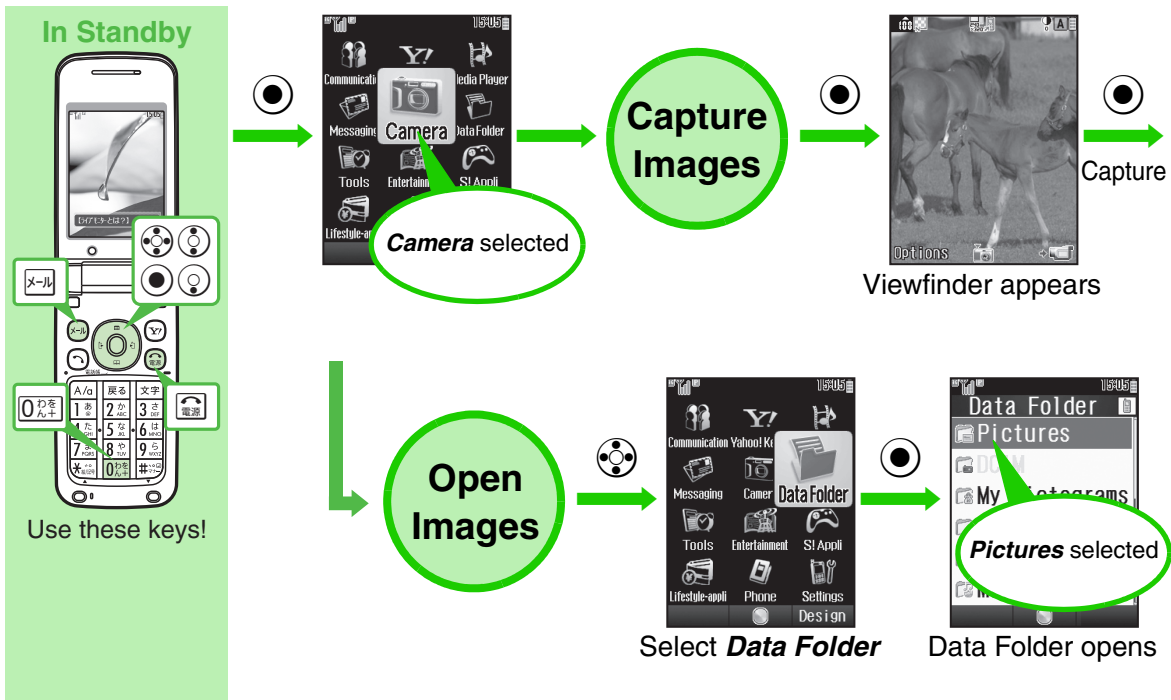

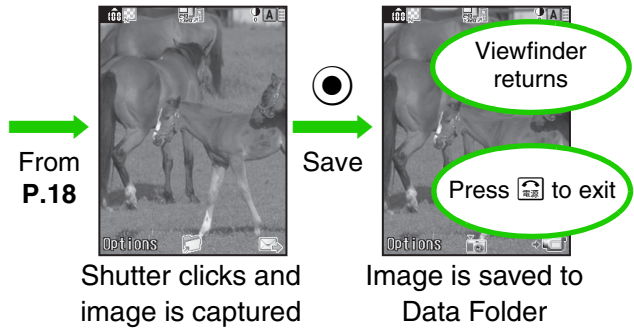

Help

While Viewfinder appears, press to view a summary of key assignments. (Use to scroll.)

- :Zoom In
- :Zoom Out
- :Exposure -
- :Exposure +
- :ChangeCamera
- :To Video

OK

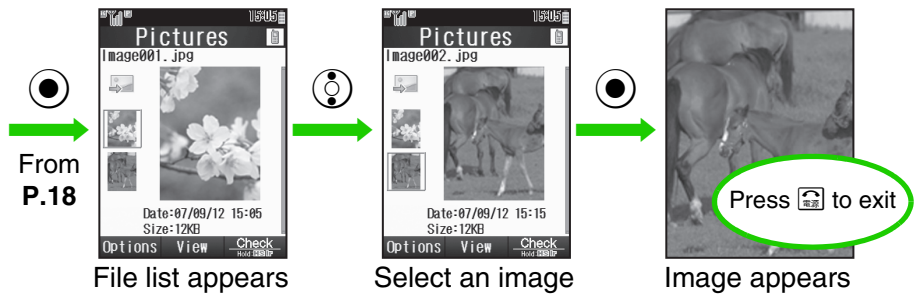

Capturing & Sending Images

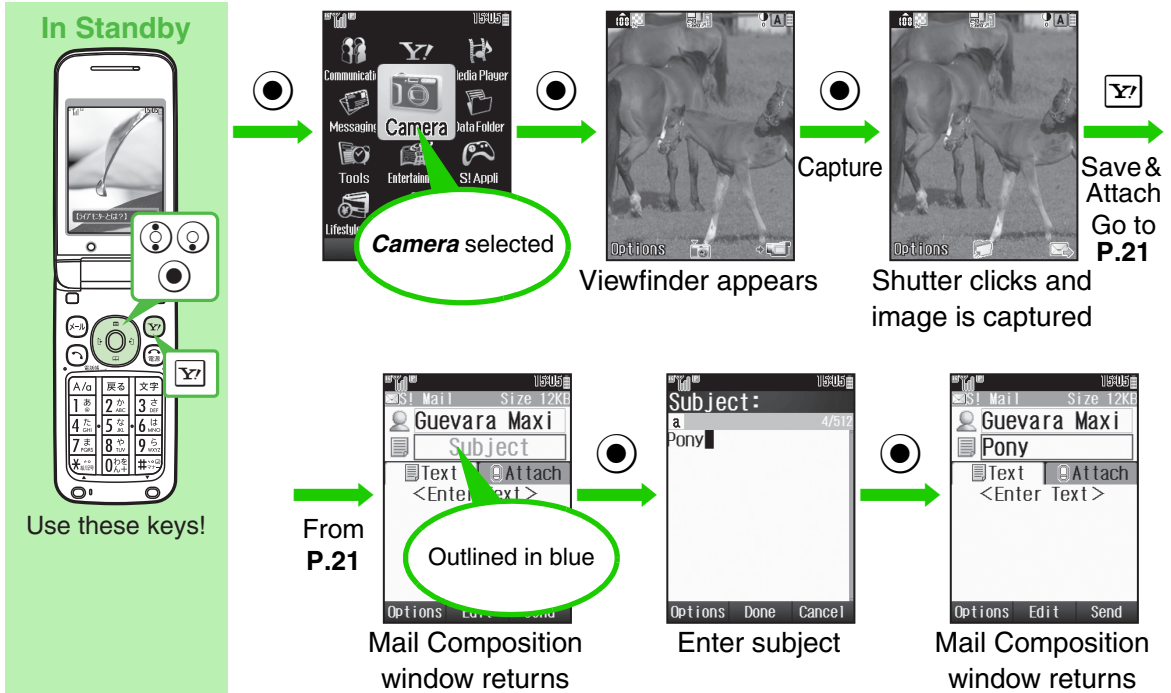

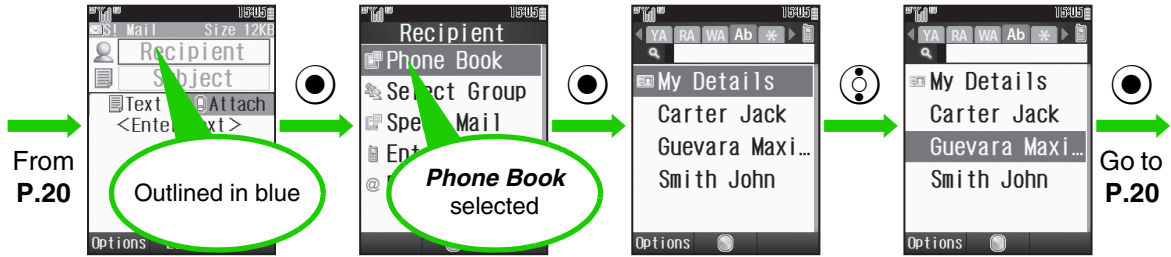

Mail Composition window opens

Recipient window opens

Phone Book opens

Select a recipient

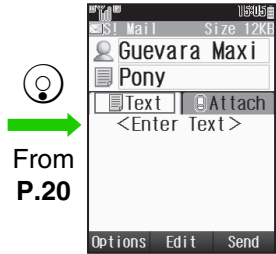

Select **Text**



Enter a message

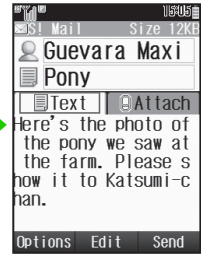

SI Mail is created

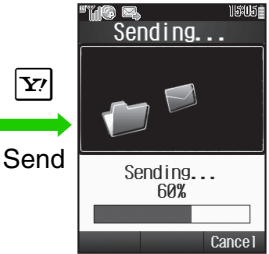

SI Mail is sent

Wallpaper

Use a captured image as Wallpaper.

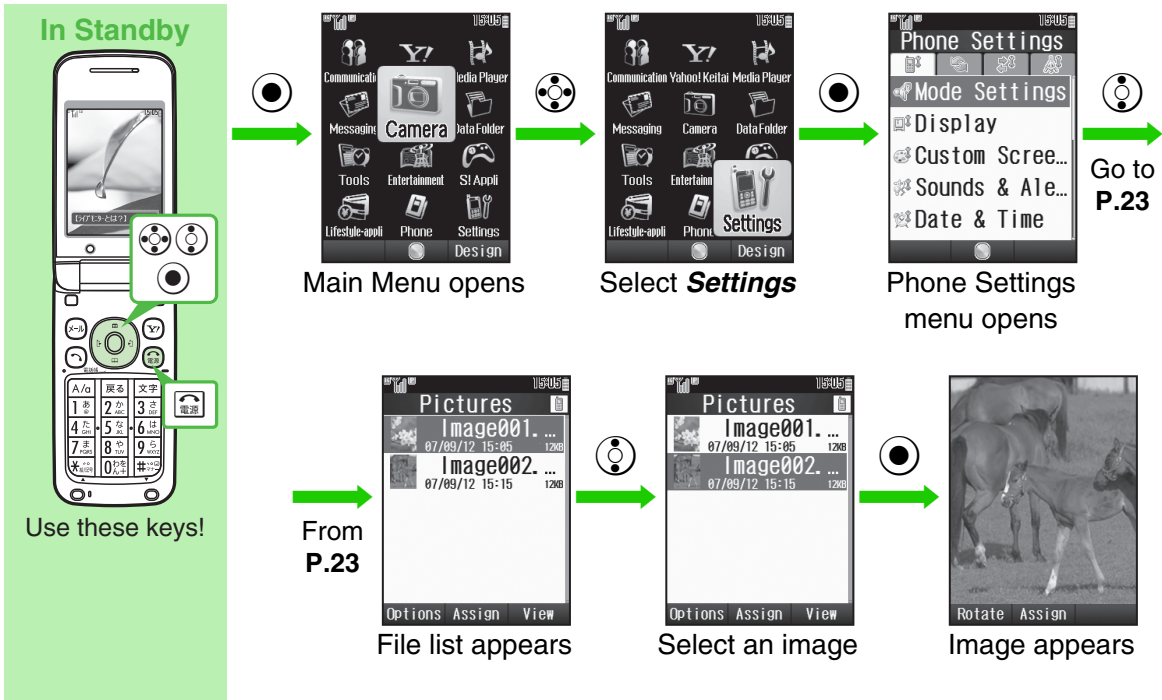

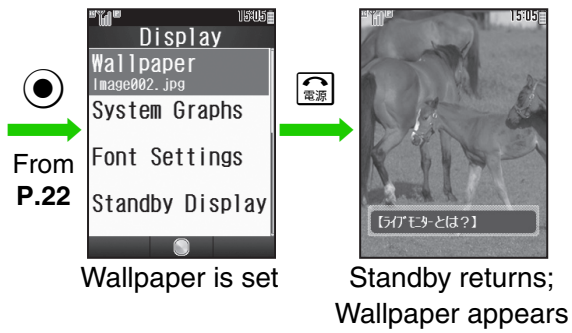
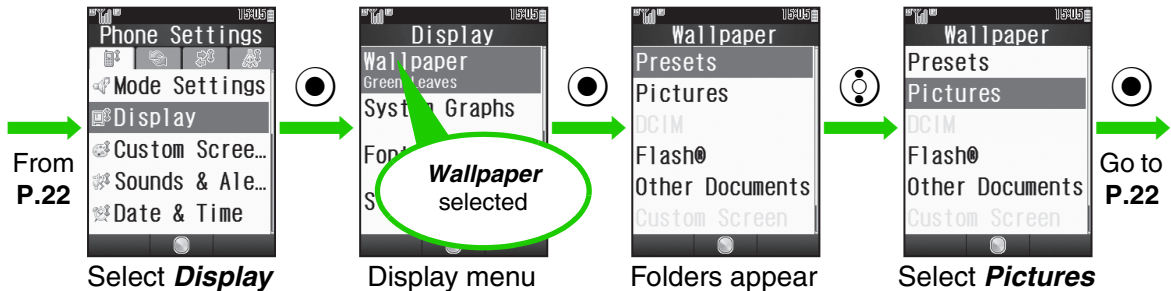

Text Entry

Switching Entry Modes

In a Text Entry Window

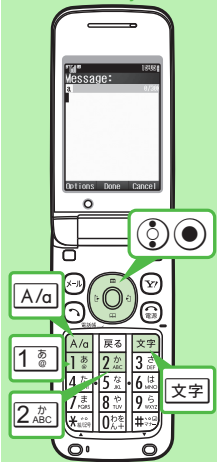

Use these keys!

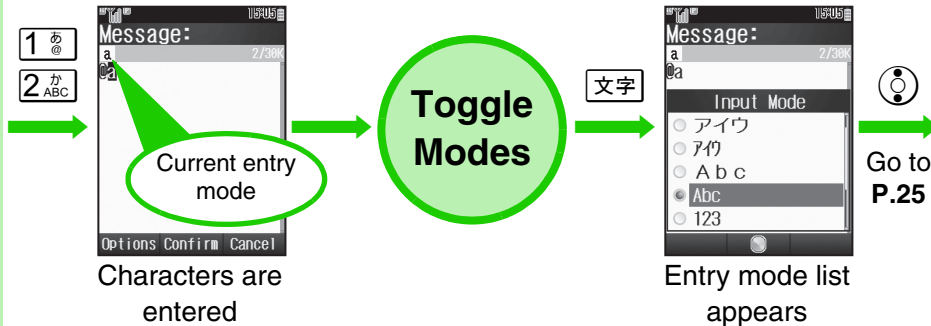

Characters are entered

Entry mode list appears

Available Modes

Kanji	Kanji (hiragana)	123	Single-byte number
アイウ	Double-byte katakana	Pictogram	Pictogram*
アイ	Single-byte katakana	Symbols	Symbol*
A b c	Double-byte alphanumerics	Character Code	Character Code
Abc	Single-byte alphanumerics		*List appears.

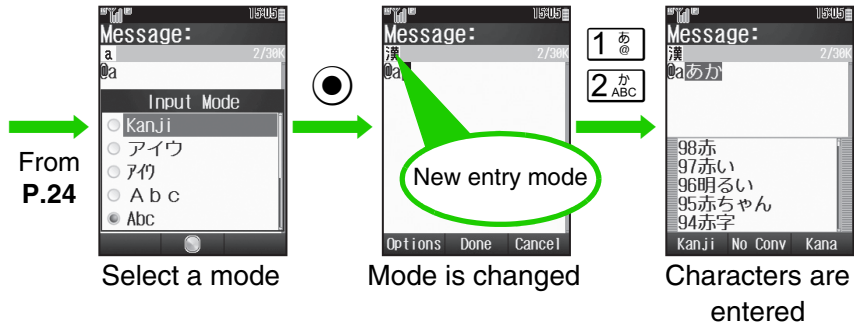

Toggle Case

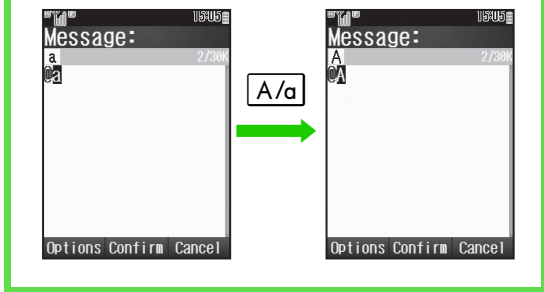

Character Entry Basics & Key Assignments

Multiple characters are assigned to each key. Press a key to toggle between character options for that key.

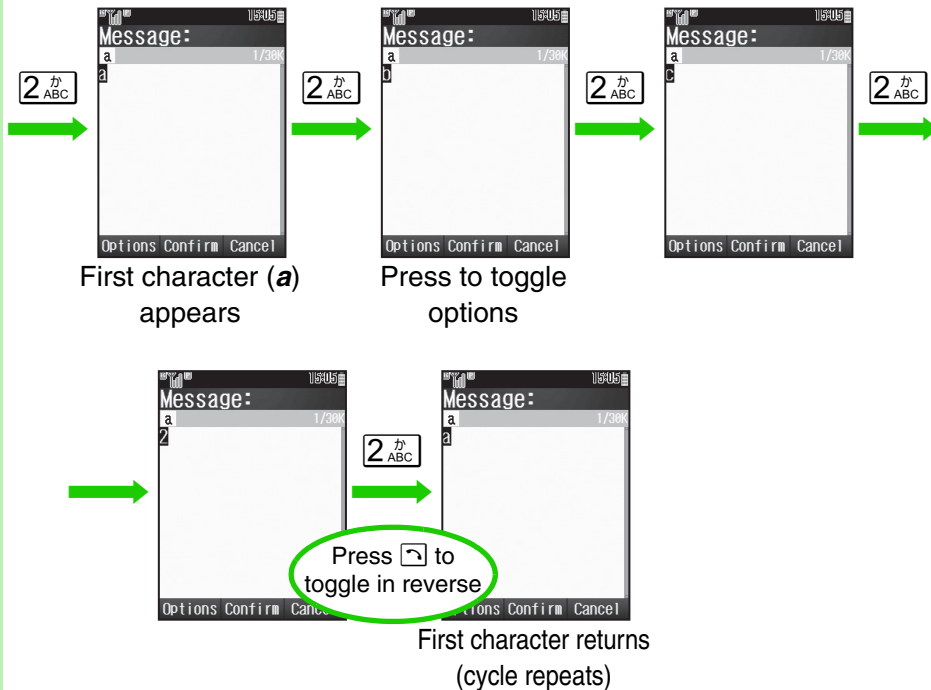
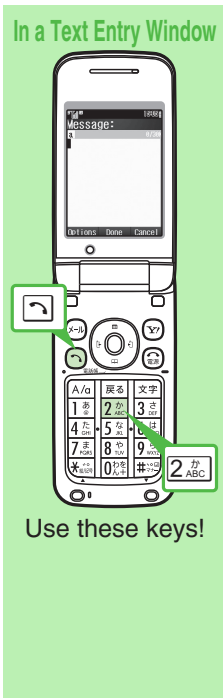

■ Key Assignments

	Kanji (Hiragana) [Double-byte]	Katakana [Double & Single-byte]	Alphanumerics [Double & Single-byte]	Numbers [Single-byte]
1 あ @	あいうえお あいうえお	アイウエオ アイウエオ	@. / _ — 1 □ (Space)	1
2 か ABC	かきくけこ	カキクケコ	A B C a b c 2	2
3 さ DEF	さしすせそ	サシスセソ	D E F d e f 3	3
4 た GHI	たちつてとつ	タチツテトツ	G H I g h i 4	4
5 な JKL	なにぬねの	ナニヌネノ	J K L j k l 5	5
6 は MNO	はひふへほ	ハヒフヘホ	M N O m n o 6	6
7 ま PQRS	まみむめも	マミムメモ	P Q R S p q r s 7	7
8 や TUV	やゆよやゆよ	ヤユヨヤユヨ	T U V t u v 8	8
9 ら WXYZ	らりるれろ	ラリルレロ	W X Y Z w x y z 9	9
0 わ ん 十	わをんー	ワヲンー	0	0
* ** 記号	、 。	、 。	、 。	* P (Pause) ? - ³
Log/History, Pictogram List, Symbol List ²				
# ** @D マフ	、 。	、 。	、 . ↓ (Line Break) ? ! □ (Space)	#

¹- is available only in single-byte katakana entry.

²Double or single-byte according to the entry mode.

³* P (Pause), ? and - are for phone number entry.

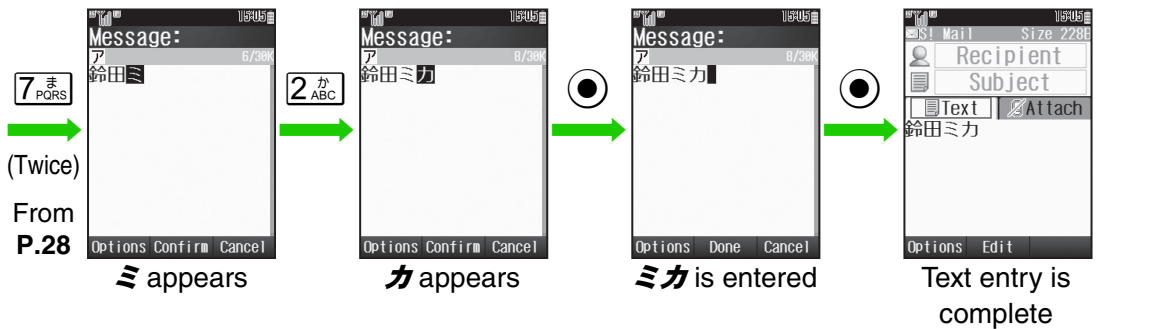
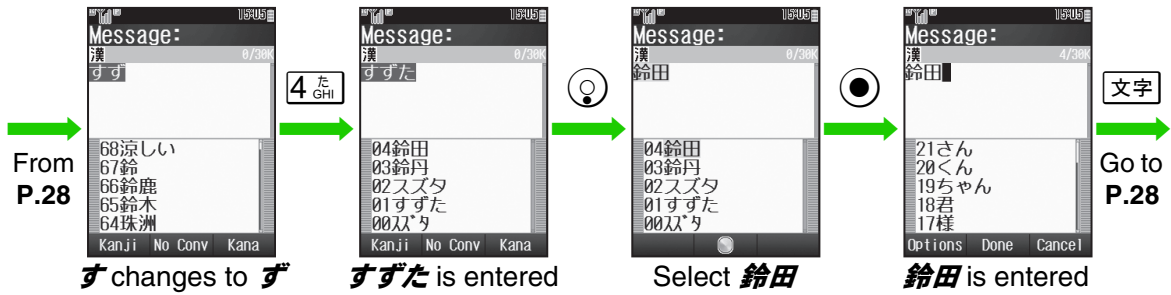



■ Mind your mobile manners when carrying a handset.