

Getting Started

Package Contents

□ Handset (103P)

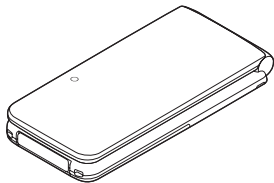

□ Battery (PMBAS1)

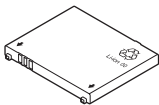

□ クイックスタート (Japanese)

□ お取り扱いとご注意 (Japanese)

□ 保証書 (Japanese)

Note

- Use SoftBank Mobile specified AC Charger (sold separately) to charge Battery.
- For more information about AC Charger and accessories, please contact SoftBank Customer Support, General Information (☎ P.9-21).
- 103P accepts microSD or microSDHC Card (not included). Purchase one to use related functions (☎ P.1-5, P.9-1).

Using This Guide

Before reading on, please make note of the following:

- SoftBank 103P is referred to as "handset" or "103P."
- "microSD Card" and "microSDHC Card" are referred to as "microSD Card."
- Screenshots, etc. are for reference. Actual handset windows, menus, etc. may differ.
- Key icons are simplified.
- Most operation descriptions begin in Standby.
- Pressing a Key for more than one second is described as "Press and Hold."

Guide Symbols

Softkeys

Press the corresponding Key to execute the function or operation indicated at the bottom of Display.

Example:

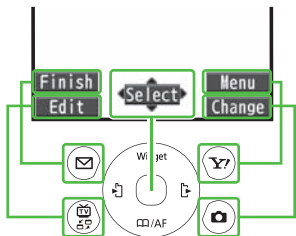

Multi Selector

Use Multi Selector to select items, navigate menus, etc. In this guide, Multi Selector operations are indicated as shown below.

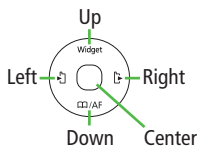

Up	Up/Down	Up/Down/Left/Right
Down		
Left	Left/Right	Center
Right		

Japanese Functions & Services

When "(Japanese)" appears in a title, Japanese ability is required to use full range of the function or service.

USIM Card Installation

- Always power off handset before removing Battery.
- USIM PINs:  P.1-13

Inserting

- 1 With IC chip down, insert USIM Card

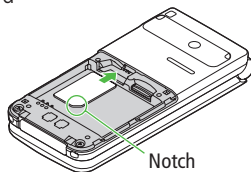

Removing

- 1 Slide out USIM Card gently

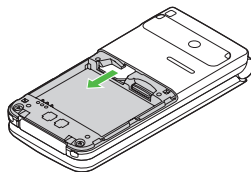

Important

- USIM Card is the property of SoftBank Mobile.
- Return USIM Card to SoftBank Mobile upon service cancellation.
- USIM Card will be reissued for a fee if lost or damaged.
- If USIM Card/handset with USIM Card installed is lost or stolen, contact SoftBank Customer Support or SoftBank Mobile Global Call Center ( P.9-21).
- Back up USIM Card files. SoftBank Mobile is not liable for lost files.
- USIM Card specifications/performance may change without prior notice.
- Pre-installed S! Appli may be unusable while a different or replacement USIM Card is installed.
- Some downloaded files may be inaccessible after upgrades/repairs, USIM Card/handset replacement.
- Returned USIM Cards are recycled.

Note

- Do not forcefully insert/remove USIM Card; may damage handset/USIM Card.
- Avoid touching USIM Card terminals or IC chip. Doing so may hinder performance/USIM Card recognition.

Charging Battery

Battery Installation

- Always power off handset before removing Battery.

1 Press and slide to remove Battery Cover

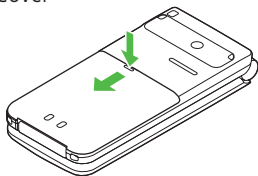

2 Insert Battery

Align Battery contacts with handset pins

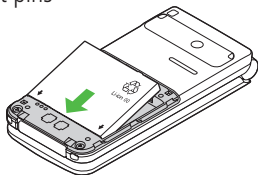

Remove Battery

Lift Battery out

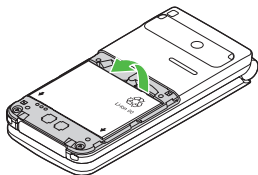

3 Replace Battery Cover

Battery Cover should click into place.

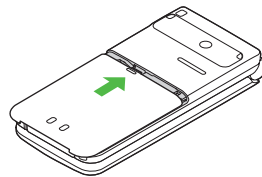

Note

- Lithium-ion batteries are valuable and recyclable resources.
 - Recycle used lithium-ion battery at shops displaying this symbol:
 - To avoid fire or electric shock, do not:
 - Short-circuit Battery
 - Disassemble Battery



Li-ion 00

Charging Battery

- Use only specified AC Charger (sold separately).

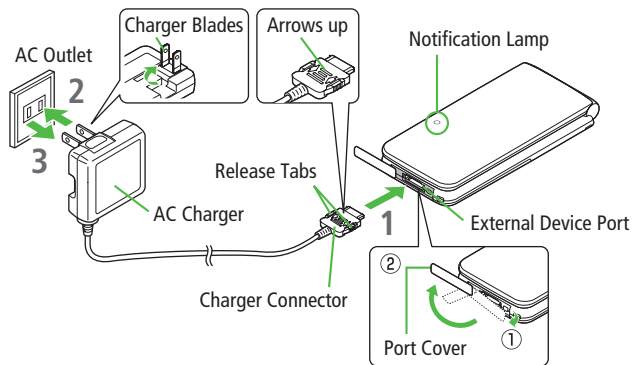

- 1 Connect AC Charger to handset
- 2 Extend Charger blades, and plug AC Charger into AC outlet
Notification Lamp illuminates and charging starts.
When charging is complete, Notification Lamp goes out.
- 3 When charging is complete, unplug AC Charger, then disconnect handset
Squeeze release tabs to remove Charger connector, and replace Port Cover.

microSD Card Installation

- Always power off handset before removing Battery.
- Handset Data Backup: ➔ P.9-1

Inserting

- 1 Insert microSD Card until it clicks

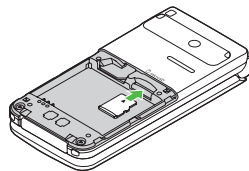

Format microSD Card

> Main Menu > Tools > microSD Backup > Refer Data > [Y] [Menu]
> microSD format > Enter Phone Password > YES

- Formatting microSD Card deletes all saved files/data.
- Do not power off handset or remove microSD Card while formatting; may damage handset or microSD Card.

Removing

- 1 Push microSD Card in
 - microSD Card pops out with a light push.

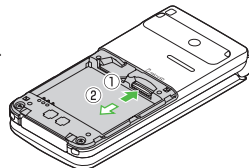

Parts & Functions

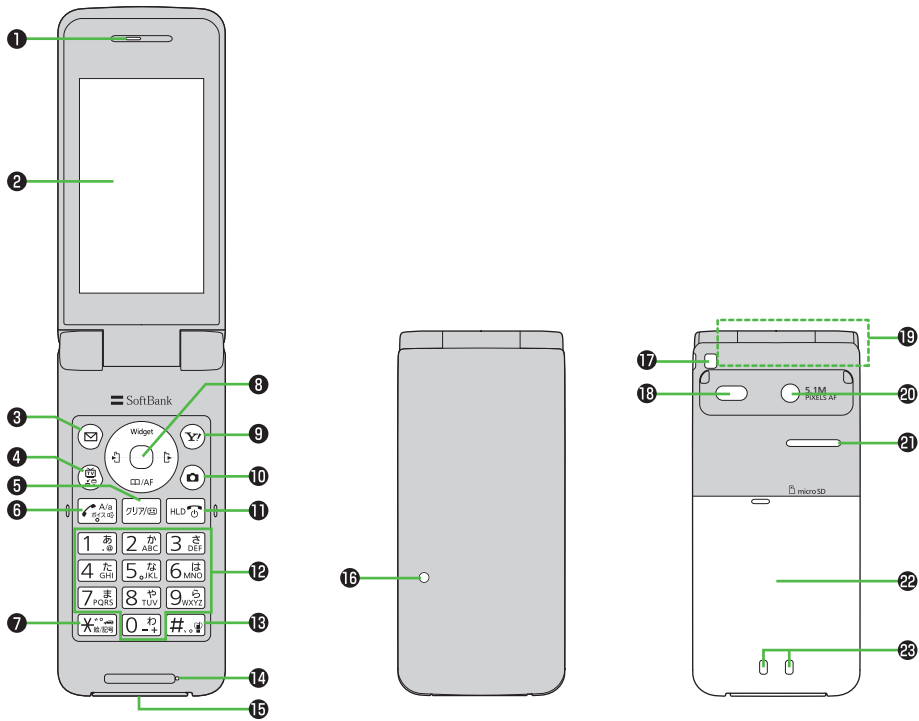

Getting Started

- 1 **Earpiece**
- 2 **Display**
- 3  **Mail Key**
 - Open Messaging menu
 - Execute Upper Left Softkey function
- 4  **TV Key**
 - Activate TV
 - Open TASK MENU
 - Execute Lower Left Softkey function
- 5  **Clear/Memo Key**
 - Delete characters
 - Cancel menus
 - Use Answer Phone
- 6  **Send Key**
 - Initiate or answer calls
 - Toggle upper/lower case in text entry windows
 - Use Voice Dial
- 7  *** /Pictograph/Symbol/Driving Mode Key**
 - Enter " * "
 - Access pictographs in text entry windows
 - Toggle Driving Mode on/off
- 8  **Multi Selector**
 - Move cursor or select menus (➡ P.1-2)
 -  Select icons/S! Quick News
 -  Open Phone Book
 -  Open Received call logs
 -  Open Redial logs
- 9  **Yahoo! Keitai Key**
 - Open Yahoo! Keitai top menu
 - Execute Upper Right Softkey function
- 10  **Camera Key**
 - Activate Camera
 - Execute Lower Right Softkey function
- 11  **End/Escape & Power Key**
 - Power on/off (➡ P.1-8)
 - End calls
 - Return to Standby
- 12  -  **Numeric Keys**
 - Enter phone number/text
- 13  **# /Manner Mode Key**
 - Enter " # "
 - Toggle Manner Mode on/off
- 14 **Mic**
- 15 **External Device Port**
 - Connect AC Charger, earphone or other accessories here
- 16 **Notification Lamp**
 - Flashes for incoming transmissions
 - Lights for charging
- 17 **Strap Eyelet**
- 18 **Infrared Port**
 - Transfer data via Infrared
- 19 **Internal Antenna Area**

- 20 **Camera**
- 21 **Speaker**
- 22 **Battery Cover**
- 23 **Charging Terminals**

Note

- Do not press microphone button when connecting Earphone with Mic. Doing so may cause malfunction. If pressed accidentally, unplug then reconnect it.

Basic Operations

Power On/Off

1 Power On

Press and Hold 

Start-up window appears and handset enters Standby.

Power Off

Press  for 2+ seconds → **YES**

Handset shuts down.



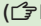

Initial Setup

The first time handset powers on and Initial setting window appears, select **YES** and set the following: (Each item can be set separately.)

Date & Time* ( P.1-9)	Set date and time
Phone Password ( P.1-13)	Enter 9999 , and enter new Phone Password
Key Tone	Select ON or OFF
Font Size	Set Display font size all at once

*May set/adjust automatically upon network connection.

Retrieving Network Information

Pressing , ,  or  for the first time in Standby may initiate Network Information retrieval. Press  to retrieve it.

- Update Network Information to use messaging, Internet, etc.
- Update Network Information manually: **Main Menu** ► **Settings** ► **Connectivity** ► **Retrieve NW Info** ► **YES**

Keyguard

Lock handset Keys to prevent accidental operation.

- While set,  appears in Standby.

1 Press and Hold

- To cancel Keyguard, repeat operation.

While Keyguard is Active

- Answer incoming calls by Pressing .
- Once emergency numbers (110, 119, 118) are dialed, Keyguard is canceled.

English Interface

Main Menu ► 設定 ► ディスプレイ設定 ► Language ► English

Date & Time

Main Menu ► Settings ► Date & Time

1 *Date & Time*

2 Enter year → Enter date → Enter time

■ World Clock

> After Step 2, highlight time zone → [Edit] → [Select] to select a time zone

- Alternatively, in Step 1, **World Clock** → **ON** → [Select] to select an area → [Select].

My Number

1 [Select] → [0]

■ Edit Account Details

Save phone number, mail address, street address, etc. in Account Details.

- Handset phone number cannot be edited or deleted.

> After Step 1, [Edit] → Enter Phone Password → Edit → [Finish]

■ Send Account Details via Infrared

> After Step 1, [Ir]

Display

Icons & Indicators



1 Display Indicators

Signal Strength

Strong Moderate Weak Low

Offline Mode Active

OUT Out-of-Range

Battery Level

→ → → (Red)

Data Transmission

3G/GSM Packet Transmitting

Network Service

Operator (set for Select Operator)
Out-of-Range

3G / 3G/GSM Packet Transmission Available*

3G / 3G/GSM Packet Transmission
Unavailable*

* Appears only while abroad

Secure Content

PC Site Browser Active

Infrared Active

USB Cable Connected

Keyguard Active

Voicemail

(Blue) Bluetooth® Device Connected

microSD Card Installed

Unread Message

Unread Urgent News

Manner Mode Active

Software Update
(Notification/Updating/Result)

Digital TV Active

Timer Recording in Progress

Recording TV Program/Paused

Music Playback/Paused

Vibration Active (Incoming Call/Message)

Incoming Call/Message Ringtone Disabled

Driving Mode Active

USB Mode

Communication Mode

microSD Mode

Answer Phone Active (Number of Recorded Messages (Voice Call))

Answer Phone Active (Number of Recorded Messages (Video Call))

2 Information Window (P.1-11)

Information Window





In Standby, Information Window opens for missed events.
Select a notification to view/access information.

- 1 Highlight an item → 
Follow onscreen instructions.

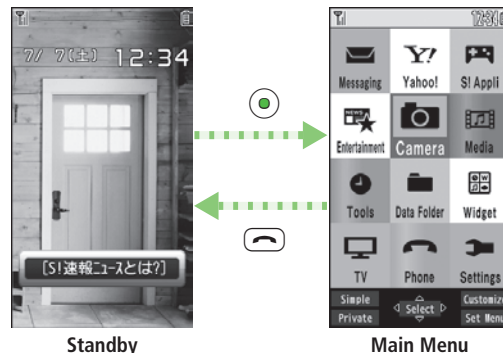

Handset Menus



- 1 In Standby, 
Main Menu appears.
- 2  to highlight an icon → [Select]
Selected function menu appears.
 - To return to Standby: 

Function List

Messaging

Incoming Mail
Create New
Retrieve New
Drafts
Templates
Sent/Unsent
Server Mail
Create New PC Mail
Create New SMS
Settings
Memory Status

Yahoo!

Yahoo! Keitai
Menu List
Bookmarks
Saved Pages
Web Search
Enter URL
History
PC Site Browser
Set Yahoo! Keitai
Reset

S! Appli

S! Appli List
S! Appli Settings
S! Appli History
Information

Entertainment

S! Info Ch./Weather
S! Quick News
Free Contents
S! Contents Store
Post Blog

Camera

Camera
Video Camera

Media

Music
Videos

Tools

Alarms
Calendar
Calculator
Notepad
Tasks
Sound Recorders

Barcode Reader
Location Settings
Bluetooth
Receive via Infrared
Music Player
microSD Backup
Templates/User Dic.

Data Folder

Pictures
Ring Songs&Tones
S! Appli
Widget
Music
Videos
TV
Books
Customized Screen
Templates
Font
Other Documents

Widget

Widget Store
Widget Contents
Settings

TV

Watch TV
Program List
Timer Watching
Timer Recording
Recording Result
TV Link
Channel List
Channel Setting
User Settings

Phone

Phone Book
Create New Entry
Call Log
Account Details
S! Addressbook BkUp
Group
Memory Manager
Restrictions
Settings
Memory Status

Settings

Sound Settings
Display Settings
Customized Screen
Incoming Settings
Phone Settings
Date & Time
Security
Call Settings
Video Call
International Call
Connectivity
Notification Light

Handset Security

USIM PINs

PIN	4 to 8-digit code used to prevent unauthorized handset use. <ul style="list-style-type: none">When PIN Authentication is ON, PIN entry is required each time handset is powered on (with USIM Card installed).
PIN2	Required for call cost setting.

- PIN and PIN2 are set to **9999** by default.

PIN Authentication

Main Menu ► **Settings** ► **Security** ► **PIN Authentication**

- Enter Phone Password → **PIN Authentication** → **ON** or **OFF** → Enter PIN

PIN/PIN2 Lock & Cancellation (PUK/PUK2)

PIN Lock or **PIN2 Lock** is activated if **PIN** or **PIN2** is incorrectly entered three times. Cancel **PIN Lock** or **PIN2 Lock** by entering **PIN Unblocking Key (PUK/PUK2)**.

- For information about PUK/PUK2, contact SoftBank Customer Support, General Information (☎ P.9-21).

Note

- If PUK/PUK2 is incorrectly entered ten times, USIM Card is locked and handset is disabled. Write down PUK/PUK2.
- For USIM Card recovery, contact SoftBank Customer Support, General Information (☎ P.9-21).

Passwords

The following passwords are required for handset use.

Phone Password	4 to 8-digit number required to use/change some handset functions. (9999 by default.)
Center Access Code (Security Code)	4-digit number specified at initial subscription; required to access optional services via landlines, set Call Restrictions, subscribe to paid content.

- Enter number within 15 seconds. _ appears for each digit entered.
- Do not forget Phone Password/Center Access Code (Security Code). For password recovery, contact SoftBank Customer Support, General Information (☎ P.9-21).
- Do not reveal Phone Password/Center Access Code (Security Code). SoftBank Mobile is not liable for misuse or damages.

Note

- If entered incorrectly, an error message appears. Reenter the password.
- If Center Access Code (Security Code) is entered incorrectly three times, Call Barring settings lock; Center Access Code (Security Code) must be changed. For details, contact SoftBank Customer Support, General Information (☎ P.9-21).
- If Security Code has been changed on handset, enter the number to activate/cancel Call Barring.

Change Phone Password

> **Main Menu** ► **Settings** ► **Security** ► **Change Phone Password** ►

Enter current Phone Password ► Enter new Phone Password ► **YES**

Mobile Manners

Minding Mobile Manners



Please use your handset responsibly. Inappropriate handset use can be both dangerous and bothersome.

- Power off handset in theaters, museums and other places where silence is the norm.
- Refrain from use in restaurants, lobbies, elevators, etc.
- Observe signs and instructions regarding handset use aboard trains, etc.
- Refrain from use that interrupts the flow of pedestrian or vehicle traffic.

Manner-related Features

Manner Mode	Mute handset tones and activate Vibration for incoming transmissions.
Vibration	Activate in public places, meetings, etc. for silent call/message alerts.
Ringer Volume	Adjust call/message tones, etc.
Offline Mode	Suspend all handset transmissions.
Answer Phone	Use to handle incoming calls when inappropriate/unsafe to answer.
Driving Mode	While driving, send a voice message informing the caller that you cannot answer the call. (Handset does not ring.)

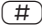
Manner Mode



- 1 In Standby, Press and Hold 
 appears.
 - To cancel: Press and Hold  again

Offline Mode

Main Menu ► Settings ► Call Settings ► Offline Mode

- 1 **YES**
 appears.
 - To cancel: Follow the same steps

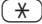
Driving Mode

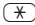
- 1 In Standby, Press and Hold 
 appears.
 - To cancel: Press and Hold  again