



008Z User Guide

008Z User Guide Contents

Introduction	
Introduction.....	2
Getting Started	
Package Contents.....	4
Parts & Functions.....	4
USIM Card Installation.....	5
SD Card Installation.....	7
Battery Installation.....	9
Charging Battery.....	10
Power On/Off.....	11
Touchscreen Operations.....	12
Basic Operations	
Basic Operations.....	14
Handset Language.....	15
Home Application.....	15
Security Codes.....	16
Handset Interface	
Home Screen Basics.....	18
Status Bar.....	18
Notifications Window.....	19
Phone	
Calling.....	22
Optional Services.....	22
Appendix	
Specifications.....	24
Customer Service.....	24
Safety Precautions	
Safety Precautions.....	26
General Notes.....	33

Introduction

Thank you for purchasing SoftBank 008Z.

Before You Begin

- SoftBank 008Z is referred to as "handset" in this guide.
- Read "Safety Precautions" and this guide thoroughly beforehand for proper usage.
- Accessible services may be limited by contract conditions or service area
- Unauthorized copying of any part of this guide is prohibited.
- Guide content subject to change without prior notice.
- Contact [SoftBank Customer Support](#), General Information if you find inaccuracies.

Guide Usage Notes

- Most operation descriptions are based on default settings.
- Unless noted otherwise, descriptions are for Home Screen.
- Some operation descriptions may be omitted.
- In this guide and on handset, "abroad" means "outside Japan" with regard to handset/service usage.
- In this guide, microSD/microSDHC Card is referred to as "SD Card."

Screenshots & Key Labels

Screenshots and Key labels are provided for reference only. Actual handset windows, menus, etc. may differ in appearance.

Getting Started

Package Contents.....	4
Parts & Functions.....	4
USIM Card Installation.....	5
SD Card Installation.....	7
Battery Installation.....	9
Charging Battery.....	10
Power On/Off.....	11
Touchscreen Operations.....	12

Package Contents

Package Contents

- Handset (SoftBank 008Z)
- Battery (ZEBAG1)
- AC Adapter (ZECAD1)
- Micro USB Cable (ZEDAD1)
- 3.5mm Headset with Mic (ZELAD1)
- microSD Card (Complimentary Sample)
- Quick Start (Japanese)
- Safety Precautions (Japanese)
- Warranty (Japanese) [008Z, AC Adapter]

Parts & Functions

Front/Top/Bottom

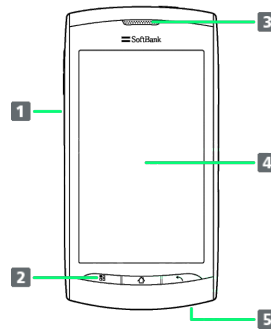

Part	Description
1 External Device Port	Connect Micro USB Cable here
2 Notification Lamp	Lights/blinks to indicate handset status
3 Receiver	Other party's voice sounds here for calls
4 Touchscreen Display	Touch to operate
5 Mic	Speak here for calls

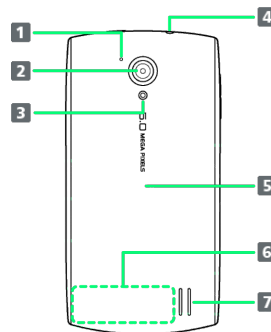

Part	Description
1 Noise Cancellation Port	Clarify other party's voice
2 Camera	Capture images
3 Light	Use as camera flash
4 3.5 mm Audio Jack	Connect headphones
5 Battery Cover	Access SD/USIM Card or battery
6 Internal Antenna	Conducts handset transmissions
7 Speaker	Ringer and Speakerphone sound from here

Handset Keys

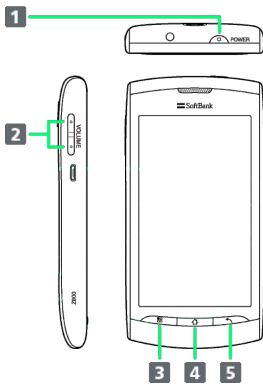

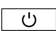
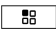
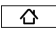
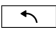
Part	Description
1 	Toggle Display Backlight on/off Long Press for Power on/Phone options
2 Volume	Adjust Volume
3 	Show Menu options
4 	Return to Home Screen Long Press for recent apps
5 	Go Back/Escape

USIM Card Installation

USIM Card IC chip contains customer and authentication information, including handset number.

Inserting USIM Card

1

Remove Battery Cover



· Use notch to lift Cover, then remove it.

2

Remove battery

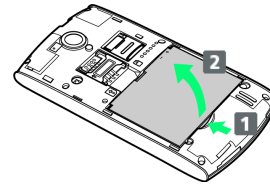

· Press **1** and lift out **2**.

3

Insert USIM Card

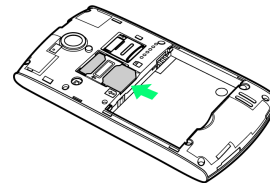

· Slide in USIM Card with IC chip down.

4

Insert battery

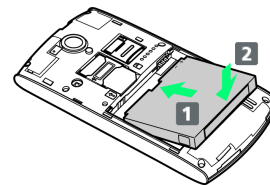

· Slide battery into place as shown.

5

Close Battery Cover

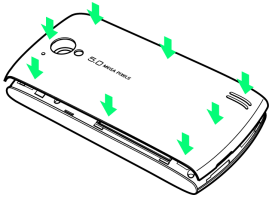

- Close Cover completely leaving no gaps.

Removing USIM Card

1

Remove Battery Cover



- Use notch to lift Cover, then remove it.

2

Remove battery

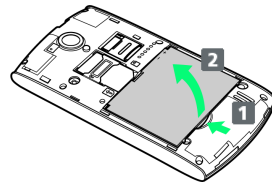

- Press **1** and lift out **2**.

3

Remove USIM Card

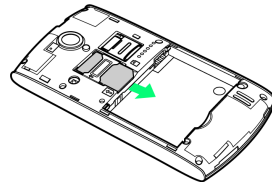

4

Insert battery

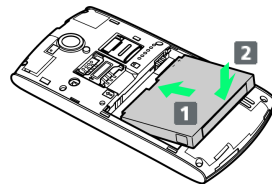

- Slide battery into place as shown.

5

Close Battery Cover

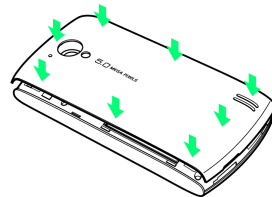

- Close Cover completely leaving no gaps.

SD Card Installation

Handset accepts microSDHC/microSD Cards (hereafter, SD Card) up to 32 GB. Some SD Cards may not operate properly.

Inserting SD Card

Always power off first.

1

Remove Battery Cover



· Use notch to lift Cover, then remove it.

2

Unlock Holder

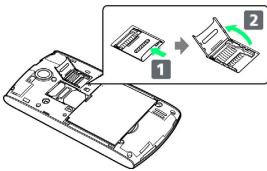

· Slide Holder **1** and lift it **2**.

3

Insert SD Card

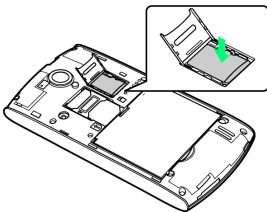

· Slide in SD Card as shown.
· Do not insert other objects.

4

Lock Holder

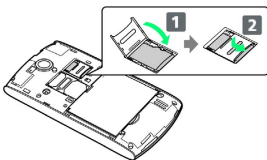

5

Close Battery Cover

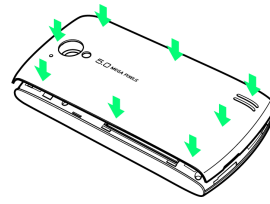

· Close Cover completely leaving no gaps.

Removing SD Card

Always perform Unmount SD Card, then power off first.

1

Remove Battery Cover



· Use notch to lift Cover, then remove it.

2

Unlock Holder

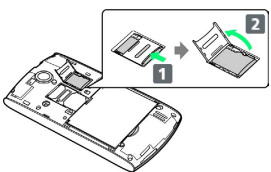

· Slide Holder **1** and lift it **2**.

3

Remove SD Card

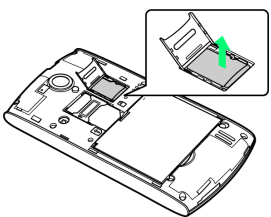

4

Lock Holder

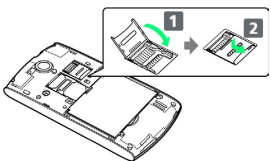

5

Close Battery Cover

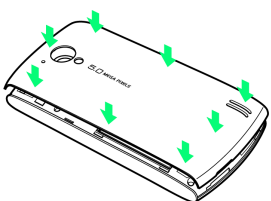

· Close Cover completely leaving no gaps.

Formatting SD Card

When using a new SD Card for the first time, format it on handset before trying to save files, etc.

- Format Card deletes all SD Card files, even those created on other devices.
- Charge battery or install a charged battery beforehand.

1

In Home Screen,   詳細設定 (Settings)



2

Storage

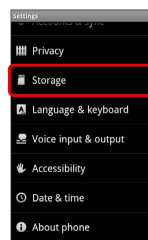

3

Unmount SD card

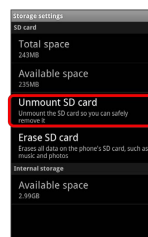

 Menu item changes from **Unmount SD card** to **Mount SD card**.

4

OK  Erase SD card

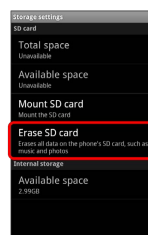

5

Erase SD card

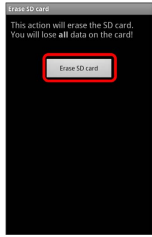

6

Erase everything

 Formatting starts.

Important SD Card Usage Notes

Saving Files on SD Card

SoftBank Mobile is not liable for any damages resulting from accidental loss/alteration of information. Keep a copy of contacts, etc. in a separate place. Never power off or remove battery while files are being accessed.

Battery Charge Level

SD Card may not read/write files correctly if battery is low.

Battery Installation

Always power off before removing battery.

Inserting Battery

1

Remove Battery Cover



· Use notch to lift Cover, then remove it.

2

Insert battery

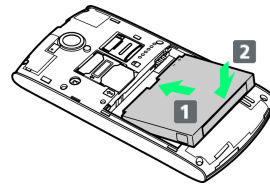

· Slide battery into place as shown.

3

Close Battery Cover

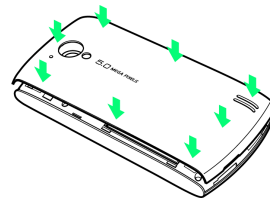

· Close Cover completely leaving no gaps.

Removing Battery

1

Remove Battery Cover



· Use notch to lift Cover, then remove it.

2

Remove battery

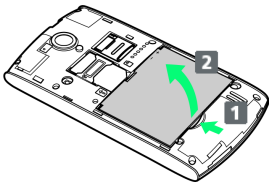

· Press **1** and lift out **2**.

3

Close Battery Cover

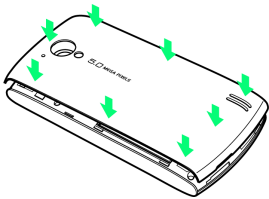

· Close Cover completely leaving no gaps.

! Battery Cautions

Battery Care

Charge battery at least once every six months; uncharged battery may die or affect files/settings.

Bulges

Depending on usage, bulges may appear near end of battery life; this does not affect safety.

Replacing Battery

Replace battery if operating time shortens noticeably.

Cleaning Charging Terminals

Clean Device Charging Terminals with dry cotton swabs.

Lithium-ion Battery

This product requires a lithium-ion battery. Lithium-ion batteries are recyclable. To recycle a used lithium-ion battery, take it to any shop displaying the recycling symbol.

Charging Battery

Battery must be inserted in handset to charge it.

Charger

1

Connect USB plug to AC Adapter

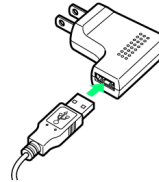

2

Connect Micro USB Cable

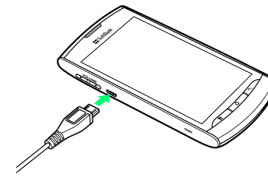

3

Plug in Charger

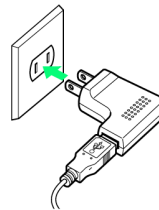

! Notification Lamp illuminates while charging.

4

Unplug Charger

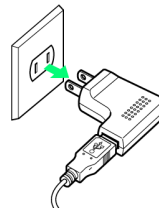

· Unplug Charger and disconnect handset.

USB Charging

- Power on handset and PC first.
- Battery may not charge or charge slowly depending on PC status/environment.

1

Connect Micro USB Cable

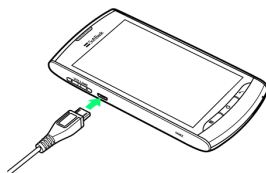

2

Connect Micro USB Cable to PC USB port

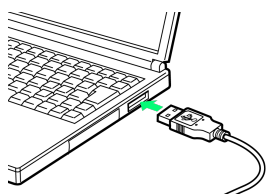

3

Disconnect handset from Micro USB Cable

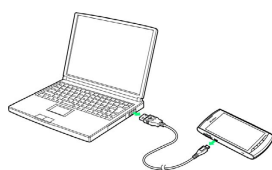



Power On/Off

Power On

1

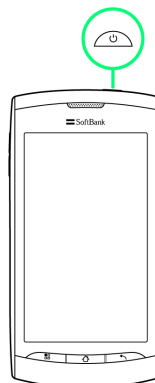
 (Long Press)



 Home Screen appears.

- Initial setup menu opens before Home Screen appears after powering on for the first time.

Power Off

1

 (Long Press)

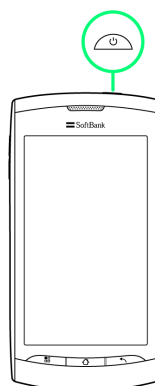

2

Power off  OK



 Handset shuts down.

Touchscreen Operations

Touch Display to select menu items, open functions, scroll pages, etc.

Tap

Tap item or key to open or execute corresponding function/operation.

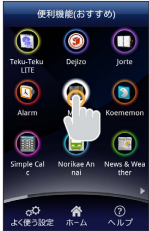

Touch & Hold

Touch item for 1+ seconds to move icons, open menus, etc.



Drag

Drag item (e.g., Touch Panel unlock slider) to move it.

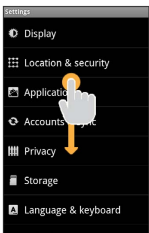

Swipe/Flick

Swipe/Flick to toggle sheets, pages, etc.

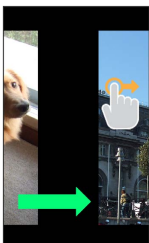

Pinch/Spread

Spread or Pinch fingers to zoom in or out on images, etc.

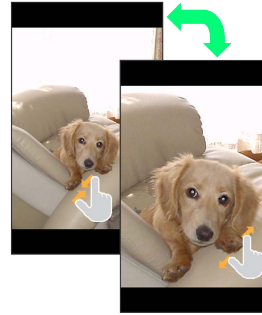

Basic Operations

Basic Operations.....	14
Handset Language.....	15
Home Application.....	15
Security Codes.....	16

Basic Operations

Home Screen & Launcher

Home Screen top sheet appears at power on. Most handset operations start from Home Screen sheets or Launcher pages. If preinstalled シンプルホーム (Simple Home) application is enabled, some sheet/page icon labels, etc. appear in Japanese even if handset language is set to English. To disable シンプルホーム application, see [Changing Home Screen to English](#).



Handset Navigation

Tap menu items, icons, onscreen Key, etc. to open assigned items.

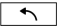
- Press  to go back or escape.

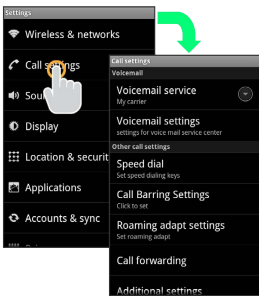

Menu Operations

Press  for options. Alternatively, Touch & Hold Display for settings.

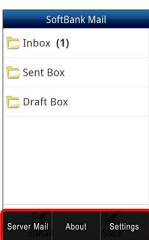

Handset Settings

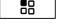
In Home Screen, Press  and Tap **詳細設定** (Settings) to customize settings.



Handset & Display Orientation

In most cases, Display orientation changes with handset orientation.

- Some application content may not change with handset orientation.

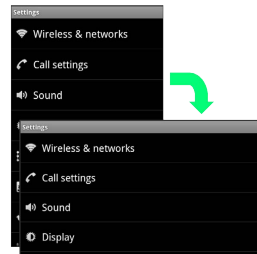

Handset Language

Language Setting

1

In Home Screen,  → **詳細設定** (Settings)



2

言語とキーボード



3

言語を選択 → Select language



 Language is set.

Home Application

Changing Home Screen to English

シンプルホーム (Simple Home) application is preinstalled; while enabled, Home Screen sheets appear in Japanese even after changing handset language to English. After selecting English, disable シンプルホーム for English Home Screen.

1

In Home Screen,  → **詳細設定** (Settings)



2

Applications

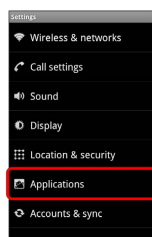

3

Manage applications

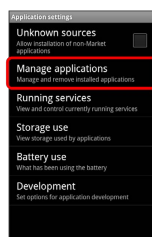

4

All → **シンプルホーム**



5

Clear defaults

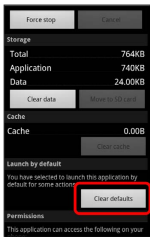

6



 Launcher

 Home Screen is changed.

- Select Use by default for this action () to make selected setting the default setting.

Security Codes

Code Types

Some functions/services require these codes for use.

- Do not reveal Security Codes. SoftBank Mobile is not liable for misuse or damages.
- If you forget Security Codes, contact us for recovery. For more information, see [SoftBank Mobile Website \(http://mb.softbank.jp/en/\)](http://mb.softbank.jp/en/).

Types	Details
Center Access Code	4-digit code in contract: Change services; use Optional Services via landlines; or set call restrictions

Handset Interface

Home Screen Basics.....	18
Status Bar.....	18
Notifications Window.....	19

Home Screen Basics

Home Screen (Japanese by default) top sheet appears at power on; most operations start here. For English sheet/page icon labels, etc., see [Changing Home Screen to English](#).

Layout



- 1 Status Bar
- 2 Tap to open application

Toggling Home Screen Sheets

Home Screen consist of five sheets. Add shortcuts, widgets or folders to sheets. Swipe or Flick left/right to toggle Home Screen sheets.

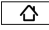
In any Home Screen sheet, Press  to return to Home Screen top sheet.



Status Bar

Status Bar appears at the top of Display.

















Status Bar



- 1 Notifications Icons
- 2 Status Indicators





















Notifications Icons

These Notification icons appear in Notification window:

Icon	Description
	New Gmail
	New Email
	New SMS/S! Mail
	New Voicemail
	Music Playing
	Wi-Fi Available
	USB Connected
	New Tweet
	Call in Progress
	Missed Call
	Call on Hold
	Call Forwarded
	Data Uploading
	Data Downloading
	Installation Complete
	App Update Available
	SD Card Unmounted

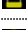
Status Indicators

These Status indicators appear in Status Bar:

Indicator	Description
	3G Data in Use
	GSM Data in Use
	HSPA Data in Use
	Wi-Fi Connected
	Bluetooth® On
	Bluetooth® Connected
	Airplane mode
	Alarm Set
	Speakerphone On
	Signal Strength
	Roaming
	No Signal
	No USIM
	Manner Mode Active
	Mic Muted
	Charge Battery
	Battery Low
	Battery Charged
	Battery Charging
	Headphones Connected

Notifications Window

Open notifications (missed call, etc.), check handset status or change various settings.

Opening Notifications Window

1

In Home Screen, Tap Status Bar



 Notifications window opens.

+ Closing Notifications Window

Touch Display bottom and Drag up to close Notifications window.

· Alternatively, Press  to close Notifications window.

Phone

Calling.....	22
Optional Services.....	22

Calling

Learn calling basics for incoming calls.

Answering Calls

1

To connect call, Drag  right

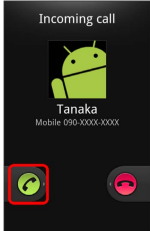

 Talk.

2

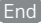
To end the call 

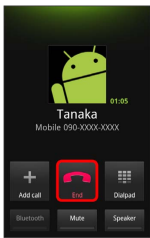

 Call ends.

Emergency Location Report

Using SoftBank 3G handset for emergency calls (110, 119 or 118) automatically reports handset location to corresponding agency (police, etc.)

- Location Report does not incur registration/transmission fees.
- Location/signal conditions affect positioning accuracy. Always provide location and call purpose.
- Hiding Caller ID (using 184, etc.) cancels Location Report. However, corresponding agency may obtain location information in life threatening situations.
- Location Report is not sent for calls made while outside Japan.

Emergency Location Report Cautions

Emergency Location Report is not sent in Airplane Mode.

Optional Services

This handset is compatible with SoftBank Optional Services.

Optional Services

Use these SoftBank Optional Services:

Service	Description
Call Forwarding	Divert all/all unanswered calls to a preset number
Voicemail	Divert all/unanswered calls to Voicemail Center; access messages via handset/touchtone phones
Call Waiting ¹	Answer calls or open another line during a call
Group Calling ¹	Switch between open lines/connect multiple lines
Call Barring	Restrict incoming/outgoing calls by conditions
Caller ID	Show or hide your number when placing calls

¹ Requires separate subscription.

Appendix

Specifications.....	24
Customer Service.....	24

Specifications

Model

Item	Description
System Information	Processor: Qualcomm MSM8255 Memory: 4GB (ROM), 512MB(RAM)
Dimensions (W x H x D) ¹	62×119×13 mm
Weight ¹	Handset alone: 110 g Battery installed: 133 g
Maximum Output	3G: 0.25 W GSM 900: 2 W GSM 1900: 1 W
Continuous Talk Time ¹	3G: 550 minutes GSM: 300 minutes
Continuous Standby Time ¹	3G: 450 hours GSM: 300 hours
Display	LCD: 3.8 inch touch-sensitive TFT Resolution: WVGA (480×800)/65,536 colors
Camera	Sensor: CMOS Effective Pixels ¹ : 5.03 million pixels Digital Zoom ¹ : Up to 1.6 times
Charging Time ¹	AC Charger: 210 minutes USB Charging: 300 minutes

¹ Approximate value

Battery

Item	Description
Voltage	3.7 V
Type	Lithium-ion
Capacity	1500 mAh
Dimensions (W x H x D) ¹	52×41×6.6 mm

¹ Approximate value

Customer Service

For SoftBank handset or service information, call General Information. For repairs, call Customer Assistance.

SoftBank Customer Support

General Information

From a SoftBank handset, dial toll free at 157
Call toll free from landlines at 0800-919-0157

Customer Assistance

From a SoftBank handset, dial toll free at 113
Call toll free from landlines at 0800-919-0113
If you cannot reach a toll free number, use the number (charges apply) below for your service area:
Hokkaido Area, Tohoku Area, Hokuriku Area, Kanto, Koshinetsu Area : 022-380-4380
Tokai Area : 052-388-2002
Kansai Area : 06-7669-0180
Chugoku, Shikoku Area, Kyushu, Okinawa Area : 092-687-0010

Smartphone Technical Support Center

From a SoftBank handset, dial toll free at 151
From a landline/IP phone, dial toll free at 0800-1700-151

SoftBank Mobile Global Call Center

From outside Japan, dial +81-3-5351-3491 (toll free from SoftBank handsets)

If handset is lost/stolen, call this number immediately (international charges apply)

Safety Precautions

Safety Precautions.....	26
General Notes.....	33

Safety Precautions



For proper handset use, carefully read Safety Precautions beforehand. Keep this guide for future reference.

Observe these safety precautions to prevent injury or damage to property.

SoftBank accepts no liability for any loss or damages incurred by you or a third party as a result of missed calls, etc., due to malfunction, erroneous operation or failure of this product.

Labels







Risks of injury or damage from improper use are categorized by levels. Understand these labels before reading this guide.

Label	Description
 DANGER	Great risk of death or serious injury ¹ from improper use
 WARNING	Risk of death or serious injury ¹ from improper use
 CAUTION	Risk of injury ² or damage to property ³ from improper use

- 1 Serious injury includes: Loss of eyesight, physical injury, high temperature burns, low temperature burns, electric shock, fractures, poisoning and other conditions having side effects or requiring hospitalization or longterm treatment.
- 2 Injury includes: Physical burns (high-temperature and low-temperature), electric shock, and other conditions not requiring hospitalization or long-term treatment.
- 3 Damage to property includes: Incidental damage to structures and household property and/or to pets and livestock.

Symbols

Make sure you understand the following symbols and precautions before reading this guide.

Symbol	Description
	Action prohibited
	Disassembly prohibited
	Exposure to liquids prohibited
	Handling with wet hands prohibited
	Action compulsory
	Unplug power cord

Handset, Battery, USIM Card, AC Adapter, Micro USB Cable, 3.5 mm Headset with Mic & SD Card (Sample)

DANGER



Compulsory

Use SoftBank specified devices (battery, AC Adapter or Micro USB Cable) only.

Use of non-specified devices may cause battery to leak, overheat, rupture or ignite; or may cause Charger to overheat, ignite or malfunction.



Do Not Disassemble

Do not disassemble/modify/solder handset.

May cause fire, injury, electric shock or malfunction. Also, battery may leak, overheat, rupture or ignite.

Modifying handset is a violation of the Radio Law and subject to penalty.



Avoid Liquids Or Moisture

Keep liquids away from handset.

If handset or battery is not dried after exposure to fluids (water, pet urine etc.), or battery is charged while wet, overheating, electric shock, fire, injury, malfunction, etc. may occur. Be careful of where used or handled.



Prohibited

Do not charge, use or leave handset in places subject to high temperatures (near an open flame or heating equipment, in direct sunlight or inside a car on a hot day).

May cause deformation or malfunction; or may cause battery to leak, overheat, ignite or rupture. Also, the outer housing may become hot resulting in burns.



Prohibited

Do not use excessive force to attach battery, AC Adapter, Micro USB Cable or 3.5 mm Headset with Mic to handset. Battery or AC Charger may be the wrong way around.

Battery may leak, overheat, rupture or ignite.

⚠ WARNING



Do not place handset, battery, AC Adapter, Micro USB Cable or 3.5 mm Headset with Mic in a microwave oven or pressure cooker, or on an induction cooktop.

May cause battery to leak, overheat, rupture or ignite; or may cause handset, AC Adapter, Micro USB Cable or 3.5 mm Headset with Mic to overheat, emit smoke, ignite or malfunction.



Turn off handset when entering gas stations or other places where flammable gases (propane gas, gasoline, etc.) or fine particulates generate. Be sure to turn off handset beforehand. Do not charge battery in such places.

Gases may ignite.
Using handset near petrochemicals or other flammables may cause fire or explosion.



Do not drop/throw handset or expose it to excessive shock.

May cause battery to leak, overheat, rupture or ignite; or may cause fire, electric shock or malfunction.



If you notice an unusual sound, odor, smoke, etc. while using, charging or storing handset, immediately:

1. Unplug AC Adapter from outlet.
2. Turn handset power off.
3. Remove battery from handset, being careful of burn or injury.

Continued use may cause fire or electric shock.



Keep liquids (water, pet urine, etc.) and conductive materials (e.g. pencil lead, metal fragments, metal necklaces, hairpins, etc.) away from 3.5 mm Audio Jack or External Device Port.

May cause short circuit, resulting in fire or malfunction.

⚠ CAUTION



Do not place handset on an uneven or unstable surface.

Handset may fall, leading to injuries or handset malfunction. Be particularly careful while charging or when vibrator is activated.



Keep handset out of reach of infants.

Failing to do so may result in small parts being accidentally swallowed or may cause injury.



When a child uses handset, parent supervision is advised.

Provide child with proper instructions. Failing to do so may cause injury, etc.

Battery

Check battery type on battery label. Properly use and dispose of battery according to type.

Label	Battery Type
Li-ion	Lithium-ion

⚠ DANGER

Prohibited

Do not dispose of battery in fire.

May cause battery to leak, rupture or ignite.



Prohibited

Do not damage (nail, hammer, stomp, etc.) battery or subject it to strong impacts/shocks.

May cause battery to leak, overheat, rupture or ignite.



Prohibited

Keep metal objects (pins, etc.) away from battery terminals. Do not carry or store conductive materials (e.g. pencil lead, metal fragments, metal necklaces, hairpins, etc.) together with battery.

May cause battery to leak, overheat, rupture or ignite.



Compulsory

If battery fluid gets into eyes, immediately rinse with clean water and consult a doctor. Do not rub eyes.

Failing to do so may result in loss of eyesight.

⚠ WARNING

Compulsory

If battery fluid gets on your skin or clothing, immediately stop handset use and rinse with clean water.

Battery fluid may harm your skin.



Compulsory

If battery is not fully charged even after specified charging time, stop charging.

Battery may leak, overheat, rupture or ignite.



Compulsory

If you notice an unusual odor, overheating, discoloration, deformation, etc. while using, charging or storing battery, remove it from handset and keep it away from fire. Be careful not to burn or injure yourself.

Continued use may cause battery to leak, overheat, rupture or ignite.

⚠ CAUTION

Prohibited

Do not dispose of battery as municipal waste.

Bring used battery to a SoftBank Shop or recycling center after insulating the terminals with tape. Be sure to observe local regulations on battery disposal.

Handset

WARNING



Prohibited

Do not use while operating a vehicle (car, motorcycle, bicycle, etc.)

May cause a traffic accident. Use of a mobile phone while driving is prohibited by law, and is subject to penalty. Stop vehicle in a safe location (where parking is allowed) before using handset.



Compulsory

Follow the instructions below when installing and wiring in-vehicle devices.

- Make sure that devices do not interfere with driving and safety equipment such as airbags
- Make sure that wires are not caught in seatbelt buckles, doors or other moving parts

Any wire caught around a foot, brake pedal, accelerator pedal, etc. may interfere with driving and cause a traffic accident. If any part of an in-vehicle device drops onto the floor, it may startle you into abrupt braking or steering, leading to a traffic accident.



Compulsory

Check your surroundings to confirm that it is safe to make/receive calls, send/receive messages, take pictures or record videos.

Failing to do so may cause you to trip over or cause a traffic accident.



Prohibited

Do not sit down with handset in your trousers pocket.

Excess weight may damage Display, battery or other parts resulting in overheating, fire or injury.



Compulsory

Keep handset power off near high precision electronic devices or devices using weak signals.

Handset may cause these devices to malfunction.

Devices that may be affected:

Hearing aids, implanted cardiac pacemakers, implanted defibrillators and other electronic medical equipment; fire alarms, automatic doors and other automatic control devices.



Compulsory

Keep handset power off aboard aircraft.

When in-flight use is permitted, observe airline instructions.



Compulsory

If you have a weak heart, be careful with incoming call vibrator and ringtone volume settings.

These may affect your heart.



Compulsory

If thunder is heard while outside, immediately turn handset power off and seek shelter.

Failing to do so may attract lightning and cause electric shock.

⚠ CAUTION

Prohibited

Do not use handset in a vehicle if it affects in-vehicle electronic devices.

Use of handset in some types of vehicles may, in some rare cases, affect in-vehicle electronic devices and interfere with safe driving.



Prohibited

Do not turn on or shine Light near someone's eyes. Do not look directly at Light when it is on. Also do not point Light at someone else and turn it on.

May cause harm such as loss of eyesight. Especially, do not photograph infants up close. May also temporarily affect eyesight or startle, leading to injury or other accident.



Compulsory

If skin abnormality occurs with use of handset, immediately discontinue use and consult a doctor.

Handset contains metals, etc. Depending on your physical condition, you may experience itchiness, rash, etc.

For more information, see [Materials](#).



Prohibited

Keep magnetic cards, etc. away from handset.

Failing to do so may cause magnetic data on a cash card, credit card, telephone card or floppy disk to be lost.



Compulsory

Handset may become hot during prolonged use.

Skin contact for extended period may cause low-temperature burns.



Prohibited

Always maintain some distance from Speaker while ringtones, music or other handset sounds play.

Excessive volume may damage hearing.



Compulsory

Do not turn volume up too high when using earphones.

Using earphones for extended periods at high volume may impair hearing or sudden loud sound may harm your ears.

USIM Card & SD Card (Sample)**⚠ CAUTION**

Prohibited

Do not insert objects other than SD Card into SD Card Slot.

Doing so may cause overheating, electric shock or malfunction.



Prohibited

Do not subject SD Card to vibration or shock or remove it from Slot or turn off handset while data is being written to or read from SD Card.

Doing so may cause data loss or malfunction.



Prohibited

Use only SD Card supported by handset.

Failing to do so may cause data loss or malfunction.

Handset supports SD Card with a storage capacity of up to 32 GB.



Prohibited

Do not use excessive force when inserting or removing USIM Card.

Doing so may cause a malfunction. Be careful not to injure a hand or finger when removing USIM Card.



Prohibited

Insert specified USIM Card only.

Using other SIM cards may cause malfunction/data loss.

AC Adapter & Micro USB Cable

WARNING



Prohibited

Do not cover or wrap with clothing or bedding during charging.

Heat may build up resulting in fire or malfunction.



Prohibited

Use the specified power supply and voltage.

Failing to do so may cause fire or malfunction.

AC Adapter: 100 to 240 V AC (for household AC outlets only)

Also, do not use commercially available voltage converters, as when travelling.

May cause fire, electric shock or malfunction.



Disconnect Power Source

Hold plug and unplug AC Adapter from outlet before extended periods of handset disuse.

Failing to do so may cause electric shock, fire or malfunction.



Disconnect Power Source

If liquid (water, pet urine, etc.) gets into AC Adapter, immediately hold plug and unplug AC Adapter from outlet.

Failing to do so may cause electric shock, smoke emission or fire.



Compulsory

If dust accumulates on AC Adapter plug, hold plug and unplug AC Adapter from outlet and wipe with a dry cloth.

Failing to do so may cause fire.



Compulsory

When plugging AC Adapter into outlet, keep conductive materials (pencil lead, metal parts, necklaces, hair pins, etc.) away from AC Adapter plug/Micro USB Cable terminals and plug AC Adapter firmly into outlet.

Failing to do so may cause electric shock, short circuit, fire, etc.



Do Not Use Wet Hands

Do not plug/unplug AC Adapter with wet hands.

May cause electric shock or malfunction.



Prohibited

If thunder is audible, do not touch AC Adapter.

May cause electric shock.

CAUTION



Disconnect Power Source

Firmly hold plug and unplug AC Adapter from outlet before cleaning.

Failing to do so may cause electric shock.



Compulsory

Do not unplug AC Adapter by pulling the cord. Firmly hold plug and unplug AC Adapter.

Pulling the cord may damage the cord resulting in electric shock or fire.



Prohibited

When AC Adapter is connected to an outlet, do not pull on cord or otherwise subject AC Adapter to strong shock.

May cause injury or malfunction.



Prohibited

Do not touch handset with sweaty hands or place it into a pocket of sweaty clothes.

Sweat and humidity may erode the internal components of handset and cause overheating or malfunction.



Prohibited

Do not pull, bend with excessive force or twist Micro USB Cable.

Do not damage or modify Micro USB Cable. Do not place objects on Micro USB Cable. Do not apply heat and keep Micro USB Cable away from heaters.

Damage to Micro USB Cable may cause electric shock, overheating or fire.

Handset Use & Electronic Medical Equipment

This section is based on “Guidelines on Safeguarding Medical Equipment from Electromagnetic Waves from Mobile Phones and Other Devices” (Electromagnetic Compatibility Conference Japan), and “Research Report on the Influence of Electromagnetic Waves on Medical Equipment” (Association of Radio Industries and Businesses, March 2001).

WARNING



Compulsory

Keep handset a minimum of 22 centimeters from implanted cardiac pacemaker or implanted defibrillator.

Radio waves may interfere with the operation of implanted cardiac pacemakers or implanted defibrillators.



Compulsory

When using electronic medical equipment (other than implanted cardiac pacemakers/defibrillators) outside of medical institutions, consult device manufacturer about the influence of radio waves.

Radio waves may interfere with the operation of electronic medical equipment.



Compulsory

Handset radio waves may affect electronic medical equipment. Observe these guidelines in medical institutions:

- Do not bring handset into an operating room, ICU (Intensive Care Unit) or CCU (Coronary Care Unit).
- Turn off handset in hospital wards.
- Turn off handset even in lobbies or areas where use is permitted if there is electronic medical equipment nearby.
- Observe the instructions of individual medical institutions and do not use or bring handset into prohibited areas.



Compulsory

Keep handset power off in crowded places such as rush hour trains; a person with an implanted cardiac pacemaker or implanted defibrillator may be nearby.

Radio waves may interfere with the operation of implanted cardiac pacemakers or implanted defibrillators.

Materials

· 008Z

Parts	Material/Finishing
Outer Case (Display side)	PC + ABS resin/UV coating
Outer Case (side)	PC resin (GF-20) /UV coating
Outer Case (Battery Cover) , Volume Key	PC resin/UV coating
Display/ Touchscreen, Camera Panel	Glass
Camera Ring	Aluminum
Light, Home Key, Menu Key, Back Key	PMMA resin
Power Key	PC resin/NCVM
Receiver	Stainless steel/NCVM
Speaker	Cloth
External Device Port, Screws	Stainless steel
3.5 mm Audio Jack	Copper alloy
SD Card Holder, USIM Card Holder	PC resin (GF-10)

· Battery (ZEBAG1)

Parts	Material/Finishing
Outer Case	PET resin
Terminals	Nickel/gold plating

· AC Adapter (ZECAD1)

Parts	Material/Finishing
Outer Case	PC + ABS resin
Plug	Copper + nickel plating
Terminals	Copper + gold plating

· Micro USB Cable (ZEDAD1)

Parts	Material/Finishing
Outer Case	PVC resin
USB Terminal	Iron + nickel plating
Micro USB Terminal	stainless steel

· 3.5 mm Headset with Mic (ZELAD1)

Parts	Material/Finishing
Exterior (Terminal, Cable)	Elastomer resin
Exterior (Earphone)	ABS resin/UV coating
Terminals	Nickel
Mic	ABS resin
Earphone	SUS304 stainless steel

General Notes

Usage Basics

- Handset employs radio waves. Signals may be disrupted even within service areas if you are indoors, underground, inside a tunnel or inside a vehicle. If you move to a location with poor signal reception, a call may be suddenly cut off.
- When using handset in public places, take care not to annoy other people around you. Use of handset is prohibited in some public places such as in theaters or on buses and trains.
- Handset is a wireless station under Japanese Radio Law. You may be requested to submit your handset for inspection based on this law.
- Use of handset near a landline phone, TV or radio may affect the image and sound quality of the equipment.
- Handset employs a digital system to maintain a high level of communication quality even at very low signal levels. However, calls may be suddenly cut off when the signal strength becomes too weak.
- The digital system provides a high level of privacy protection. However, the possibility of someone eavesdropping on your conversation cannot be ruled out as long as radio waves are used.
- Data stored on handset may be corrupted or lost on the following occasions.
 - Handset is used improperly.
 - Handset is exposed to static electricity or electric noise.
 - Handset is turned off during operation.
 - Battery is completely discharged.
 - Handset malfunctions or is sent for repairs.

SoftBank accepts no liability whatsoever for the corruption or loss of stored data. Be sure to keep a separate memo of important data to limit damage caused by data corruption or loss to a minimum.

- Be sure to charge battery before using handset for the first time or if handset has not been used for a long time. When battery is stored for a long time, it discharges over time even if it is not used.
- When handset is used for extended periods of time, especially in high temperature conditions, handset surface could become hot. Please use caution when touching handset under such conditions.
- Prolonged use or repeatedly flashing Display or other light may adversely affect the body. If you feel discomfort or pain, immediately discontinue use and consult a doctor.
- When certain items are taken out of the country, documentation may be required to certify that the export of the items is not controlled, prohibited, or restricted by the Export Trade Control Order and Foreign Exchange Order. Basically, no such documentation is required if you take handset out of the country and bring it back for the purpose of personal use when going on vacations or short business trips. In some cases, however, an export permit may be required if handset is to be used by or transferred to anyone else.

Furthermore, a US government export permit may be required when taking handset to countries for which the US government has imposed export restrictions (Cuba, North Korea, Iran, Sudan, Syria).

For details on export laws, regulations and procedures, refer to the Web page of the Security Export Control Policy Division of the Ministry of Economy, Trade and Industry.

- If you use a hearing aid, handset usage may interfere with hearing aid performance. If there is any interference, consult with the manufacturer or distributor of the hearing aid.
- Turn off handset in or near places where explosives are handled. Handset use may lead to an explosion, or affect explosion devices.
- Do not forget a code you have set for unlocking Display. If you forget the code, handset must be taken to your nearest SoftBank Shop. All information and settings saved on handset will be erased.
- A variety of applications can be installed to handset from "Android Market™" provided by Google Inc. SoftBank makes no guarantee whatsoever with regard to the nature (quality, reliability, legality, suitability for a purpose, validity of information, accuracy, etc.) of these applications that you yourself have installed, or with regard to any problems (viruses, etc.) resulting from them.

Inside Cars

- Do not use handset while driving. Use of handset while driving is prohibited by law. Talking on handset using 3.5 mm Headset with Mic while driving may be subject to penalties in some prefectures.
- Before using handset, stop the vehicle in a safe area where parking or stopping is permitted.
- While driving, place handset in a safe place away from airbag compartments. Handset may cause airbag to deploy, resulting in injury.

Aboard Aircraft

- Keep handset power off aboard aircraft. When in-flight use is permitted, observe airline instructions.

Precautions

- Avoid exposing handset to rain, snow or high humidity. Handset, battery, AC Adapter, Micro USB Cable, 3.5 mm Headset with Mic and other optional accessories are not waterproof.
- Do not use handset in extreme temperatures, direct sunlight and humid or dusty places.
- Do not drop handset or subject it to excessive shock.
- To clean handset, wipe it with a dry soft cloth. Do not use alcohol, thinner, benzene or other solvents. Doing so may cause discoloration and remove the printed logo.
- When removing Battery Cover, do not touch gold portion of USIM Card Slot or Antenna. Doing so may cause handset to malfunction due to static electricity.
- Do not remove battery while handset power is on to avoid malfunction.
- If battery has been removed from handset or handset has not been charged for a long time, stored data and settings may be lost or altered. SoftBank accepts no liability whatsoever for any damages or loss resulting from such negligence.
- Battery is a consumable item employing lithium ions. Replace battery with a new one if the operation time becomes extremely short after it is fully charged. Buy a new battery designated for handset.
- Do not dispose of battery with municipal waste. Insulate the terminal with tape or place battery in a plastic bag and take it to the nearest SoftBank Shop or recycling center. Be sure to observe local regulations on battery disposal.



Li-ion

- When removing battery, be sure to insert finger in Finger Pocket and lift battery on one side. Forcefully removing battery may damage Terminals.
- Handset Display pixels may be missing or remain lit. This is not a defect or malfunction. If Display is left on for a long period of time, pictures may be permanently burned into it.
- Make sure 3.5 mm Headset with Mic is securely plugged into 3.5 mm Audio Jack. Failing to do so may generate noise on the other party's phone during calls.
- Do not turn the volume up too high while using 3.5 mm Headset with Mic. Exposure to high sound levels may impair hearing and prolonged use may cause hearing damage regardless of the volume level. Sound leakage may annoy other people and surrounding sounds may not be heard clearly when walking, resulting in an accident.
- Hold the plug and do not pull the cord when unplugging 3.5 mm Headset with Mic. Pulling the cord may cause damage or malfunction.
- Handset's Internal Antenna is built into the body and does not protrude. Signal sensitivity may be reduced by touching/covering the built-in Antenna area. Do not cover this area by affixing stickers or any other items. Doing so may prevent you from making/receiving calls, sending/receiving messages or accessing the Web.
- When you replace handset or send it for repair, messages and other data stored in handset cannot be transferred to another handset.
- Do not allow USIM Card to get wet or leave it in places of high humidity. Doing so may cause a malfunction.

- Do not drop USIM Card or subject it to excessive shock. Doing so may cause a malfunction.
- Do not bend USIM Card or place a heavy object on it. Doing so may cause a malfunction.
- Do not use or leave USIM Card in hot places such as near a fire or heater. Doing so may cause a malfunction.
- Avoid storing USIM Card in direct sunlight or hot and humid places. Failing to do so may cause a malfunction.
- Keep USIM Card out of infants' reach. Failing to do so may result in USIM Card being accidentally swallowed or cause an injury.
- Before using USIM Card, read the instruction manual of USIM Card thoroughly to ensure safe and proper operation.
- If handset freezes or acts in any similar manner, remove battery and replace it after waiting a few seconds.

Light

- Do not use Light in hot/cold temperatures or where there is much humidity. May shorten Light's usable life.
- Light has a usable life. Light will gradually dim as it is used repeatedly.

Camera

- Be sure to observe proper etiquette when using Camera.
- Do not expose Camera Lens to direct sunlight. Concentrated sunlight through Lens may cause handset to malfunction.
- Be sure to try taking and previewing pictures before using Camera on important occasions like wedding ceremonies.
- Do not commercially use or transfer pictures taken with Camera without the permission of the copyright holder (photographer), except for personal use.
- Do not use Camera in locations where taking photos and recording videos are prohibited.

Bluetooth®

- Handset supports the Bluetooth®-standard security function for secure Bluetooth® communication. However, be careful when using the Bluetooth® function, as security may be insufficient depending on settings.
- SoftBank accepts no liability for leak of data or information during communication using Bluetooth®.
- Use a headset, handsfree, audio and object push on handset. The audio/video remote control may be available for audio.
- Wireless Frequencies & Modulations
Bluetooth® and Wi-Fi frequency information appears on battery cavity label:
2.4: 2400MHz range
FH/DS/OF: FH-SS, DS-SS or OFDM modulation
1: maximum interference range of 10 m
4: maximum interference range of 40 m
■ ■ ■ : Utilizes 2400 - 2483.5 MHz band with mobile device bandwidth differentiation
*Available channels vary depending on the country. For use aboard aircraft, contact the airline beforehand.

2.4FH1/DS4/OF4

- Bluetooth® Cautions
The operating frequency band of the Bluetooth® device is used by industrial, scientific, consumer and medical equipment including microwave ovens, premises radio stations for identifying mobile units used in the manufacturing lines of plants (radio stations requiring a license), specified low power radio stations (radio stations requiring no license) and amateur radio stations (hereafter, "other radio stations").
1. Before handset use, be sure "other radio stations" are not in use nearby.
2. In the event of handset causing harmful radio wave interference with "other radio stations", promptly change the operating location or avoid radio wave interference by turning off the power, etc.
3. For further information, contact [SoftBank Customer Support](#).
- Use the Bluetooth® function only in Japan. Handset Bluetooth® complies with Japan radio standards and is certified. Outside Japan, confirm national laws regarding use, as use may be subject to penalty.

Wi-Fi (Wireless LAN)

· About Wi-Fi (Wireless LAN)

Do not use Wi-Fi (wireless LAN) near magnetic devices such as electrical appliances or AV/OA devices, or where there are electromagnetic waves.

- Magnetism or electrical noise may increase noise or disable communications (especially when using a microwave oven).
- When used near TV, radio, etc., reception interference may occur, or channels on the TV screen may be disturbed.
- If there are multiple Wi-Fi access points nearby and the same channel is used, search may not work correctly.

· 2.4 GHz Device Cautions

The operating frequency band of the Wi-Fi (Wireless LAN) device is used by industrial, scientific, consumer and medical equipment including microwave ovens, premises radio stations for identifying mobile units used in the manufacturing lines of plants (radio stations requiring a license), specified low power radio stations (radio stations requiring no license) and amateur radio stations (radio stations requiring a license).

1. Before using the device, confirm that premises radio stations for identifying mobile units, specified low power radio stations and amateur radio stations are not being operated nearby.
2. If the device causes harmful radio interference to premises radio stations for identifying mobile units, immediately change the frequency band or stop use, and contact [SoftBank Customer Support](#) for crosstalk avoidance, etc. (e.g. partition setup).
3. If the device causes radio interference to specified low power radio stations or amateur radio stations, contact [SoftBank Customer Support](#).

- Wi-Fi (Wireless LAN) is for use in Japan only. Handset Wi-Fi (Wireless LAN) complies with radio standards of Japan and is certified. Outside Japan, confirm national laws regarding use, as use may be subject to penalty.

SIM Unlock

This handset is SIM Lock Free. Unlock SIM to use handset with another provider's SIM card.

Restrictions and precautions apply when using another provider's SIM card. For information, see [SoftBank Mobile Website](#).

Copyrights

- Copyright laws protect sounds, images, computer programs, databases, other materials and copyright holders. Duplicated material is limited to private use only. Use of materials beyond this limit or without permission of copyright holders, such as by copying (including altering data format), modifying, transferring to anyone else, or making available over a network, may constitute copyright infringement, and be subject to criminal punishment. Comply with copyright laws when making copies with handset camera or using images captured with handset camera.

Portrait Rights

- Portrait rights protect individuals' right to refuse to be photographed or to refuse unauthorized publication/use of their photographs. Portrait rights consist of the right to privacy, which is applicable to all persons, and the right to publicity, which protects the interests of celebrities. Therefore, photographing others including celebrities and publicizing/distributing their photographs without permission is illegal; use handset camera responsibly.

Specific Absorption Rate (SAR)

This mobile phone 008Z meets the MIC's* technical regulation for exposure to radio waves.

The technical regulation established permitted levels of radio frequency energy, based on standards developed by independent scientific organizations through periodic and thorough evaluation of scientific studies.

The regulation employs a unit of measurement known as the Specific Absorption Rate, or SAR.

The SAR limit is 2 watts/kilogram (W/kg)** averaged over ten grams of tissue.

The limit includes a substantial safety margin designed to assure the safety of all persons, regardless of age and health. The value of the limit is equal to the international guidelines recommended by ICNIRP***.

All mobile phones should be confirmed to comply with the regulation, before they are available for sale to the public. The highest SAR value for this mobile phone is 0.527 W/kg when tested for use at the ear.

The test for SAR was conducted in accordance with MIC's testing procedure, using standard operating positions, with the phone transmitting at its highest permitted power level. While there may be differences between the SAR levels of various phones and at various positions, all phones meet MIC's technical regulation.

Although the SAR is determined at the highest certified power level, the actual SAR of the phone during operation can be well below the maximum value.

For more information about SAR, see the following websites:

- Ministry of Internal Affairs and Communications (MIC)
<http://www.tele.soumu.go.jp/e/sys/ele/body/index.htm>
- Association of Radio Industries and Businesses (ARIB)
<http://www.arib-emf.org/> (Japanese)

*Ministry of Internal Affairs and Communications

**The technical regulation is provided in Article 14-2 of the Ministry Ordinance Regulating Radio Equipment.

***International Commission on Non-Ionizing Radiation Protection

SoftBank's Body SAR Policy

For body worn operation, this mobile phone has been tested and meets RF exposure guidelines when used with an accessory containing no metal and positioning the handset a minimum 15 mm from the body. Use of other accessories may not ensure compliance with RF exposure guidelines.

For more information, see SOFTBANK MOBILE Corp. Website:

<http://www.softbankmobile.co.jp/ja/info/public/emf/emf02.html> (Japanese)

FCC RF Exposure Information

Your handset is a radio transmitter and receiver. It is designed and manufactured not to exceed the emission limits for exposure to radio frequency (RF) energy set by the Federal Communications Commission of the U.S. Government.

The guidelines are based on standards that were developed by independent scientific organization through periodic and thorough evaluation of scientific studies. The standards include a substantial safety margin designed to assure the safety of all persons, regardless of age and health.

The exposure standard for wireless handsets employs a unit of measurement known as the Specific Absorption Rate, or SAR. The SAR limit set by the FCC is 1.6 W/kg. The tests are performed in positions and locations (e.g. at the ear and worn on the body) as required by the FCC for each model.

The highest SAR value for this model handset as reported to the FCC when tested for use at the ear is 0.45 W/kg, and when worn on the body in a holder or carry case, is 0.5 W/kg.

Body-worn Operation; This device was tested for typical body-worn operations with the back of the handset kept 1.5 cm from the body. To maintain compliance with FCC RF exposure requirements, use accessories that maintain a 1.5 cm separation distance between the user's body and the back of the handset. The use of beltclips, holsters and similar accessories should not contain metallic components in its assembly.

The use of accessories that do not satisfy these requirements may not comply with FCC RF exposure requirements, and should be avoided. The FCC has granted an Equipment Authorization for this model handset with all reported SAR levels evaluated as in compliance with the FCC RF emission guidelines.

SAR information on this model handset is on file with the FCC and can be found under the Display Grant section of <http://www.fcc.gov/oet/ea/> after searching on FCC ID Q78-008Z. Additional information on Specific Absorption Rates (SAR) can be found on the Cellular Telecommunications & Internet Association (CTIA) website at <http://www.ctia.org>.

European RF Exposure Information

Your mobile device is a radio transmitter and receiver. It is designed not to exceed the limits for exposure to radio waves recommended by international guidelines. These guidelines were developed by the independent scientific organization ICNIRP and include safety margins designed to assure the protection of all persons, regardless of age and health.

The guidelines use a unit of measurement known as the Specific Absorption Rate, or SAR. The SAR limit for mobile devices is 2 W/kg and the highest SAR value for this device when tested at the ear was 0.73 W/kg*. As mobile devices offer a range of functions, they can be used in other positions, such as on the body as described in SoftBank Body SAR Policy. In this case, the highest tested SAR value is 0.682 W/kg. As SAR is measured utilizing the devices highest transmitting power the actual SAR of this device while operating is typically below that indicated above. This is due to automatic changes to the power level of the device to ensure it only uses the minimum level required to reach the network.

The World Health Organization has stated that present scientific information does not indicate the need for any special precautions for the use of mobile devices. They note that if you want to reduce your exposure then you can do so by limiting the length of calls or using a hands-free device to keep the mobile phone away from the head and body.

*The tests are carried out in accordance with international guidelines for testing.

008Z User Guide Index

B	
Basic Operations.....	14
Battery Installation.....	9
C	
Calling.....	22
Charging Battery.....	10
Customer Service.....	24
G	
General Notes.....	33
H	
Handset Language.....	15
Home Application.....	15
Home Screen Basics.....	18
I	
Introduction.....	2
N	
Notifications Window.....	19
O	
Optional Services.....	22
P	
Package Contents.....	4
Parts & Functions.....	4
Power On/Off.....	11
S	
SD Card Installation.....	7
Safety Precautions.....	26
Security Codes.....	16
Specifications.....	24
Status Bar.....	18
T	
Touchscreen Operations.....	12
U	
USIM Card Installation.....	5

SoftBank 008Z User Guide

August 2011, First Edition
SOFTBANK MOBILE Corp.

Visit [SoftBank Shop](#) for assistance

Model : SoftBank 008Z
Manufacturer : ZTE Corporation