

SoftBank 301Z

User Guide



SoftBank

Guide Usage Notes

Thank you for purchasing SoftBank 301Z.

- Before using SoftBank 301Z, read "Quick Start Guide," and "User Guide (this guide)," for proper usage.
- Handset is a mobile phone that supports SoftBank Mobile's Simple Style 3G phone plan. See, "Simple Style User Guide (Japanese)" for details.
- Handset does not support Yahoo! Keitai.
- Subscribers of Unlimited Mail can set Email related settings to make changes to Email addresses, etc. via My SoftBank.
- My SoftBank can only be used during Unlimited Mail period of validity.

SoftBank 301Z supports 3G format.

Precautions

- Reproduction of the contents of this guide in part is prohibited.
- Contents of this guide are subject to change without notice.
- Every effort has been made in the preparation of this guide. Should you notice any unclear points, omissions, etc., feel free to contact us (P.10-1).
- User Guide with incorrect pagination or missing pages will be replaced.

The latest version of this guide is downloadable from SoftBank Mobile Website at:
<http://www.softbank.jp/en/mobile/product/prepaid/301z/>

Procedures and Displays in This Manual

Please note the following before reading this guide.

- SoftBank 301Z is referred to as “handset”.
- microSD Card and microSDHC Card are referred to as “SD Card”.
- Screenshots and images in this guide may differ in appearance from the actual handset. Also, the tone and brightness may differ depending on the conditions such as surrounding light levels.
- Simple key icons represent key operations.
- Unless otherwise noted, operations start from Standby.
- “Long Press” means pressing a key for more than one second.

Contents

Guide Usage Notes	i
Contents	iii
1 Getting Started	
Package Contents.....	1-1
Parts & Functions	1-2
USIM Card Installation.....	1-5
SD Card Installation	1-7
Battery Installation	1-8
Charging Battery.....	1-12
Power On/Off.....	1-12
Handset.....	1-13
Initial Handset Setup	1-15
Sound Profile.....	1-16
Basic Operations	1-17
USIM PIN	1-19
Security Codes.....	1-20
2 Text Entry	
Entering Text	2-1
Editing Text.....	2-5
User Dictionary.....	2-6

3 Phone	
Emergency Calls	3-1
Voice Call	3-1
Optional Services	3-3
Phone Book	3-5
4 Messaging	
Customizing Mail Address.....	4-1
Message Type & Size.....	4-1
Sending S! Mail	4-2
Sending SMS	4-4
Settings.....	4-5
Working with Messages.....	4-6
5 My SoftBank	
My SoftBank.....	5-1
6 Camera	
Using Camera	6-1
Photos	6-3
Videos	6-4
Viewing Photos/Videos	6-5
7 Applications	
Opening Applications.....	7-1

8 Appendix

Software Updates	8-1
-------------------------------	------------

9 Safety Precautions

Safety Precautions	9-1
---------------------------------	------------

General Notes.....	9-10
---------------------------	-------------

Intellectual Property Rights.....	9-12
--	-------------

Specific Absorption Rate (SAR) for This Product	9-13
--	-------------

10 Customer Service

Customer Service	10-1
-------------------------------	-------------

Package Contents

□ 301Z (Handset)

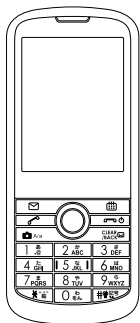

□ Battery (ZEBAT1)

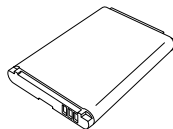

□ AC Charger (ZECAP1)

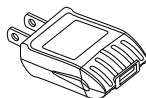

□ Micro USB Cable (ZEDAD1)

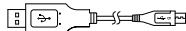

□ Quick Start (Japanese)

□ Quick Start Guide

□ Warranty (Handset, AC Charger)

- Keep warranty and accessories in a safe place.
- Handset supports microSD™/microSDHC™ Card (hereinafter, SD Card). Purchase a commercial SD Card to use.

Parts & Functions

1

Getting Started

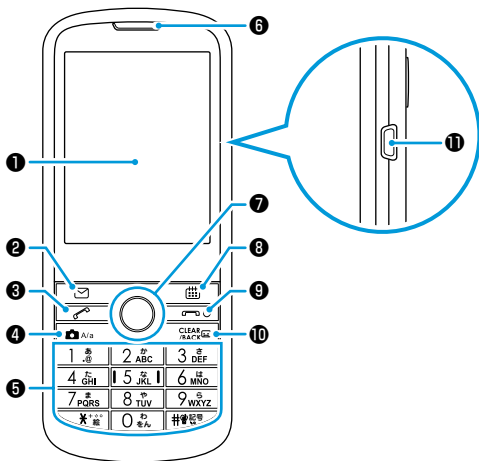

- ① Display
- ② Email Key
- ③ Call Key
- ④ Camera Key
- ⑤ Dial Keypad
- ⑥ Earpiece
- ⑦ L/R/U/D Keys/Enter Key
- ⑧ Calendar Key
- ⑨ Power/Call End Key
- ⑩ Clear/Back/Set Answering Machine Key
- ⑪ External Device Port

Earphone Jack

- Use 3.5 mm Earphone with Mic [ZELAD1] (optional accessory) with this handset. If any other products besides the specified product are used, handset will not properly function, and thereby cause a malfunction.

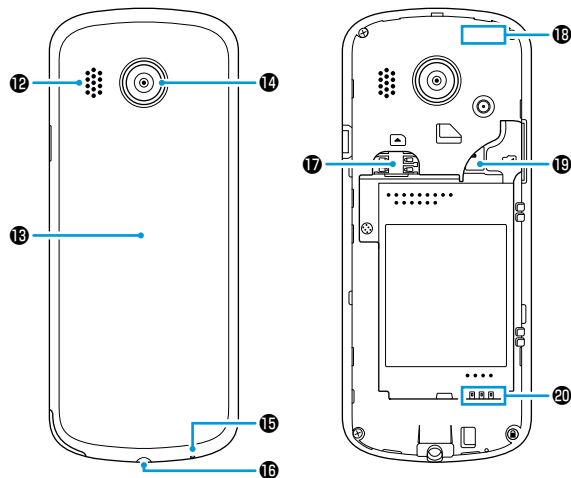

- ⑫ Speaker
- ⑬ Battery Cover
- ⑭ Camera
- ⑮ Mic
- ⑯ Earphone Jack
- ⑰ USIM Card Slot
- ⑱ Internal Communication Antenna
- ⑳ SD Card Slot
- ㉑ Battery Terminals

Internal Communication Antenna

- Do not cover over with stickers, or your hands, since sensitivity may be affected.

What 301Z Can Do

In Standby, Press any key once to directly call up various functions such as create Email and show call log, etc. Change functions that are called up via shortcut keys.

■ Press Keys to

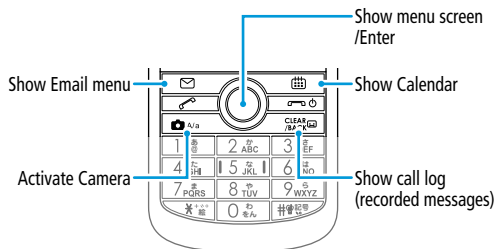
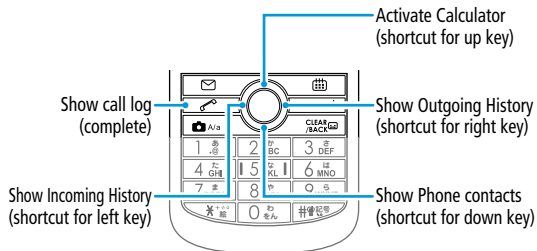

■ Long Press Keys to

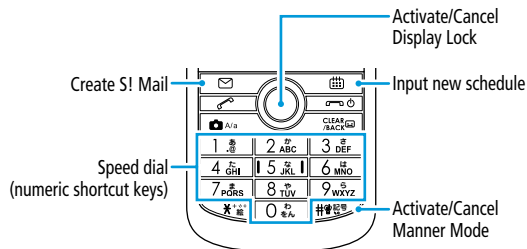
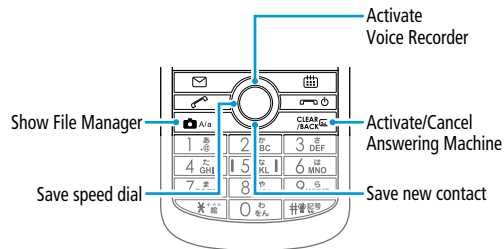

Softkeys

Show compatible key operations.

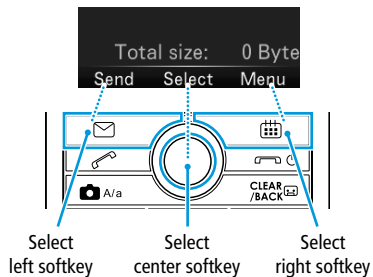

- Screenshot is for descriptive purposes and may differ from actual handset.

Key Operation Icons

This guide uses the following key icons.

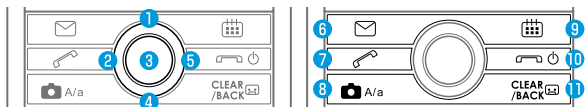

Key	Icon	Description
1		Press Up
2		Press Left
3		Press Confirm
4		Press Down
5		Press Right
1 4		Press Up or Down
2 5		Press Left or Right
1 2 4 5		Press Up, Left, Down or Right
6		Press Mail
7		Press Call
8		Press Camera
9		Press Calendar
10		Press Power/End
11		Press Clear/Back/Answering Machine

Before Using USIM Card

USIM Card is an IC card issued by SoftBank Mobile Corp. to users that contains information such as phone numbers, etc. Insert USIM Card to use handset. See the manual provided with USIM Card.



IC component

- Data saved in USIM Card can be used with other SoftBank mobile phones that support USIM Cards.
- Only use USIM Cards designated by SoftBank Mobile Corp. Handset may not operate properly with other USIM Cards. SoftBank Mobile Corp. is not liable for any damages arising from inserting USIM Cards into IC card readers or other third party devices.
- Keep the IC chip clean.
- Do not scratch, carelessly touch or short-circuit the IC chip. May cause data loss or malfunction.
- Clean USIM Card with a dry soft cloth.
- Do not put labels on USIM Cards. May cause malfunction.
- Do not drop nor subject handset to excessive force which may cause USIM Card to not be correctly recognized, thereby causing handset to repower up. After handset repowers up, Standby appears. Handset is functioning normally, this is not a malfunction. If "Please shut down the phone and insert a USIM." is shown, power off handset, ensure that USIM Card is inserted properly, and power on handset again.

Other Precautions

- USIM Card is the property of SoftBank Mobile Corp.
 - Return USIM Card to SoftBank Mobile Corp. upon cancellation or suspension of service.
 - USIM Card will be reissued for a fee if lost or damaged.
 - If USIM Card/handset with USIM Card inserted is lost or stolen, contact Customer Service (P.10-1) to suspend service.
 - Keep a separate copy of data saved on USIM Card. SoftBank Mobile Corp. is not liable for any loss of data you have saved.
 - USIM Card specifications and performance are subject to change without notice.
 - Returned USIM Cards are recycled.
- Note that some files including music, pictures and videos saved in handset or SD Card may be inaccessible after service subscription cancellation, handset upgrade, USIM Card replacement or handset repair.

Inserting/Removing USIM Card

- Always power off handset before inserting/removing USIM Card.

To Insert

- 1 Open Battery Cover (P.1-10)
- 2 Remove Battery (P.1-11)
- 3 Insert USIM Card with IC facing down, all the way in
 - Confirm that USIM Card is perfectly installed.

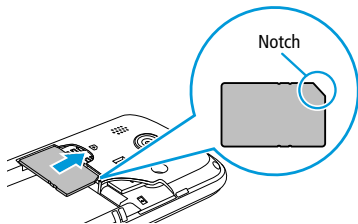

- 4 Install Battery (P.1-10)
- 5 Close Battery Cover (P.1-11)

To Remove

- 1 Open Battery Cover (P.1-10)
- 2 Remove Battery (P.1-11)
- 3 Slide out USIM Card gently

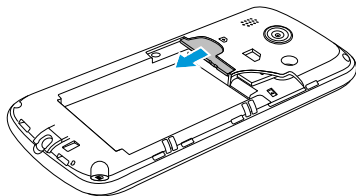

- 4 Install Battery (P.1-10)
- 5 Close Battery Cover (P.1-11)

Overview

Like File Manager in handset, data can be saved in SD Card.

- Handset supports microSD Cards up to 2GB and microSDHC Cards up to 32GB (as of June 2014).

Note that not all operations are guaranteed.

- SD Card data may be lost or altered due to an accident or malfunction. Keep a copy of your data in a separate place. Note that SoftBank Mobile Corp. is not liable for any damages arising from lost/changed data.
- Do not remove Battery or power off handset while reading/writing data in SD Card.
- Be careful not to delete or overwrite data accidentally.
- It may take time to access data on SD Cards filled with data.

Inserting/Removing SD Card

- Always power off handset before inserting/removing SD Card.

Inserting SD Card

- 1 Open Battery Cover (P.1-10)
- 2 Insert SD Card with contacts facing down, all the way in
 - Ensure that SD Card is completely inserted.

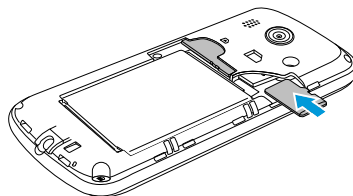

- 3 Close Battery Cover (P.1-11)

- After powering on, **SD** appears. If **SD** is not shown, remove SD Card (P.1-8) and insert it again.

Removing SD Card

- 1 Open Battery Cover (P.1-10)
- 2 Pull SD Card straight out

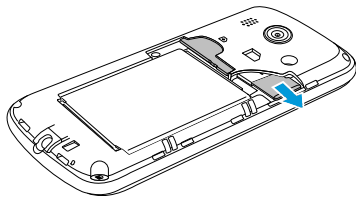

- 3 Close Battery Cover (P.1-11)

Battery Installation

Before Charging

When purchased, Battery is not sufficiently charged. Be sure to charge before initially using.

About Battery

- Soiled Battery, handset or AC Charger terminals may cause poor contact, resulting in power failure or insufficient charging. Clean handset, Battery and AC Charger with a clean, dry swab.
- Battery is a consumable item. Replace Battery with a new one if the operation time becomes extremely short even after it is fully charged, purchase a new battery.
- Do not store or leave Battery uncharged. Battery may become unusable. If Battery is to be left uncharged for a long period of time, charge Battery every six months.
- Carry Battery in a bag, etc. when carrying it separately.

Charging

- Battery cannot be charged without handset. Install Battery in handset to charge it.
- Charging may take longer when handset is powered on.
- Move AC Charger away from TV/radio if interference occurs.





Battery Life

Using handset in the following conditions may shorten Battery life:

- Extremely high or low temperatures
- Handset, Battery or AC Charger is soiled
- Weak signal/no signal
- Handset is left powered on in mid-operation (not in Standby)
- To extend Battery life:
 - Set Backlight Time to a shorter time
 - Set Keypad Backlight Time to a shorter time
 - Set Key Tone to Off: (P.1-16)

Battery Level Indicator

Battery Level indicator changes as remaining usage time decreases. Charge or replace Battery based on this indicator and low Battery messages.

Battery Icon	Remaining Battery Level
	0 - 10%
	10 - 40%
	40 - 70%
	70 - 100%

Installing/Removing Battery

- Always power off handset before installing/removing Battery.

To Install

1 Open Battery Cover

- Use your finger to lift up Battery Cover with indentation. Gradually remove Cover along the circumference after creating a gap between Battery Cover and handset.
- Be careful to not damage your fingernail.

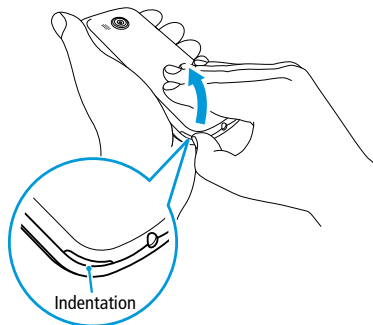

2 Install Battery

- Insert Battery terminals so that they match with handset's terminals as shown ①, then press it in as shown ②.

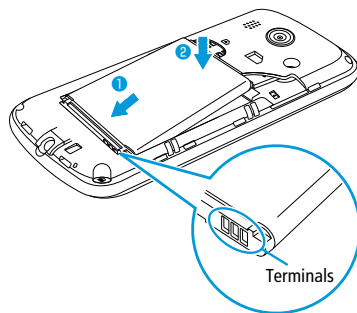

3 Close Battery Cover

- Completely press and close Battery Cover so that it snaps shut such that there are not any gaps between Battery Cover and handset.

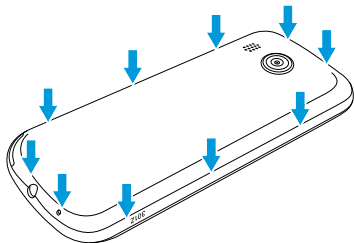

- Since handset will no longer properly function if Battery is removed while in use, absolutely do not remove it while handset is powered on.

To Remove

1 Open Battery Cover (P.1-10)

2 Remove Battery

- Use your finger to lift up Battery with indentation (opposite side of the terminals) as shown 1.

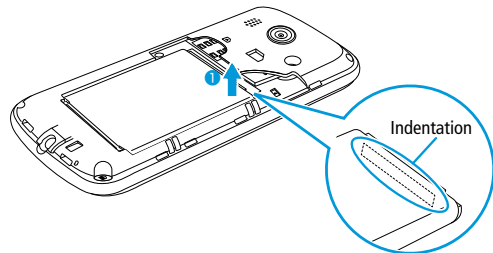

3 Close Battery Cover (P.1-11)

- Handset uses a lithium-ion battery. Lithium-ion batteries are recyclable resources.
- Bring used batteries to retail stores with a Mobile Recycle Network logo.
- Do not short-circuit or disassemble batteries. May cause a fire or electric shock.

Charging with AC Charger

Always use provided AC Charger.

- 1 Insert Micro USB Cable USB plug into AC Charger
- 2 Insert Micro USB Cable Micro USB plug into External Device Port
- 3 Plug AC Charger into household AC outlet
 - While charging, Battery indicator  appears.

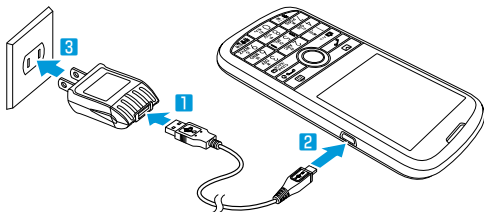

- If handset and computer are connected with the supplied Micro USB Cable, handset can be charged via a computer.
- Do not use any other AC Charger or Micro USB Cable except for the ones supplied to charge handset. May cause malfunction.

Power on

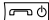
- 1 Long Press  (more than three seconds)
Standby is shown.
 - To require operation password to be input to operate handset: (P.1-21)
 - To require PIN to be input to operate handset: (P.1-19)

Retrieving Network Information

When purchased, Pressing any key for the first time in Standby may show a confirmation window.  (Yes) to start retrieving network information.

- Services involving network access such as Mail or My SoftBank need network information retrieval.

Power off

- 1 Long Press  (more than three seconds) to power off handset
Display turns off.
 - Do not power on handset immediately after powering off.

Indicators

Notification and Status Indicators

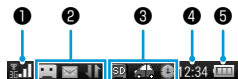

1 Signal: Show signal strength



Signal Strength



No Signal



Flight Mode

2 Notification: Show notifications



Message for Answering Machine Recorded



Unread Email



Mailbox Capacity Insufficient



HSPA Data in Use



Data Communications Active



Emergency Alert Messages



Software Update in Progress

3 Status: Show status



Alarm Set



Headphones Connected



Driving Mode



Manner Mode



SD Card Installed

4 Clock: Show current time

5 Battery: Show battery status (P.1-9)



Battery Level

Display

Display shows various icons and information.

- Standby shows status, date and time and notifications.

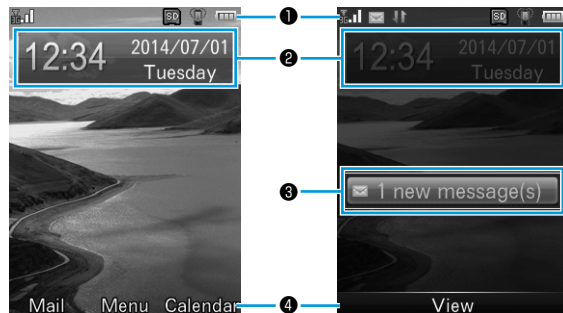

1 Status Bar

Shows signal, battery level, settings and status.

2 Date and time area

Shows date, time and day.

3 Information area

Shows information including unread messages and missed calls.

4 Softkey area

Shows operations available by Pressing ,  and .

- Main Menu shows status icons and icons for launching different functions.



1 Status Bar

Shows signal, battery level, time, settings and status.

2 Launcher area

Shows function icons with their names.

3 Softkey menu area

Shows operations available by Pressing ,  and .

- For Status Bar icons: (P.1-13)

- For Information area: (P.1-15)

Standby

Information

An information message appears when you miss calls or receive messages.

- The message indicates the type of information and the number of items.

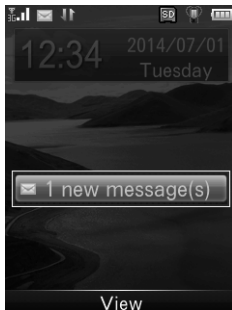

- Highlight an item > **(View)**

Setting Language

- To change from Japanese to English:

In Standby, **(Menu)** > **設定** > **本体設定** > **Language** > **English**

- To change from English to Japanese:

In Standby, **(Menu)** > **Settings** > **Handset** > **言語設定** > **日本語**

Setting Time

- In Standby, **(Menu)** > **Settings** > **Handset** > **Time and Date**

Time format	(Edit) > 24 hours/12 hours > (OK) > (Save)
Auto-update time	To automatically update: (Edit) > On > (OK) > (Save) To manually update: (Edit) > Off > Time > (Edit) > Edit time > (OK) > Date > (Edit) > Edit date > (OK) > (Save)

Please use your handset responsibly.

- Power handset off in theaters, museums and other places where silence is the norm.
- Refrain from using in restaurants, lobbies, elevators, etc.
- Observe signs and instructions regarding handset use aboard trains, etc.
- Refrain from use that hinders other pedestrians.

Manner Mode/Driving Mode

Manner Mode

Mute handset tones for incoming calls and alarms. Activate vibration instead.

- When set,  appears.

1 In Standby, Long Press

- Long Press  in Standby to deactivate.

- When Manner Mode is activated, the following tones still sound.
 - Photo shutter click
 - Start/Stop sound for recording video
 - Ringtone via Headset
 - Emergency Alert Messages

Driving Mode

Mute handset tones for incoming calls and alarms. Incoming calls and alarms are shown in Display.

- When set,  appears.



1 In Standby, (Menu) > Settings > Sound profiles > Drive

- Ringtones sound via Headset.

Settings for Normal Mode

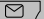
Set Ringtone, change Volume and activate Phone sounds.

From In Standby,  (Menu) > Settings > Sound profiles > Select Normal >  (Edit)

Items	Description
Ringtone	(P.1-19)
Volume	Adjust tone volume  Voice call/Message/Confirm delivery notification/Missed call notification/Earpiece volume/Alarm volume > Adjust volume >  (OK)
Vibration	(P.1-19)
Phone sounds	Set whether to activate Phone sounds  Keypad sounds/Warning tone > On/Off

Turning Handset Transmissions Off (Flight Mode)

Turn off all handset transmissions. Flight Mode disables all the functions involving handset transmissions such as placing/receiving calls, sending/receiving messages or My SoftBank.

When set, Signal indicator changes to .

1 In Standby, (Menu) > Settings > Connections

2 Flight mode > On

- Select Off to deactivate.

Selecting Items and Going Back

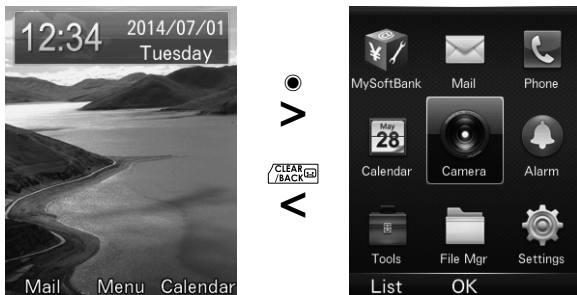

- 1 Highlight an item > ● (XXXX)
Window of the item selected is shown.
- 2 
Display returns to the previous window.

Going Back to Standby

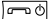
- 1 In any window, 
Display returns to Standby.

Quick Operations

Select menu with Dial Keypad.

■ Main Menu

In Main Menu, icons are arranged the same as keypad; Press a number key to select.

E.g.) Press  to select Camera

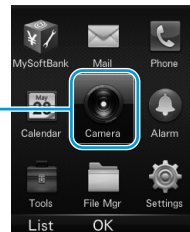
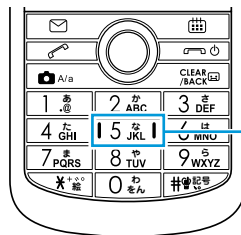

Main menu: normal

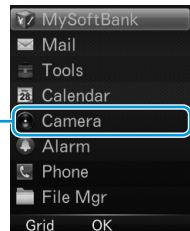

Main menu: listed

Items and Menu Options

If there are numbers shown to the left of selections, Press a number key to select the corresponding item.

E.g.) Press [1] to select Inbox in Message window

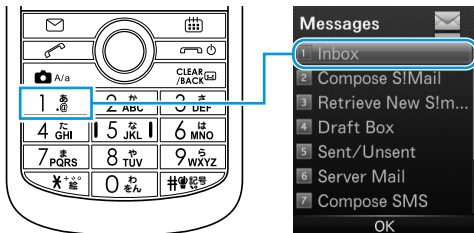

Shortcut Keys

Add a shortcut to frequently used functions for quick and easy access.

- Up to five shortcuts can be assigned.
- Default shortcut functions can be changed.

Using Shortcut Keys

- 1 In Standby, Press a key (or Long Press a number key) where you assigned a function
The function is launched.

Adding Shortcut Keys

- 1 In Standby, (Menu) > Settings
- 2 Handset > Shortcut keys
- 3 Select a key > Select a function

Shortcut Key	Default Function
Set UP key	Calculator
Set DOWN key	Contacts
Set LEFT key	Received call
Set RIGHT key	Dialed call
Long press number keys	Speed dial

Incoming Call Operations

From In Standby, ● (Menu) > *Settings* > *Sound profiles* > *Select Normal*

Changing Ringtone

Change the default Ringtone.

- 1  (Edit)
- 2 *Ringtone* > *Voice call/Message/Confirm delivery notification/ Missed call notification* > Select a Ringtone > ● (Setting)

Vibrator Settings

Set whether to activate vibration when calls/messages are incoming.

- 1  (Edit)
- 2 *Vibration* > *Ringing Only/Vibration only/Vibration and ringing*

PIN

USIM Card has a "USIM PIN" security code, change it from default setting to prevent unauthorized usage by third parties (at the time of purchase, it is set to "9999").

Enabling USIM PIN

- 1 In Standby, ● (Menu) > *Settings*
- 2 *Security* > Enter operation password
- 3 *Activate security codes* > *PIN code* > *On*
- 4 Enter USIM PIN > ● (OK)

Changing PIN

Reset the USIM PIN.

Set PIN code to On before resetting (see Step 3 above).

- 1 In Standby, ● (Menu) > *Settings*
- 2 *Security* > Enter operation password
- 3 *Change security codes* > *PIN code*
- 4 Enter current USIM PIN > ● (OK)
- 5 Enter new USIM PIN > ● (OK)
- 6 Enter the new USIM PIN again > ● (OK)

Mistaken USIM PIN input

- If mistakenly input three times in a row, USIM PIN is locked, and handset usage is restricted. Enter Personal Unlocking Key (PUK code) to release PIN lock (P.1-20).

Cancelling PIN Lock (PUK Code)

- Contact Customer Service (P.10-1), then after confirming "Personal Unlocking Key (PUK code)," perform these operations.

- 1 Enter PUK > ● (OK)
- 2 Enter new USIM PIN > ● (OK)
- 3 Enter the new USIM PIN again > ● (OK)

Mistaken PUK input

- If PUK is mistakenly input ten times in a row, USIM Card is locked, and handset is no longer operable. Input carefully; a locked USIM Card will need to be reissued (for fee) at a "SoftBank Shop."

The following security codes are required in order to use handset.

Operation password	Required to set and unlock password key lock to operate handset (at the time of purchase, it is set to "0000").
Contract security code	Designated at initial subscription. Required for mail address and other Email-related settings, nuisance Email settings, and customer-requested emergency cancellation. If you forget your security code, you can reobtain it only by mail to the street address you indicated at initial subscription.

- Be careful to not forget operation and contract security codes. If forgotten, recovery procedures are required. For details, contact Customer Service (P.10-1).
- Be careful to not let other people know the operation and contract security codes. SoftBank Mobile Corp. is not liable for damages due to misuse.
- If mistakenly input three times in a row, Call Barring settings are no longer changeable. Change operation and contract security codes in those cases. For details, contact Customer Service (P.10-1).
- If you have previously changed your contract security code on a handset, input the changed code when setting Call Barring.
- Set or change operation password with handset (P.1-21).

Enabling Handset Lock

• Operation password: (P.1-20)

- 1 In Standby, ● (Menu) > *Settings*
- 2 *Security* > Enter operation password
- 3 *Activate security codes* > *Power* > *On*
- 4 Enter operation password > ● (OK)

Changing Operation Password

Reset operation password.

Set Power to On before resetting (see Step 3 above).

- 1 In Standby, ● (Menu) > *Settings*
- 2 *Security* > Enter operation password
- 3 *Change security codes* > *Power*
- 4 Enter current operation password > ● (OK)
- 5 Enter new operation password > ● (OK)
- 6 Enter the new operation password again > ● (OK)

Entering Text

Text Entry Window

E.g.) Text Entry window for S! Mail

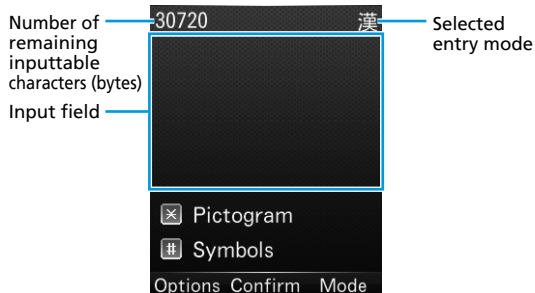

Entry Mode

- 1  (Mode)
Show Entry Mode list.



- 2 Select a mode

Mode	Description	Mode	Description
Kanji	Kanji and Hiragana	ABC[Full]	Double-byte alphanumerics
アイウ	Double-byte Katakana	ABC[Half]	Single-byte alphanumerics
アウ	Single-byte Katakana	Symbols	Single/Double-byte symbols
123[Full]	Double-byte numbers	Pictogram	Pictograms
123[Half]	Single-byte numbers	Emotions	Emotions

Number Keys for Entering Text

Use number keys to enter text.

A single number key has multiple characters assigned to it. Press a key multiple times to scroll through its assigned characters (P.2-2).



Kanji/Hiragana/Katakana

Entering Kanji

E.g.) Enter "鈴木" in Kanji Mode

1 In Text Entry window, enter "すずき"

- Enter text as follows:

「す」: [3 DEF] (thrice)

「ず」: [0] > [3 DEF] (thrice) > [英] (once)

「き」: [2 ABC] (twice)

* Press [0] first to move the cursor when the next character is on the same key.

2 [0] for Predictive Candidate list

- [0] for Switch Candidate list.
- [CLEAR/BACK] to exit the list to add/edit text.
- There are two types of lists for converting Hiragana to Kanji: Predictive Candidate list and Switch Candidate list (P.2-4).

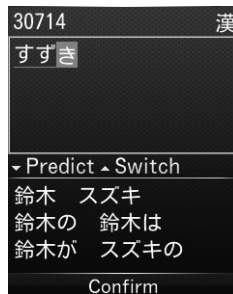

3 to highlight "鈴木" > (Confirm)



Entering Hiragana

E.g.) Enter "すずき" in Kanji Mode

1 In Text Entry window, enter "すずき"

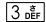
- Enter text as follows:

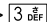
「す」:  (thrice)

「ず」:  >  (thrice) >  (once)

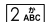
「き」:  (twice)

*Press  first to move the cursor when the next character is on the same key.

2 (Confirm)



Entering Katakana

E.g.) Enter "スズキ" in アイウ (Katakana) Mode

1 In Text Entry window, enter "スズキ"

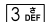
- Enter text as follows:

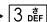
「ス」:  (thrice)

「ズ」:  >  (thrice) >  (once)

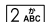
「キ」:  (twice)

- Each character is automatically confirmed as you enter it in.

*Press  first to move the cursor when the next character is on the same key.

2 (Confirm)

Entering Small Kana (つ, ツ, etc.)

1 Enter Kana normally >

- Alternatively, to enter small Kana, repeatedly Press a key.

Adding ` or °

1 Enter a Kana > (°) (> (°))

Entering Alphanumerics

E.g.) Enter "SoftBank" in ABC[Half] Mode

1 In Text Entry window, enter "SoftBank"



- Enter text as follows:

S :  (four times) > 

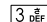
o :  (thrice)

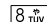
f :  (thrice)

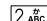
t :  (once)

B :  (twice) > 

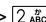
a :  >  (once)

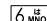
n :  (twice)

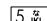
k :  (twice)

- To easily enter a number in ABC[Half] Mode, Long Press a number key.



*Press  first to move the cursor when the next character is on the same key.

Entering Symbols/Pictograms/Emotions

Symbols

- 



Symbol menu appears.

 - In Symbol menu,  (Change) to toggle tabs: *History* (previously entered symbols), *FullSym.* (double-byte symbols) or *HalfSym.* (single-byte symbols).
-  to highlight a symbol
-  (Confirm)

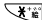
Pictograms

- 



Pictogram menu appears.

 - In Pictogram menu,  (Change) to toggle tabs: *History* (previously entered pictograms), *Common* (cross-carrier pictograms) or *All Pict.* (all pictograms).
-  to highlight a pictogram
-  (Confirm)











Emotions

-  (Mode) > *Emotions*



Emotion menu appears.

 - In Emotion menu,  (Change) to toggle tabs: *History* (previously entered emotions) or *Emotions.*
-  to highlight an emotion
-  (Confirm)

Entering Spaces

- To add a double-byte space at the end of sentence:
 -  > Press  (Change) multiple times for *FullSym.* > Highlight a space character >  (Confirm)
- To add a single-byte space at the end of sentence:
 -  
- To insert a double-byte space mid-sentence:
 -  > Press  (Change) multiple times for *FullSym.* > Highlight a space character >  (Confirm)
- To insert a single-byte space mid-sentence:
 -  > Press  (Change) multiple times for *HalfSym.* > Highlight a space character >  (Confirm)

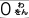

Inserting a Line Break

- To add a line break at the end of sentence:
 -  
- To insert a line break mid-sentence (only for Kanji Mode):
 -   (nine times)

Text Conversion

Candidate list appears during character entry.

- The candidate list sequence changes as words are entered more frequently.

Toggle	Example candidates for わ	Description
 (Predictive Candidates)	"私" or "わたし"	Predicts candidates beginning with the entered text
 (Switch Candidates)	"和" or "輪"	Shows candidates whose Kana/Kanji exactly matches with the entered text

Deleting/Editing Entered Text

1 To delete characters in a sentence:

Move the cursor to the right of the characters you want to delete >  to delete one character to the left of the cursor.

- Long Press  to delete all the characters to the left of the cursor.

To delete characters from the end of the sentence:

With the cursor at the end of the sentence, Press  to delete one character.

- Long Press  to delete all the characters to the left of the cursor.

2 Enter correct characters

Copying, Cutting and Pasting

Copy or cut text and paste it.

1 In Text Entry window, (Options) > Copy/Cut

2 Move the cursor to the right/left of the text you want to select > ● (Start) > Move the cursor to the left/right to select the whole text > ● (End)

3 Move the cursor to where you want to paste > (Options) > Paste

Words saved in User Dictionary appear as Switch Candidates.

Adding Words in User Dictionary

2

Text Entry

- 1 In Text Entry window,  (Options) > *Add to Dict.*
- 2 Move the cursor to the right/left of the text you want to select > ● (Start) > Move the cursor to the left/right to select the whole text > ● (End)
- 3 To enter the word, ● (Confirm)
- 4 Enter the reading > ● (Confirm)

Emergency Calls

Call 110 (Police), 119 (Fire & Ambulance) or 118 (Japan Coast Guard) even when Call Barring is activated.

■ Situations Where Emergency Call is Available

Available	<ul style="list-style-type: none">• Key lock is activated• All outgoing calls are barred
Not available	<ul style="list-style-type: none">• SoftBank USIM Card not inserted• Key lock with Password• In PIN entry window• In PUK entry window





■ Emergency Location Report

Your location is automatically reported to the corresponding agency such as police when you place an emergency call (110, 119 or 118) with SoftBank 3G handsets. This system is called "Emergency Location Report." The reported location is based on the positioning signals sent from base stations to handset.



- No application fees or connection fees apply.
- Reported location may be inaccurate, depending on the caller's location and signal strength. Make sure to provide your location, nearby landmarks and purpose on the phone.
- Emergency Location Report works with those agencies that have the system installed.
- Dial 184 before emergency numbers to not report your location. However, first responders may obtain your location information for situations where an immediate and serious threat to life is concerned.

Voice Call

Making Calls

- 1 In Standby, enter a phone number including area code**
 - Always enter area code even from within the same area code.
- 2 Confirm the phone number >**
 /  (Call)
The call is made.
 - To adjust volume: 
 - To end while calling:  (Cancel)
- 3 After the call ends >** 
"Call ended" and the call time appear for about two seconds. Then Display returns to Standby.

■ Correcting Misteries

 to move the cursor to the right of the digit you want to delete, then Press . Enter correct digits. Long Press  to delete all the digits to the left of the cursor.

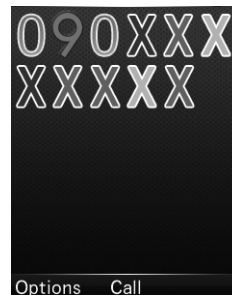

International Calls

Make voice calls from Japan to outside Japan.

1 twice (+) + country code + phone number > (Call)

- For more information on international call rates, visit SoftBank Mobile Website (<http://www.softbank.jp/en/mobile/>).

- When making an international call from Incoming History without having changed the international code setting, the set international code is automatically added to the number.

Checking International Code

1 In Standby, (Menu) > Settings > Calls > international code

Editing International Code

1 In Standby, (Menu) > Settings > Calls > international code

2 to delete the code, then enter a new code > (Save)

Answering Calls

Ringtone sounds for an incoming call.

The caller's phone number or name saved in Phone Book appears if Caller ID is sent.

- If not, "Withheld call" appears.

1 (Accept) > Talk to the caller

- To adjust volume:

2 After the call ends >

"Call ended" and the call time appear for about two seconds.

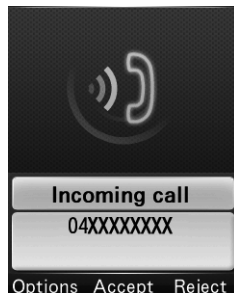

Handling Incoming Calls

Handle an incoming call as follows:

Mute ringtone*	CLEAR/BACK 0 9 WXYZ * #
Hold call	(Options) > Hold
Answering Machine	(Options) > Answering machine
Reject call	(Reject)

*Receive incoming calls when Any key answer is On.

- Mute setting is deactivated after the call.

Overview

The following optional services are available.

- For more information on applying for services, how to use them from landline phones, or service details, visit SoftBank Mobile Website (<http://www.softbank.jp/en/mobile/>).

Call Barring (P.3-3)	Bar outgoing/incoming calls and SMS
Caller ID (P.3-4)	Set whether to send your Caller ID to other party

Call Barring

Security code set at initial subscription is required to activate this service (P.1-20).

The following items can be set:

Item	Description
Bar all outgoing calls	All outgoing calls cannot be placed
Bar outgoing calls (international)	International calls cannot be placed
Bar all incoming calls	All incoming calls cannot be accepted
Cancel all call barring	Deactivate all outgoing and incoming call barring  Enter security code set at initial subscription
Reject numbers	Reject calls by specifying individual phone numbers in Specified numbers or by specifying caller types. Caller types you can specify to reject are Not saved numbers, Payphone, Withheld call, and Unsaved numbers (phone numbers not saved in Phone Book)

From In Standby, (Menu) > Settings > Calls > Call barring

Activating/Deactivating Call Barring

- 1 *Bar all outgoing calls/Bar outgoing calls (international)/Bar all incoming calls > Activate/Deactivate*
- 2 Enter security code set at initial subscription > (OK)

- A message indicating that Call Barring is activated appears when you attempt to place a call. It may take time to show the message depending on the region you are in. If no message appears, check Call Barring settings.

Checking Call Barring Settings

- 1 *Bar all outgoing calls/Bar outgoing calls (international)/Bar all incoming calls > Check status*
Current settings are shown.
 - (OK) for Call Barring window.

Deactivating All Call Barring

- 1 *Cancel all call barring*
- 2 Enter security code set at initial subscription > (OK)

Caller ID

Default is the setting (Set by network) which was specified at initial subscription.

- 1 In Standby, (Menu) > Settings > Calls > Send my number
- 2 *Set by network/On/Off*

Using Phone Book

Save frequently used phone numbers and mail addresses to Phone Book.

Saving Entries in Phone Book



Save an entry with name, phone number, mail address, etc.

















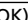

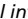

1 Long Press 

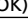
2 Enter Last name > Enter First name

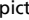

3 Select items to add

Item	Operation/Description
Last name	 Enter Last name
First name	 Enter First name
Reading last name	Entering Last name automatically enters Last name reading  Change Last name reading if needed

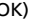
Reading first name	Entering First name automatically enters First name reading  Change First name reading if needed
Phone number	Up to five numbers can be added  Enter a phone number > Select an icon >  (OK)
Email address	Up to five addresses can be added  Enter a mail address > Select an icon >  (OK)
Group	 Select a group >  (OK) • Set groups beforehand
Address	Enter <i>Zip code, Country, Prefecture, City, number/street and additional information</i>  Enter Address >  (Save) > Select an icon >  (OK)
Office	 Enter office information
Post	 Enter job title
Homepage	 Enter a website > Select an icon >  (OK)
Note	 Enter notes
Birthday	 Enter birthday
Picture	 Preset pictures >  (OK) > Select a picture >  (Setting)  Other pictures > Open a folder with pictures inside > Select a picture >  (Setting)
Ringtone	 Select a Ringtone >  (OK)

4 After completing information,  (Save)

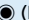
- Alternatively, in Standby,  (Menu) > Phone > New contact to create a new entry.

Other Ways to Create New Entries

Save currently shown phone number or mail address to Phone Book.

E.g.) Save a phone number from Incoming History

1 > **Highlight a number** > (Options) > **Save**

2 **To add as a new entry:**

New contact > Enter details (P.3-5)

To add to an existing entry:

Update contact > Highlight an entry > (OK) > Enter details (P.3-5)

3 After completing information, (Save)

Making Calls from Phone Book

1

2 to find a number

- Alternatively, enter a part of Reading to find the number.

3 Highlight an entry > (OK)

4 Select a phone number > (Call)

- If no entry matches entered Reading, entries close to Reading may appear.

Functions Available in Phone Book

■ Functions Available from Entry List window

(> Search an entry if needed) > Highlight an entry > (Options) > Select an option

Call	Select a number > (OK)
New contact	Save a new Phone Book entry (P.3-5)
Send	Send SMS or S! Mail <i>SMS</i> > Select a number > Follow the SMS instructions (P.4-4) <i>Mail</i> > Select a number or mail address > Follow the S! Mail instructions (P.4-2)
Send Biz Card	Send contact information via SMS or S! Mail <i>Via SMS</i> > Check items > (Done) > Follow the SMS instructions (P.4-4) <i>Via Mail</i> > Check items > (Done) > Follow the S! Mail instructions (P.4-2)
Edit contact	Edit the entry (P.3-5) > (Save)
Delete	<i>Selected</i> > Yes <i>Multiple</i> > Check entries > (Done) > Yes <i>All</i> > Yes
Advanced	Show Speed dial or Memory information <i>Speed dial info.</i> <i>Memory info.</i>

■ Functions Available from Entry Details window

(> Search an entry if needed) > Highlight an entry > (Options) > Select an option

Edit ^{*1}	Edit the entry (P.3-5) > (Save)
Send ^{*2}	Send SMS or S! Mail SMS > Select a number > Follow the SMS instructions (P.4-4) Mail > Select a number or mail address > Follow the S! Mail instructions (P.4-2)
Send Biz Card	Send contact information via SMS or S! Mail Via SMS > Check items > (Done) > Follow the SMS instructions (P.4-4) Via Mail > Check items > (Done) > Follow the S! Mail instructions (P.4-2)
Add to speed dial ^{*2}	Select a number shown next to "<Empty>" > (Assign) • If "<Empty>" is not shown, select an existing entry to overwrite > (Replace) > Yes
Delete	Yes

*1 Only for phone numbers and mail addresses

*2 Only for phone numbers

Group

From In Standby, (Menu) > Phone > Group

Saving Groups

Change a group name in Phone Book or set own Ringtone or image for groups.

1 (Options) > Add new group > Select an item > (Edit) > Specify details

2 After completing information, (Save)

■ To edit an existing group:

Select a group > (Options) > Edit group > Select an item > (Edit) > Specify details > After editing, (Save)

■ To delete an existing group

Select a group > (Options) > Delete group > Yes

- If an individual entry has its own settings such as Ringtone, the individual settings take precedence over the group settings that the individual belongs to.

Using Groups

Find an entry from existing groups.

1 Select a group > (OK)

Entries that belong to the group are shown.

Backing Up Phone Book

Back Up Phone Book

Back up entries in Phone Book to SD Card.

- Insert SD Card beforehand.

- 1 In Standby, ● (Menu) > *Phone*
- 2 *Address book back-up* > *Back up*
- 3 Enter operation password > *Yes*

Restoring

Replace entries in handset Phone Book with a backup file.

- 1 In Standby, ● (Menu) > *Phone*
- 2 *Address book back-up* > *Restore*
- 3 Enter operation password > Select a backup file > ● (OK) > *Yes*

Customizing Mail Address

Default account name is random alphanumerics. To avoid receiving spam, a mail address that cannot easily be guessed is preferable.

sbm123-abc @ softbank.ne.jp
Account Name Domain Name
(Customize this)

- For more information, visit SoftBank Mobile Website (<http://www.softbank.jp/en/mobile/>).

- 1 In Standby,**  (Mail) > **Settings > Custom Mail Addr**
Handset connects to My SoftBank.
 - Follow the onscreen instructions.

Message Type & Size

Item		S! Mail		SMS	
To	Email address	✓	Up to 254 single-byte alphanumerics/ Up to 20 recipients	-	-
	Phone number	✓		✓	Up to 21 single-byte alphanumerics/ Up to 1 recipient
Subject		✓	Up to 256 double-byte characters Up to 512 single-byte alphanumerics	-	-
Message body		✓	Up to 15360 double-byte characters Up to 30720 single-byte alphanumerics	✓	Up to 70 double-byte characters Up to 70 single-byte alphanumerics *1
Attachment		✓	*2	-	-

*1 When SMS Input char. (P.4-5) is set to English (160 char.), up to 160 single-byte alphanumerics can be entered.

*2 Maximum S! Mail size is 300KB including the subject, message body and attachments.

- Character limit varies with attachment size.

Sending S! Mail

Text entry: (P.2-2)

E.g.) Select a Phone Book entry to send S! Mail

1 In Standby, Long Press (Mail)

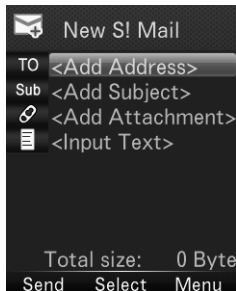

2 Highlight Address field > (Select) > Phone Book

3 Select a Phone Book entry

-  to change a tab.
-  to highlight an item.

4 (OK) to select an Email address/phone number

- When an Email address and phone number are saved,  to highlight an item to be selected.

5 Highlight Subject field > (Select) > Enter subject

6 Highlight Text field > (Select)

7 Enter message body

8 (Send)

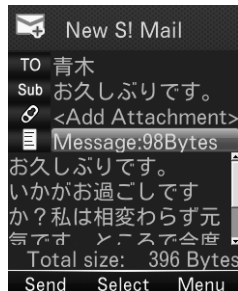

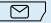

- Alternatively, in Standby,  (Mail) > Compose S!Mail to open New S! Mail window.

Attaching Files

- 1 In New S! Mail window, highlight Attachment field > ● (Select)
- 2 Select a file type > Select a folder > Select a file
 - When SD Card is inserted, ● to switch handset tab and SD card tab.
- 3  (Send)





■ To capture photos/video to attach:

 After Step 1, *Activate Camera* > *Photo mode/Video mode* > Frame subject > ● (Capture)/● (Record) (>  (Stop) for video)

■ To view/play attached files:

 Highlight Attachment field with an attachment > ● (Select) > Select a file > ● (View)/● (Play)

■ To add more attachments:

 Highlight Attachment field with an attachment > ● (Select) >  (Menu) > *Add* > Select a folder > Select a file >  (Finish)

■ To delete attachments:

 Highlight Attachment field > ● (Select) > Select an attachment >  (Menu) > *Delete* > *YES*

- Some files cannot be attached depending on the file format or size.
- Some copyright-protected files cannot be sent.

Sending SMS

Text entry: (P.2-2)

E.g.) Select a Phone Book entry to send SMS

1 In Standby,  (Mail) > **Compose SMS**

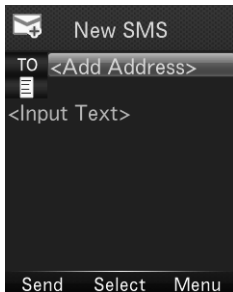

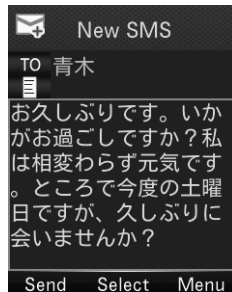

7  (Send)





4

Messaging

2 Highlight Address field >  (Select) > **Phone Book**

3 Highlight an entry >  (OK)

-  to change a tab.
-  to highlight an item.

4 Highlight a phone number >  (OK)

- When more than one number is saved,  to highlight an item to be selected.

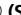
5 Highlight Text field >  (Select)

6 Enter message body

General Settings

From In Standby, [Envelope Icon] (Mail) > Settings > Univ. Settings

Font Size	Set font size in preview [Icon] Select size
Scroll Unit	Set scroll unit in preview [Icon] Select a scroll unit
Delivery Report	Set whether to request Delivery Report for every message [Icon] ON/OFF
Auto Sent Del	Set whether to automatically delete older messages when Sent/Unsent is full [Icon] ON/OFF
Auto Rcvd Del	Set whether to automatically delete older messages when Inbox is full [Icon] ON/OFF

S! Mail Settings

From In Standby, [Envelope Icon] (Mail) > Settings > S! Mail Settings

Sending Options	Set Reply-To	Set whether to reply to the specified address. A reply-to address can be specified here [Icon] ON/OFF [Icon] Highlight Reply-To field > ● (Edit) > Phone Book/Direct Entry
	Set Signature	Set whether to use your Signature. A new Signature can be defined here [Icon] ON/ON When New/OFF [Icon] Highlight Signature field > ● (Edit) > Enter Signature
Incoming Opt		Set whether to download complete messages automatically [Icon] Auto Download All/Manual Retrieval

SMS Settings

From In Standby, [Envelope Icon] (Mail) > Settings > SMS Settings

Message Center	Set SMS Center number [Icon] Select SMS Center number
SMS input char.	Set text entry language [Icon] Japanese (70 char.)/English (160 char.)

Messaging Window Layout

Message List

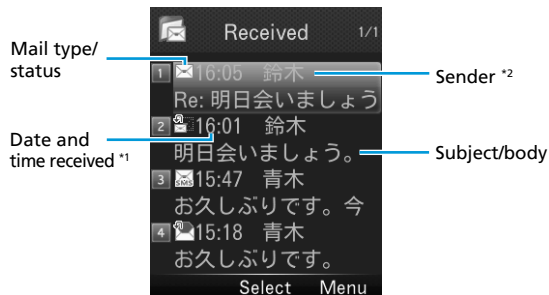

- For Sent, the following items are shown instead:
 - *1 Date and time sent
 - *2 Recipient

Message Type/Status

Both Message Type and Status are shown together.

Message Type		Message Status	
	Unread/Read S! Mail		Attachments
	Unread/Read S! Mail notification		Protected
	Unread/Read SMS in handset		Forwarded
	Unread/Read Emergency Alert Message (earthquake)		Replied
	Unread/Read Emergency Alert Message (disaster/evacuation information)		Failed (only for Sent)
	Unread/Read Emergency Alert Message (tsunami alert)		New delivery report (only for Sent)
	Forwarded server message		High priority
			Low priority

Message Details

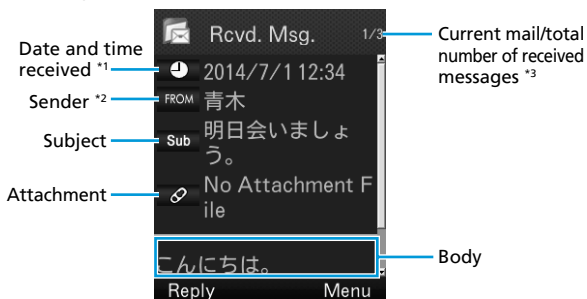

- For Sent, the following items are shown instead:

- *1 Date and time sent
- *2 Recipient
- *3 Total number of sent messages

- After retrieving a complete message from the S! Mail notification with (Forwarded) or (Replied), the icon changes to / (Unread/Read S! Mail).
- Messages remain protected after complete messages are retrieved via protected S! Mail notifications.





Managing/Using Messages

Viewing a Message



- 1 In Standby, (Mail) > *Inbox/Draft Box/Sent/Unsent*
 - For Inbox, select one more folder. The number of unread messages appears next to the folder.
- 2 Select a message





Replying to a Message

- 1 In Message window,  (Reply) > *Reply to Sender/Reply to All* (> *Compose S! Mail/Compose SMS for Reply to Sender*)
 - When S! Mail is replied to, "Re:" is appended at the beginning of the subject.
- 2 Create a reply message >  (Send)
 - To quote the body and reply:
 In Message window,  (Menu) > *ReplyWithQuote* > *Reply to Sender/Reply to All*
 - Menu options differ by the message type you reply to.
 - Alternatively, select a message in Message List to reply.

Forwarding Messages

- 1 In Message window,  (Menu)
- 2 *Forward* > *Forward/Fwd Server Mail*
 - When S! Mail is forwarded, "Fw:" is appended at the beginning of the subject.
- 3 Create a forward message >  (Send)

Protecting Messages

- 1 In Standby,  (Mail) > *Inbox/Sent/Unsent*
 - For Inbox, select one more folder.
- 2 Select a message >  (Menu) > *Protect* > *This one*

Deleting Messages

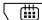
- 1 In Standby,  (Mail) > *Inbox/Draft/Sent/Unsent*
 - For Inbox, select one more folder.
- 2 Select a message >  (Menu) > *Delete* > *Delete This* > *YES*

Access My SoftBank from your SoftBank mobile phone or computer to check your charges and check or change your settings.

- Note that packet communication fees apply for accessing My SoftBank from your mobile phone.
- Subscribers of Unlimited Mail can set Email related settings to make changes to Email addresses, etc. via My SoftBank.
- My SoftBank is only usable while subscription to Unlimited Mail is valid.

- 1 In Standby, (Menu) > MySoftBank**
Settings page appears.
 - Follow the onscreen instructions.

Menu Options

From In Standby, (Menu) > MySoftBank > (Options)

Item		Operation/Description	
Refresh		Refresh the page	
Forward		Go ahead to the page you were viewing before going back a page	
Encoding		Set encoding to highlight an item > (Select)	
Properties		Show properties	
Settings	Advanced settings	Cache Mode to highlight an item > (OK)	
		Cookies mode to highlight an item > (OK)	
		Refresh Limit to highlight an item > (OK)	
	Clear cache		Clear data temporarily saved in cache Yes
	Clear cookies		Clear cookie identifiers Yes
	Certificate	Pre-installed Highlight a certificate > (Select)	
		Current used Highlight a certificate > (Select)	
	Version		Show Browser version
	Exit		Exit My SoftBank

Using Camera

301Z features an approximately 2.0-megapixel CMOS Camera capable of capturing photos and videos.

Important

- Lenses soiled with fingerprint smudges and grease may not focus well. Clean Lens off with a soft cloth.
- Hold handset firmly to avoid camera shaking, which may blur images especially in dark places.
- If handset has been left in a hot place for a prolonged period of time, image quality when shooting and saving images may be affected.
- Exposing Lens to direct sunlight may degrade Internal Color Filter, resulting in poor image quality.

Shutter Click

Shutter click sounds even in Manner Mode. Sound volume is fixed. Click sound can be changed (P.6-3).

- Camera cannot be activated when Battery level is low.
- Incoming calls or Alarms while activating or low Battery level deactivate Camera. If Camera is deactivated when photos are captured but not yet saved, the photos are retained automatically. If Camera is deactivated while recording video, the recorded data until that point is retained in handset. Activate Camera again to manually save data.
- If no operations are performed for two minutes, Camera enters Power-saving mode.

File Formats & Save Location

Photos/Videos are saved in File Manager.

Type	File Format	Save Location
Photo	JPEG (.jpg)	Pictures
Video	MPEG-4 (.3gp or .mp4)	Videos

Change save location to save files in SD Card (P.6-3, P.6-4).

Camera Mode & Image/Video Size

Camera Mode	Type	Size
Camera	Photo	1200 x 1600
		1024 x 1280
		960 x 1280
		768 x 1024
		600 x 800
Video Camera	Video	Not limited
		Email size

Display

- These screenshots may differ from actual handset, and are for descriptive purposes only.

■ Camera



■ Video Camera



Icon	Description
Zoom Bar	Indicate zoom level
Camera Mode	Camera
	Video

Key Operations for Camera

■ Before taking photos/recording

	Open Menu
	Take a photo/start recording
	Adjust zoom level

■ When Menu is open

	Change Menu
	Highlight an item
	Select an item
	Close Menu

■ While recording video

	Adjust zoom level
	Stop recording

■ After taking photos/recording

	Play recorded video
	Open Menu

*Only for videos

Photo Mode

Photos are taken in Portrait View.

Image size, image quality, brightness, contrast and effect can be set.

Taking Photos

1 In Standby,  > Frame subject

-  to adjust zoom level.



2  (Capture)

Shutter click sounds, then photo is taken and saved. The file name and save location appear at the top of the Display.

3 

Display returns to Viewfinder.

4 

Display returns to Standby.

- Alternatively, in Standby,  (Menu) > *Camera* to activate Camera.

Options Available for Taking Photos

From In Standby,  >  (Options)



Option	Description
My Pics	Open the save location
Image size	Set image size
Photo quality	Set image quality
Brightness	Set brightness
Contrast	Set contrast
Effect	Select an effect
Shutter sound	Select a shutter sound
Save to	When SD Card is inserted, Memory card can be specified as a save location
Switch to video camera	Switch to Video Camera Mode

Video Mode



Videos are recorded in Portrait View.



Video size, video quality, brightness, contrast, effect, video sound and video format can be set.



Recording Videos

- 1 In Standby,  >  (Options)
- 2 *Switch to video camera* > Frame subject
 -  to adjust zoom level.



- 3  (Record)
Recording starts with a sound effect.
- 4  (Stop)
The file name and save location appear at the top of the Display.

- 5 
Display returns to Viewfinder.
- 6 
Display returns to Standby.

- Alternatively, in Standby,  (Menu) > *Camera* >  (Options) > *Switch to video camera* to activate Video Camera.

Options Available for Recording Video

From In Standby,  >  (Options) > *Switch to video camera* >  (Options)

Option	Description
My videos	Open save location
Video size	Set whether to limit the recording size to the max. size of Email attachment
Video quality	Set video quality
Brightness	Set brightness
Contrast	Set contrast
Effect	Select an effect
Video sound	Set whether to record sound
Video format	Set file format
Save to	When SD Card is inserted, Memory card can be specified as a save location
Switch to camera	Switch to Camera Mode

Viewing Photos/Videos

From In Standby, ● (Menu) > File Mgr

1 For photos:

Select *Pictures*

For videos:

Select *Videos*

2 Highlight a folder > ● (OK)

3 Highlight a file > ● (Open)

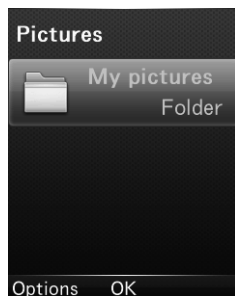

■ To view photos saved in SD Card:

Select *SD card* in Step 1 above > Highlight a folder > ● (OK)

■ To play videos saved in SD Card:

Select *SD card* in Step 1 above > Highlight a folder > ● (OK)

■ To view photos from Viewfinder:

In Viewfinder, [Envelope] (Options) > *My Pics*

- [CLEAR/BACK] to return to Viewfinder.











■ Options while viewing a photo

View in full screen	● (Full scr)
Zoom in* ¹	⦿
Zoom out* ¹	⦿
Move up* ¹ * ²	2 ↑ ABC
Move left* ¹ * ²	4 ← GHI
Move right* ¹ * ²	6 → MNO
Move down* ¹ * ²	8 ↓ TUV
Attach the file to a message	[Envelope] (Options) > <i>Send via Mail</i>
Show file information	[Envelope] (Options) > <i>File info.</i>
Show previous file	⦿
Show next file	⦿

*1 Only when in full screen

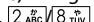
*2 Only when zoomed in

Options while playing video

Play	
Pause	
Adjust volume	
Switch between Mute/Unmute	 (Options) > <i>Mute/Unmute</i> (#) Alternatively,  to toggle Mute/Unmute
Adjust brightness	 (Options) > <i>Brightness</i> >  Alternatively,  to adjust brightness
Attach the file to a message	 (Options) > <i>Send via Mail</i>
Show file information	 (Options) > <i>File info</i> .
Show previous file	
Show next file	

Calendar

Show Calendar

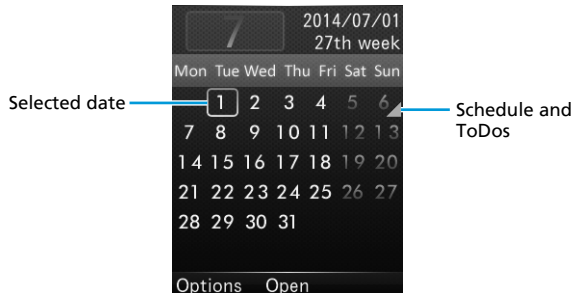

1 In Standby, (Calendar)

Calendar in Month view appears.



Calendar Options

1 In Standby, (Calendar) > (Options)













Item	Operation/Description
New	Add an entry  (P.7-1)
Week view/Month view	Switch the view
Go to date	Go to the specified date  Set a date > ● (OK)
Delete entry	Delete an entry  <i>On this day/Before today/All entries</i>
Settings	Set Calendar alarm and view
Memory Info.	Show memory usage of entries

Add an Entry

Up to 500 entries can be saved.

1 In Standby, (Calendar) > Highlight a date > (Options) > New

2 Appointment/ToDo > Select items to set

Item	Operation/Description
Subject	 Add a subject
Location*1	 Add a location
All-Day*1	 <i>On/Off</i> > ● (OK)
Start time**2	 Set start time
End time*3	 Set end time
Start date*1	 Set start date
End date	 Set end date
Alarm set	 <i>On/Off</i> > ● (OK)
Alarm time*4	 Set Alarm time
Alarm date*4	 Set Alarm date
Repeat set	 Select a repeat interval
Detail	 Add a description

*1 Only for Appointments

*2 Only when All-Day is set to Off

*3 Only for Appointments with All-Day set to Off or ToDos

*4 Only when Alarm is set to On

3 (Save)

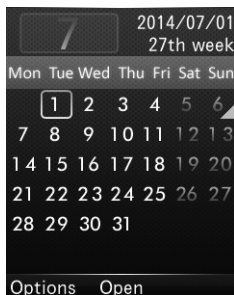

Alarm

Alarm goes off at the specified time.







■ Set an Alarm

Up to five Alarms can be set.

- When set,  appears in Status Bar.

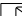
1 In Standby,  (Menu) > *Alarm* > Select <Not set> >  (Edit)

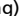
2 Select items to set

Item	Operation/Description
Time	 Set start time
Type	 Set whether to repeat Alarm (Select Repeat > Check days of week >  (Done) to repeat)
Snooze	When set, first Alarm goes off for 60 seconds, then recurs at the specified interval  Set Snooze interval
Ringtone	 Set whether Alarm sounds (Select On > Highlight a Ringtone file >  (Setting) to set)
Alarm remark	 Add a subject

3 (Save)





■ Disable an Alarm

1 In Standby,  (Menu) > *Alarm* > Highlight an Alarm

2  (Options) > *Disable*

■ Reset an Alarm

1 In Standby,  (Menu) > *Alarm* > Highlight an Alarm

2  (Options) > *Reset this* > *Yes*

■ Reset all Alarms

1 In Standby,  (Menu) > *Alarm*

2  (Options) > *Reset all* > *Yes*

■ Stop Alarm Sound

1 While Alarm is sounding,  (Stop)

- When Snooze is set, Press any key other than  to stop alarm from sounding.







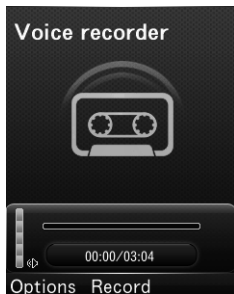

Alarm goes off again at the specified interval.

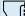
- When other events are set at the same time, handset notifies you of the highest priority event. The order of priority is as follows: *Alarm* > *ToDo* > *Appointment*. Notifications you missed are shown as Missed Alarm information in Standby.

Voice recorder

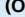
1 Long Press

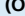





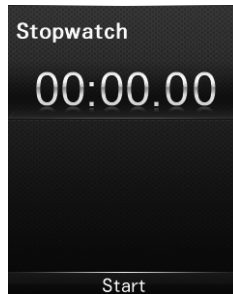

Key	Description
 (Record)	Start recording
 (Stop)	Stop recording
	Adjust recording volume
While recording,  (Pause)	Pause recording
While paused,  (Continue)	Resume recording
 (Options) > <i>Duration</i> > Highlight an item >  (OK)	Change recording time
 (Options) > <i>Save to</i> > Highlight an item >  (OK)	Change the save location
 (Options) > <i>My audios</i>	Open the save location

- Alternatively, in Standby,  (Menu) > *Tools* > *Voice recorder* to activate Voice Recorder.

Stopwatch

1 In Standby, (Menu) > *Tools* > *Stopwatch*



Key	Description
 (Start)	Start counting
While counting,  (Stop)	Suspend counting
While suspended,  (Continue)	Resume counting
 (Record)	Mark a lap time
With lap times marked,  (Reset)	Reset lap times marked

World Time

1 In Standby, **⊙** (Menu) > Tools > World Time



Key	Description
⊙	Show the current time in major cities around the world
⊙ (OK)	Change handset time to the time shown

Calculator

• Up to 12 digits can be shown.

1 **⊙**

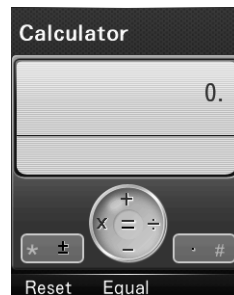

Key	Description	Key	Description
1 2 3 4 5 6 7 8 9 0 . to 0 おん	Enter numbers	⊙ (Equal)	=
⊙	+	± おん	Change sign
⊙	-	。 おん	Period (.)
⊙	*	CLEAR /BACK おん	Clear
⊙	/	⊙ (Reset)	Reset

E.g.) $-13 + 31.5 = 18.5$

⊙ **1** **3** **⊙** **3** **⊙** **1** **5** **。** **⊙**

• Alternatively, in Standby, **⊙** (Menu) > Tools > Calculator to activate Calculator.

Converter

1 In Standby,  (Menu) > Tools > Converter
E.g.) For Area

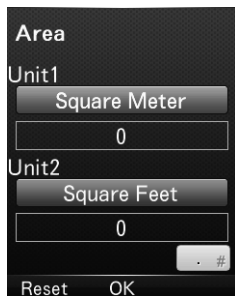

Item	Description
Currency	Enter Exchange rate > Enter Foreign amount or Local amount
Area	
Length	Choose a unit from Unit1 and Unit2 > Enter a value in Unit1 or Unit2 (units are predefined)
Weight	
Temperature	

Software Updates

Use the network to check whether handset software needs updating, and update it when required.

- Checking/updating does not incur communication charges.
- It may take about 30 minutes to update software. Handset cannot be used until updating is completed.
- Check that Battery level is adequate before updating software.
- Update software in a place where signal is good, and do not move around while updating.
- Other functions are unusable while software is being updated.
- We recommend that you back up needed data before updating software (some downloaded data is not able to be backed up). Data saved on handset before updating remains saved, but depending on handset condition (malfunctions, etc.), data may be lost. Note that SoftBank Mobile Corp. is not liable for lost data.
- While updating software, absolutely do not remove Battery, USIM Card, or power off. Updating may fail.
- If updating of software fails, handset may no longer be usable. In such case contact Customer Service (P.10-1).

1 In Standby,  (Menu) > Settings > Software update > Software update

2  (Yes) > Follow the onscreen instructions

After downloading the update, handset automatically restarts and software update begins.

When "Software has been successfully updated." appears, handset restarts again and shows update completion message (The process may take more than 60 seconds).

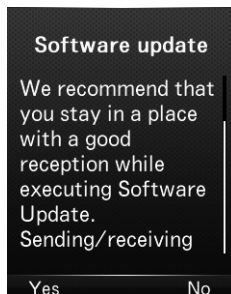

Checking Update Result

In Standby, (Menu) >
Settings > Software update
> Update result

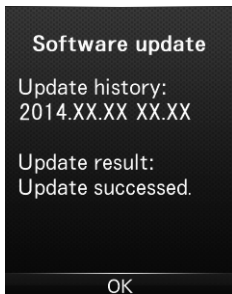

Scheduled Updates

Scheduled Update can be activated from any notification message from SoftBank Mobile Corp. When Scheduled Update is activated and the scheduled time comes, a confirmation window for updating software appears. Update software from this confirmation window.



- If handset does not restart after updating software, remove Battery then reinstall, and power on again. If handset still does not power on, consult with Customer Assistance (loss or malfunction) (P.10-1).
- Note that SoftBank Mobile Corp. is not liable for any data loss due to update.
- Alarm and schedule notification tones do not sound during updates.

Safety Precautions

- Read safety precautions before using handset.
- Observe precautions to avoid injury to self or others, or damage to property.
- SoftBank Mobile Corp. is not liable for any damages resulting from use of this product.







Labels

- These labels indicate the degree of risk from improper use. Make sure you thoroughly understand their meanings before reading on.

 DANGER	Great risk of death or serious injury from improper use
 WARNING	Risk of death or serious injury from improper use
 CAUTION	Risk of minor injury or damage to property from improper use

Symbols

- These symbols indicate prohibited or compulsory actions. Make sure you thoroughly understand their meanings before reading on.

 Prohibited	Prohibited actions
 Do Not Disassemble	Disassembly prohibited
 Avoid Liquids Or Moisture	Exposure to liquids prohibited
 Do Not Use Wet Hands	Use with wet hands prohibited
 Compulsory	Compulsory actions
 Disconnect Power Source	Unplug power cord

301Z, Battery (ZEBAT1), USIM Card, AC Charger (ZECAP1), Micro USB Cable (ZEDAD1)

DANGER



Prohibited

Do not charge, use or leave handset in places subject to high temperatures (near open flames or heating equipment, in direct sunlight or inside of cars on hot days). Also, do not charge, use or leave handset in warm places (inside of hermetically-closed bag or pocket, inside of kotatus, electric blankets, or inside pockets together with pocket heater, etc.) where heat easily builds up since same risks might be incurred.

May cause deformation and malfunction of handset, or cause Battery to leak, overheat, ignite and rupture. Also, a portion of the case might get hot which may cause burns, etc.



Prohibited

When installing Battery, and connecting AC Charger or Micro USB Cable, if they cannot be smoothly installed or connected, do not force them. Check orientation of Battery and terminals, then install and connect.

May cause Battery to leak, overheat, rupture and ignite. Also that may cause Battery terminals to get damaged or burned.



Prohibited

Do not exert excessive force on the exterior of handset and charger by stepping on them when they are charged.

Charging when terminals are damaged may cause malfunction or fire. When charging, be careful of where you use and handle handset and charger.



Do Not Disassemble

Do not disassemble/modify/solder handset.

May cause fire, injury, electric shock or malfunction. In addition, that may cause Battery to leak, overheat, rupture or ignite. Modifying handset is a violation of Radio Law and subject to penalty.



Avoid Liquids Or Moisture

Keep liquids away from handset.

When liquids such as water or pet urine get in, if it is left wet, and wet Battery is charged, that may cause overheat, electric shock, fire, injury or malfunction. Be careful of where you use and handle it.



Compulsory

Use SoftBank specified devices (Battery, AC Charger, or Micro USB Cable) only.

Use of non-specified devices may cause Battery to leak, overheat, rupture or ignite; or may cause AC Charger, Micro USB Cable to overheat, ignite or malfunction.

WARNING



Prohibited

Do not place handset, Battery, AC Charger, or Micro USB Cable in a microwave oven or pressure cooker, or on an induction cooktop.

May cause Battery to leak, overheat, rupture or ignite; or may cause handset, AC Charger, Micro USB Cable to overheat, emit smoke, ignite or malfunction.



Prohibited

Do not drop/throw handset or expose it to excessive shock.

May cause Battery to leak, overheat, rupture, ignite, or may cause fire, electric shock, malfunction.



Prohibited

Keep liquids (tap water, soft drink, seawater, pet urine, etc.) and conductive materials (e.g. pencil lead, metal fragments, metal necklaces, hairpins, etc.) away from charging terminals, External Device Port and Earphone Jack.

May cause short circuit, resulting in fire, injury or malfunction.



Compulsory

Turn off handset when entering gas stations or other places where flammable gases (propane gas, gasoline, etc.) or fine particulates are generated. Be sure to turn off handset beforehand. Do not charge Battery in such places.

Gases may ignite. Using handset near petrochemicals or other flammables may cause fire or explosion.



Compulsory

When you sense something is wrong such as strange noises, emission of smoke or strange odors, etc. while using, charging or storing, implement procedures below.

1. Hold AC Charger and unplug it from outlet. Also, be careful of getting burned since it might be hot, so disconnect handset.
2. Power off handset.
3. Be careful of burns and injuries, so remove Battery. Continued use may cause fire or electric shock.

CAUTION



Prohibited

Do not place handset on an uneven or unstable surface.

Handset may fall, leading to injuries or handset malfunctions. Be especially careful while vibration (vibrates) setting is active while charging. Also dropping while charging may damage terminals.



Prohibited

When disconnecting handset from AC Charger, do not pull on the cord, hold AC Charger connector and disconnect it.

The cord is damaged if it is pulled on, fire and electric shock, etc. may result because of damaged terminals.



Compulsory

Store in a place where infants and pets cannot reach.

Failing to do so may result in small parts being accidentally swallowed or may cause injury.



Compulsory

When children use handset, parental supervision is advised. Provide children with proper instructions.

Failing to do so may cause injury, etc.

Battery (ZEBAT1)

After verifying battery type by what is printed on Battery label, use it and dispose of it.

Label	Battery Type
Li-ion 00	Lithium-ion

DANGER



Prohibited

Do not dispose of Battery in fire.

May cause Battery to leak, rupture or ignite.



Prohibited

Do not damage (nail, hammer, stomp, etc.) Battery or subject it to strong impacts/shocks.

If a deformed Battery is used, it may cause leaking, overheating, rupturing or ignition. When using, verify Battery conditions.



Prohibited

Do not contact Battery terminals with metals such as needles, etc. In addition, do not transport and store Battery with conductive materials (e.g. pencil lead, metal fragments, metal necklaces, hairpins, etc.)

May cause Battery to leak, overheat, rupture or ignite.



Compulsory

If Battery fluid gets into eyes, immediately rinse with clean water and consult a doctor. Do not rub eyes.

May cause loss of eyesight.

WARNING



Compulsory

If Battery fluid gets on your skin or clothing, immediately stop handset use and rinse with clean water.

Battery fluid may harm your skin.



Compulsory

If Battery is not fully charged even after specified charging time, stop charging.

May cause Battery to leak, overheat, rupture or ignite.



Compulsory

When you sense something is wrong such as strange odors, emission of smoke, discoloration, or deformation etc. while using, charging or storing Battery, be careful to not get burned or injured, and remove Battery, furthermore keep away from open flames.

If used while there are anomalies, Battery may leak, overheat, rupture or ignite.



Compulsory

Be sure that pets do not bite on them. Also, do not use batteries that pets have bitten on.

May cause Battery to leak, overheat, rupture or ignite, and may cause malfunction or fire.

CAUTION



Prohibited

Do not dispose of unneeded batteries in ordinary trash.

Cover terminals with tape, separately recycle them, or take them to your nearest "SoftBank Shop." In municipalities where batteries are separately disposed of, handle them in accordance with the laws.

301Z

WARNING



Prohibited

Do not use handset while operating vehicles such as automobiles, motorcycles, and bicycles, etc.

May cause traffic accidents. Usage of mobile phones while operating vehicles is prohibited by law, and is subject to criminal punishment. For drivers who are going to use handset, park in safe places where parking is not prohibited, then use.



Prohibited

Do not cover or wrap with clothing or bedding during charging. Also do not sleep with it covered over by blankets or bedding.

Heat may build up resulting in fire, burns, or malfunction.



Compulsory

Keep handset power off near high precision electronic devices or devices using weak signals. Handset may cause these devices to malfunction.

*Devices that may be affected
Hearing aids, implanted cardiac pacemakers, implanted defibrillators and other electronic medical equipment; fire alarms, automatic doors and other automatic control devices.



Compulsory

Power off handset on board airplanes. If set (alarm functions, etc.) to automatically power on, deactivate setting then power off.

May be detrimental to aircraft safety. Powering on mobile phones on board airplanes is prohibited by law, and is subject to criminal punishment.



Compulsory

People with weak hearts, be careful when setting vibration (vibrates) or volume of incoming communications.

May cause heart problems.



Compulsory

If thunder is heard while outside, immediately seek shelter.

Failing to do so may attract lightning and cause electric shock.



CAUTION



Prohibited

Do not use handset in a vehicle if it affects in-vehicle electronic devices.

Use of handset in some types of vehicles may, in some rare cases, affect in-vehicle electronic devices and interfere with safe driving.



Prohibited

Keep handset away from magnetic cards.

Failing to do so may cause magnetic data on a cash card, credit card, telephone card or floppy disk to be lost.



Compulsory

If skin abnormality occurs with use of handset, immediately discontinue use and consult a doctor.

Handset contains metals, etc. Depending on your physical condition, you may experience itchiness, rash, etc.

Parts	Materials/Finishes
Outer Case (rear)	PC
Outer Case (Battery)	Base: FR4; Metal part: Coating; Seal: PET
Battery Cover	PC/UV finish
Display	PMMA/Serigraph
Keys (black)	PC/Paint, Laser etched
Keys (silver)	PC/NCVM, Laser etched
USIM Card Slot	Metal part: Copper alloy/Nickel coating; Resin part: LCP
SD Card Slot	Metal part: Stainless steel/Nickel zinc coating; Resin part: LCP
External Device Port	Metal part: Stainless steel/Nickel zinc coating; Resin part: LCP
Earphone Jack	Metal part: Copper alloy/Nickel coating; Resin part: LCP
Camera (lens)	Glass/Serigraph
Camera Ring (silver)	PC/UV finish
Battery terminals	Metal part: Copper alloy/Nickel coating; Resin part: LCP
Screws	Zinc alloy/Black zinc coating

■ Materials List

Parts	Materials/Finishes
Outer Case (Display)	PC/UV finish
Outer Case (side)	PC/UV finish, Serigraph



Compulsory

If handset is used for a long time, do not charge, use or leave handset in places subject to high temperatures (near open flames or heating equipment, in direct sunlight or inside of cars on hot days). In addition, be careful since handset and charger get hot in warm places or places (kotatusu, electric blankets and pocket heaters in pockets, etc.) easily stifled with heat.

Touching with skin and using for a long time may cause low temperature burns.



Compulsory

If handset is used for a long time while charging, since handset and charger may get hot, do not touch portions that get hot for a long time.

May cause low temperature burns.

USIM Card, SD Card (Commercial Item)



Prohibited

Do not use excessive force when installing or removing USIM Card.

Doing so may cause a malfunction. Be careful not to injure your hands or fingers when removing USIM Card.



Prohibited

Install specified USIM Card only.

Using other USIM Cards may cause malfunction/data loss.



Prohibited

Contact with IC chip on USIM Card is a potential cause of data loss or failure. Please avoid unnecessary contact.



Prohibited

USIM Card may be hot during using handset. It is able to be used normally.



Prohibited

Do not insert objects other than SD Card into SD Card Slot.

Doing so may cause overheating, electric shock or malfunction.



Prohibited

Do not subject SD Card to vibration or shock or remove it from SD Card Slot while data is being written onto or read from SD Card.

Doing so may cause data loss or malfunction.



Prohibited

Use only SD Card supported by handset.

Failing to do so may cause data loss or malfunction.

AC Charger (ZECAP1), Micro USB Cable (ZEDAD1)

WARNING



Prohibited

Do not cover or wrap with clothing or bedding during charging. Also do not sleep with it covered over by blankets or bedding.

Heat may build up resulting in fire, burns, or malfunction.



Prohibited

Use specified power supply and voltage.

Failing to do so may cause fire or malfunction.

AC Charger: 100 to 240 V AC (for household AC outlets only)

Also, do not use commercially available voltage converters, as when traveling. May cause fire, electric shock or malfunction.



Prohibited

If thunder is audible, do not touch AC Charger.

May cause electric shock.



Do Not Use
Wet Hands

Do not plug/unplug AC Charger or terminals with wet hands.

May cause electric shock or malfunction.



Compulsory

If dust accumulates on AC Charger plug, hold plug and unplug AC Charger from outlet and wipe with a dry cloth.

Failing to do so may cause fire.



Compulsory

When plugging AC Charger into outlet, keep conductive materials (pencil lead, metal parts, necklaces, hair pins, etc.) away from AC Charger plug/Micro USB Cable terminals and plug AC Charger firmly into outlet.

Fire, burns or malfunction may result due to electric shock or shorting.



Compulsory

Supplied Micro USB Cable is only for charging handset. Do not use charging equipment of third-party products.

If any damage such as short-circuiting, fire or failure has occurred by using supplied Micro USB Cable for charging the third-party products, SoftBank Mobile is not liable for any damages resulting from use of this cable.



Disconnect
Power Source

When not using, hold AC Charger and unplug the power plug from outlet.

When power plug is left plugged in, electric shock, fire or malfunctions may result if foreign objects or liquids get on AC Charger plug, or if AC Charger plug is stepped on.



Disconnect
Power Source

If liquid (water, pet urine, etc.) gets into AC Charger, immediately hold plug and unplug AC Charger from outlet.

Failing to do so may cause electric shock, smoke emission or fire.

CAUTION



Prohibited

When AC Charger is connected to an outlet, do not pull on cord or otherwise subject AC Charger to strong shock.

May cause injury or malfunction.



Prohibited

Do not pull, bend with excessive force or twist Micro USB Cable. Do not damage or modify Micro USB Cable. Do not place objects on Micro USB Cable. Do not apply heat and keep Micro USB Cable away from heaters.

Damage to Micro USB Cable may cause electric shock, overheating or fire.



Prohibited

Do not use with damaged AC outlets, or with AC Charger loosely plugged in.



Prohibited

Be sure to do not touch plug with portions of your body such as your hands or fingers, etc.

That may cause burns, electric shocks, injuries or malfunctions.



Compulsory

When unplugging AC Charger from outlet, do not pull on the cord, hold AC Charger and unplug it.

The cord is damaged if it is pulled on, electric shock or fire etc. may result.



Compulsory

When AC Charger is connected to a power strip, do not exert excessive force on the exterior by stepping on it.

Fire or malfunctions may result.



Disconnect Power Source

Firmly hold plug and unplug AC Charger from outlet before cleaning.

Failing to do so may cause electric shock.

Handset Use & Electronic Medical Equipment

The contents printed herein were referenced from contents of, "Policies in Regards to Usage of Mobile Telephone Terminals, etc. for Preventing the Effects of Radiowaves on Electronic Medical Equipment," (Electromagnetic Compatibility Conference Japan [April 1997]), and "Policies for Preventing the Radiowaves Used by Various Devices from Exerting Effects upon Implanted Medical Devices," (Ministry of Internal Affairs and Communications [January 2013]).



Compulsory

Keep handset a minimum of 15 centimeters away from implanted cardiac pacemakers or implanted defibrillators.

Radio waves may interfere with operation of implanted cardiac pacemakers or implanted defibrillators.



Compulsory

When using electronic medical equipment (other than implanted cardiac pacemakers/defibrillators) outside of medical institutions, consult device manufacturer about influence of radio waves.

Radio waves may interfere with operation of electronic medical equipment.

General Use

- If a USIM Card, or a USIM Card equipped handset is stolen or lost, be sure to contact Customer Service (P.10-1), after contacting us, perform emergency usage suspension procedures.
- Handset accommodates software updates. Use the latest software.
- Handset employs radio waves. Signals may be disrupted even within service areas if you are indoors, underground, inside a tunnel or inside a vehicle. If you move to a location with poor signal strength, a call may be suddenly cut off.
- When using handset in public places, take care not to annoy other people around you. Use of handset is prohibited in some public places such as in theaters or on buses and trains.
- Handset is a wireless station under Japanese Radio Law. You may be requested to submit your handset for inspection based on this law.
- In the following cases, information contents saved in handset and SD Card may be altered, or lost. Be forewarned that SoftBank does not take responsibility for altered, or lost information contents. To minimize damages that are associated with altered, or lost information contents, take notes of important contents and save them.
 - Handset is used improperly.
 - Handset is exposed to static electricity or electrical noise.
 - Handset is turned off during operation.
 - Handset malfunctions or is sent for repairs.
- Connection speed may drop or connections may not be established depending on line traffic or connection environments.
- Do not use handset in or near places where explosives are handled. Handset use may lead to an explosion, or affect explosion devices.



Compulsory

Handset radio waves may affect electronic medical equipment. Observe these guidelines in medical institutions:

- Do not bring handset into an operating room, ICU (Intensive Care Unit) or CCU (Coronary Care Unit).
- Turn off handset in hospital wards. If set (alarm functions, etc.) to automatically power on, deactivate the setting then power off.
- Turn off handset even in lobbies or areas where use is permitted if there is electronic medical equipment nearby.
- Observe instructions of individual medical institutions and do not use or bring handset into prohibited areas.



Compulsory

Since persons who might have implanted cardiac pacemakers or implanted defibrillators may be in the vicinity, if you cannot ensure that a distance of 15 cm or more can be maintained in crowded conditions where you cannot freely move, switch handset in advance to a state (e.g.: Flight Mode) whereas it cannot be used to communicate, or either power off mobile phones. If set (alarm functions, etc.) to automatically power on, deactivate setting then power off.

Radio waves may interfere with operation of implanted cardiac pacemakers or implanted defibrillators.

- Handset USIM Card cannot be used with some mobile devices (including previously sold SoftBank models).
- Handset may get warm while it is being charged or used for a long time.
- Low temperature burns may result if handset is kept in contact with skin for a long time.
- AC Charger gets warm during charging.

Restrictions While Talking/Communicating

- Note that call and communication charges apply even while using or operating other functions simultaneously while talking/communicating.

Camera

- Use camera functions by observing conventional morals.
- When photographing important scenes, be sure to take a test shot, and show image to check that it is properly being photographed.
- Do not photograph in places where photographing is prohibited.
- Except for one's personal enjoyment, images that are shot using camera functions are to be used without having to obtain permission of the owner of copyright (photographer), which cannot be transferred.

Images

- Image data saved on SD Cards with handset may not be able to be used with other handsets.

Emergency Alert Messages

- At the time of purchase, Emergency Alert setting is set to "On."
- Handset beeps when received even in Manner Mode.
- It cannot be received while talking, communicating, or when signal is poor.
- Depending on your usage environments and conditions, information may be received relating to your present location and different areas, or it might not be received.
- If Emergency Alert setting is set to "On," standby time might be shorter.
- SoftBank does not take responsibility for damages generated in relation to this service, which includes accidents caused by information contents, reception timing, and reception or non-reception of information.

Handset & Hardware Care

- Note that if Battery level is left depleted, your saved details and settings will be lost or altered, thus handset will no longer be usable. Moreover, please be forewarned that SoftBank does not take responsibility for damages generated in regards to this.
- Avoid exposing handset to rain, snow or high humidity. Handset is not waterproof.
- Do not use handset in extreme temperatures, direct sunlight or humid or dusty places.
- Do not drop handset or subject it to excessive shock.
- To clean handset, wipe it with a dry soft cloth. Do not use alcohols, thinners, benzene or other solvents. Doing so may cause discoloration and remove the print.

Portrait Rights

Portrait rights are the right for someone to be able to assert that they do not wish to have their photograph taken without permission by other people, nor to have taken photographs be disclosed, nor to be used without permission. Portrait rights may be personal rights that are acknowledged by everyone, and may be property rights that focus attention on the economic benefits (publicity rights) of celebrities, etc. Consequently, since the unauthorized taking, publicizing, and distribution of the photographs of other people and celebrities may constitute malfeasance, please endeavor to appropriately use camera functions.

Copyrights

The rights of works and the owners of copyrights are protected in accordance with the copyright laws for music, images, computer programs, databases, etc. Replication of these works can only be conducted for the purpose of personal or household usage. Beyond the objectives of the aforementioned, if distribution of these replications (including data format conversions), modifications, and transferral of replicates is conducted over networks without comprehension of the right holders, then one might be liable to claims for indemnification for damages and criminal punishment with regard to "copyright infringements," and "infringements of the author's moral rights." When handset is used for making replications, etc., beyond observing copyright laws, we request that you endeavor to engage in appropriate usage. In addition, since handset is equipped with camera functions, we wish to request that you endeavor to engage in usage appropriate in a manner likewise to the aforementioned.

- Do not personally engage in replicating or modifying, disjoining from the hardware, reverse assembling, reverse compiling, and reverse engineering of the software in its entirety or in portion which is equipped in handset, nor allow third parties to do so without permission of the separate copyright owners. Also do not engage in such usage.

- SoftBank, SoftBank's equivalent in Japanese and the SoftBank logo are registered trademarks or trademarks of SoftBank Mobile Corp. in Japan and other countries.
- S! Mail and S! Basic Pack are registered trademarks or trademarks of SoftBank Mobile Corp.
- ZTE, ZTE中興, and ZTE logo are trademarks or registered trademarks of ZTE Corporation in China/other countries. Copyright © 2014 ZTE Corporation. All rights reserved.
- Handset (in a portion of SoftBank mobile telephone) is equipped with the Internet browser NetFront Browse and mailer NetFront Messaging Client from ACCESS Co., Ltd. Copyright© 2002-2014 ACCESS CO., LTD. ACCESS and NetFront are trademarks or registered trademarks of ACCESS Co., Ltd. in Japan or other countries. A module developed by Independent JPEG Group is included in a portion of the handset's software.

ACCESS NetFront®

- microSD and microSDHC logos are trademarks of SD-3C, LLC.
-  is a registered trademark of Yahoo! Inc. in the U.S..
- The names of companies, products, and services use in this guide are registered trademarks or trademarks of the respective companies.

Specific Absorption Rate (SAR) for This Product

This mobile phone [301Z] meets the MIC's* technical regulation** and international guidelines for exposure to radio waves.

The MIC's technical regulation* for exposure to radio frequency energy established permitted levels of radio frequency energy, based on standards developed by independent scientific organizations through periodic and thorough evaluation of scientific studies.

The regulation employs a unit of measurement known as the Specific Absorption Rate, or SAR.

The SAR limit is 2 watts/kilogram (W/kg) averaged over ten grams of tissue.

The limit includes a substantial safety margin designed to assure the safety of all persons, regardless of age and health.

The value of the limit is equal to the value given in international guidelines recommended by ICNIRP***.

The highest SAR value for this mobile phone is 1.07 W/kg when tested for use at the ear, and 0.502 W/kg when worn on the body in the below manner.

While there may be differences between the SAR levels of various phones and at various positions, all phones meet the MIC's technical regulation.

Although the SAR is determined at the highest certified power level, the actual SAR of the phone during operation can be well below the maximum value.

Use at positions other than at the ear

Use this mobile phone maintaining a 1.0 cm separation with no metal (parts) between the body and the mobile phone. When used in this manner, this mobile phone is confirmed to comply with the MIC's technical regulation for exposure to radio waves and international guidelines for radio wave protection.

* Ministry of Internal Affairs and Communications

** The technical regulation is provided in Article 14-2 of the Ministry Ordinance Regulating Radio Equipment.

*** International Commission on Non-Ionizing Radiation Protection

The World Health Organization has announced that "A large number of studies have been performed over the last two decades to assess whether mobile phones pose a potential health risk. To date, no adverse health effects have been established as being caused by mobile phone use."

For more information about SAR, see the following websites:

Ministry of Internal Affairs and Communications (MIC)

<http://www.tele.soumu.go.jp/e/sys/ele/body/index.htm>

Association of Radio Industries and Businesses (ARIB)

<http://www.arib-emf.org/index02.html> (Japanese)

Customer Service

Feel free to contact us at the following Customer Service Centers, when you experience problems, or if anything is unclear.

■ SoftBank Customer Support

General Information

From a SoftBank handset, dial toll free at 157

From a landline, dial toll free at 0800-919-0157

Customer Assistance (loss or malfunction)

From a SoftBank handset, dial toll free at 113

From a landline, dial toll free at 0800-919-0113