

SoftBank 002P

User Guide



SoftBank

Introduction

Thank you for purchasing SoftBank 002P.

- Read this guide thoroughly beforehand for proper usage.
- Accessible services may vary by service area, subscription, etc.

SoftBank 002P is compatible with both 3G and GSM network technologies.

Note

- Unauthorized copying of any part of this guide is prohibited.
- Guide content is subject to change without prior notice.
- Efforts have been made to ensure the accuracy and clarity of this guide. Please contact SoftBank Mobile Customer Center, General Information (☎ P.9-19) about unclear or missing information.

Getting Started

Contents

Getting Started

Contents	1-1
Package Contents	1-2
Using This Guide	1-2
USIM Card Installation	1-4
Charging Battery	1-5
Memory Card Installation	1-6
Parts & Functions	1-7
Basic Operations	1-9
Display	1-10
Handset Menus	1-11
Handset Security	1-13
Mobile Manners	1-14

Text Entry

Entering Text	2-1
Editing Text	2-4

Calling

Emergency Calls	3-1
Voice Calls	3-1
Video Calls	3-2
International Calls	3-3
Answer Phone	3-5
Optional Services	3-6
Phone Book	3-10

Messaging

Basics	4-1
Customizing Handset Address	4-2
Sending S! Mail & SMS	4-3
Receiving Messages	4-4

Internet

Getting Started	5-1
Accessing Internet	5-2
Bookmarks & Saved Pages	5-3
Internet Settings	5-4

Connectivity

Infrared	6-1
External Devices	6-3

Camera & Imaging

Before Using Camera	7-1
Capturing Still Images	7-4
Recording Videos	7-4
Other Camera Functions	7-5

Digital TV

Initial Setup	8-1
Watching TV	8-1

Appendix

Handset Data Backup	9-1
Software Update	9-2
Troubleshooting	9-3
Safety Precautions	9-5
Handling Precautions	9-11
Copyrights	9-15
Specific Absorption Rate (SAR)	9-17
Specifications	9-18
Support	9-18

Package Contents

☐ Handset (002P)

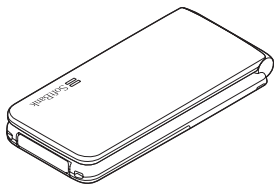

☐ Battery (PMBAS1)

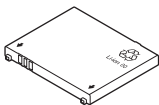

☐ Quick Start Guide (Japanese)

☐ Safety Precautions (Japanese)

Note

- Use SoftBank Mobile specified AC Charger (sold separately) to charge battery.
- For more information about AC Charger and accessories, please contact SoftBank Mobile Customer Center, General Information (☎ P.9-19).
- 002P accepts microSD Card (not included). Purchase one to use related functions (☞ P.1-6, P.9-1).

Using This Guide

Before reading on, please make note of the following:

- SoftBank 002P is referred to as "handset" or "002P."
- "microSD Card" is referred to as "Memory Card."
- Screenshots, etc. are for reference. Actual handset windows, menus, etc. may differ.
- Key icons are simplified.
- Most operation descriptions begin in Standby.
- Pressing a key for more than one second is described as "Press and hold."

Guide Symbols

Softkeys

Press the corresponding key to execute the function or operation indicated at the bottom of Display.

Example:

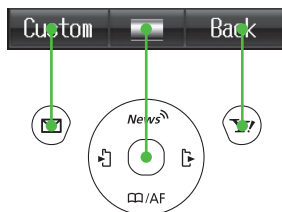

Multi Selector

Use Multi Selector to select items, navigate menus, etc. In this guide, Multi Selector operations are indicated as shown below.

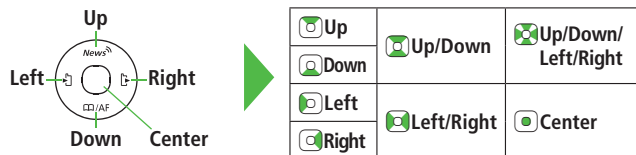

Japanese Functions & Services

When "(Japanese)" appears in a title, Japanese ability is required to use full range of the function or service.

USIM Card Installation

- Always turn off handset power before removing battery (☞ P.1-5).
- USIM PINs: ☞ P.1-13

Inserting

- 1 With IC chip down, insert USIM Card

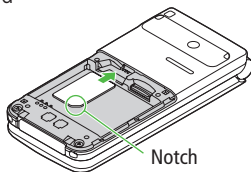

Removing

- 1 Slide out USIM Card gently

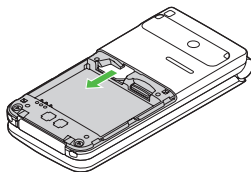

Important

- USIM Card is the property of SoftBank Mobile.
- Return USIM Card to SoftBank Mobile upon service cancellation.
- USIM Card will be reissued for a fee if lost or damaged.
- If USIM Card/handset with USIM Card installed is lost or stolen, contact SoftBank Mobile Customer Center or Global Call Center (☞ P.9-19).
- Back up USIM Card files. SoftBank Mobile is not liable for lost files.
- USIM Card specifications/performance may change without prior notice.
- Pre-installed S! Appli may be unusable while a different or replacement USIM Card is installed.
- Some downloaded files may be inaccessible after upgrades/repairs, USIM Card/handset replacement.
- Returned USIM Cards are recycled.

Note

- Do not forcefully insert/remove USIM Card; may damage handset/USIM Card.
- Avoid touching USIM Card terminals or IC chip; doing so may hinder performance/USIM Card recognition.

Charging Battery

Battery Installation

- Always turn off handset power before removing battery.

1 Press and slide to remove cover

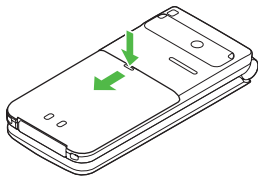

2 Insert Battery

Align battery contacts with handset pins

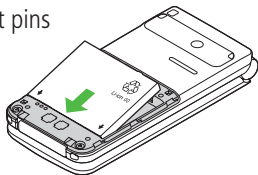

Remove Battery

Lift battery out as shown

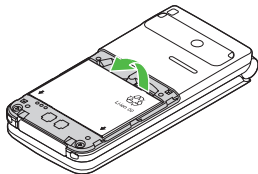

3 Replace battery cover

Cover should click into place.

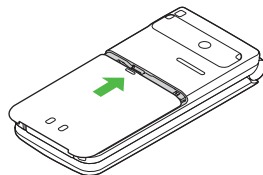

Note

- Lithium-ion batteries are valuable and recyclable resources.
 - Recycle used lithium-ion battery at shops displaying this symbol:
 - To avoid fire or electric shock, do not:
 - Short-circuit battery
 - Disassemble battery



Li-ion 00

eco Mode

Activate eco Mode to extend battery time. Set Auto eco Mode to activate automatically when remaining battery strength reaches set level.

- eco Mode cannot be activated/deactivated in Standby or while S! Appli/Digital TV is active.

1 Press and hold

- To cancel: Press and hold  again

■ Set Auto eco Mode

> **Main Menu** ► **Settings** ► **Battery/eco Mode Settings**
► **Auto eco Mode** ► Select a level (To cancel: **OFF**)

Charging Battery

Use only specified AC Charger (sold separately).

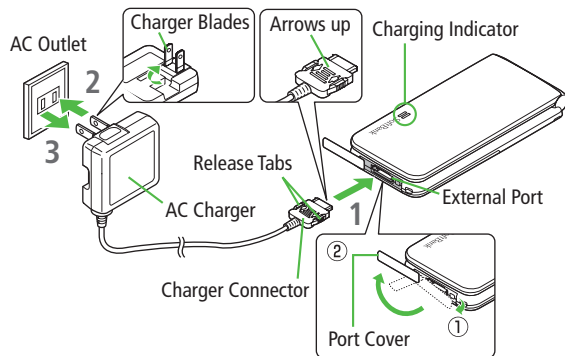

- 1 Connect AC Charger to handset
- 2 Extend Charger Blades, and plug AC Charger into AC Outlet
Charging Indicator illuminates and charging starts.
When charging is complete, Charging Indicator goes out.
- 3 When charging is complete, unplug AC Charger, then disconnect handset
Squeeze Release Tabs to remove Charger Connector, and replace Port Cover.

Memory Card Installation

- Power off handset before inserting/removing Memory Card.
- Battery Installation: ➡ P.1-5
- Handset Data Backup: ➡ P.9-1

Inserting

- 1 Insert Memory Card until it clicks

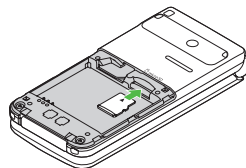

Format Memory Card

> Main Menu ► Settings ► Memory Card Manager

► Format Memory Card ► Enter Phone Password

- Formatting Memory Card deletes all saved files/data.
- Do not power off handset or remove Memory Card while formatting; may damage handset or Memory Card.

Removing

- 1 Push Memory Card in
 - Memory Card pops out with a light push.

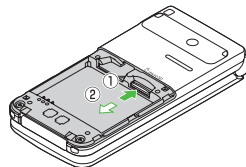

Parts & Functions

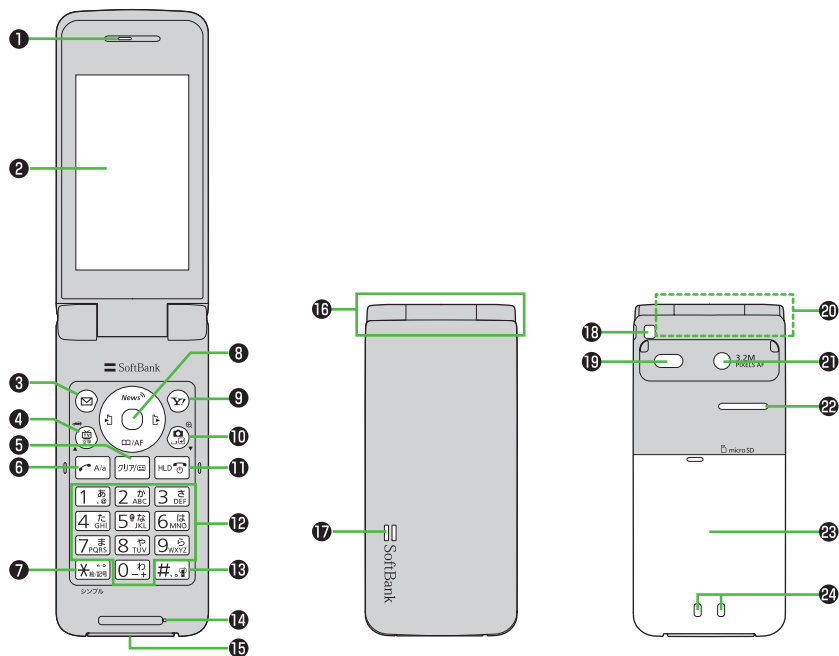

Getting Started

1 Earpiece

2 Display

3 Mail Key

- Open Messaging menu
- Execute Left Softkey function

4 TV/Input Mode Key

- Activate TV
- Toggle input modes in text entry windows
- Toggle Drive Mode on/off

5 Clear/Memo Key

- Delete characters
- Cancel menus
- Use Answer Phone





6 Send Key

- Initiate or answer calls
- Toggle upper/lower case in text entry windows

7 */Simple Mode Key

- Enter "✱"
- Toggle pictograph/symbol lists in text entry windows
- Toggle Simple Mode on/off

8 Multi Selector

- Scroll up/down/left/right to navigate menus and text
-  Open/Select Standby Window (Unavailable in Simple Mode)
-  Open Phone Book; set Auto Focus Lock
-  Open Incoming Call Logs
-  Open Outgoing Call Logs

9 Yahoo! Keitai Key

- Open Yahoo! Keitai top menu
- Execute Right Softkey function

10 Camera/Line Break Key

- Activate Camera; activate Magnifying Loupe
- Enter a line break
- Toggle letters in reverse order in text entry windows

11 End/Escape & Power Key

- Power on/off ( P.1-9)
- End calls
- Return to Standby
- Place call on hold

12 Keypad

- Enter phone number/text

13 #/Manner Mode Key

- Enter "##"
- Toggle Manner Mode on/off

14 Microphone

15 External Port

- Connect AC Charger or other accessories here

16 Hinge

17 Notification Light/Charging Indicator

- Flashes for incoming transmissions; flashes while Camera is active
- Lights red for charging

18 Strap Eyelet

19 Infrared Port

- Transfer data via Infrared

20 Antenna

21 Camera

22 Speaker

23 Battery Cover

24 Charging Terminals

Basic Operations

Power On/Off

1 Power On

Press  for 3+ seconds

Start-up window appears and handset enters Standby.

Power Off

Press  for 2+ seconds

Handset shuts down.

The First Time Handset Powers Up...



Setup window appears.

Enter date → Enter time (24 hours)

Day of the week is set automatically.

■ Keyguard





Lock handset keys to prevent accidental operation.

> In Standby, press and hold  → 

● To cancel: In Standby,  →  [YES]

● While Keyguard is active, handset will not power down.

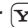
Retrieving Network Information

Pressing ,  or  for the first time in Standby may initiate Network Information retrieval; press  to retrieve it.

● Update Network Information to use messaging, Internet, etc.

● Update Network Information manually: **Main Menu** ► **Settings**

► **Phone Settings** ► **Retrieve NW Info** ► 

English Interface

Main Menu ► **設定** ► **一般設定** ► **Language** ► **English**

● **Automatic** applies USIM Card language.

Date & Time

Main Menu ► **Settings** ► **Phone Settings** ► **Date & Time**

1 **Home Clock** → **Date & Time** → Enter date → Enter time

■ **Set Second Time Zone (Away Clock)**

> In Step 1, **Away Clock** → **Set Time Zone** → Select a city →  → **Select Clock** → **Away Clock**

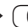

My Number

1  → 



■ **Edit Account Details**

Save phone number, mail address, street address, etc. in Account Details.

● Handset phone number cannot be edited or deleted.

> After Step 1,  [Menu] → **Edit** → Edit →  [Save]

■ **Send Account Details via S! Mail/Infrared**

> After Step 1,  [Menu] → **Send** → **Attach to S! Mail** or **Infrared** → Operate selected item (S! Mail:  P.4-3/Infrared:  P.6-1)

Display

Icons & Indicators

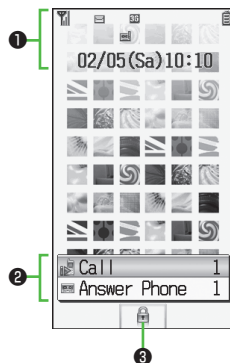

1 Display Indicators

Signal Strength

- Strong Moderate Weak Low
- Out-of-Range
- Offline Mode Active
- (Red) Only Packet Transmission Available

Battery Level

- → → (Red)

Data Transmission

- 3G/GSM Packet Transmission Enabled
- 3G/GSM Packet Transmitting

Network Service

- 3G Packet Transmission Available
- GSM Packet Transmission Available
- Memory Card installed
- Unread Message
- Software Update (Notification/Updating/Result)
- Digital TV Active
- PC Site Browser Active
- Infrared Active
- USB Cable Connected
- eco Mode Active
- Auto eco Mode Active
- Secure Content
- Manner Mode Active
- Drive Mode Active
- Roaming

- Mute & Vibration Active
- Call Forwarding or Voicemail Active
- Voicemail
- Answer Phone Active
- Answer Phone Full
- New Message Recorded

2 Information Window (P.1-11)

3 Keyguard (P.1-9)

Getting Started

Information Window

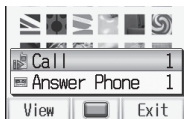

In Standby, Information Window opens for missed events.
Select a notification to view/access information.

- 1 Highlight an item → 
Follow onscreen instructions.





Standby Window

Access Shortcuts from Standby Window.

In Standby, press  to show/hide Standby Window; use  to show Standby Window and select items.





Accessing Functions from Shortcuts

- 1 In Standby,  → Select an icon
The selected icon is highlighted and function name appears at top of panel.
 - To deselect: 





- 2  to access function

Add Shortcuts

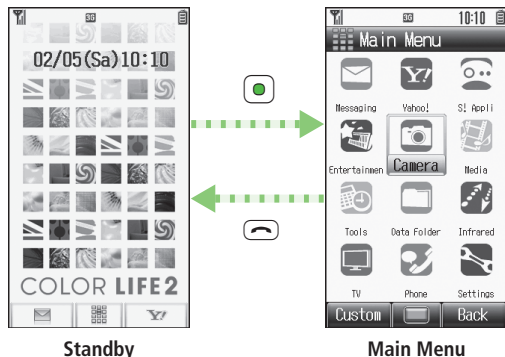
> In Standby,  → highlight target → [Menu] → **Set Shortcut** →
Select an item → Highlight a function, bookmark or Phone Book entry →
[Entry]

Handset Menus



- 1 In Standby, 
Main Menu appears.
- 2  to highlight an icon → 
Selected function menu appears.
 - To return to Standby: 

Function List

Messaging

Incoming Mail
Create New S! Mail
Retrieve New
Drafts
Templates
Sent Messages
Unsent Messages
Server Mail Box
Create New SMS
Settings
Memory Status

Yahoo!

Yahoo! Keitai
Menu List
Bookmarks
Saved Pages
Web Search
Enter URL
History
PC Site Browser
Settings

S! Appli

S! Appli List
S! Appli Settings
Information

Entertainment

S! Information Channel/Weather
S! Quick News
Free Contents

Camera

Camera
Video Camera
Bar Code Reader
Magnifying Loupe

Media

Audio
Video

Tools

Alarms
Calendar
Calculator
Notepad
Count Down Timer
Answer Phone
Voice Recorder
Bar Code Reader
Software Update
One Touch Guide

Data Folder

Pictures
Ring Songs/Tones
S! Appli
Music
Videos
Books
Customized Screen
Templates
Flash(R)
Other Documents
Memory Status

Infrared

Infrared ON/OFF
Send Account Details
Send All Phone Book

TV

Watch TV
Program List
TV Link
Channel List
Channel Settings
User Settings

Phone

Phone Book
Create New Entry
Mail & Call Log
Group
Account Details
One Touch Key
S! Addressbook Back-up
Memory Manager
Settings
Memory Status

Settings

Sound Settings
Display Settings
Customized Screen
Phone Settings
Security
Call Settings
Manner Mode Settings
Location Settings
Memory Card Manager
Key Settings
Battery/eco Mode Settings

Handset Security

USIM PINs

PIN	4 to 8-digit code used to prevent unauthorized handset use. <ul style="list-style-type: none">When PIN Certification is ON, PIN entry is required each time handset is turned on (with USIM Card installed).
PIN2	Required for call cost setting.

- PIN and PIN2 are set to **9999** by default.

PIN Certification

Main Menu ► **Settings** ► **Security** ► **PIN Certification**

1 **ON** or **OFF** → Enter PIN

PIN/PIN2 Lock & Cancellation (PUK/PUK2)

PIN Lock or PIN2 Lock is activated if PIN or PIN2 is incorrectly entered three times. Cancel PIN Lock or PIN2 Lock by entering PIN Unblocking Key (PUK/PUK2).

- For information about PUK/PUK2, contact SoftBank Mobile Customer Center, General Information (☎ P.9-19).

Note

- If PUK/PUK2 is incorrectly entered ten times, USIM Card is locked and handset is disabled. Write down PUK/PUK2.
- For procedures required to unlock USIM Card, contact SoftBank Mobile Customer Center, General Information (☎ P.9-19).

Passwords

Phone Password

<Default> 9999

4 to 8-digit number required to use/change some handset functions.

Change Phone Password

- > Main Menu** ► **Settings** ► **Security** ► **Change Password**
- Enter current Phone Password ► Enter new Phone Password
 - Reenter new Phone Password

Center Access Code (Call Barring Password)

4-digit number specified at initial subscription; required to access Voicemail via landlines, subscribe to paid content or restrict handset services.

- For procedures required to change Center Access Code, contact SoftBank Mobile Customer Center, General Information (☎ P.9-19).
- If entered incorrectly three times, Call Barring settings lock; Center Access Code must be changed.
- If Call Barring Password has been changed on handset, enter the number to activate/deactivate Call Barring.

Note

- Write down Phone Password and Center Access Code. Do not reveal Phone Password and Center Access Code. SoftBank Mobile is not liable for misuse or damages.

Mobile Manners

Minding Mobile Manners



Please use your handset responsibly. Use these basic tips as a guide. Inappropriate handset use can be both dangerous and bothersome. Please take care not to disturb others when using your handset. Adjust handset use according to your surroundings.

- Turn it off in theaters, museums and other places where silence is the norm.
- Refrain from use in restaurants, lobbies, elevators, etc.
- Observe signs and instructions regarding handset use aboard trains, etc.
- Refrain from use that interrupts the flow of pedestrian or vehicle traffic.

Manner-related Features

Manner Mode	Mute handset tones and activate vibration for incoming transmissions.
Vibration	Activate in public places, meetings, etc. for silent call/message alerts.
Ringer Volume	Adjust call/message tones, etc.
Offline Mode	Suspend all handset transmissions.
Answer Phone	Use to handle incoming calls when inappropriate/unsafe to answer.
Drive Mode	While driving, send a voice message informing the caller that you cannot answer the call. (Handset does not ring.)

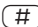
Manner Mode



- 1 In Standby, press and hold  **#**
 appears.
 - To cancel: Press and hold  again

Offline Mode

Main Menu ► Settings ► Call Settings ► Offline Mode

- 1 **ON** or **OFF**
 appears.
 - To cancel: Follow the same steps

Drive Mode

- 1 In Standby, press and hold  **TV**
 appears.
 - To cancel: Press and hold  again

Text Entry

Entering Text

Enter alphanumerics, hiragana, kanji, katakana, symbols and pictographs.





Help

Help describes text entry operations.

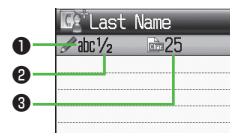
> In text entry window,  [Menu] → *Help* → Select an item

Text Entry Window



① Input Modes	Operations
漢: Kanji (Hiragana) ｶ: Katakana abc: Alphanumerics 123: Numbers	
② Double-byte/Single-byte	Operations
1/1: Double-byte 1/2: Single-byte	Press and hold 
③ Character/Byte Count	
 Remaining number of enterable characters appears, regardless of input mode.	
 Remaining enterable memory (in bytes) appears.	

Note

- Follow these steps to select input mode:

 [Menu] → *Input Options* → *Change Input Mode*

Entering Characters

Example: Enter 鈴木

- 1 In alphanumerics mode,  twice to switch to kanji (hiragana) mode

す:  three times

ず:  * →  three times → 

き:  twice

* When the next character is on the same key, press  first to move cursor.

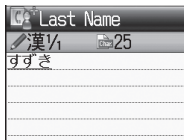





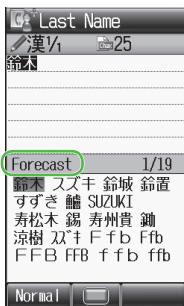



- 2  to enter Forecast List

- To exit list: 

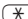

- 3  to select 鈴木

Other Input Functions

Enter katakana/alphanumerics	 for input mode → Enter characters
Enter small kana (っ, っ, etc.)	Enter a character →  <ul style="list-style-type: none"> Alternatively, press a key repeatedly for assigned small kana.
Enter uppercase letters	Enter a character →  <ul style="list-style-type: none"> Alternatively, press a key repeatedly for assigned uppercase letter.
Add * or °	Enter a character →  for ° or  twice for ° <ul style="list-style-type: none"> In single-byte katakana mode, enter ° or ° as a single-byte character.
Insert line break	 to insert line breaks in text
Add space at end of text	
Insert space within text	 [Menu] → Insert → Space(Double-byte) or Space(Single-byte)
Reverse toggle	 Example: From c, press a key to toggle as follows: c → b → a → 2...
Undo	 [Menu] → Undo

Pictographs & Symbols

- Pictographs do not appear in messages sent to incompatible SoftBank handsets or most e-mail addresses.

1 Open Pictograph List

In text entry window, (✖)

Open Symbol List

In text entry window, press and hold (#) or (✖) in pictograph list

List Log may appear first.

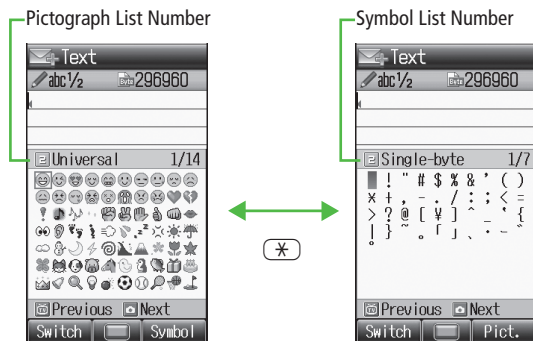

2  to select a pictograph or symbol

Additional Features

From ► In text entry window, (✉)[Menu]

Emoticons

> *Emotions* → Select an emoticon

Use Info from Phone Book/Account Details/Notepad/String Templates

> *Insert* → Select an item

Item	Operation/Description
Phone Book Data*	> Select an entry → Select an item
Account Details*	> Select an item
Notepad	> Highlight a note → (✉)[Set]
String Templates	Insert web and mail extensions > Select an extension

* Available Items: Last Name/First Name, Reading, Phone Number, Email Address, Address or Note.

Enter Kuten Code

> *Input Options* → *Kuten Code* → Enter a character code (4 digits)

Editing Text

Deleting & Replacing

1 Delete Characters within Lines

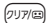
Place cursor before a character → 

A character after cursor is deleted.

- Press and hold  to delete all characters after cursor.

Delete Characters from the End of Text

Place cursor at the end of text → 

A character before cursor is deleted.

- Press and hold  to delete all characters before cursor.

2 Enter another character

Copy/Cut & Paste

1 In text entry window,  [Menu] → *Copy* or *Cut*

2 Select Text to Copy/Cut

Place cursor before (or after) text to select →  →

Place cursor after (or before) text → 

Select All

 [All] → 

3 Paste Text

Place cursor at target location → Press and hold 

Paste Previously Copied/Cut Text

Place cursor at target location →  [Menu] → *Paste* →
Select data

Calling

Emergency Calls

Call 110 (Police), 119 (Fire & Ambulance) or 118 (Coast Guard) even when some handset restrictions are active.

Calling Unavailable in Following Cases:

- While Offline Mode is active
- In PIN entry window upon turning on handset (PIN Certification is **ON**)
- When USIM Card is not installed



Emergency Positioning Request

When an emergency call is made from a mobile phone, location is reported to first response agencies such as the police.

- Location information may be inaccurate due to location or signal conditions.
Describe location or nearby landmarks.
- Base Station Positioning System is accurate within 100 meters to 10 kilometers. Location information from distant base stations may be inaccurate.
- Function available wherever system is installed by first response agencies.
- Dialing 184 before 110, 119 or 118, cancels location report.
However, first responders may obtain location information for immediate and serious threats to life.
- Not available for international roaming.
- Requires no separate subscription or transmission fees.

Voice Calls

Making Voice Calls

- 1 Enter number with area code → 
 - To adjust volume:  or 

- 2  to end call

Call from Call Logs

>  → Highlight a record →  [Menu] → **Call** → **Voice Call**

Make Calls from Phone Book

>  → Select an entry → Highlight a phone number → 



Show/Hide Caller ID

> Enter number →  [Menu] → **My Caller ID** → **Show** or **Hide**

- To always show/hide Caller ID: **Main Menu** ► **Settings** ► **Call Settings**
► **Show My Number** ► **ON**, **OFF** or **Network Set***

***Network Set** Caller ID setting varies by subscription.

Answering Voice Calls

- 1 When a call is received,  to talk
 - To adjust volume:  or 

- 2  to end call

Video Calls

Video Call Window

Example:

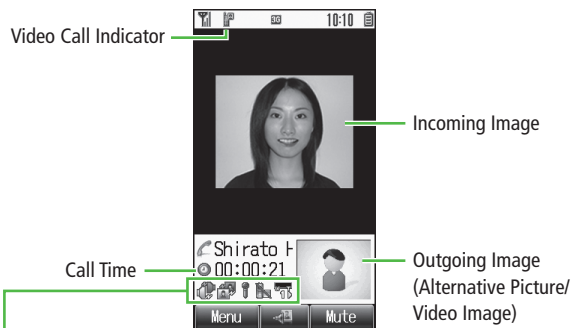

Indicators

Incoming/Outgoing Sound OK	Incoming Image OK/ Outgoing Image NA
Incoming Sound NA/ Outgoing Sound OK	Incoming/Outgoing Image NA
Incoming Sound OK/ Outgoing Sound NA	Microphone ON
Incoming/Outgoing Sound NA	Microphone OFF
Incoming/Outgoing Image OK	Video ON
Incoming Image NA/ Outgoing Image OK	Alternative Picture ON
	Zoom Level (1-25)

- Display appearance may vary by settings/conditions.

Making Video Calls

- 1 Enter number with area code → Alternative Picture is sent.
 - To send Video Image: → **Send Voice & Video**
 - To adjust volume:

- 2 to end call

Call from Call Logs

> → Highlight a record → [Menu] → **Call** → **Video Call**

Make Calls from Phone Book

> → Select an entry → Highlight a phone number →

Answering Video Calls

- 1 When a video call is received, or to talk

Send Video Image

[YES]

Video Image is sent.

Send Alternative Picture

[NO]

Alternative Picture is sent.

- To adjust volume:

- 3 to end call

International Calls

Calling Abroad from Japan

- No application required. See SoftBank Mobile Website: http://mb.softbank.jp/en/global_services/call/

1 Enter a phone number

2  [Menu] → **International Call**

Country/Area Number List appears.

3 Select a country/region



4 **Voice Call**



Video Call

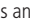

■ **Enter Country/Region Code Directly**

- >  → Press and hold  for + (IDD Prefix) → Enter a country/region code
→ Enter number (omit first 0) → Voice Call: /Video Call: 
- Do not omit leading 0 when calling Italy (country code: 39).

Global Roaming

- May require Global Roaming Service application. See SoftBank Mobile Website: http://mb.softbank.jp/en/global_services/global_roaming/

Example: When Roaming Dial Assistant is ON

- Roaming Dial Assistant (📞 P.3-4) is **ON** by default.



1 **Voice Call**

Enter a phone number → 

Video Call

Enter a phone number → 

2 Select an item

Item	Operation/Description
Call to Japan*	Call Japan
Call to Visited Country/Area	Call within the country/region
Call to Other Country/Area*	Call other countries/regions > Select a country/region → Voice Call:  /Video Call: 
As is Call	Manually enter number to call Select when calling within the country/region

*First 0 is replaced by IDD Prefix and country/region code (e.g. **+81**). (When calling Italy, **+39** is added before first 0.)

Note

- IDD Prefix and country/region code can be manually entered in Step 1.
Alternatively, save IDD Prefix and country/region code in Phone Book entries.

Calling

International Call Settings

Add to Country/Area Number List

- > Within Japan: Enter number → [Menu] → *International Call* → [Menu] → *Add* → Enter country/region name → Enter country/region code
- > Outside Japan: Enter number → Voice Call: [Voice Call Icon] / Video Call: [Video Call Icon] → *Call to Other Country/Area* → [Menu] → *Add* → Enter country/region name → Enter country/region code

Network Mode

<Default> Automatic

- > **Main Menu** ▶ **Settings** ▶ **Call Settings** ▶ **Optional Services**
▶ **International Setting** ▶ **Select Network** ▶ Select an item

Item	Operation/Description
Automatic	Handset automatically selects 3G network in Japan, and available network (3G or GSM) abroad
Manual	<ul style="list-style-type: none">> Select an item<ul style="list-style-type: none">• 3G/GSM : 3G service area in Japan or 3G/GSM abroad. Handset selects an available network automatically.• 3G : 3G service areas in Japan or abroad.• GSM : GSM service areas abroad. Unavailable in Japan.

- *Automatic* is recommended.

Select Operator



<Default> Automatic

- > **Main Menu** ▶ **Settings** ▶ **Call Settings** ▶ **Optional Services**
▶ **International Setting** ▶ **Select Operator** ▶ **Select Auto/Manual**
▶ **Automatic** or **Manual** (▶ For **Manual**, select an operator)

Activate/Deactivate Roaming Dial Assistant

- > **Main Menu** ▶ **Settings** ▶ **Call Settings** ▶ **Optional Services**
▶ **International Setting** ▶ **Roaming Dial Assistant** ▶ **ON** or **OFF**

Answer Phone

- When Answer Phone is active,  appears in Standby.
- Unavailable when: handset is off or in Offline Mode; **OUT** or  (red) appears.
Use Voicemail ( P.3-7).

Activating/Canceling Answer Phone

<Default> OFF

- 1 Press and hold 
 - To toggle settings, repeat operation.

Redirect a Call to Answer Phone



Note

- When full, new messages cannot be recorded even if Answer Phone is activated. Delete old messages ( Right).

Playing Messages

When a new message is recorded, Information Window opens and  appears in Standby.

- 1 In Information Window,
Answer Phone
- 2 Select a message

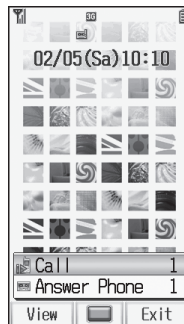

Deleting Messages

Main Menu ► Tools ► Answer Phone ► Message List

- 1 (Highlight a message →)  [Menu]
- 2 **Delete One**
Delete →  [YES]
Delete All
Delete All →  [YES] → Enter Phone Password

Optional Services

- For details, see SoftBank Mobile Website: <http://mb.softbank.jp/en/>

Call Forwarding

Forward unanswerable calls to a preset number when handset is off, out-of-range, etc.

- Call Forwarding and Voicemail cannot be active simultaneously.

Activating Call Forwarding

Main Menu ► Settings ► Call Settings ► Optional Services
► Voice Mail/Call Forwarding

1 **Call Forwarding ON** → Select a type

2 Select an item

Item	Operation/Description
Ringer Off	Forward all calls without ringing/vibrating
Ringer On	Forward missed calls

3 **Select from Phone Book**

Phone Book → Select an entry → Select a phone number

Direct Entry

Direct Entry → Enter a phone number

4 If **Ringer On** is selected in step 2, select ring time

■ Check Call Forwarding Status

> In Step 1, **Confirm Status**

■ Cancel Call Forwarding

> In Step 1, **Cancel All** → 

Note

- Toll free/international numbers cannot be saved as forwarding number.

Vicemail

Unanswered calls are forwarded to Voicemail Center as set or when handset is off, out-of-range, engaged, etc.

- Calls are forwarded to Voicemail Center via Call Forwarding function; Call Forwarding and Voicemail cannot be active simultaneously.
- Voicemail is not available for Video Calls.

Activating Voicemail

Main Menu ► Settings ► Call Settings ► Optional Services
► Voice Mail/Call Forwarding

1 *Voice Mail ON*

2 Select an item

Item	Operation/Description
Ringer Off	Forward all calls without ringing/vibrating
Ringer On	Forward missed calls > Select a ring time

■ Check Voicemail Status

> In Step 1, *Confirm Status*

■ Cancel Voicemail

> In Step 1, *Cancel All* → 

Playing Voicemail Messages

Information Window and  appear in Standby when new messages are recorded.

1 In Information Window, *Voice Mail*

Follow voice guidance.

- When Information Window does not appear,
Main Menu ► Settings ► Call Settings
► Optional Services
► Voice Mail/Call Forwarding ► Listen to Voice Mail.



■ View Details

View callers' phone numbers and date/time Voicemail messages were left before playing messages.

- Activate Missed Call Notification beforehand ( Below).
- >  to open Incoming Call Log → Select a Voicemail notification → View details
→  [Menu] → *Listen to Voice Mail*

Missed Call Notification

When Missed Call Notification function is active, Information Window appears for calls missed while handset was off, out-of-range, engaged etc.

- Available only when Voicemail is active.

Main Menu ► Settings ► Call Settings ► Optional Services
► Missed Call Notification

1

Handset connects to the Network. Follow voice guidance.

Call Waiting

Place the current call on hold and answer a second, or alternate between calls.

- Separate subscription is required for this service.



Activating/Canceling Call Waiting

Main Menu ► Settings ► Call Settings ► Optional Services
► Call Waiting

Current status appears.

- 1  [Menu] → *Activate* or *Deactivate*

Answering Second Call

- 1 When tone sounds, 
 - Press  to alternate between calls.

Reject Second Call

> When tone sounds,  [Reject]

Note

- When Voicemail or Call Forwarding is set to **Ringer On** while Call Waiting is active, unanswered calls are transferred to Voicemail Center or the forwarding number.
- When Voicemail or Call Forwarding is set to **Ringer Off**, Call Waiting is disabled.

Group Calling



Call another party during a call and alternate between calls. Add other parties to talk on up to five lines simultaneously.

- Separate subscription is required for this service.



Dialing New Number during a Call

- 1 Enter a phone number during a call → 
The line switches. The other line is placed on hold.



Swap Calls

- 1 During a call, 
 - Press  to toggle lines.
 - Press  to disconnect all lines.

Connecting to Multiple Parties

- 1 While switching between two lines,  [Menu] → *Speak with All*
 - Connect up to five lines simultaneously.
 - Press  to disconnect all lines.

Add a New Party to a Call

> Enter number during Group Calling →  → After the party is connected,  [Menu] → *Speak with All*

End Calls Individually

> Highlight a member →  [End] →  [YES]

Call Barring

Restrict incoming/outgoing Voice Calls, Video Calls or SMS messages.

- **Bar All Outgoing Calls** and **Bar All Incoming Calls** are not available when Call Forwarding or Voicemail is active. (Call Forwarding or Voicemail takes priority.)
- Emergency numbers (110, 119, 118) are dialable even while Call Barring for outgoing calls is active.

Activating/Deactivating Call Barring

Main Menu ► Settings ► Call Settings ► Optional Services
► Call Barring

1 **Outgoing Calls** or **Incoming Calls** → Highlight an item

Item	Operation/Description
Bar All Outgoing Calls	Restrict all non-emergency calls
Bar All International Calls	Allow only domestic calls
Bar International Calls	Restrict all international calls except to Japan
Bar All Incoming Calls	Reject all calls
Bar All If Roamed	Reject calls when outside Japan

2 [Menu] → **ON** or **OFF** → Enter Center Access Code

■ Check Call Barring Status

> In Step 1, **Confirm Status** → Select an item (← Left)





■ Cancel All Call Barring

> In Step 1, **Cancel All Barring** → Enter Center Access Code



Phone Book

Saving to Phone Book

Creating New Entries

- 1  →  [Menu] → **New Entry**
 • When no Phone Book entries exist:  →  [Create]
- 2 Select an item → Enter information
 • To save an entry, enter at least one of the following fields:
 Last Name, First Name, Phone Number, Email Address
- 3  [Save]

Saving from Mail & Call Log

- 1  → Select a Call Log → Highlight a record →
 [Menu] → **Add to Phone Book**
- 2 **New Entry**
Create New Entry → Enter other details
Add to Existing Entry
 Select an entry → Enter other details
- 3  [Save]



Changing Save Settings

Main Menu ► Phone ► Settings ► Save Settings

- 1 **Phone, USIM** or **Ask Each Time**

Managing Phone Book

Editing Phone Book Entries

- 1  → Highlight a Phone Book entry
- 2  [Menu] → **Edit** → Edit entry →  [Save]

Delete a Phone Book Entry

> After Step 1,  [Menu] → **Delete** → 

Delete All Phone Book Entries

> Main Menu ► Phone ► Memory Manager ► Delete All(Phone) or
 Delete All(USIM) ►  [YES] ► Enter Phone Password

Phone Book Memory Status

Main Menu ► Phone ► Memory Status

Messaging

Basics

Send messages via S! Mail or SMS.

- SoftBank Mobile messaging services are available in Japan and overseas.
- For more information, see SoftBank Mobile Website: <http://mb.softbank.jp/en/>

Messaging Folders

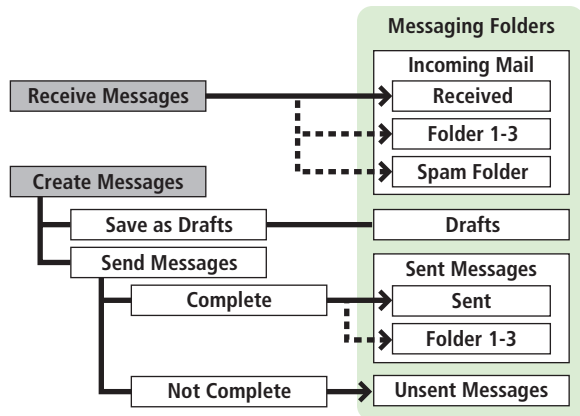

Deleting Messages Automatically

When memory for Messaging Folders is low, read messages and sent messages are automatically deleted one by one. Protect important messages from unintentional deletion, or set Auto Delete Sent Messages/Auto Delete Incoming Messages to **OFF**. SMS messages saved in USIM Card are not automatically deleted.

- To protect messages: In message list, (Highlight a message →) [Menu] → **Protect** → **One** or **Protect Selected Items**
(→ For **Protect Selected Items**, Check messages → [Execute])
- To deactivate Auto Delete: [Menu] → **Settings** → **Universal Settings** → **Auto Delete** → **Auto Delete Sent Messages** or **Auto Delete Incoming Messages** → **OFF**

View Memory Status

> [Menu] → **Memory Status** → **Phone** or **USIM** (→ For **Phone**, **Outgoing** or **Incoming**)

















Messaging Folder Contents

Received/Sent Date & Time,
Sender/Recipient,
Subject/SMS Message Text



Example: Received Folder
in Incoming Mail

Message Type/Status

Message Type	Message Status
 /  Unread/Read S! Mail	 Attachment(s)
 /  Unread/Read S! Mail Notice	 (Gold) Protected
 /  Unread/Read SMS	 Forwarded Message
 /  Unread/Read USIM Card SMS	 Replied Message
 Forwarded Server Mail	 New Delivery Report (Sent Messages)
	 SMS Concatenating
	 High Priority
	 Low Priority

Customizing Handset Address

Change handset mail address (alphanumerics before @) to help reduce spam. Random alphanumerics appear before @ by default.

abc123-xyz @ softbank.ne.jp

[Account] [Domain]
Name Name

(Customizable)

- For details, see SoftBank Mobile Website: <http://mb.softbank.jp/en/>

1 → **Settings** → **Custom Mail Address**

Handset connects to the Network.

Follow onscreen instructions.

Sending S! Mail & SMS

Sending S! Mail

1 Press and hold 

2 Select Address field

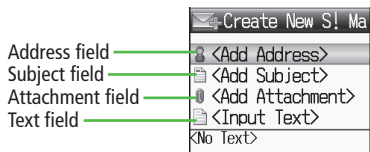

Composition Window

3 **Select from Phone Book**

Phone Book →

Select a Phone Book entry →

Select a mail address or SoftBank handset number

Enter Directly

Enter Number or **Enter Address** → Enter a SoftBank handset number or mail address

Select from Sent/Received Logs

Send Logs or **Receive Logs** → Highlight a record →



 [Select]

4 Select Subject field → Enter subject

5 Select Text field → Enter text

6  [Send]

Add Address

> Highlight Address field →  [Edit] → <Add Recipient> → Search/enter address → Select an address/SoftBank handset number or enter directly →  [Set]

Use Templates

> In Composition window,  [Menu] → **Insert Template** → Highlight a template (→  [View]) →  [Set]

Adding Attachments

From ► Composition window, select Attachment field

Add Attachments

> Select a folder in Data Folder → Highlight a file →  [Set]/[Select]

Capture Pictures/Videos to Attach

> Still Image: **Launch Camera** → Frame subject →  [Shoot] or  →  [Save]

> Video: **Launch Camera** →  [Video] → Frame subject →  [Record] →  [Stop] → **Attach to S! Mail**

Sending SMS Messages

1  → **Create New SMS**

2 Select Address field

3 **Select from Phone Book**

Phone Book →

Select a Phone Book entry → Select a SoftBank handset number

Enter Directly

Enter Number → Enter a SoftBank handset number

Select from Sent/Received Logs

Send Logs or **Receive Logs** → Highlight a record →

 [Select]

4 Select Text field → Enter text

- When number of entered character exceeds limit, S! Mail conversion option message appears.

5  [Send]

Manual Mail Conversion

> In SMS Composition window,  [Menu] → **Switch Message Type**

Add Address

> Highlight Address field →  [Edit] → <Add Recipient> → Search/enter address → Select a SoftBank handset number or enter directly →  [Set]

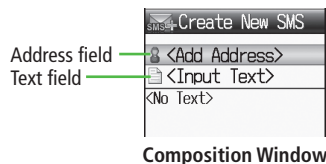

Receiving Messages

Retrieving S! Mail Automatically

Auto download retrieves complete messages and any attachments. Transmission fees are incurred; adjust to use. (To disable auto download:  P.4-5)

When a new message is received,  appears and Information Window opens in Standby.

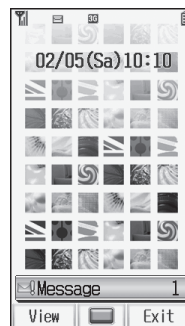

1 In Information Window, **Message**

- When Information Window does not appear,  → **Incoming Mail** → Select a folder → Select a message.



Retrieving Complete S! Mail

When Center sends initial portion of message (S! Mail Notice), retrieve the complete message manually.

- 1 Select a message with  or  → Select ***There are sequels*** at the end of message text

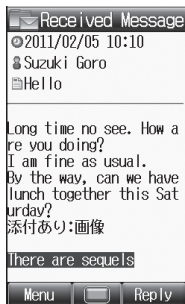



Incoming Options (S! Mail Only)

From ► **Main Menu** ► **Messaging** ► **Settings**
► **S! Mail Settings** ► **Incoming Options**

- **Set S! Mail Download Condition (within Japan)**
► *Home Auto Settings* → *Auto Download All, From Numbers Only* or *Manual Retrieval*
- **Set S! Mail Download Condition (while Abroad)**
► *Roaming Auto Settings* → *Auto Download* or *Manual Retrieval*

Setting Filters (Mail Delivery Rule)

- 1  → ***Incoming Mail*** or ***Sent Messages***
- 2 Highlight a folder → [Menu] → ***Mail Delivery Rule***
- 3 [Menu] → Select an item

Item	Operation/Description
Add Sender/ Add Address	Filter messages by sender/recipient address ► Search/enter address → Select sender/recipient or enter an address/SoftBank handset number
Add Subject	Filter messages by subject ► Enter subject ● SMS cannot be sorted by subject.

4 [Set]

■ **Edit Sort Conditions**

► After Step 2, highlight an item → [Edit] → Edit

■ **Delete Mail Delivery Rule Settings**

► After Step 2, highlight an item → [Menu] → ***Delete***

■ **Re-sort Set Folders**

► After Step 1, highlight a folder → [Menu] → ***Distribute in Folder*** → 

Internet

Getting Started

"Yahoo! Keitai" is both a SoftBank Mobile Internet service and the SoftBank Mobile Internet portal.

View PC Internet websites via PC Site Browser.

Internet

Yahoo! Keitai

- View Mobile Internet Websites
- Download image/sound files, etc.
- Video/Music Streaming

PC Site Browser

- View PC Sites
- Download still images

- Separate subscription is required for Network access.
- For more information, see SoftBank Mobile Website: <http://mb.softbank.jp/en/>

SSL/TLS

SSL (Secure Sockets Layer) and TLS (Transport Layer Security) are encryption protocols for secure Internet transmissions of important/sensitive information such as credit card numbers.

- Server certificates are saved on handset (📁 P.5-4).

Notes

When a security notice appears, subscribers must decide for themselves whether or not to open the page. SOFTBANK MOBILE Corp., VeriSign Japan K.K., Cybertrust Japan Co., Ltd., Entrust Japan Co., Ltd., GlobalSign K.K., RSA Security Inc., SECOM Trust Systems Co., Ltd. and Comodo Certificate Authority cannot be held liable for any damages associated with the use of SSL and TLS.

Accessing Internet

Yahoo! Keitai

From ► Main Menu ► Yahoo!

Opening Yahoo! Keitai Menu

- 1 **Open Top Menu**
Yahoo! Keitai

Open Menu List Menu List

- 2 Select a menu item
 - Repeat Step 2 as required.

Web Search

- 1 **Web Search** → Enter text

Entering URL

- 1 **Enter URL**
- 2 **Enter URL Directly**
Direct Entry → Enter URL

Use URL History

URL History List → Select a URL record

Delete URL History Records

> After Step 1, **URL History List** → (Highlight a URL →) [Menu] → **Delete** → **One** or **All** → [YES]

Using Access History

- 1 **History**
- 2 Select a history record

Delete Access History Records

> After Step 1, (Highlight a record →) [Menu] → **Delete** → **One** or **All** → [YES] (→ For **All**, enter Phone Password)

Exiting Mobile Internet

- 1 [Back] → [End]

Browsing PC Sites

- Some pages may not be viewable.
- Viewing PC websites via PC Site Browser may incur high charges.

From ► **Main Menu** ► **Yahoo!** ► **PC Site Browser**

Opening Menu

- 1 **Homepage** → [OK] → [YES] or [NO]
- 2 Select a menu item
 - Repeat Step 2 as required.

Web Search

Follow Step 1 of "Web Search" for Yahoo! Keitai (P.5-2).

Entering URL

Follow Steps 1 & 2 of "Entering URL" for Yahoo! Keitai (P.5-2).

Using Access History

Follow Steps 1 & 2 of "Using Access History" for Yahoo! Keitai (P.5-2).

Exiting Internet

- 1 →

Bookmarks & Saved Pages

Bookmarks

Save links to websites. Handset connects to the Network to open the link.

Saved Pages

Save page content. Handset opens saved pages without connecting to the Network.

Saving Webpages

- 1 Open a webpage → [Menu] → **Bookmarks** or **Saved Pages** → **Add**
- 2 **Save Bookmarks**
Select title → Edit title → [Save]

Save Saved Pages
Edit title

Viewing Bookmarks & Saved Pages

Main Menu ► **Yahoo!** (► **PC Site Browser**)

- 1 **Bookmarks** or **Saved Pages** → Select an item

Internet Settings

Web Browsers, Memory Manager & Security

Yahoo! Keitai

From ► **Main Menu** ► Yahoo! ► Settings

PC Site Browser

From ► **Main Menu** ► Yahoo! ► PC Site Browser
► PC Site Browser Settings

■ Font Size

> *Font Size* → Select a size

■ Clear Cache

> *Memory Manager* → *Clear Cache* → ☐

■ Delete Cookies

> *Memory Manager* → *Delete Cookies* → ☐

■ Delete User ID or Password Entered when Authentication is Required

> *Memory Manager* → *Delete Certificates* → ☐

■ Delete Input Memory

> *Memory Manager* → *Delete Input Memory* → ☐

■ Auto Send Manufacturer's Number (for Authentication)

> *Security* → *Manufacture Number* → *ON* or *OFF*

■ Referer Information

> *Security* → *Send Referer* → *ON* or *OFF*

■ Cookie Storage

> *Security* → *Cookies* → *ON*, *OFF* or *Ask Every Time*

■ View Server Certificates Issued by Certificate Authorities

> *Security* → *Root Certificates* → Select an item

■ Authentication Information

> *Security* → *Certificate Retention* → Select an item

Reset

Yahoo! Keitai

From ► **Main Menu** ► Yahoo! ► Settings

PC Site Browser

From ► **Main Menu** ► Yahoo! ► PC Site Browser
► PC Site Browser Settings

■ Initialize Browser

> *Initialized Browser* → ☐ → Enter Phone Password

■ Reset Browser Settings

> *Reset Defaults* → ☐ [YES] → Enter Phone Password

Connectivity

Infrared

Transfer Phone Book/Schedule entries, Messages, Bookmarks and Data Folder files wirelessly between handset and compatible devices, including PCs and other mobiles.

- Align infrared ports within 20 cm of one another and make sure no objects are placed between them. Do not move the devices until transfer is complete.

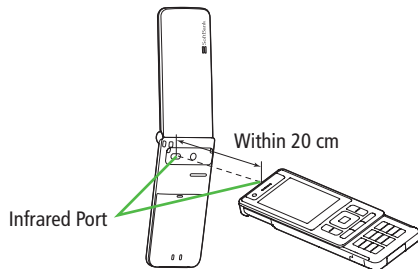

Note

- If memory becomes full, remaining entries are truncated.

Sending

One File Transfer

- 1 Highlight a file →  [Menu] → Follow steps below:

Files	Operation/Description
Phone Book/ Account Details/ Data Folder files	> <i>Send → Infrared</i>
Messages/ Schedule entries/ Bookmarks	> <i>Send via Infrared</i>
SMS in Incoming Mail folder	> <i>Local Connectivity → Infrared</i>

All Phone Book Transfers

Precaution

- Receiving all files overwrites all saved files including secret entries.
- Sending all Phone Book entries transfers Account Details as well. User-saved Account Details is overwritten on receiving handset (handset number remains).

Infrared Authentication Code

Infrared Authentication Code (4 digits) is required for all file transfers via Infrared. Sender and recipient must enter same Authentication Code to complete transfers.

Main Menu ► Infrared ► Send All Phone Book

- 1  → Enter Phone Password → Enter Authentication Code

Receiving

Main Menu ► Infrared ► Infrared ON/OFF

- 1 **ON** → When receiving transfer request from sender, 

- 2 **One File Transfer**

Follow steps

All Phone Book Transfer

 → Enter Phone Password → Enter Authentication Code

External Devices

SoftBank Utility Software (Japanese)

Phone Book, Calendar, Messages, Bookmarks and Data Folder files can be transferred to a PC, edited or managed by using SoftBank Utility Software.

- USB cable (sold separately) is necessary for using SoftBank Utility Software.
- For SoftBank Utility Software download details, see SoftBank Mobile Website: <http://www.softbank.jp/mb/r/sbu/> (Japanese)

USB (Japanese)

- Use USB cable specified by SoftBank Mobile.

Data Communication via USB Cable

Use handset as a modem for Internet access by connecting handset with a PC.

- Download utility software from URL below and install on PC.
<http://panasonic.jp/mobile/support/download/002p/index.html>

- 1 Install "USB ドライバ (USB Driver)" and "Modem Wizard" from Utility Software (002P) to a PC
- 2 Connect handset to PC via USB cable
 - Power on handset before connecting to PC via USB cable.

- 3 Start up "002P Modem Wizard," and complete communication setup

- "Modem Wizard" enables you to set up APN and dial-up easily. For setup/starting procedures, see "Modem Wizard" Help.

Note

- Connecting handset to a PC or PDA for Internet access may incur high packet transmission fees.

USB Charge

Connect handset to a PC via USB cable to charge battery.

- Both PC and handset must be powered up.
- USB Charging may be slower/less effective than AC Charger.

Camera & Imaging

Before Using Camera

- Notification Light/Charging Indicator illuminates while Camera is active.
Notification Light/Charging Indicator cannot be turned off.
- Shutter click sounds at fixed volume even in Manner Mode.

File Formats & Save Location

Still images/videos are saved to Data Folder.

Image Type	File Format	Save Location
Still images	JPEG (.jpg)	Pictures (Data Folder)
Videos	MPEG-4 (.3gp)	Videos (Data Folder)

Changing Save Location

Main Menu ► Camera ► Camera or Video Camera

- 1  [Menu] → *Save to*
- 2 *Phone* or *Memory Card*

Camera Display Indicators

● Images shown below are for reference only.

Picture Viewfinder

● Press **[9]** to open key assignment guide.

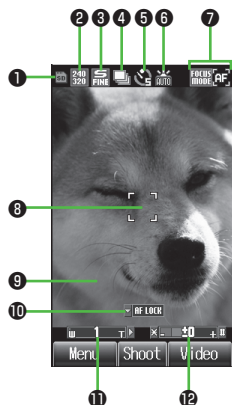

	Item	Description	Operation
①	Save to	Phone Memory Card	①
②	Size	<div> <div>1536 2048 480 640</div> <div>QXGA VGA</div> <div>1200 1600 240 320</div> <div>UXGA QVGA</div> <div>960 1280 120 160</div> <div>SXGA QQVGA</div> <div>Wallpaper</div> </div>	②
③	Quality	<div> <div>FINE</div> <div>Super Fine</div> <div>FINE</div> <div>Fine</div> <div>NORMAL</div> <div>Normal</div> </div>	③
	Multi Shot	Multi Shot	④
④	Night Mode	Night Mode	⑥
⑤	Self-Timer	5 seconds 10 seconds	⑤
⑥	White Balance	Automatic Fine Cloudy Light Bulb	⑧
⑦	Focus Setting	Auto Focus Close-up Scenery	⑦
⑧	Focus Guide	Adjust focus automatically	—
⑨	Effect	Normal/Sepia/Monochrome/Negative	⑦
⑩	Auto Focus Lock	Lock focus on the subject	to set Auto Focus Lock
⑪	Zoom bar	Indicate zoom level (Level 1 to 25)	to zoom in/ to zoom out ● Long press: continuous zoom
⑫	Brightness	Adjust brightness (Level -2 to +2)	# Brighter/ Darker

Camera & Imaging





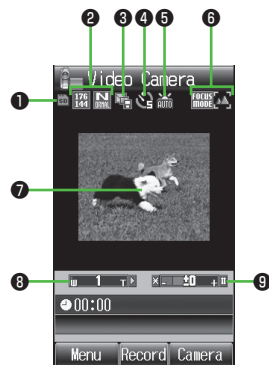

Video Viewfinder

- Press **[9]** to open key assignment guide.





	Item	Description	Operation
1	Save to	Phone Memory Card	[1]
2	Quality	<div> <div>320 / 240 S FINE Super Fine</div> <div>176 / 144 F FINE Fine</div> <div>176 / 144 N NORMAL Normal</div> </div>	<div>[3]</div> <ul style="list-style-type: none"> Available only when Recording Time is set to Extended Video.
3	Recording Time	Attach to S! Mail Extended Video	[2]
4	Self-Timer	5 seconds 10 seconds	[5]
5	White Balance	Automatic Fine Cloudy Light Bulb	[8]
6	Focus Setting	FOCUS MODE Close-up Scenery	[6]
7	Effect	Normal/Sepia/Monochrome/Negative	[7]
8	Zoom bar	Indicate zoom level (Level 1 to 25)	<div>[Z] to zoom in/[D] to zoom out</div> <ul style="list-style-type: none"> Long press: continuous zoom
9	Brightness	Adjust brightness (Level -2 to +2)	[#] Brighter/[*] Darker

Capturing Still Images







- 1  Viewfinder appears.
- 2 Frame subject →  [Shoot] or 
Shutter click sounds.
- 3  [Save]
 - To return to Viewfinder without saving the image:

- 4  to exit
Return to Standby.



■ Send Still Images via S! Mail

> After Step 2,  [S! Mail] → Create message ( P.4-3)

Recording Videos

- 1  →  [Video]
Viewfinder appears.
- 2 Frame subject →  [Record] to start recording
Tone sounds.
- 3  [Stop] to end recording
Tone sounds.
Video is automatically saved.
 - To return to preview window:  [Back]
 - To review: **Playback**
 - To delete: **Delete**
- 4  to exit
Return to Standby.



Note

- If save location is set to Phone ( P.7-3), select **Save to Data Folder** after Step 3.

■ Send Videos via S! Mail

- Set Recording Time to **Attach to S! Mail** beforehand ( P.7-3).
- > After Step 3, **Attach to S! Mail** → Create message ( P.4-3)

Other Camera Functions

From ▶





Camera: 

Video Camera:  →  [Video]



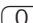

Auto Focus Lock (Camera Only)

To focus on an off-centered subject, lock focus on the subject and recompose your picture.

- Check if Focus Setting is set to **Auto Focus** (🔧 P.7-2).

- 1 In Viewfinder, adjust Focus Guide to subject → 
When in focus, handset sounds. Focus Guide turns green, and focus is locked.
 - To try again: 
- 2 Determine composition
- 3  [Shoot] or  →  [Save]

Self-Timer

- 1 In Viewfinder, 
 - Each key press toggles **5 seconds**, **10 seconds** and **OFF**.
- 2 Frame subject →  [Shoot]/[Record]
Self-Timer tone sounds. After set period of time, shutter is released and capturing starts.
- 3 **Camera**
 [Save]
Video Camera
 [Stop]

Digital TV

Initial Setup

- Digital TV is available only in Japan.
- USIM Card removal/service cancellation disable Digital TV.

Main Menu ▶ TV ▶ Channel Settings

1 **Select Area** → Select a region → Select a prefecture →



Automatic Channel Setup

If manual setup fails, try automatic channel setup.

> In Step 1, **Set from Current Location** → → After channel search, → Edit title

Using Channel List

From ▶ Main Menu ▶ TV ▶ Channel List

Set Channels

- > Select a Channel List
- Select a channel to access the station.

Delete Channel List

- > Highlight a Channel List → [Menu] → **Delete One** →
- Selected Channel List cannot be deleted.

Watching TV

- Set channels beforehand (Left).

1



- To change view:

2

Select a channel

Direct Channel Access	1 - 9
	* (Channel 10)
	0 (Channel 11)
	# (Channel 12)
Previous/Next Channel	
Channel Search	Press and hold ● To stop: [Cancel] or









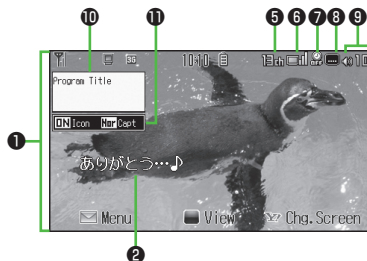





3

To end TV, →

Indicators

- Screenshots provided for reference only.



	Item	Description	Operation
1	Image	—	—
2	Captions	—	—
3	Data Broadcast	—	—
4	Operation Mode ¹	 AV Mode  Broadcast Mode	 <ul style="list-style-type: none"> ● Each key press toggles modes.
5	Channel	( P.8-1)	—
6	Signal Strength Level	    Strong ← → Weak Out of range	—
7	TV Off Timer	—	 [Menu] → Misc. Settings → TV Off Timer → Select a time
8	Receiving Captions	—	—
9	Volume	—	<ul style="list-style-type: none"> ● Adjust volume: ³ ● Mute/Resume: ³
10	Program Title	—	 or 
11	Indicator/Caption Setting ²	Indicators: ON/OFF Caption: Normal/Small/OFF	 <ul style="list-style-type: none"> ● Each key press toggles settings.
12	Display/Caption ¹	Display: ON/OFF Caption: ON/OFF	 <ul style="list-style-type: none"> ● Each key press toggles settings.

¹ Available only in Normal Screen

² Available only in Wide Screen

³ Available only in AV Mode

Handset Data Backup

Back up Phone Book, Calendar, Messages, and Bookmarks, etc. to Memory Card; restore files after accidental loss/alteration.

- Memory Card Installation: P.1-6

Main Menu ► Settings ► Memory Card Manager
► Memory Card Backup/Restore

1 Enter Phone Password

2 Select an item

- For **Messaging**, select a messaging folder.

3 Backup

Copy to Memory Card → →

Restore

Overwrite to Phone → →

Select a file →

- Backup date serves as file name.
- Backup files restored from Incoming Mail/Sent Messages folders are saved to Received/Sent folders.

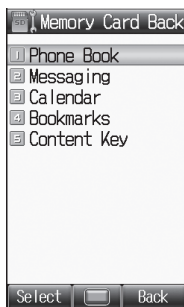



■ Delete Backup Files

> After Step 2, **Overwrite to Phone** → → Highlight a file → [Menu] → **Delete** →

Software Update

Check for 002P software updates and download as required.

- Transmission fees do not apply to updates (including checking for updates, downloading and rewriting).
- Software Update may take approximately 30 minutes.
- Fully charge battery beforehand. Even if  appears, low battery message may appear. In this case, charge battery until Notification Light/Charging Indicator goes out.
- Select a place where signal is strong and stable.
- Other functions are unavailable during update.
- Software Update does not affect Phone Book entries, files saved in Data Folder or other content, but it is recommended that you create a backup of any important information and data (note that some files cannot be copied). SoftBank Mobile is not liable for damages resulting from loss of data, information, etc.
- Do not remove battery/USIM Card during the update. Update will fail.
- Software Update failure may disable handset. Contact SoftBank Mobile Customer Center, Customer Assistance ( P.9-19).

Main Menu ► Tools ► Software Update ► Software Update

- 1  → Follow onscreen instructions

After download is complete, handset automatically restarts and update begins.

When update is complete,

Updated successfully Rebooting phone

appears. Handset restarts, then Information appears. Entire process takes approximately 30 seconds.

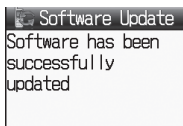

Update Results

When Information Window appears, *Update Results*

- When Information Window does not appear,
Main Menu ► Tools ► Software Update
► Update Result.



Scheduled Update



SoftBank Mobile sends update notice via SMS; read and change preset update schedule as needed. Confirmation appears at scheduled time. Press  or wait a while for update to start.

Note

- SoftBank Mobile is not liable for damages resulting from loss of data, information, etc.
- Update may temporarily cancel Keyguard.
- Alarm tone does not sound during update.
- For more information, see SoftBank Mobile Website: <http://mb.softbank.jp/en/>

Troubleshooting

Handset will not power on

- Was  pressed for more than three seconds?
- Is battery level sufficient?
- Is battery installed properly? ( P.1-5)



Handset functions do not work after power on

- Does PIN entry window appear?
PIN Certification ( P.1-13) is **ON**. Enter PIN.

Insert **USIM** or **INVALID USIM** appears at power on or after key press

- Is USIM Card installed correctly? ( P.1-4)
- Is SoftBank Mobile specified USIM Card installed?
Unusable USIM Card may be inserted.
- USIM Card IC chip may be dirty.
Wipe with a clean cloth, then correctly install USIM Card.





Keypad does not respond

- Does  appear in Standby?
Keyguard ( P.1-9) is active. Cancel it.

Display is blurry

- Is eco Mode active?
Cancel eco Mode ( P.1-5).

Outgoing calls/text messages/Internet transmissions are unavailable

- Does **OUT**  (red) appear?
Is handset out-of-range or signal weak?
Move for a stronger signal.
- Does  appear?
Cancel Offline Mode ( P.1-14).
- Are you using handset outside Japan?
Change International Call settings (e.g. select operator) ( P.3-4).
- Is area code entered?
- Are outgoing calls restricted (Call Barring)? ( P.3-9)

Call is interrupted or disconnected

- Does **OUT** appear? Is handset out-of-range or signal weak?
Move for a stronger signal.

Digital TV does not work

- Is handset out of set broadcast area range or TV signal weak?
Confirm Channel List area or move for a stronger signal.

Date & Time is incorrect

- Battery removal does not affect Date & Time, however, a long period without power may. Set Date & Time or Retrieve NW Info ( P.1-9).

Cannot charge battery

- Is AC Charger (sold separately) firmly connected to handset or Desktop Holder (sold separately)? (👉 P.1-6)
- Is AC Charger securely plugged into an outlet?
- Is battery installed in handset correctly? (👉 P.1-5)
- Is handset correctly mounted in Desktop Holder?
- Are handset, battery, Desktop Holder and AC Charger terminals clean?
- Is ambient temperature between +5°C and +35°C?
Otherwise, battery may not reach full charge.
- When charging battery during a call/data transmission, Notification Light/Charging Indicator may go out due to handset temperature increase. When handset temperature returns to normal level, Notification Light/Charging Indicator illuminates again.
- Battery may need to be replaced.

Handset/accessories feel warm

- AC Charger/Desktop Holder may warm during charging.
Handset may warm during long use. This is normal if you can hold it comfortably. Low temperature burns may occur if handset is held against skin for long periods.

Battery operating time is greatly reduced



- Battery operating time may be reduced by environmental factors such as temperature, charging conditions or signal strength, as well as by operations or settings. See "Specifications" (👉 P.9-18).
Activate eco Mode to extend battery time (👉 P.1-5).

Warning Signs







Problem	Causes and Remedies
OUT appears	Handset is out-of-range. Move for a stronger signal.
🔒 appears	Keyguard is active (👉 P.1-9). Cancel Keyguard to use keys. Answer calls even if Keyguard is active.
Low battery message appears and battery alarm tone sounds	Battery is low. Charge (👉 P.1-6) or replace battery (👉 P.1-5).

Safety Precautions

- For proper handset use, read Safety Precautions carefully beforehand. Keep this guide in a safe place for future reference.
- Safety Precautions contain information meant to prevent injury to the user or others, or property damage, and must be observed at all times.
- SoftBank Mobile is not liable for any damages resulting from use of this product.
- Symbols below indicate level of risk from improper use:
Understand these symbols and precautions before reading this guide.

	Danger	Great risk of death or serious injury
	Warning	Risk of death or serious injury
	Caution	Risk of minor injury/property damage

- Symbol Explanations
Understand these symbols and precautions before reading this guide.

	Prohibited Action		Always Dry Hands First
	Disassembly Prohibited		Compulsory Action
	Avoid Moisture		Disconnect Power Source

Handset, Battery, USIM Card, AC Charger (Sold Separately) & Memory Card (Sold Separately)



Danger



Do not use or leave handset or related hardware in locations subject to high temperatures, such as near an open flame/heater, in sunlight or inside a car on an extremely hot day. Do not charge, leave, use, or be carrying handset or related hardware in a warm place or where heat collects, such as under a kotatsu (blanketed warming table) or electric blanket, next to a kairo (worn warming patch), etc.

Battery may leak, overheat, explode, or ignite. Handset or related hardware may deform or malfunction. Part of the casing may also become hot and cause burns.



Do not use excessive force to attach battery or connect Charger to handset. Battery or connector may be the wrong way around. Battery may leak, overheat, explode or catch fire.



Do not disassemble, modify or solder handset or related hardware. May cause accidents such as fire, bodily injury, electric shock or equipment malfunction. Battery may leak, overheat, explode or catch fire. Modifying handset is a violation of Radio Law and subject to prosecution.



Do not get handset, battery and Charger wet. If handset, battery or Charger is left wet or battery is charged after exposure to liquids such as water or pet urine, overheating, electric shock, fire, injury or malfunction may occur. Be mindful of location when using handset, battery and Charger. Handle with care.



Use specified battery, Charger and Desktop Holder (sold separately).

Battery may leak, overheat, explode or catch fire, and Charger may overheat, catch fire or cause malfunction.



Warning



Do not place handset, battery or Charger inside cooking appliances, such as microwave ovens or high-pressure containers, or on IH cooking heaters.

Battery may leak, overheat, explode or catch fire. Handset or Charger may overheat, emit smoke, catch fire or cause malfunction.



Do not drop, throw or otherwise subject to strong force or impacts.

Battery may leak, overheat, explode, catch fire, or cause electric shock or damage to handset.



Do not allow liquids (water, pet urine, etc.) or conductive objects (pencil leads, metal pieces, necklaces, hair pins, etc.) to contact Charger terminals, external port terminals or Memory Card slot.

May cause fire or malfunction triggered by short-circuit.



Keep handset off and Charger disconnected near propane gas, in filling stations or places where flammable gas is generated.

Handset use in such areas may lead to fire.



If handset, battery or Charger emits an unusual sound, smoke or odor, perform following steps:

1. Unplug Charger from outlet.
 2. Turn off handset.
 3. Remove battery. (Take care to avoid burns or injuries.)
- May cause fire or electric shock.



Caution



Do not place handset, battery or Charger on an unstable surface.

May fall, causing injury or malfunction. Take extra precautions while vibration alert is active or during charging.



Keep handset and related hardware out of the reach of young children.

May result in accidental ingestion or bodily injury.



If for use by child, guardian should teach proper handling and ensure handset and related hardware is used as directed.

May result in bodily injury.

Battery



Danger

See battery label to confirm battery type.

Label	Battery Type
Li-ion 00	Lithium-ion



Do not throw battery into fire.

Battery may leak, explode or catch fire.



Do not pierce battery with a nail or other sharp object, hit it with a hammer, step on it, or subject it to strong shocks.

Battery may leak, overheat, explode or catch fire.



Do not touch terminals with metallic objects or carry/store battery with conductive objects (pencil leads, metal pieces, necklaces, hair pins, etc.).

Battery may leak, overheat, explode or catch fire.



If battery fluid gets into eyes, do not rub; flush with clean water and see a doctor immediately.

Failure to do so may cause blindness.



Warning



If battery fluid comes into contact with skin or clothing, stop handset use immediately and rinse fluid off with clean water.

Battery fluid is harmful to your skin.



If battery does not charge after specified time, stop charging.

Battery may leak, overheat, explode or catch fire.



If battery emits an unusual odor, overheats, discolors or deforms, immediately remove it and keep away from fire. Take care to avoid burns or injuries.

Battery may leak, overheat, explode or catch fire.



Caution



Do not dispose of battery with ordinary refuse.

Tape over terminals to insulate battery; take it to a SoftBank retailer or institution that handles used batteries in your area. Comply with local waste disposal regulations.

Handset



Warning



Do not use handset while driving a vehicle.

Doing so may interfere with safe driving and cause an accident. Stop your vehicle to park in a safe place before using handset.

Drivers using handsets while driving are subject to prosecution.



Do not aim infrared port at eyes in infrared transmissions.

Doing so may affect eyes.



Turn off handset near high-precision electronic devices or devices using weak electronic signals.

Handset may cause these devices to malfunction.

*Electronic devices that may be affected: Hearing aids, implantable cardiac pacemakers, implantable cardioverter defibrillators, other medical electronic devices, fire alarms, automatic doors and other automatically controlled devices.



Turn off handset aboard aircraft.

Handset signal may interfere with aircraft operation.

When in-flight handset use is permitted, follow airline instructions for proper use.



If you have a weak heart, take extra precautions when setting functions such as Vibration or Ringer Volume for incoming transmissions.

May affect heart.



In a thunderstorm, immediately turn off handset and seek shelter.

There is a risk of being struck by lightning and suffering electric shock.



Caution



If handset affects car electronics, stop use.

Handset use may affect electronics in some models. In this case, stop use; could impede safe driving.



Do not place a magnetic card near or in handset.

The stored magnetic data in cash cards, credit cards, telephone cards and floppy disks, etc. may be erased.



Do not swing handset by its strap, etc.

Handset may strike you or others, or strap may be broken resulting in injury or damage to handset or other property.



Do not place your ear too close to the speaker while ringer sounds or sound files play.

May impair hearing.



If skin abnormality occurs, immediately stop use and seek medical treatment.

Handset contains metals. Handset use may cause itching, rashes, eczema or other symptoms depending on the user's physical condition.

Parts		Materials/Surface Finish
Outer case	Keypad side, Display rear side, Battery side	ABS/UV coating
	Display side, Hinge holder	PC/UV coating
External Port terminals		Stainless steel/Nickel plating, Gold plating
External Port Cover		Elastomer
Camera panel, Display panel		PMMA/Hard coating

Parts		Materials/Surface Finish
Protrusion on Camera Panel		ABS
Charging Terminals		Phosphor bronze/Nickel plating, Gold plating
Keypad	Center Key	PC/Hard coating
	Sheet	PC
	Keys	PC/UV coating
Stop pads		Acrylic urethane
Notification Light/Charging Indicator		PC/Evaporated tin, UV coating
Battery Cover	Resin part	ABS/UV coating
	Battery compartment sheet	PC
Battery compartment		PC
Battery terminals	Resin part	PPS
	Terminals	Beryllium copper/Nickel plating, Gold plating
Battery	Resin part	PC
	Terminals	Glass fiber reinforced epoxy board/ Nickel plating, Gold plating
	Label	PET
Screws (Battery compartment)		Iron/Nickel plating
Nameplate		Polyester
Memory Card slot (Battery compartment)	Metal part	Stainless steel/Nickel plating
	Resin part	LCP

Appendix



Handset may become hot while used in a hot environment.

Avoid prolonged skin contact that may result in burns.



Make sure not to trap fingers or objects when opening/closing handset.

May result in injury or damage to display.



Watch TV with adequate lighting and distance from Display.

May damage eyesight.



Do not turn up the volume unnecessarily high when using earphones.

Using earphones with volume turned up for an extended period may impair hearing or injure ears.

AC Charger (Sold Separately)



Warning



Do not cover or wrap Charger during charging.

May cause overheating, fire or malfunction.



Always use the specified power supply/voltage.

Using incorrect voltage may cause fire or malfunction.

AC Charger: AC100V-240V (household AC outlet only)

In-Car Charger (sold separately): DC12V, 24V (vehicles with a negative earth only)



Use In-Car Charger (sold separately) in vehicles with a negative (-) earth. Do not use In-Car Charger if vehicle has a positive (+) earth.

May cause fire.



Do not use Charger in thunderstorms.

There is a risk of suffering electric shock.



Do not handle Charger with wet hands.

May cause electric shock or malfunction.



If In-Car Charger (sold separately) fuse blows, always replace it with specified fuse.

Using the incorrect fuse may cause fire or malfunction. Refer to the respective manuals for information on the correct fuse specifications.



If dust accumulates on plug, unplug Charger and wipe with a dry cloth.

May cause fire.



When plugging Charger into outlet, keep conductive materials (pencil leads, metal parts, necklaces, hair pins, etc.) away from Desktop Holder terminals or Charger plug/terminals and plug Charger firmly into outlet.

May cause electric shock, short-circuit or fire.



Unplug Charger during periods of disuse.

May cause electric shock, fire or malfunction.



If liquid such as water or pet urine get into Charger, unplug it immediately.

May cause electric shock, smoke emission or fire.



Caution



Pull Charger (not cord) to unplug Charger.

Pulling on the cord may damage the cord and cause electric shock or fire.



Always unplug Charger before cleaning it.

May result in electric shock.

Near Electronic Medical Equipment



Warning

This section is based on "Guidelines on the Use of Radio Communications Equipment such as Cellular Telephones and Safeguards for Electronic Medical Equipment" (Electromagnetic Compatibility Conference, April 1997) and "Report of Investigation of the Effects of Radio Waves on Medical Equipment, etc." (Association of Radio Industries and Businesses, March 2001).



If you use an implantable cardiac pacemaker or cardioverter defibrillator, keep handset more than 22 cm away from the implant at all times.

Handset radio waves may affect implantable cardiac pacemaker or cardioverter defibrillator operations.



Persons using electronic medical equipment outside medical facilities should consult the vendor about possible radio wave effects.

Handset radio waves may affect electronic medical equipment operations.



Observe the following in medical facilities. Handset radio waves may affect electronic medical equipment.

- Do not take handset into operating rooms, Intensive Care Units or Coronary Care Units.
- Turn off handset inside hospital wards.
- Turn off handset even outside hospital wards (in hospital lobbies, etc.); electronic medical equipment may be in use nearby.
- Where a medical facility has specific instructions prohibiting the carrying and use of mobile phones, observe those instructions strictly.



Turn off handset in crowded places such as rush hour trains; implantable cardiac pacemakers or cardioverter defibrillators may be in use nearby.

Handset radio waves may affect implantable cardiac pacemaker or cardioverter defibrillator operations.

Handling Precautions

General Notes

- SoftBank Mobile is not liable for damages from accidental loss/alteration/repair of handset/Memory Card information (Phone Book entries, image/sound files, etc.). Back-up important information.
- Handset transmissions may be disrupted inside buildings, tunnels or underground, or when moving into/out of such places.
- Use handset without disturbing others.
- Handsets are radios as stipulated by the Radio Law. Under the Radio Law, handsets must be submitted for inspection upon request.
- Handset use near landlines, TVs or radios may cause interference.
- Read Memory Card manual beforehand for proper use.
- **Beware of eavesdropping.**
Digital signals reduce interception, however transmissions may be overheard. Deliberate/accidental interception of communications constitutes eavesdropping. "eavesdropping" means radio communication is received by another receiver deliberately or accidentally.
- **Be cautious of unsafe websites.** Take extra precautions especially when posting personal information on websites.

Electromagnetic Waves

- For body worn operation, this mobile phone has been tested and meets RF exposure guidelines when used with an accessory containing no metal and positioning the handset a minimum 15 mm from the body. Use of other accessories may not ensure compliance with RF exposure guidelines.

FCC Notice

- This device complies with part 15 of the FCC Rules. Operation is subject to the following two conditions:
(1) This device may not cause harmful interference, and
(2) this device must accept any interference received, including interference that may cause undesired operation.
- **Changes or modifications not expressly approved by the manufacturer responsible for compliance could void the user's authority to operate the equipment.**

FCC RF Exposure Information

Your handset is a radio transmitter and receiver. It is designed and manufactured not to exceed the emission limits for exposure to radio frequency (RF) energy set by the Federal Communications Commission of the U.S. Government.

The guidelines are based on standards that were developed by independent scientific organization through periodic and thorough evaluation of scientific studies. The standards include a substantial safety margin designed to assure the safety of all persons, regardless of age and health.

The exposure standard for wireless handsets employs a unit of measurement known as the Specific Absorption Rate, or SAR. The SAR limit set by the FCC is 1.6 W/kg.

The tests are performed in positions and locations (e.g. at the ear and worn on the body) as required by the FCC for each model.

The highest SAR value for this model handset as reported to the FCC when tested for use at the ear is 0.816 W/kg, and when worn on the body in a holder or carry case, is 0.461 W/kg.

Body-worn Operation; This device was tested for typical body-worn operations with the back of the handset kept 1.5 cm from the body. To maintain compliance with FCC RF exposure requirements, use accessories that maintain a 1.5 cm separation distance between the user's body and the back of the handset. The use of beltclips, holsters and similar accessories should not contain metallic components in its assembly.

The use of accessories that do not satisfy these requirements may not comply with FCC RF exposure requirements, and should be avoided. The FCC has granted an Equipment Authorization for this model handset with all reported SAR levels evaluated as in compliance with the FCC RF emission guidelines. SAR information on this model handset is on file with the FCC and can be found under the Display Grant section of <http://www.fcc.gov/oet/ea/> after searching on FCC ID UCE210036A.

Additional information on Specific Absorption Rates (SAR) can be found on the Cellular Telecommunications & Internet Association (CTIA) website at <http://www.phonefacts.net>.

European RF Exposure Information

Your mobile device is a radio transmitter and receiver. It is designed not to exceed the limits for exposure to radio waves recommended by international guidelines. These guidelines were developed by the independent scientific organization ICNIRP and include safety margins designed to assure the protection of all persons, regardless of age and health.

The guidelines use a unit of measurement known as the Specific Absorption Rate, or SAR. The SAR limit for mobile devices is 2 W/kg and the highest SAR value for this device when tested at the ear was 0.846 W/kg*. As mobile devices offer a range of functions, they can be used in other positions, such as on the body as described in this user guide**. In this case, the highest tested SAR value is 0.836 W/kg. As SAR is measured utilizing the devices highest transmitting power the actual SAR of this device while operating is typically below that indicated above. This is due to automatic changes to the power level of the device to ensure it only uses the minimum level required to reach the network.

The World Health Organization has stated that present scientific information does not indicate the need for any special precautions for the use of mobile devices. They note that if you want to reduce your exposure then you can do so by limiting the length of calls or using a hands-free device to keep the mobile phone away from the head and body.

*The tests are carried out in accordance with international guidelines for testing.

**Please see Electromagnetic Waves on page 9-11 for important notes regarding body worn operation.

Declaration of Conformity

CE0168

We, Panasonic Mobile Communications Development of Europe Ltd., declare that SoftBank 002P conforms with the essential and other relevant requirements of the directive 1999/5/EC.

A declaration of conformity to this effect can be found at <http://panasonic.net/pmc/support/index.html>

- This product is only intended for sale in Japan.
- Compliance to the European RTTE directive applies to: SoftBank 002P handset, battery (PMBAS1) and AC Charger (SoftBank ZTDAA1, marked MITSUMI).

Handset Care

- **002P is not waterproof. Avoid exposure to liquids and high humidity.**
 - Do not expose handset to precipitation.
 - Air conditioned air may cause condensation, resulting in corrosion.
 - Do not put handset in damp places like bathrooms.
 - On the beach, keep handset away from sun and surf.
 - Perspiration in handset may cause malfunction.
- If handset is left with no battery or an exhausted one, data may be altered/lost. SoftBank Mobile is not liable for any resulting damages.
- Use handset within temperatures of 5°C to 35°C and humidity 35% to 85%. Avoid extreme temperatures/direct sunlight.
- Handset may become warm during use or charging. This is not malfunction.
- Battery may swell as service life nears end; this is not a problem.
- Exposing lens to direct sunlight may damage color filter and affect image color.

- Soiled terminals may cause poor connection. If the terminals are dirty, use a dry cloth or cotton swab to wipe them clean.
- Clean handset with dry, soft cloth. Using alcohol, thinner, etc. may damage it.
- Avoid forceful rubbing or scratching handset displays.
- Do not subject handset to excessive force.
 - Do not sit down with handset in a back pocket.
 - Do not place heavy objects on a bag with handset inside.
- Do not remove nameplate from handset; doing so invalidates warranty.
- Always turn off handset before removing battery. If battery is removed while saving or sending mail, data may be altered or lost.
- LCD is manufactured with high precision technology, however, some pixels may appear darker/brighter.
- Connect only specified products to External Port.
- While walking, moderate earphone volume to make sounds around you audible and help avoid accidents.
- When holding handset in use, do not cover Speaker.

Function Usage Limits

These functions are disabled after handset replacement/upgrade or service cancellation: Camera; Digital TV; Media Player; S! Appli. After a period of disuse, these functions may become unusable.

Multitasking during Calls/Data Transmissions

- Calls/data transmissions incur transmission fees even when other functions/operations are simultaneously in use.
- When opening a function menu by entering number during a call, some options are unavailable.

Mobile Camera

- Be sure to observe proper etiquette when using the camera.
- Do not expose the camera lens to direct sunlight. Concentrated sunlight through the lens may cause the handset to malfunction.
- Be sure to try taking and previewing pictures before using the camera on important occasions like wedding ceremonies.
- Do not commercially use or transfer pictures taken with the camera without the permission of the copyright holder (photographer), except for personal use.
- Do not use the camera in locations where taking photos and recording videos are prohibited.

Copyrights

Portrait Rights

Individuals have the right to refuse being photographed or publication or use of their image. Personality rights, or Right of Publicity, is a form of property right designed to protect celebrity interests that applies to all people. Be careful when using handset camera. Photographing or distributing the images of others without permission is unlawful.

Copyrights

Sounds, images, computer programs, databases, other copyrighted materials, their respective works and copyright holders are protected by copyright laws. Duplicated materials are limited to private use only. If duplications (including conversion of data types), modifications, transfer of duplicates or distribution on networks are made without permission of copyright holders, this constitutes "Literary Piracy" and "Infringement of Copyright Holder Rights" and a criminal action for reparations and criminal punishment may be filed. If duplicates are made using handset, please observe the copyright laws. Materials captured with handset camera are also subject to the above.

This product is licensed under the MPEG-4 patent portfolio license and AVC patent portfolio license for the personal use of a consumer or other uses in which it does not receive remuneration to

(i) encode video in compliance with the MPEG-4 Visual Standard and AVC Standard ("MPEG-4/AVC Video") and/or
(ii) decode MPEG-4/AVC Video that was encoded by a consumer engaged in a personal activity and/or was obtained from a video provider licensed to provide MPEG-4/AVC Video.

No license is granted or shall be implied for any other use. Additional information may be obtained from MPEG LA, L.L.C. See <http://www.mpegla.com>.

Java and all Java based trademarks and logos are trademarks or registered trademarks of Sun Microsystems, Inc. in the U.S. and other countries.



Aplix, microJBlend and JBlend, and all Aplix- or JBlend-related trademarks and logos are trademarks or registered trademarks of Aplix Corporation in the U.S., Japan and other countries.

QR Code is a registered trademark of DENSO WAVE INCORPORATED.



microSD Logo is a trademark of SD-3C, LLC.

Chaku-Uta® and Chaku-Uta Full® are registered trademarks of Sony Music Entertainment (Japan) Inc.

Machi-Uta® is a registered trademark of KDDI CORPORATION.

Powered by MascotCapsule®

MascotCapsule® is a registered trademark of HI CORPORATION

© 2011 HI CORPORATION. All Rights Reserved.



This product contains NetFront Mobile Client Suite of ACCESS CO., LTD. ACCESS and NetFront are trademarks or registered trademarks of ACCESS CO., LTD. in the United States, Japan and other countries. © 2008 ACCESS CO., LTD. All rights reserved. This software is based in part on the work of the Independent JPEG Group.



This product contains Adobe® Flash® Lite™ Player under license from Adobe Systems Incorporated. Copyright © 1996-2008 Adobe Macromedia Software LLC. All rights reserved. Adobe, Flash and Flash Lite are either registered trademarks or trademarks of Adobe Systems Incorporated in the United States and/or other countries.

"AutoArt" adopted by this product is based on Emoji Lite®, protected by the intellectual property rights of Acrodea, Inc.

SOFTBANK, SOFTBANK's equivalent in Japanese and the SOFTBANK logo are registered trademarks or trademarks of SOFTBANK CORP. in Japan and other countries.

COLOR LIFE, S! Mail, Graphic Mail and Feeling Mail are trademarks or registered trademarks of SOFTBANK MOBILE Corp.

Yahoo! and the "Yahoo!" or "Y!" logos are trademarks and/or registered trademarks of Yahoo! Inc. in the U.S.

This product is manufactured or sold under license from InterDigital Technology Corporation.

Other company and product names mentioned herein are trademarks or registered trademarks of their respective owners.

The software contained in 002P is copyrighted material; copyright, moral right and other related rights are protected by copyright laws. Do not copy, modify, alter, disassemble, decompile or reverse-engineer the software, and do not separate it from hardware in whole or part.

Specific Absorption Rate (SAR)

This mobile phone 002P meets the MIC's* technical regulation for exposure to radio waves.

The technical regulation established permitted levels of radio frequency energy, based on standards developed by independent scientific organizations through periodic and thorough evaluation of scientific studies.

The regulation employs a unit of measurement known as the Specific Absorption Rate, or SAR.

The SAR limit is 2 watts/kilogram (W/kg)** averaged over ten grams of tissue.

The limit includes a substantial safety margin designed to assure the safety of all persons, regardless of age and health.

The value of the limit is equal to the international guidelines recommended by ICNIRP***.

The highest SAR value for this mobile phone is 0.793 W/kg when tested for use at the ear.

While there may be differences between the SAR levels of various phones and at various positions, all phones meet MIC's technical regulation.

Although the SAR is determined at the highest certified power level, the actual SAR of the phone during operation can be well below the maximum value.

For more information about SAR, see the following websites:

- Ministry of Internal Affairs and Communications (MIC)
<http://www.tele.soumu.go.jp/e/sys/ele/body/index.htm>
- Association of Radio Industries and Businesses (ARIB)
<http://www.arib-emf.org/> (Japanese)

* Ministry of Internal Affairs and Communications

** The technical regulation is provided in Article 14-2 of the Ministry Ordinance Regulating Radio Equipment.

*** International Commission on Non-Ionizing Radiation Protection

Specifications

002P

Weight (including battery)		110 g*
Dimensions (closed)		109 x 50 x 16.5-18 mm*
Standby Time	3G	400 hours*
	GSM	350 hours*
Talk Time	3G	200 minutes*
	Video Call	100 minutes*
	GSM	230 minutes*
TV Reception Time		3 hours*
Charging Time	AC Charger	130 minutes*
	In-Car Charger	130 minutes*
Maximum Output	3G	0.25 W
	GSM	2.0 W

* Approximate value

Battery

Voltage	3.7 V
Battery Type	Lithium-ion
Capacity	800 mAh
Dimensions	45 x 4.5 x 37 mm*

* Approximate value

● Specifications subject to change without notice.

Support

Warranty

Warranty is provided when you purchase a 002P.

- Check name of distributor and date of purchase.
- Read through contents and keep in a safe place.
- The warranty term is described in the warranty.

SoftBank Mobile is not liable for any damage resulting from use of this product.

After-Sales Service

See "Troubleshooting" (📄 P.9-3) before contacting SoftBank Mobile for service or repairs. If you cannot find solutions or solve problems, contact SoftBank Mobile Customer Center, Customer Assistance (📄 P.9-19) in your subscription area and provide a detailed description of the problem.

- Repairs within warranty are performed under terms and conditions described.
- Out of warranty, any repairs are performed upon request at subscriber's expense.

Customer Service

For information about SoftBank handsets or services, call General Information.

For repairs, call Customer Assistance.

SoftBank Mobile Customer Center

General Information

From a SoftBank handset, dial toll free at 157

From a landline/IP phone, dial toll free at 0800-919-0157

Customer Assistance

From a SoftBank handset, dial toll free at 113

From a landline/IP phone, dial toll free at 0800-919-0113

If you cannot reach a toll free number, use the number (charges apply) below for your service area:

Hokkaido Area Tohoku Area Hokuriku Area Kanto, Koshinetsu Area	022-380-4380	Tokai Area	052-388-2002
Kansai Area	06-7669-0180	Chugoku, Shikoku Area Kyushu, Okinawa Area	092-687-0010

SoftBank Mobile Global Call Center

From outside Japan, dial +81-3-5351-3491 (toll free from SoftBank handsets)

If handset is lost/stolen, call this number immediately (international charges apply)

SoftBank 002P User Guide

March 2012, Second Edition

SOFTBANK MOBILE Corp.

For additional information, please visit a SoftBank Shop.

Model: SoftBank 002P

Manufacturer: Panasonic Mobile Communications Co., Ltd.



モバイル・リサイクルネットワーク
携帯電話・PHSのリサイクルにご協力を。

Please help the mobile industry maintain high environmental standards. Recycle your old handsets, batteries and charger units (all manufacturers and brands). Before you recycle, please remember these important points:

- Handsets, batteries and chargers submitted for recycling cannot be returned.
- Always erase all data recorded on old handsets (Phone Book entries, call records, mail, etc.) before recycling.