

Libero 2

User Guide

Libero 2 User Guide Contents

Introduction

About the User Guide.....	3
Accessing Instructions on Handset.....	3

Getting Started

Parts & Functions.....	6
Battery.....	7
USIM Card.....	8
Internal Memory and SD Card.....	9
Charging Battery.....	12
Power On/Off.....	13
Using Touchscreen.....	13

Basic Operations

Basic Operation.....	16
Confirmation when First Launching Applications.....	17
Applications.....	18
Phone Number.....	19
Silent Mode.....	19
Airplane Mode.....	20
Text Entry.....	21
Using a Google Account.....	22
Google Play.....	24
Security Codes/Operation Password.....	26
SIM PIN.....	27
Locking Screen.....	28
Updating Software.....	28

Handset Interface

Home Screen Basics.....	32
Status Bar.....	32
Using Notifications Window/Quick Settings.....	33

Phone

Placing/Answering Calls.....	36
Optional Services.....	38
Using Contacts.....	40

Messaging & Internet

Messaging.....	44
Sending SI Mail/SMS.....	44
Opening & Replying to SI Mail/SMS.....	46
Using Gmail.....	47
Using Chrome.....	49

Camera

Capturing Still Images/Videos.....	52
Viewing Captured Still Images/Videos (Photos).....	54

Music

Listening to Music (Play Music).....	58
--------------------------------------	----

Connectivity

Connecting by Wi-Fi.....	62
Using Bluetooth® Function.....	63

Global Services

Making Calls while Abroad.....	68
--------------------------------	----

Handset Settings

Handset Settings.....	72
Wi-Fi Settings.....	73
Display Settings.....	74
Notifications Settings.....	74
Sound Settings.....	75
Apps Settings.....	75
Accounts Settings.....	76
About Phone.....	77

For Assistance

Specifications.....	80
Customer Service.....	80

Safety Precautions

Safety Precautions.....	82
Materials.....	91
Important Product Information.....	91
General Notes.....	94

About the User Guide

Thank-you for purchasing this product.

Before Using This Product

Read "QUICK START" and this guide thoroughly for proper usage.

Accessible services may be limited by subscription contract conditions.

Descriptions in the User Guide

In the User Guide, most operation descriptions are based on handset at time of purchase.

Unless noted otherwise, descriptions are for Home Screen. Some operation descriptions may be simplified.

Screenshots & Key Labels

Screenshots in the User Guide may differ in appearance with actual Display. Key labels in the User Guide are simplified for description purposes and differ with actual Display.

Other Notations

In the User Guide, the product is referred to as "handset." microSD™/microSDHC™/microSDXC™ Card is referred to as "SD Card."

Accessing Instructions on Handset

Use Guide application to learn touch operations or making settings. Or access FAQ website.

Launching Guide

1

In Home Screen,  (Applications List)   (Guide)

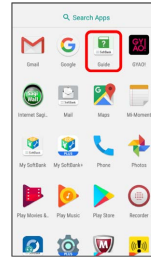

 Guide top opens.

- If using Guide for the first time, Usage notes appear. Follow onscreen instructions.

Showing Status Bar Indicator

Set Guide indicator to show on Status Bar.

1

In Home Screen, (Applications List) (Guide)

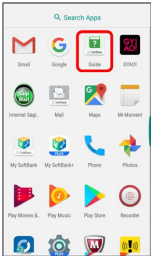

Guide top opens.

· If confirmation appears, follow onscreen instructions.

2

Indicator

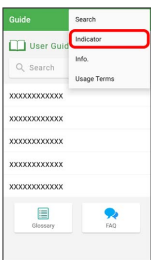

3

on BACK

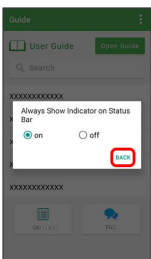

Setting is complete.

Launching Guide from Notifications Window

Find Guide indicator on Status Bar. Activate the application to learn handset operations, etc.

1

Drag Status Bar down to open Notifications Window



Notifications Window opens.

2

Guide

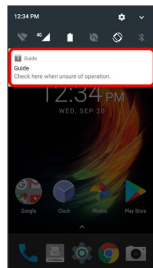

Guide top opens.

Using Guide

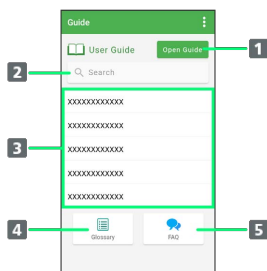

Item	Description
1 Open Guide	Check operations for your purposes.
2 Search	Search for Guide.
3 Frequently Accessed	Show frequently accessed items at random. Tap item to jump to description.
4 Glossary	Check glossary.
5 FAQ	Check FAQ. Or access FAQ mobile website.

Getting Started

Parts & Functions.....	6
Battery.....	7
USIM Card.....	8
Internal Memory and SD Card.....	9
Charging Battery.....	12
Power On/Off.....	13
Using Touchscreen.....	13

Parts & Functions

Handset (Front)

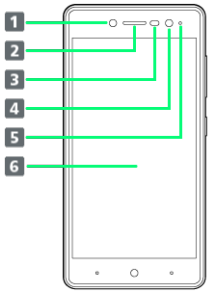

Part	Description
1 Front Camera Flash	Use as camera flash for Front Camera.
2 Earpiece	Hear the other party's voice here.
3 Proximity/ Light Sensor	Proximity Sensor prevents Touchscreen misoperation during a call. Light Sensor adjusts brightness of Display according to ambient brightness.
4 Front Camera	Capture still images and videos of yourself.
5 Notification Lamp	Flashes for incoming transmissions. Lights while charging.
6 Display	Touchscreen-type display; operate with your fingers on Display.

Handset (Back/Side)

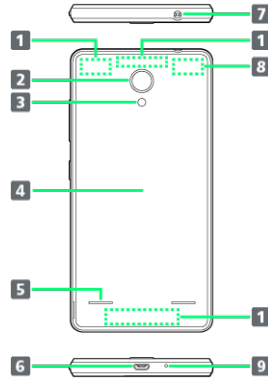

Part	Description
1 Internal Antenna Area	Internal Antenna for call and data communication.
2 Camera	Capture still images and videos.
3 Camera Flash	Use as flash in dark place.
4 Battery Cover	Open to insert/remove USIM Card or SD Card.
5 Speaker	Hear music, video sounds, etc. here.
6 External Device Port	Connect AC Charger or Micro USB Cable.
7 Earphone Port	Connect headphones.
8 Wi-Fi/GPS Antenna Area	Internal Antenna for Wi-Fi and GPS.
9 Mic	Speak here.

Keys



Part	Description
1 Volume Up/ Down Key	Adjust Volume.
2 Power Key	Toggle Display on/off. Long Press for power on/off.

Battery

Inserting Battery

1

Remove Battery Cover

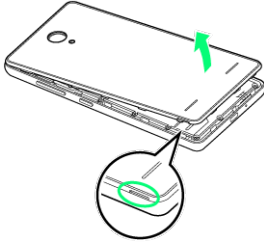

- Lift the recess up to make a gap between Battery Cover and handset. Remove Battery Cover little by little along the edge.
- Be careful not to hurt fingernails.

2

Insert Battery

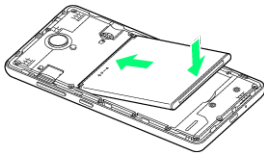

- Insert Battery so that the terminal part contacts the terminal part of handset, then set it into handset.

3

Attach Battery Cover

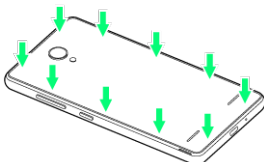

- Firmly Press Battery Cover until it clicks so as not to make any gaps between Battery Cover and handset.

Removing Battery

Always power off beforehand.

1

Remove Battery Cover

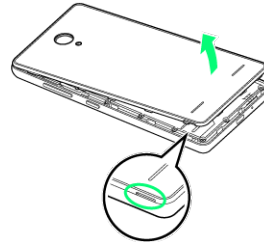

- Lift the recess up to make a gap between Battery Cover and handset. Remove Battery Cover little by little along the edge
- Be careful not to hurt fingernails.

2

Remove Battery

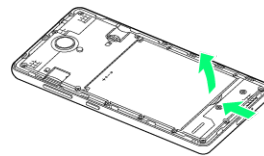

- Put your finger into the groove of handset and then lift the one side of Battery. Forcibly removing may damage the terminal part.

3

Attach Battery Cover

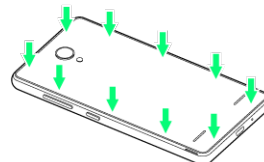

- Firmly Press Battery Cover until it clicks so as not to make any gaps between Battery Cover and handset.

USIM Card

USIM Card is an IC card containing phone number and other customer information.

Handling USIM Card

- Customer is responsible for any damage caused by inserting USIM Card in an other-brand IC card reader, etc. SoftBank Corp. is not responsible in such case.
- Always keep the IC chip clean.
- Wipe clean with a dry, soft cloth.
- Avoid applying labels. May damage USIM Card.
- See instructions included with USIM Card for handling.
- USIM Card is the property of SoftBank Corp.
- USIM is replaceable (at cost) in case of loss/damage.
- Return USIM Card to SoftBank Corp. when canceling subscription.
- Returned USIM Cards are recycled for environmental purposes.
- Note that USIM Card specifications and performance may change without notice.
- It is recommended that you keep a separate copy of information that is stored on USIM Card. SoftBank Corp. is not responsible for damages from stored information that is lost.
- Always follow emergency procedures to suspend service if your USIM Card or handset (USIM Card inserted) is lost/stolen. For details, contact [Customer Service](#).
- Always power off handset before inserting/removing USIM Card.

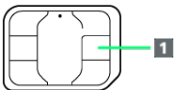

1 IC chip

Inserting USIM Card

Always power off beforehand.

1

Remove Battery Cover

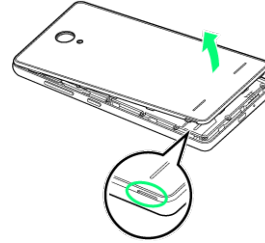

- Lift the recess up to make a gap between Battery Cover and handset. Remove Battery Cover little by little along the edge.
- Be careful not to hurt fingernails.

2

Slowly insert USIM Card straight with metal chip facing down

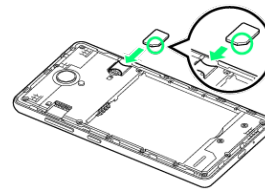

3

Attach Battery Cover

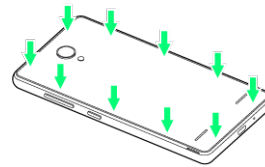

- Firmly Press Battery Cover until it clicks so as not to make any gaps between Battery Cover and handset.

Removing USIM Card

Always power off beforehand.

1

Remove Battery Cover

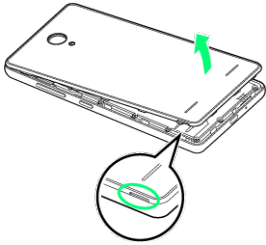

- Lift the recess up to make a gap between Battery Cover and handset. Remove Battery Cover little by little along the edge.
- Be careful not to hurt fingernails.

2

Put your fingernail into the groove of Card Slot and slide USIM Card until USIM Card is moved out a little, then slowly pull it out

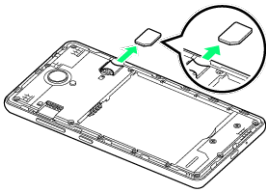

3

Attach Battery Cover

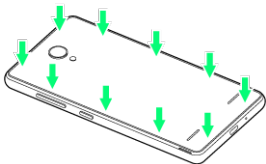

- Firmly Press Battery Cover until it clicks so as not to make any gaps between Battery Cover and handset.

SIM-Unlocking Handset

Handset can be SIM-unlocked. SIM-unlocking handset allows other-carrier SIM cards to be used with it.

- Some services, functions, etc. may have restrictions when an other-carrier SIM card is used. SoftBank Corp. does not guarantee operation whatsoever.
- For details, see SoftBank Website.

Internal Memory and SD Card

Save data to handset memory or SD Card.

Handset supports SD Cards up to 128GB. Some SD Cards may not operate properly.

! SD Card Cautions

Data

Information stored on SD Card can become lost or changed accidentally or as a result of damage. It is recommended that you keep a separate copy of important data. SoftBank Corp. is not responsible for damages from data that is lost or changed.

Reading/Writing Data

Never power off while reading or writing data.

Battery Level

A low battery charge may prevent reading/writing to SD Card.

⊘ Handling SD Card

Use/store SD Cards away from the reach of infants. May cause choking if swallowed.

Inserting SD Card

Always power off beforehand.

1

Remove Battery Cover

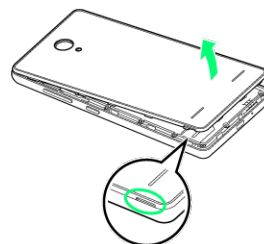

- Lift the recess up to make a gap between Battery Cover and handset. Remove Battery Cover little by little along the edge.
- Be careful not to hurt fingernails.

2

Insert SD Card gently with the terminal part facing down.

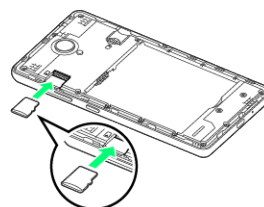

3

Attach Battery Cover

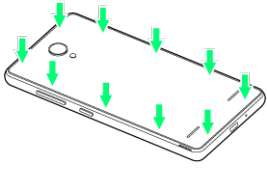

- Firmly Press Battery Cover until it clicks so as not to make any gaps between Battery Cover and handset.

Unmounting SD Card

Always unmount SD Card before removing.

1

In Home Screen, (Applications List) (Settings)

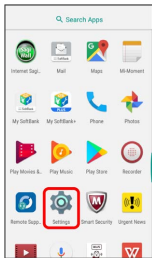

2

Storage

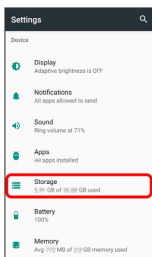

3

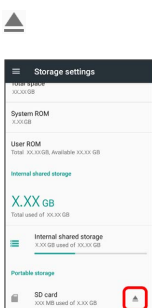

Item name changes from amount of memory to **Ejected** .
SD Card is unmounted.

Removing SD Card

Always unmount SD Card and power off first.

1

Remove Battery Cover

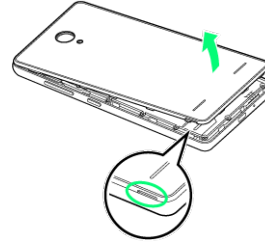

- Lift recess up to make gap between Battery Cover and handset. Remove Battery Cover little by little along edge.
- Be careful not to hurt fingernails.

2

Slowly pull SD Card straight out

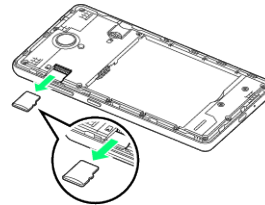

3

Attach Battery Cover

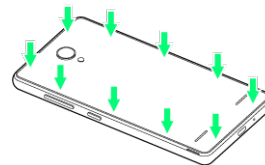

- Firmly Press Battery Cover until it clicks so as not to make any gaps between Battery Cover and handset.

Formatting SD Card

When using a new SD Card for the first time, always format it on handset.

- Formatting erases all data on SD Card. Carefully check any SD Card that was used on another device before formatting.
- Charge Battery while formatting, or format with adequate battery charge.

1

In Home Screen, ^ (Applications List) → (Settings)

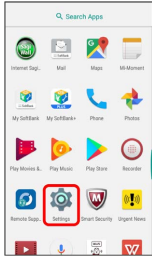

2

Storage

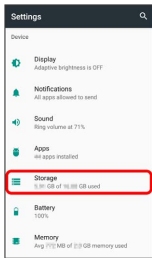

3

SD card

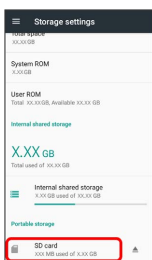

4

Storage settings

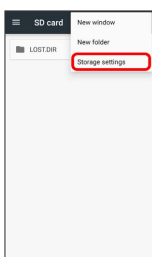

5

Format → ERASE & FORMAT

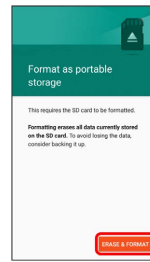

All data on SD Card is erased.

Charging Battery

! Charging

Do not connect Micro USB plug when handset or peripheral device is wet.

Charging with AC Charger (Sold Separately)

AC Charger is sold separately. Use specified AC Charger. For AC Charger or other related accessories, see SoftBank Website.

- See AC Charger manual. Charging with AC Adapter (Micro USB 1.0A) [ZSDBA6] (SoftBank SELECTION Micro USB 1.0A AC Adapter for smartphones 1.0A [SB-AC13-HDMU/WH]) is explained here.

1

Insert Micro USB plug of AC Charger into External Device Port

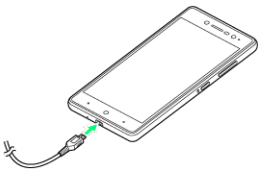

2

Raise power plug and plug AC Charger into household power outlet

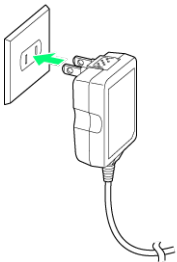

🚩 Notification Lamp lights when charging starts.

3

When charging is complete, unplug AC Charger and remove Micro USB plug

Charging by PC

For Micro USB Cable and other related accessories, see SoftBank Website.

- Always turn on PC beforehand.
- Battery may not charge depending on type of connection to PC.

1

Insert Micro USB plug into External Device Port

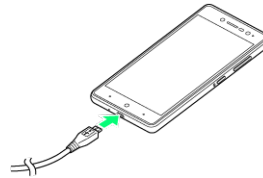

2

Insert USB plug into PC

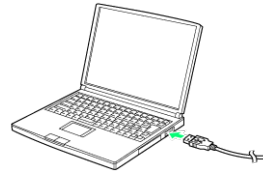

🚩 Notification Lamp lights when charging starts.

3

After charging, remove Micro USB Cable from PC and handset

Power On/Off

Powering On

1

Power Key (Long Press)

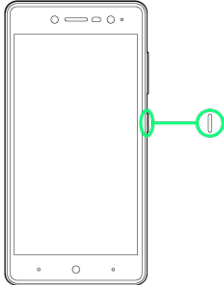

Lock screen appears.

- See "[Unlocking Screen](#)" to unlock the screen.
- Startup guidance appears the first time handset is powered on. Follow onscreen instructions to make settings.

Powering Off

1

Power Key (Long Press)

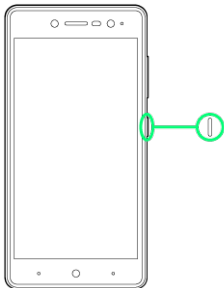

2

Power off

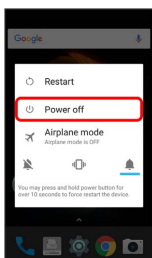

Handset powers off.

Using Touchscreen

Handset Display is a touchscreen. Operate with your fingers on Display.

Tap

Contact Display lightly and briefly.

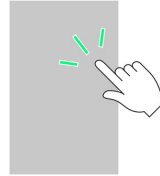

Touch & Hold

Contact Display lightly; release finger when screen changes.

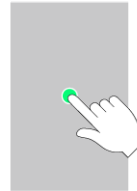

Drag

Touch icon or other item lightly, move it where desired, and release finger.

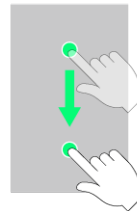

Swipe/Flick

Contact Display lightly, then brush screen up/down or left/right.

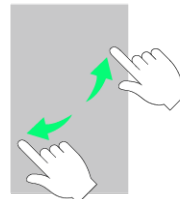

Pinch/Spread

Contact Display lightly, then close/widen fingers.

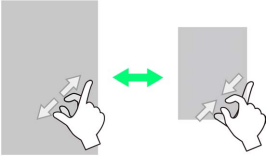

Basic Operations

Basic Operation.....	16
Confirmation when First Launching Applications.....	17
Applications.....	18
Phone Number.....	19
Silent Mode.....	19
Airplane Mode.....	20
Text Entry.....	21
Using a Google Account.....	22
Google Play.....	24
Security Codes/Operation Password.....	26
SIM PIN.....	27
Locking Screen.....	28
Updating Software.....	28

Basic Operation

Home Screen & Applications List

Most handset operations start in Home Screen (appears at power on) or in Applications List.

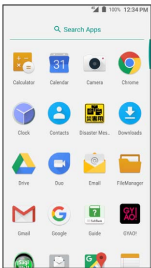

Navigation Bar

Tap icons on Navigation Bar (Display bottom) for the following functions/operations.



Item	Description
(Back)	Return to previous screen. Tap to close keyboard while it appears.
(Home)	Return to Home Screen
(History)	Open listing of recently used applications and activate or delete applications.

Selecting Options and Navigating Screens

Tap items, icons, onscreen keys, etc. to open assigned items.

- Tap to go back to previous screen.

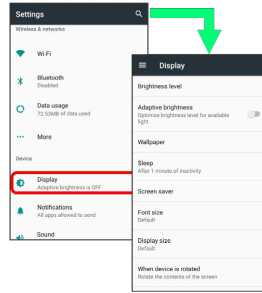

Menu Operations

Tap for available settings and items.

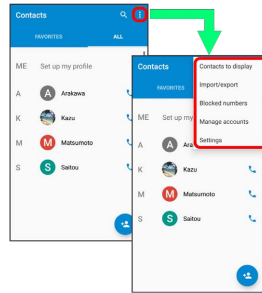

Screens may also have settings and items that are available by Touching & Holding Display.



Handset Settings and Making Settings

In Home Screen, Tap (Applications List) then Tap (Settings) to customize the operation of handset functions.

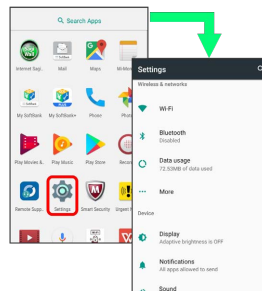

Portrait Orientation & Landscape Orientation

The screen changes to portrait orientation when handset is rotated sideways.

- Depending on the current screen, the orientation may not change even by changing handset orientation.

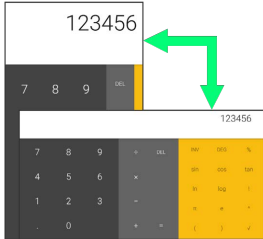

Confirmation when First Launching Applications

Setting Required Permissions for Applications

Type of confirmation and the content differ with application. Operation when activating ☎ (Phone) for the first time is described as an example.

- Application may not work correctly if use of functions is not permitted.

1

In Home Screen, ^ (Applications List)



Applications List opens.

2

☎ (Phone)

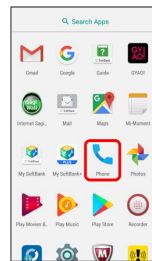

3

DENY / ALLOW

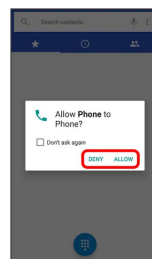

Setting is complete.

- Generally, select **ALLOW** to permit use of the function.
- For several functions, set in the same way.

+ Other Ways to Set Required Permissions for Applications

Setting Functions to Use by Application

In Home Screen, ^ (Applications List) →
 (Settings) → Apps → Tap application →
 Permissions → Tap function
 · Tap function to toggle on ()/off ().

Setting Applications with Permitted Usage by Function

In Home screen, ^ (Applications List) →
 (Settings) → Apps → App permissions →
 Tap application → Tap application
 · Tap application to toggle on ()/off ().

Applications

Launching Applications

1

In Home Screen, ^ (Applications List)



Applications List opens.

2

Tap the application

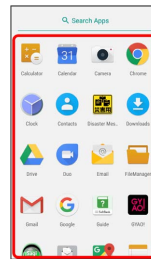

Application is activated.



Required Permissions for Applications

Some applications request permissions of functions such as accessing to handset data, capturing photos, etc. Permission confirmations appear when application is launched. Follow onscreen instructions. For details, see "[Confirmation when First Launching Applications.](#)"

Phone Number

Checking Your Phone Number

1

In Home Screen,  (Applications List)   (Settings)

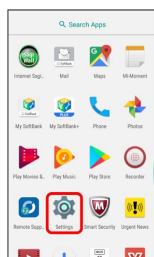

2

About phone

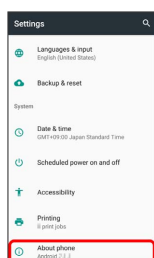

3

Status

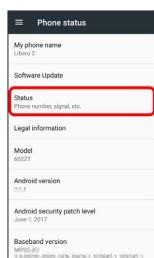

4

SIM status



 Check phone number.

Silent Mode

! Cautions In Silent Mode

Camera shutter sound, video recording tones, alarm sound, video/music sound, etc. play even in Silent Mode.

Using Silent Mode (Vibrate)

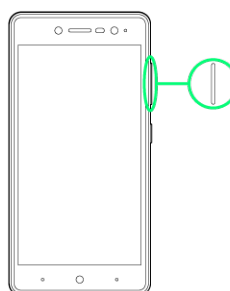

1

Press Up/Down of Volume Up/Down Key



2

On Volume bar, 

 Icon changes to  (White) and Silent mode (Vibrate) is set.

• To cancel Silent mode, Press Up of Volume Up/Down Key while Volume bar appears.

Using Silent Mode (Mute)

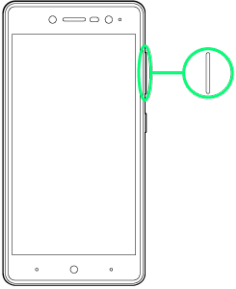

1

Press Up/Down of Volume Up/Down Key



2



On Volume bar,   Press Down of Volume Up/Down Key

 Icon changes to  (Gray) and Silent mode (Mute) is set.

- To cancel Silent mode, Press Up of Volume Up/Down Key twice while Volume bar appears.

+ Setting Silent Mode in Quick Settings

Set Silent mode option in Quick Settings.

Drag Status Bar down with two fingers  Do not disturb  Total silence / Alarms only / Priority only  DONE

Total silence: Mutes incoming ringtone, operation sound, alarm, video sound, music, etc. and does not vibrate.

Alarms only: Sounds alarm, video sound, music, etc.; mutes incoming ringtone, operation sound, etc. and does not vibrate.

Priority only: Sounds incoming ringtone or notifications set in **Priority only allows** in **MORE SETTINGS** .

- Camera shutter and video recording tones are not muted regardless of the setting.
- For Quick Settings, see "[Using Notifications Window/Quick Settings](#)."

Airplane Mode

Using Airplane Mode

Disable all functions that emit signals. Handset remains powered on.

1

Drag Status Bar down using with two fingers



 Quick Settings open.

2

Airplane mode

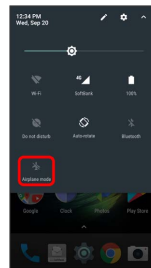



 Handset is in Airplane mode.

- Use same operation again while in Airplane mode to cancel.



Text Entry

Keyboards

Use onscreen keyboards for text entry. 10-key keyboard and QWERTY keyboard are available to enter Alphabet.

- To hide keyboard, Tap .
- Default input mode is Kana (Japanese) (10-Key Keyboard); Tap  to toggle input mode to Alphabet.

+ Changing to QWERTY Keyboard

While 10-key keyboard appears, Tap  above the keyboard  Select QWERTY keyboard

10-Key Keyboard Layout

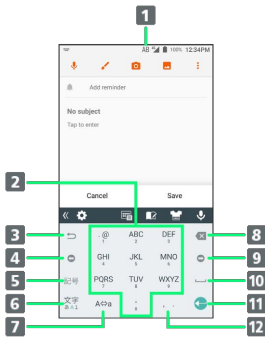

- 1 Current input mode
- 2 Enter assigned character
- 3 Undo entry
- 4 Move Cursor to the left
- 5 Toggle Emoji/Symbol/Emoticon list
- 6 Toggle input mode (Kana/Alphabet/Number)
- 7 Change to upper case/lower case
- 8 Delete a character before cursor
- 9 Move cursor to the right
- 10 Enter a space
- 11 Enter a linefeed, or fix entered text
- 12 Enter a comma (,), or period (.)

QWERTY Keyboard Layout

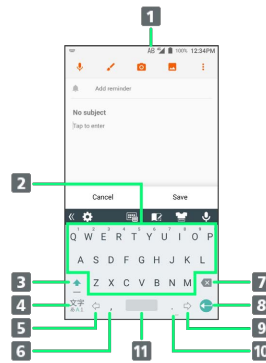

- 1 Current input mode
- 2 Enter character
- 3 Change to upper case/lower case
- 4 Toggle input mode (Kana/Alphabet/Number & Symbol)
- 5 Move cursor to the left
- 6 Enter a comma (,)
- 7 Delete a character before cursor
- 8 Enter a linefeed, or fix text
- 9 Move cursor to the right
- 10 Enter a period (.)
- 11 Enter a space

Using a Google Account

Use a Google account and get more convenience with Google services. A Google account is required to use some services or fully use some applications.

Google Account Cautions

Be careful not to forget your Google account ID or password.

Creating a Google Account

1

In Home Screen, (Applications List) (Settings)

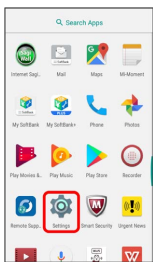

2

Accounts Add account

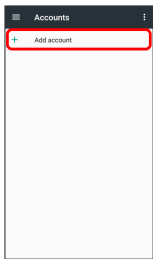

3

Google

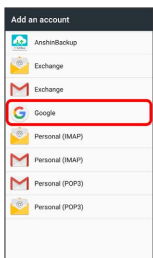

Window for adding a Google account opens.

4

More options Create account

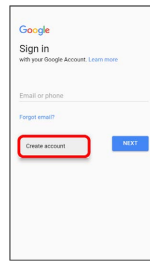

5

Enter first name Enter last name NEXT



6

Enter birth date and gender NEXT

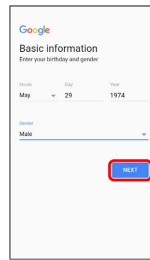

7

Enter username (mail address) NEXT



If confirmation appears, follow onscreen instructions.

8

Enter password → Enter password again (for confirmation)

→ NEXT

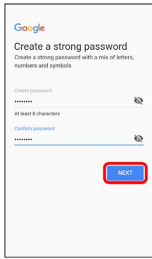

9

Enter phone number for recovery → NEXT

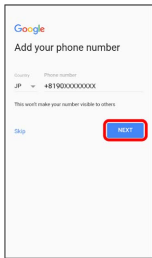

10

VERIFY

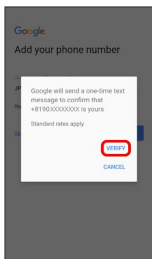

🚩 SMS is sent to the entered phone number.

11

AGREE

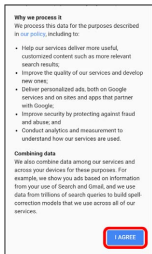

🚩 Google account is created.

12

NEXT

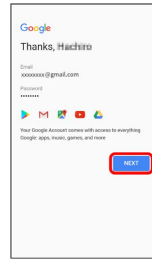

13

Set each item → AGREE

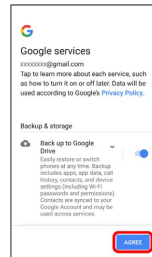

🚩 Creating Google account is complete.

Logging In with a Google Account

If an application is activated that requires a Google account, a window for adding a Google account opens. Sign in with a Google account you have so you can use the application.

1

In window for adding Google account, enter mail address →

NEXT

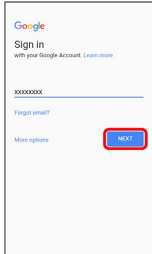

2

Enter password → NEXT

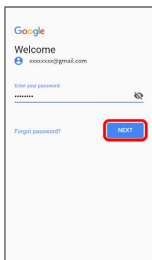

3

Follow onscreen instructions

🚩 You are logged in to your Google account.

Google Play

Download a variety of applications (free/paid) from Google Play. Change the setting of downloaded applications to enable manual or automatic updates. Log in to your Google account beforehand.

! Installing Applications

Many different kinds of applications can be installed on handset from Google Play (provided by Google Inc.). SoftBank Corp. is not responsible in any way for user-installed applications (quality, reliability, legality, fitness for a purpose, credibility, accuracy, etc.) or resulting malfunctions (viruses, etc.).

Installing Free Applications

1

In Home Screen, (Applications List) → (Play Store)

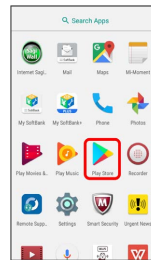

🚩 Google Play appears.

• If confirmation appears, follow onscreen instructions.

2

Tap free application → INSTALL → ACCEPT

🚩 Application is downloaded and installed.

Purchasing Paid Applications

1

In Home Screen, ^ (Applications List) → (Play Store)

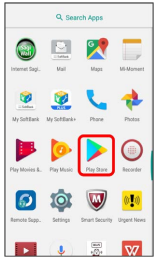

Google Play appears.

- If confirmation appears, follow onscreen instructions.

2

Tap paid application → Tap amount → Follow onscreen instructions

Application is downloaded and installed.

Purchased Applications

Payment

Pay only once. Redownloads of uninstalled applications are free of charge.

On Other Android Devices

Install an application on any Android device under the same Google account for free.

Requesting Refunds

Refund is possible within a limited time. By requesting a refund, the application is deleted and the charge is cancelled. A refund request is valid only once per one application.

In Google Play, ≡ → My apps & games → Tap application → REFUND

Purchasing Applications

Purchase applications at your own risk. SoftBank Corp. is not responsible for any disadvantage resulting for user or third parties.

Updating Applications

1

In Home Screen, ^ (Applications List) → (Play Store)

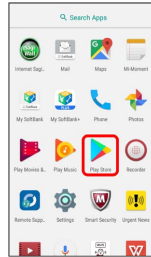

Google Play appears.

- If confirmation appears, follow onscreen instructions.

2

≡ → My apps & games → Tap application to update → UPDATE

The application is downloaded and installed.

- If confirmation appears, follow onscreen instructions.

Setting Application Updates

Setting Automatic Application Updates

In Google Play, ≡ → Settings → Auto-update apps

Setting Automatic Update to Each Application



In Google Play, ≡ → My apps & games → Tap application → Auto-update ()

- Automatic update may not be available for some applications.

Uninstalling Applications

Applications installed from Google Play can also be uninstalled.

1

In Home Screen,  (Applications List)   (Play Store)

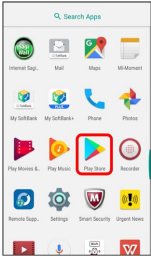

 Google Play appears.

· If confirmation appears, follow onscreen instructions.

2

  My apps & games  Tap application to uninstall
 UNINSTALL  OK

 Application is uninstalled.

How to Use Google Play

1

In Google Play,   Help & feedback

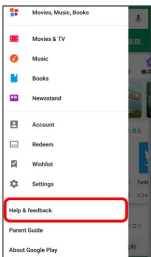

 Google Play Help window opens.

2

Follow onscreen instructions

 A description for each item appears.

Security Codes/Operation Password

Security Codes

The following are main security codes required for handset use.

Type	Description
Operation Password	A code required for using some functions. For details, see " Operation Password and Center Access Code. "
Center Access Code	A four-digit code set in subscription contract. For details, see " Operation Password and Center Access Code. "
SIM PIN	A code for USIM Card. For details, see " SIM PIN. "
PIN	A code for unlocking screen.
WPS PIN	A code for connecting WPS devices.

PIN Types

There are different types of PINs; SIM PIN for USIM Card, PIN for unlocking screen and WPS PIN for connecting WPS devices. Do not forget these codes.

Operation Password and Center Access Code

A Center Access Code is required for using handset. This code is the four-digit security code at time of subscription. It is required when using option services from a landline phone etc.

- Be careful not to forget Center Access Code. If you forget the code, contact us for recovery. For details, contact [Customer Service.](#)
- Be careful to keep Center Access Code confidential. SoftBank Corp. is not responsible for damages resulting from misuse by other parties.

SIM PIN

SIM PIN is the security code for your USIM Card. It prevents third parties from unauthorized use of handset. By default, "9999" is set.

Enabling SIM PIN

By enabling SIM PIN, SIM PIN entry is required each time powering on handset with the USIM Card installed.

1

In Home Screen, ^ (Applications List) → ⚙️ (Settings)

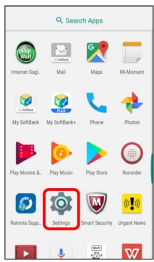

2

Security

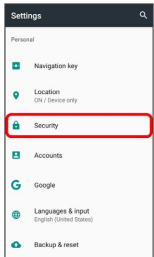

3

Set up SIM card lock → Lock SIM card → Enter PIN → OK ()

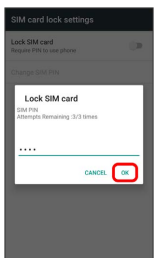

PIN is enabled.

! PIN Cautions

Entering incorrect PIN three times locks PIN. To release locked PIN, enter PUK (Personal Unblocking Key). For details on PUK, contact [Customer Service](#). Entering incorrect PUK ten times consecutively locks USIM Card to disable handset operations. In that case, reissue of USIM Card at a SoftBank Shop (paid service) is needed.

Changing SIM PIN

Changing SIM PIN is only available when SIM PIN is enabled.

1

In Home Screen, ^ (Applications List) → ⚙️ (Settings)

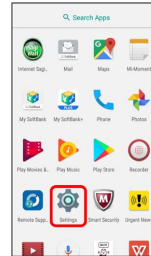

2

Security

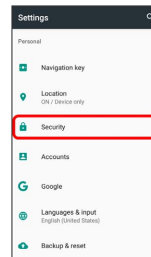

3

Set up SIM card lock → Change SIM PIN → Enter PIN → OK → Enter new PIN → OK → Enter new PIN again (for confirmation) → OK

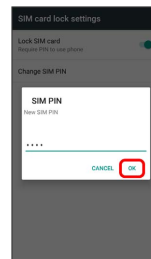

SIM PIN is changed.

Locking Screen

Display is locked after a set period of inactivity. Alternatively, Press Power Key for manual screen lock. This saves battery power and prevents accidental Touchscreen operation.

Unlocking Screen

1

In sleep mode, Press Power Key

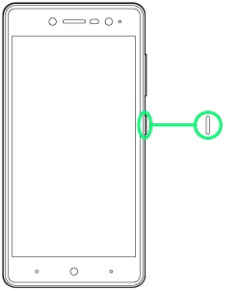

 Lock screen appears.

2

Swipe  up



 Screen is unlocked.

· The method for unlocking the screen can be changed from Security settings.

Updating Software

Check whether updates are required via the network, and update as required.

Before Updating Software

Saved data may be lost depending on condition of handset (malfunctioning, damaged, water seepage, etc.). It is recommended that you back up important data before updating software. SoftBank Corp. is not responsible for damages from loss of data.

Software Update Cautions

During Update

Handset cannot be used until software is updated. It may take time to update software.

Signal during Update

Operate handset where signal reception is good and without changing location. Also operate with adequate battery charge. Signal becoming weak or Battery becoming low during an update may cause an update failure. An update failure may disable handset.

If Using Other Functions

Other functions cannot be operated during a software update.

Updating Software

1

In Home Screen,  (Applications List)   (Settings)

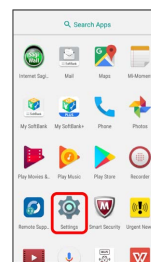

2

About phone

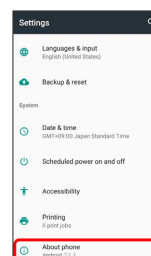

3

Software Update



 Software Update window opens.



4

Software Update  Follow onscreen instructions



 Software update starts.

 Software Update Setting Operations

Setting whether to Update Software Automatically

On Software Update window, **Automatic Update**
Settings  **NOT AUTOMATICALLY UPDATE** /
AUTOMATICALLY UPDATE  **OK**

Changing Scheduled Update

On Software Update window, **Update Schedule Settings**
 **Set time**  **OK**  **OK**

Handset Interface

Home Screen Basics.....	32
Status Bar.....	32
Using Notifications Window/Quick Settings.....	33

Home Screen Basics

Home Screen appears at power on; most handset operations start here. Customize Home Screen with application shortcuts, widgets, and folders.

Home Screen Layout



Area	Description
1 Status Bar	Drag down for Notifications Window. Drag down using with two fingers for Quick Settings.
2 Applications List Button	Open Applications List.
3 Dock	Tap icon to launch application or function. Customize with up to five application shortcuts. Also, create folders.
4 Customize Area	Place application shortcuts, folders, widgets freely.

Toggling Home Screen Sheets

Home Screen consists of several sheets. Customize each Home Screen sheet with icons, widgets, etc. to make handset more convenient. Flick Home Screen left/right to toggle sheets.

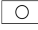
In any Home Screen sheet, Tap  to return to Home Screen top sheet.



Status Bar

Status Bar appears at the top of Display. Notification Indicators for new mail, etc. and Status Indicators for handset appear here.



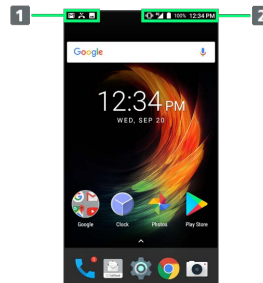







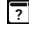





Status Bar Layout

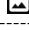

- 1** Notification Indicators
- 2** Status Indicators

Main Notification Indicators

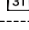
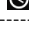
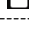
Notification Indicators appearing in Status Bar include the following.

Indicator	Description
	Launch Guide (Drag Status Bar down and open from Notifications Window)
	Missed Call
	Call Arriving/In Progress/On Hold
	New Text Message (SMS)/S! Mail
	New Gmail
	New Email
	Wi-Fi Open Network Available
	Sharing File via Bluetooth®
	Data Uploading
	Data Downloading
	Application Update Available
	Application Installation Complete
	Screenshot
	Playing Music with Play Music
	Calendar Event Reminder
	Snoozing/Unchecked Alarm
	Mounting SD Card
	Software Update Notice, Downloading Complete, Stopped
	Hidden Notice

Main Status Indicators

Status Indicators appearing in Status Bar include the following.

Indicator	Description
	Battery Level
	Battery Charging
	Signal Strength (Strong)
	Signal Strength (Weak)
	No Signal
	4G LTE/4G Data in Use ¹
	3G Data in Use
	Airplane Mode
	Wi-Fi Connected
	Bluetooth [®] ON
	Bluetooth [®] Device Connected
	Silent Mode (Vibrate)
	Silent Mode (Total Silence) ²
	Silent Mode (Alarms Only or Priority Only) ²
	Obtaining Current Location
	Alarm Set

- 1 Handset supports FDD-LTE (SoftBank 4G LTE) and AXGP (SoftBank 4G); indicator appears when handset is connected to either. Handset connects to SoftBank 4G first.
- 2 Settable to Silent mode in Quick Settings. For Quick Settings, see "Using Notifications Window/Quick Settings."

Using Notifications Window/Quick Settings

Drag Status Bar down to open Notifications Window. Open Notification Indicators to check details.

Drag Notifications Window down to open Quick Settings. Tap icon to set ON/OFF of function.

Opening Notifications Window/Quick Settings

1

Drag Status Bar down



Notifications Window opens.

2

Drag Notifications Window down

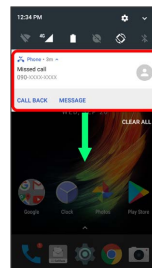

Quick Settings open.

· Alternatively, Drag Status Bar down with two fingers to open Quick Settings.

+ Notifications Window/Quick Settings

Closing Notifications Window/Quick Settings

Drag Notifications Window/Quick Settings up

· Alternatively, Tap to close Notifications Window/Quick Settings.

Customizing Quick Settings

Add or delete functions to/from Quick Settings, or rearrange the items.

In Quick Settings, Drag the icon following onscreen instructions.

Notifications Window Layout

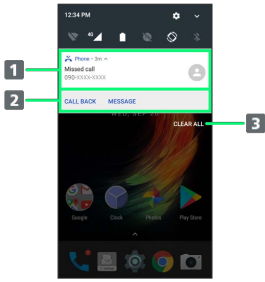

- 1 Show notifications (incoming calls, etc.) and active functions
- 2 Use notification option¹
- 3 Clear all notifications²

- 1 Available functions differ depending on notification. For example, in incoming notification, calling back and sending SMS to incoming phone number are available.
- 2 Flick notifications left or right to clear one by one. Some notifications cannot be cleared.

Quick Settings Layout

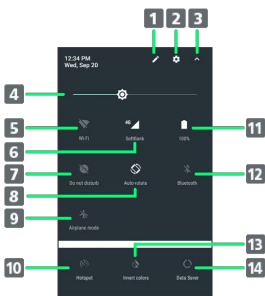

- 1 Edit quick setting item
- 2 Open Settings menu
- 3 Close Quick Settings
- 4 Adjust screen brightness
- 5 Wi-Fi ON/OFF
- 6 Cellular data setting
- 7 Silent mode ON/OFF
- 8 Auto-rotate screen
- 9 Airplane mode ON/OFF
- 10 Hotspot ON/OFF
- 11 Battery level
- 12 Bluetooth® ON/OFF
- 13 Invert colors
- 14 Data Saver ON/OFF

Phone

Placing/Answering Calls.....	36
Optional Services.....	38
Using Contacts.....	40

Placing/Answering Calls

How to dial directly to make a call and answer a call, as well as options when a call is arriving/during a call are described.

Phone Function

Emergency Call Location Information

If handset is used to place a call to emergency numbers such as 110, 119, or 118, your location is automatically reported to the emergency organization such as Police. Location report is calculated from positioning information provided by call accepted base station.

- This service requires no application or communication fee.
- The emergency organization may not be able to determine your precise location due to where the call was made or signal conditions. Be sure to give your location and purpose of the call to the emergency organization.
- Location cannot be reported if you dial with caller ID hidden, for example, using "184" prefix. However, the emergency organization may obtain your location in a life-threatening, etc. crisis.
- While using international roaming, Location report is disabled.

VoLTE

Handset supports VoLTE for high-quality call sound.

- As of October 2017, VoLTE is not compatible with Simple Style (Prepaid Services). For details, see SoftBank Website.

+ Adjusting Volume of Call

Press Volume Up/Down Key during call

? Hints

Q. Difficulty during call

- A. It may not be possible to make a call properly in a noisy location.
- A. When calling using Speaker, check the call volume. Raising the call volume may make calling difficult.

Q. Sound pops momentarily during a call

- A. Are you changing location while calling? Sound pops when signal is weak and handset switches to a different area.

! Emergency Call Cautions

Areas Where Usable

Emergency call from handset can be used within SoftBank service area only.

In Airplane Mode

Emergency calls are restricted in Airplane mode.

Placing Calls

1

In Home Screen, (Applications List) (Phone)

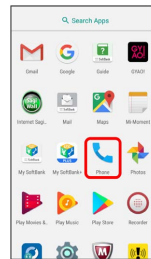

Phone opens.

2

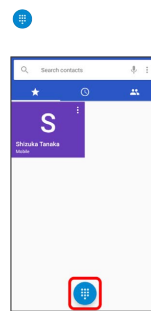

Dialpad window opens.

3

Tap dialpad to enter the other party's number

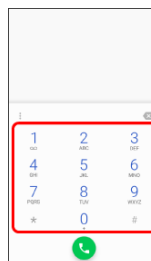

- Enter area code first for calling landline numbers.

4

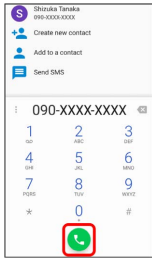

Handset dials number. Call begins when other party answers.

5

To end call,

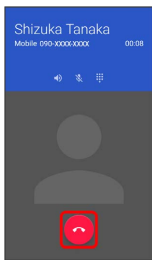

Call ends.

+ Calling Emergency Numbers When Screen Locked

- In Lock Screen, Flick screen up → Tap **EMERGENCY**
- Enter number for emergency service →
- This method is available when method for unlocking screen is a setting other than **Swipe**.

? Hints

- Q.** Call does not connect
- A.** Was the number dialed using the area code? Dial the number starting with "0."
- A.** Are conditions for calling poor? Call again after moving where signal is good.

Answering Calls

1

When a call arrives, Drag right to

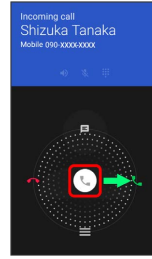

Call begins.

2

To end call,

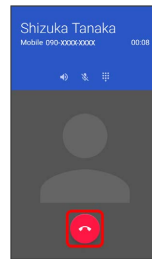

Call ends.

+ Arriving Call Operations

Stopping Ringtone

Press Volume Up/Down Key when call is arriving

Rejecting Arriving Calls

Drag left to when call is arriving

Answering with Answering Machine

When call is arriving, Drag down to →

Answering machine

· To answer call while recording, Tap on recording window.

Answering by Putting a Call on Hold

When call is arriving, Drag down to → **Hold**

· To answer the call, Tap on call-holding window.

Answering with Quick Reply

When call is arriving, Drag up to → Select an SMS message

In-Call Screen Layout

During a call, Tap icons to use the following functions.

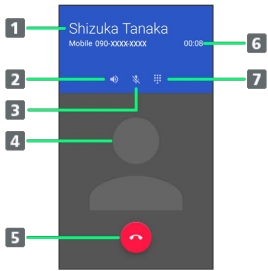

- 1 Show name/number of other party
- 2 Call using Speaker
- 3 Mute your voice to the other party
- 4 Show contact image
- 5 End call
- 6 Show call time
- 7 Show dialpad

Optional Services

Use convenient optional services.

Optional Services

Use the following optional services.

Service	Description
Caller ID	Show or hide your number when placing calls.
Call Barring	Restrict calls according to situation.

Using Caller ID Notification

1

In Home Screen, ^ (Applications List) → 📞 (Phone)

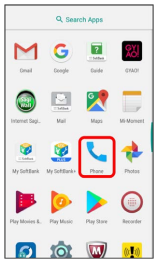

2

☰ → Settings → Call settings

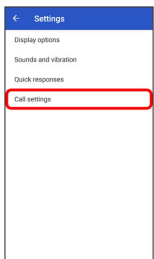

🔲 Call settings open.

3

Additional settings

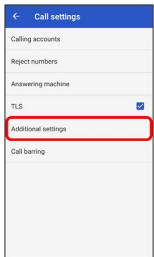

4

Caller ID → Hide number / Show number

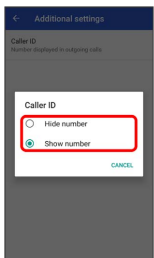

🔲 Caller ID is set.

Using Call Barring

Restrict calls from specified numbers.

- When attempting to place a call while calling is restricted, a message appears. Message may take time to appear in some areas.
- Available setting items are as follows.

Item	Description
All outgoing calls	Restrict all outgoing calls.
Outgoing international calls	Restrict outgoing international calls.
Outgoing international roaming calls	Restrict outgoing international roaming calls.
Stop all outgoing calls	Cancel restriction for outgoing calls.
All incoming calls	Restrict all incoming calls.
Incoming calls when roaming	Restrict incoming calls when roaming.
Stop all incoming calls	Cancel restriction for incoming calls.

1

In Home Screen, ^ (Applications List) → 📞 (Phone)

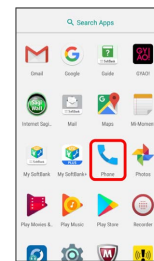

2

☰ → Settings → Call settings

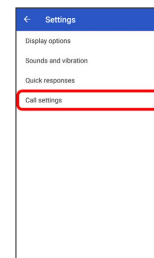

🔲 Call settings open.

3

Call barring

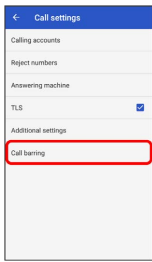

4

Tap target option

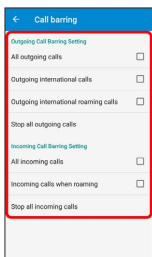

 Call barring is set.

Using Contacts



Save phone numbers, mail addresses, etc. to Contacts.

 **Contacts Cautions**

Information saved in Contacts may be lost or changed if handset is left uncharged. Accident or malfunction may also cause loss or change to information. Accident or malfunction may also cause loss or change to information. It is recommended that you keep a separate copy of contacts and other important information. SoftBank Corp. is not responsible for any damages from lost or changed contacts.

Adding New Contacts

1

In Home Screen,  (Applications List)   (Contacts)

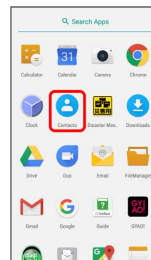

 Contacts open.

2

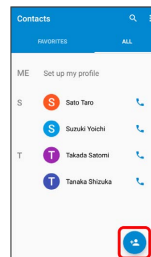

 Add new contact window opens.

- If confirmation appears, follow onscreen instructions.

3

Enter items → ✓ (Save)

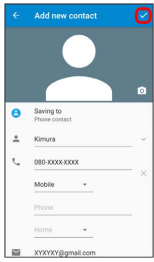

🚩 Contact is added.

+ Saving Contacts from Call Window

Save a number entered in call window directly to Contacts.

In Home Screen, ^ (Applications List) → 📞

(Phone) → 📞 → Tap dialpad to enter phone number

→ Add to a contact

Messaging & Internet

Messaging.....	44
Sending S! Mail/SMS.....	44
Opening & Replying to S! Mail/SMS.....	46
Using Gmail.....	47
Using Chrome.....	49

Messaging

S! Mail

Exchange messages with S! Mail-compatible SoftBank handsets and email compatible devices (other mobiles, PCs, etc.) beyond SMS character entry limit; attach media files.

SMS

Exchange short messages (up to 160 single-byte characters) using handset numbers as addresses.

Gmail

Gmail is Google's webmail service. Handset automatically syncs with Gmail.

Email





Use email (POP3/IMAP4) on handset.

- Set up an email account beforehand.
- Sending/receiving email on handset syncs handset and mail server; sent/received messages (in the POP protocol, received messages only) are also accessible from PCs.

Sending S! Mail/SMS

Sending S! Mail/SMS

1

In Home Screen,  (Applications List)   (Mail) 



2

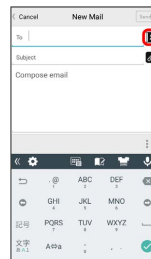

- Alternatively, enter phone numbers or email addresses in Recipient field directly.

3

Phonebook / Outgoing History / Incoming History / Mail Group

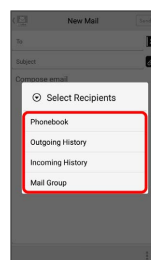

- Tap **Phonebook**, **Outgoing History**, or **Incoming History** to select recipients from Contacts, Outgoing History, or Incoming History.
- Tap **Mail Group** to select a mail group and set all the members on the list as recipients.

4

Select recipients → OK

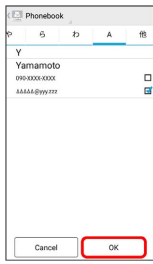

- Tap **Phonebook** / **Outgoing History** / **Incoming History** / **Mail Group** to change recipient lists.
- After setting recipients, Tap **1 0000** to check recipients' phone numbers/email addresses or set them to Cc/Bcc.
- If recipients are set to Cc/Bcc, the mail is sent as S! Mail.
- To delete a recipient, Tap **1 0000** and then **X 0000**. Alternatively, Tap **1 0000** and then **Delete recipient**.

5

Tap Subject/text entry field → Enter subject/text

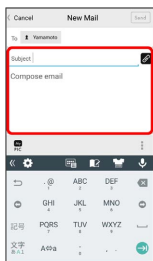

- Tap **📎** to attach a file.
- If a subject is entered or a file is attached, the mail is sent as S! Mail.

6

Send



🚩 S! Mail/SMS is sent.

- Failed S! Mail/SMS messages are saved as drafts.

💡 Sending S! Mail/SMS

S! Mail/SMS Switching

S! Mail and SMS may automatically switch at sending, depending on whether a subject is entered, text length, etc.

- When creating mail, check which it is sent as at top of Display.
 - "New Mail" appears: message is sent as S! Mail.
 - "New SMS" appears: message is sent as SMS.
- In Home Screen, **^** (Applications List) → **📧** (Mail) → **⚙️** → **Common Settings** → Tap **SMS/S!Mail Automatic Switching** () to allow selection between **☑️** (S! Mail) and **✉️** (SMS) when creating mail.

About Drafts

If **📧** is Tapped while creating S! Mail or SMS, the message is saved as a draft.

Drafts are saved to **Draft Box** in folder list, and are indicated as **📧** in thread list. Open an S! Mail/SMS draft to edit and send it.

Opening & Replying to S! Mail/SMS

Handset receives S! Mail/SMS messages automatically by default. Optionally, retrieve messages manually, and also retrieve all messages stored on the server.

+ Receiving S! Mail/SMS during Roaming

To automatically receive S! Mail during roaming, Tap **More** in **Settings** → **Cellular networks** → **Data roaming** to enable data roaming ().

Opening New S! Mail/SMS

When message arrives, new message notification and Notification Indicator appear.

1

Tap notice



Thread detail opens.

- To open new message from Notification Indicator, Drag Status Bar down for Notifications Window, then Tap corresponding notification.
- For two or more new messages, thread list opens.

+ Spam Mail

Set spam filtering to save messages from senders not in Contacts to Spam. New mail notification does not appear. To check messages saved to Spam thread list:

In Home Screen, **^** (Applications List) → **✉** (Mail) → **☰** → **Spam mail**

- If confirmation appears, follow onscreen prompts.

Replying to S! Mail/SMS

1

In S! Mail/SMS message window, **↩** / **↪**



2

Enter text → **Send**

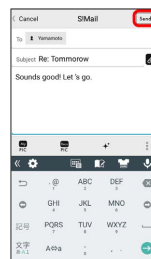

Message is sent.

Using Gmail

Use Google's mail service and your work/home email.

Creating/Sending Gmail

1

In Home Screen, (Applications List) (Gmail)

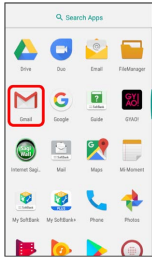

Inbox opens.

2

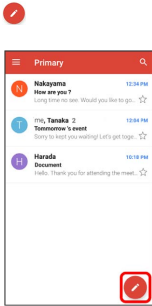

Message composition window opens.

3

Enter recipient/subject/text

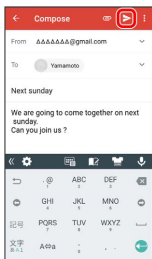

Message is sent.

+ Operations when Composing Message

Adding Cc/Bcc

In message composition window, Add recipient

Attaching Files

In message composition window, Attach file

Select file location Select file to attach

Saving as a Draft

While composing message, Save draft

Deleting Message Being Composed

In message composition window, Discard

DISCARD

Opening New Gmail

When new Gmail arrives, / appear in Status Bar.

1

Drag Status Bar down



Notifications Window opens.

2

Tap new message

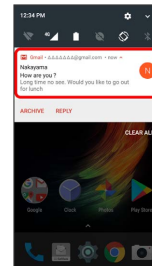

The new message opens.

• For two or more new messages, Inbox opens. Tap a message to open.

Opening Gmail

1

In Home Screen,  (Applications List)   (Gmail)

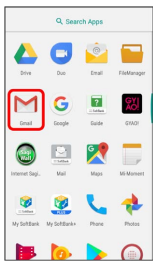

 Inbox opens.

2

Tap target message

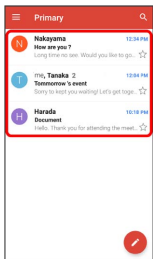



 The message opens.

+ Operations when Opening Messages

Replying to Messages

In message window,   Compose message  

- To reply all, in message window,   Reply all .
- Alternatively, Tap Reply / Reply all below message.

Forwarding Messages

In message window,   Forward  Compose message  

- Alternatively, Tap Reply / Forward below message.

Resetting Messages as Unread

In message list, Tap icon for message to reset as unread (



Deleting Messages

In message list, Tap icon for message to delete ()



Synchronizing Accounts Manually

In message list, Drag the screen down.

- Synchronize messages manually at any time regardless of the auto-sync settings.

Using Chrome

Use the browser simply by entering search words and URLs.

💡 TLS

TLS (Transport Layer Security) is a protocol for encrypting sent/received data. While in a screen connected by TLS, data is encrypted to safely send/receive private information, credit card numbers, corporate secrets, etc., and provide protection against online threats (eavesdropping, falsification, impersonation, etc.).

⚠️ TLS Cautions

When opening a secured page, users must decide as their responsibility whether or not to open the page with use of TLS. SoftBank Corp. and the Certification Authorities Symantec Website Security G.K. and Cybertrust Japan Co., Ltd. make no guarantees whatsoever to users regarding security of TLS.

Using Chrome

1

In Home Screen, ^ (Applications List) → 🌐 (Chrome)

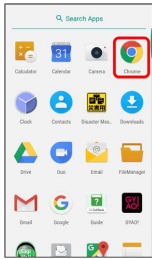

🚩 Chrome opens.

- If confirmation appears, follow onscreen instructions.
- To activate Chrome from URL in SMS or mail message, Tap the URL and Tap **Start browser**.

2

Tap entry box at top → Enter search words or URL → →

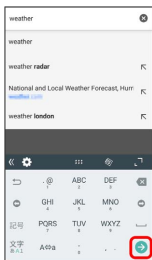

🚩 Search results appear or Web page opens.

+ Chrome Operations

My SoftBank Sign-in

In My SoftBank, check your charges or points, change subscriptions or mail address, or set spam filtering.

In Chrome window/Web page, ⋮ → **Bookmarks**
 → **SoftBank** → **My SoftBank** → Follow onscreen instructions

Searching within Web Page

In Web page, ⋮ → **Find in page** → Enter search text

🚩 Search results are shown highlighted.

Adding Bookmarks

1

In Home Screen, (Applications List) (Chrome)

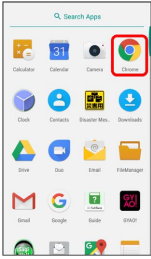

Chrome opens.

2

Show Web page to add

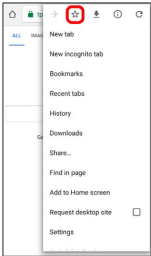

Current Web page is added to Bookmarks.

+ Bookmark Operations

Editing Bookmarks

In Chrome window/Web page, **Bookmarks**

Touch & Hold target bookmark Edit each item

Deleting Bookmarks

In Chrome window/Web page, **Bookmarks**

Touch & Hold target bookmark

Opening New Tabs

Open several tabs to switch between Web pages easily.

1

In Home Screen, (Applications List) (Chrome)

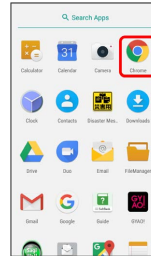

Chrome opens.

2

New tab



New tab appears.

To switch tabs, Tap at top right of window, then Tap target tab. (Number accompanied by icon indicates opened tabs.)

Camera

Capturing Still Images/Videos.....	52
Viewing Captured Still Images/Videos (Photos).....	54

Capturing Still Images/Videos

💡 Capturing Still Images/Videos

File Format for Still Images

File format for still images is JPEG.

File Format for Videos

File format for video is MPEG-4.

⚠️ Camera Cautions

If Lens Becomes Dirty

Fingerprints/smudges on lens prevent capturing of clear still images/videos. Wipe lens with a soft cloth beforehand.

Avoiding Exposure to Direct Sunlight

Be careful not to expose lens to direct sunlight for long periods. May discolor color filter and affect color of images.

🚫 Camera Flash Warning



Do not shine Camera Flash close to eyes. Do not look directly at Camera Flash when shining. Do not shine Camera Flash at other people's eyes. May affect eyesight, etc.

Capturing Still Images

Captured still images are saved to handset (memory).

- SD Card can be set as saving location if inserted.

1

In Home Screen,  (Applications List)  (Camera)

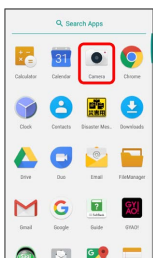





 Photo Viewfinder appears.

- If confirmation appears, follow onscreen instructions.

2

Aim Camera at subject  



 Shutter clicks and still image is saved.



- To lock the focus, Tap Viewfinder.
- By default, face detection takes precedence for focusing.
- After capturing, a thumbnail image appears at top right on Viewfinder. Tap to open the captured image.

+ Capturing Operations (Still Images)

Using Zoom

Pinch/Spread fingers on Viewfinder

Capturing with Volume Up/Down Key

Aim Camera at subject  Confirm auto-focus on the subject  Press Volume Up/Down Key

 A still image is captured.

Checking Captured Still Images

After capturing, Tap the thumbnail on upper right (landscape) or on lower right (portrait) on Viewfinder  Flick left or right to select an image

 Selected still image appears.

- To return to Viewfinder, Tap .

Switching Front Camera and Back Camera

In Viewfinder, 

Photo Viewfinder Layout



- 1 Switch Front Camera/Back Camera
- 2 Set Countdown timer (1s/3s/10s/20s)
- 3 Switch HDR setting
- 4 Switch Flash mode (On/Off/Auto)
- 5 Show Settings menu
- 6 Focus frame
- 7 Thumbnail of captured still image/video
- 8 Switch capturing mode
- 9 Switch Photo Viewfinder/Video Viewfinder
- 10 Shutter
- 11 Set color effect (Mono, Sepia, Lomo, Comic, Cool, Fisheye, Mirror, Warm)
- 12 Exit from Camera

Capturing Videos

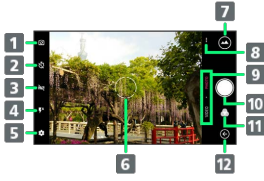
Captured videos are saved to handset (memory).

- SD Card can be set as saving location if inserted.

1

In Home Screen, (Applications List) (Camera)

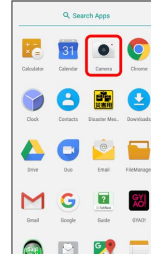

Photo Viewfinder appears.

- If confirmation appears, follow onscreen instructions.

2

VIDEO



Video Viewfinder appears.

3

Aim Camera at subject



Video recording starts.

4

To stop recording,

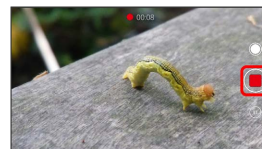

Video recording stops and video is saved.

- Tap to pause recording. To resume, Tap .
- After capturing, a thumbnail image appears at top right on Viewfinder. Tap to open the captured video.

+ Capturing Operations (Videos)

Using Zoom

Pinch/Spread fingers on Viewfinder



Capturing Still Image While Recording Video

Tap  while recording a video

 A still image is captured.

Checking Captured Videos

After capturing, Tap the thumbnail on top right (landscape) or on bottom right (portrait) on Viewfinder

 Flick left or right to select image  

 Video plays.

· When selecting image, Flick right the leftmost image to return to Viewfinder.

Switching Front Camera and Back Camera

In Viewfinder, 

Video Viewfinder Layout

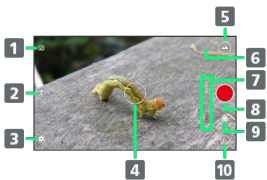

- 1 Switch Front Camera/Back Camera
- 2 Switch Flash mode
- 3 Show Settings menu
- 4 Focus frame
- 5 Thumbnail of captured still image/video
- 6 Switch capturing mode
- 7 Switch Photo Viewfinder/Video Viewfinder
- 8 Capture start/stop
- 9 Set color effect (Mono, Sepia, Lomo, Comic, Cool, Fisheye, Mirror, Warm)
- 10 Exit from Camera

Viewing Captured Still Images/Videos (Photos)

Showing Still Images/Videos

Show captured or downloaded still images and videos. Supported file formats are as follows.

Type	File Format
Still image	BMP, JPEG, GIF, PNG, WebP
Video	MPEG4, 3GP, WebM

1

In Home Screen,  (Applications List)   (Photos)

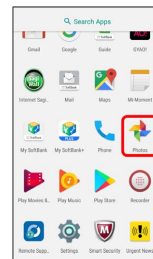

 Still image/video list opens.

- If confirmation appears, follow onscreen instructions.
- When you are signed in to Google account, image list including backed up data appears. For operations, Tap

  

2

Tap a still image/video

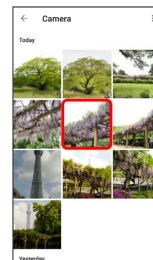

 Still image/video opens.

- For videos, Tap .
- Tap a still image/video to show edit icon etc.

+ Operations when Viewing Still Images/Videos

Zooming In or Out on Still Image

Tap Display twice or pinch on a still image.

Using Slideshow



In image window,   Slideshow

· To end slideshow, Tap the screen.

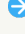
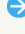
Setting Image

In image window,   Use as  Follow onscreen instructions

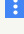
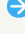
Deleting Image

In image list, Touch & Hold image    Delete 

Music

Listening to Music (Play Music).....58



Listening to Music (Play Music)

Playing Music

Supported file formats are as follows.

- MP3, MP2, AAC, AAC+v1, AAC+v2, IMY, MIDI, Ogg, AMR-WB, AMR-NB, APE, FLAC, ADPCM, WAV

1

In Home Screen,  (Applications List)  (Play Music)

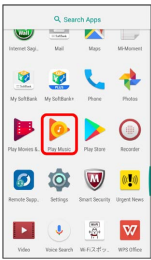

 Listen Now opens.

2

  Music library

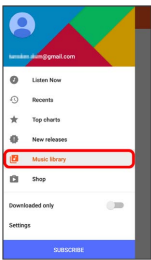

 Music library opens.

3

Flick left/right and select category (such as "ALBUMS")

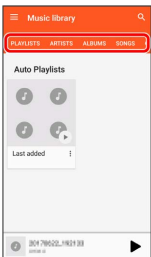

4

Tap item/song to play

 Song plays.

- Drag Playback Bar at bottom of Display up to open Music Playback screen.

Music Playback Screen Layout

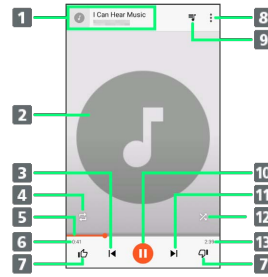

- 1 Song title/artist/song image/Return to music list
- 2 Show song image
- 3 Play previous song/Play current song from the beginning
- 4 Repeat all songs/Repeat one song/Normal play
- 5 Indicator
- 6 Play time
- 7 Song rating
- 8 Add to playlist, Move to ARTISTS etc.
- 9 Return to music list
- 10 Pause/Play
- 11 Play next song
- 12 Shuffle play on/off
- 13 Song length

Creating Playlists

1

In Home Screen, ^ (Applications List) → 🎵 (Play Music)

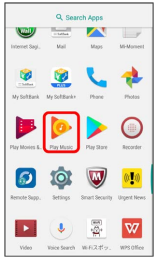

🚩 Listen Now opens.

2

⋮ for item/music to add → Add to playlist

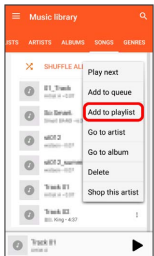

3

NEW PLAYLIST

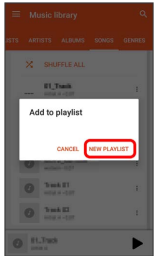

4

Enter playlist name, description → CREATE PLAYLIST

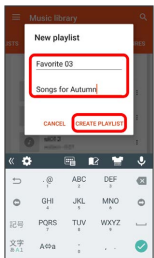

🚩 Playlist is created.

+ Adding Currently Playing Music to a Playlist

In Music Playback screen, ⋮ → Add to playlist → Tap playlist name.

🚩 Music is added to playlist.

Connectivity

Connecting by Wi-Fi.....	62
Using Bluetooth® Function.....	63

Connecting by Wi-Fi



Handset supports Wi-Fi (wireless LAN). Access the Internet via a household Wi-Fi connection environment. For Wi-Fi router (manufactured by FON) users, see "[Fonルーターかんたん設定ガイド \(http://mb.softbank.jp/mb/special/network/pdf/wifi_howto_01.pdf\)](http://mb.softbank.jp/mb/special/network/pdf/wifi_howto_01.pdf)" for details.

Automatic Updates for Optimizing Wi-Fi Connection

While using Wi-Fi, updates for optimizing connection may be received or applied automatically.

Operations when Wi-Fi Is Enabled

Scanning Access Point (Wi-Fi Network)



In Wi-Fi settings,   **Refresh**

Checking Access Point (Wi-Fi Network) Activity while Connected

In Wi-Fi settings, Tap access point (Wi-Fi network)

 Connection activity, signal strength, link speed, frequency, and security appear.

Setting Timing for Pausing Connection

In Wi-Fi settings,   **Keep Wi-Fi on during sleep**
 Tap setting item



Deleting Access Point (Wi-Fi network)

In Wi-Fi settings, Touch & Hold access point (Wi-Fi network)  **Forget network**

Selecting a Network Connection

Select a scanned access point (Wi-Fi network) and connect.

1

In Home Screen,  (Applications List)   (Settings)

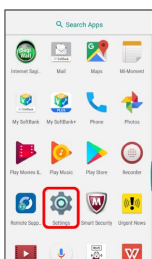

2

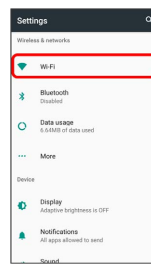

Wi-Fi



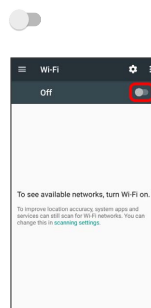

 Wi-Fi settings open.

3



 Wi-Fi is enabled ().

· To disable Wi-Fi, Tap  ().

4

Tap access point (Wi-Fi network)  Enter password 



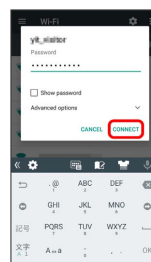

CONNECT



 Handset is connected.



- The password, for a household wireless LAN router, is sometimes found on a sticker on the router (WEP, WPA, KEY, etc.). Contact the router manufacturer for information. For password for a public wireless LAN, check with user's service provider.
- Entering a password is not required if an access point (Wi-Fi network) is not security protected.

Connecting by WPS

In Wi-Fi settings,   **Advanced**  **WPS**
Push Button / **WPS Pin Entry**  Follow onscreen instructions

Disconnecting Wi-Fi

1

In Home Screen,  (Applications List)   (Settings)

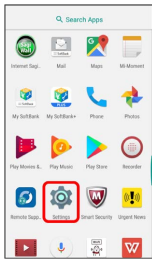

2

Wi-Fi

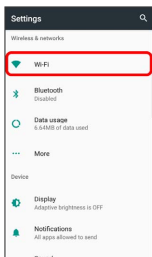

 Wi-Fi settings open.

3

Tap connected access point (Wi-Fi network)  **FORGET**

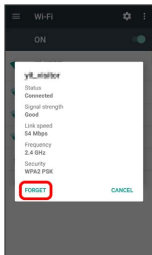

 Wi-Fi is disconnected.

- After disconnecting from an access point (Wi-Fi network), the password may need to be entered again to reconnect.

Using Bluetooth® Function

Connect to a Bluetooth®-capable wireless phone, etc. for calls or to a hands-free device such as a headset.

? Hints

- Q. Cannot use Bluetooth®
- A. Is handset in Airplane mode? Bluetooth® function turns off when Airplane mode is set. In Airplane mode, turn on Bluetooth® again.

! Bluetooth® Function Cautions

Information may not appear correctly on both devices depending on the transferred data.



Using Bluetooth® Function

The Bluetooth® function is a technology that enables wireless connection with PCs, Bluetooth® devices with hands-free device, etc.

Function	Description
Audio output	Listen to music, etc. wirelessly.
Hands-free calls	Call hands-free, using Bluetooth®-capable hands-free devices and headsets.
Data exchange	Exchange data with Bluetooth® devices.

Enabling Bluetooth® Function

1

In Home Screen,  (Applications List)   (Settings)

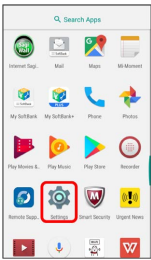

2

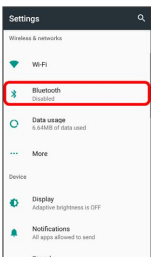

Bluetooth

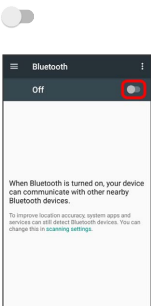

 Bluetooth® settings open.

3



 Bluetooth® function is enabled ().



· To disable Bluetooth® function, Tap  ().

Pairing Bluetooth® Devices

Search for and pair nearby Bluetooth® devices. Registered Bluetooth® devices can be connected simply.

· Enable Bluetooth® function on the Bluetooth® devices being paired beforehand.

1

In Home Screen,  (Applications List)   (Settings)

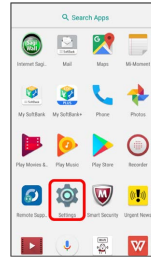

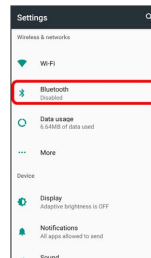

2

Bluetooth



 Bluetooth® settings open.

· Nearby Bluetooth® devices appear in "Available devices."
· If a target device is not found, Tap   **Refresh** and search again.

3



Tap device  Follow the onscreen instructions to accept device

 Bluetooth® device appears in Paired devices list.

· Methods for accepting differ depending on devices being paired.

Connecting to Paired Bluetooth® Devices

1

In Home Screen,  (Applications List)   (Settings)

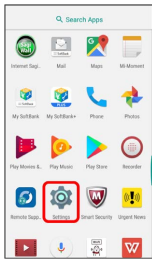

2

Bluetooth

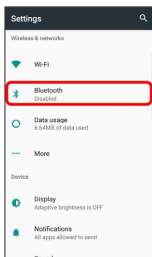

 Bluetooth® settings open.

- Paired Bluetooth® devices appear in "Paired devices."

3

Tap device

 Handset connects to Tapped device.

+ Cancelling Pairing

In Bluetooth® settings,  for paired device 

FORGET

- Settable when "Bluetooth" is enabled.

Global Services



Making Calls while Abroad..... 68

Making Calls while Abroad

Access "Global Service" of SoftBank website (<https://www.softbank.jp/en/mobile/service/global/>) to learn service area, rates, etc. before travelling overseas.

International Calls to Japan and Other Countries from Abroad

1

In Home Screen,  (Applications List)  (Phone)

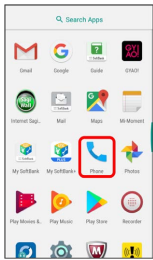

 Phone opens.

2

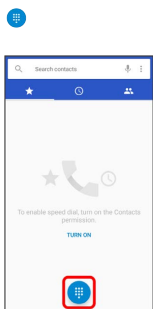

 Dialpad window opens.

3

Touch & Hold 

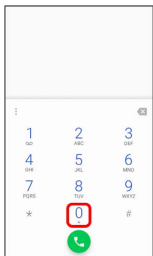

 "+" is entered.

4

Enter country code and then other party's phone number (omit first "0")

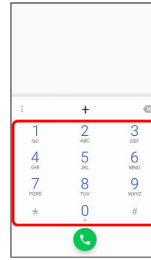

· When dialing Italy (Country code: 39), do not omit first "0".

5



 Handset dials number. Call begins when other party answers.

Calls to Landline Phones/Cell Phones in Country of Stay

Place calls in the same way as in Japan.

- Do not enter country code or omit first "0" from city code.

1

In Home Screen, ^ (Applications List) → ☎ (Phone)

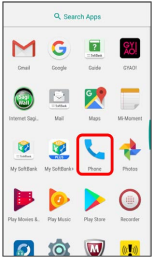

☑ Phone opens.

2

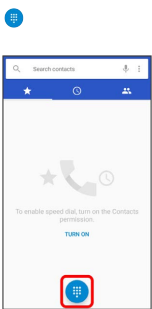

☑ Dialpad window opens.

3

Tap dialpad to enter other party's phone number

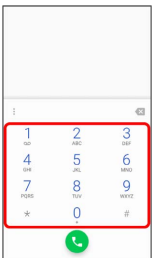

4

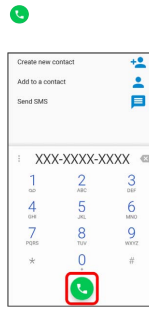

☑ Handset dials number. Call begins when other party answers.

Handset Settings

Handset Settings.....	72
Wi-Fi Settings.....	73
Display Settings.....	74
Notifications Settings.....	74
Sound Settings.....	75
Apps Settings.....	75
Accounts Settings.....	76
About Phone.....	77

Handset Settings

Handset Settings

In Home Screen, ^ (Applications List) → Tap ⚙️ (Settings) to customize operation of handset functions. Handset settings include the following items.

Item	Description
Wi-Fi	Enable Wi-Fi connection.
Bluetooth	Enable Bluetooth® connection.
Data usage	Check mobile data traffic and set limit. Also, check Wi-Fi data traffic.
More...	Set other functions for wireless and networks.
Display	Set brightness, wallpaper, etc.
Notifications	Set notifications.
Sound	Set ringtone, operation tones, etc.
Apps	Check or delete installed and running applications.
Storage	Check handset and SD Card memory space. Also, perform SD Card mount and erase SD Card data.
Battery	Check Battery usage.
Memory	Check memory usage.
Navigation key	Set functions for Navigation keys.
Location	Enable location information.
Security	Set Screen lock, Encrypt phone, etc.
Accounts	Create or add accounts and set sync.
Google	Set Google services.
Language & input	Set functions for language and text entry.
Backup & reset	Back up handset information and initialize handset.
Date & time	Set functions for date and time.
Scheduled power on and off	Set handset power-on/off at specified time.
Accessibility	Set Captions, Magnification gesture, or other useful accessibility functions.
Printing	Set Cloud Print, etc.
About phone	Check handset status.

1

In Home Screen, ^ (Applications List) → ⚙️ (Settings)

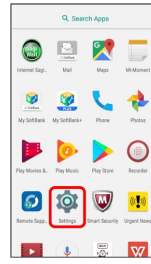

Handset settings open.

2

Set items

Settings are made.

Wi-Fi Settings

Wi-Fi Settings

1

In Home Screen, (Applications List) (Settings)

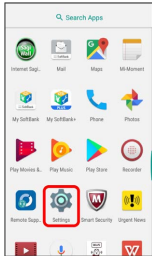

2

Wi-Fi

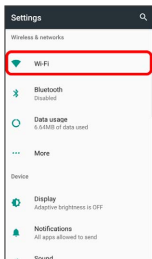

Wi-Fi settings open.

3

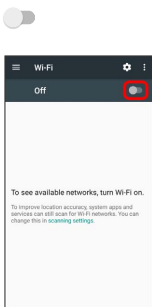

Wi-Fi is enabled ().

· To disable Wi-Fi, Tap ().

4

Tap access point (Wi-Fi network) Enter password

CONNECT

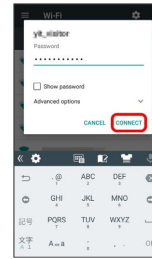

Handset is connected.

- The password, for a household wireless LAN router, is sometimes found on a sticker on the router (WEP, WPA, KEY, etc.). Contact the router manufacturer for information. For password for a public wireless LAN, check with user's service provider.
- Entering a password is not required if an access point is not security protected.
- For details on Wi-Fi connection, see "[Connecting by Wi-Fi.](#)"

+ Wi-Fi Operations

Setting Notification for Open Network

In Wi-Fi settings, Network notification

- Available when is on.
- Tap to toggle on ()/off ().

Setting Timing for Pausing Connection

In Wi-Fi settings, Keep Wi-Fi on during sleep

Installing Certificates

In Wi-Fi settings, Advanced Install certificates Follow onscreen instructions

Checking MAC Address

In Wi-Fi settings,
 · MAC address appears below "MAC address."

Checking IP Address

In Wi-Fi settings,
 · IP address appears below "IP address."

Display Settings

Display Settings

Set brightness, wallpaper, etc. Settable items are the following.

Item	Description
Brightness level	Set brightness of Display.
Adaptive brightness	Enable adjustment of brightness for surroundings based on set "Brightness level."
Wallpaper	Set Wallpaper for Home Screen or Lock Screen.
Sleep	Set a period of inactivity after which Display turns off automatically.
Screen Saver	Set Screen Saver.
Font size	Set size of font for Display.
Display size	Set size of images, icons, etc.
When device is rotated	Set whether to rotate Display with handset orientation automatically.

1

In Home Screen, (Applications List) (Settings)

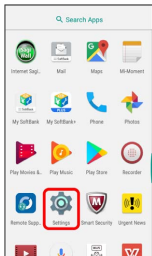

2

Display

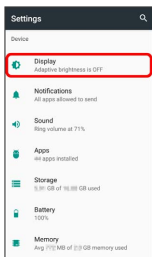

Display settings open.

3

Set items

Settings are made.

Notifications Settings

Notifications Settings

Make settings for notifications. Settable items are the following.

Item	Description
Block all	Set whether to block all notifications.
Show silently	Set whether to notify without sound, vibration or view on screen.
On the lock screen	Set whether to show notifications on Lock Screen.
Override Do Not Disturb	Set whether to show notifications when Silent mode option is set to "Priority only."

1

In Home Screen, (Applications List) (Settings)

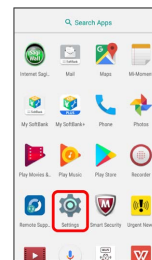

2

Notifications

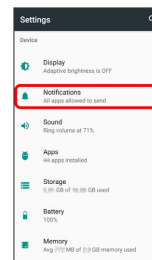

Notifications settings open.

3

Tap application Set each item

Settings are made.

+ Setting Notifications on Lock Screen

In Notifications settings, On the lock screen

Tap item

Sound Settings

Sound Settings

Make settings for Silent mode, ringtone, operation tones, etc. Settable items are the following.

Item	Description
Media volume	Set volume for music, videos, etc.
Alarm volume	Set volume for alarm.
Ring volume	Set volume for ringtone etc.
Also vibrate for calls	Set vibration for ringtone.
Do not disturb	Make advanced settings for Silent mode option "Priority only" in Quick Settings, or set auto-rule for Silent mode.
Phone ringtone	Set Phone ringtone.
Default notification ringtone	Set notification ringtone.
Default alarm ringtone	Set alarm ringtone.
Other sounds	Enable operation tones for dialpad, screen lock, etc.

1
In Home Screen, (Applications List) (Settings)

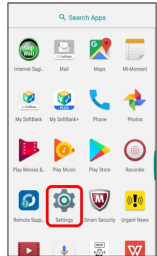

2

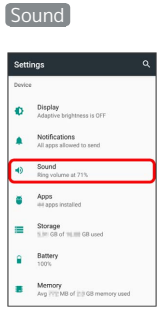

Sound settings open.

3
Set items

Settings are made.

Apps Settings

Apps Settings

Check installed applications and running applications.

1
In Home Screen, (Applications List) (Settings)

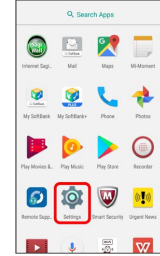

2

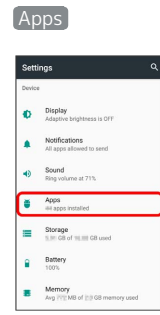

Apps settings open.

3
Tap application

Application information is shown.

+ Apps Operations

Showing System Applications

In Apps settings, **Show system**

- To hide system applications, in Apps settings, **Hide system**

Resetting Apps Setting

In Apps settings, **Reset app references**

RESET APPS

Setting Application

In Apps settings, **Set each item**

- Set App permissions, Opening links, default app for function, etc.

Uninstalling Applications

In Apps settings, Tap application → UNINSTALL → OK

Disabling Applications

In Apps settings, Tap application → DISABLE →

DISABLE APP

Accounts Settings

Accounts Settings

Create/add accounts and make sync settings.

1

In Home Screen, ^ (Applications List) → (Settings)

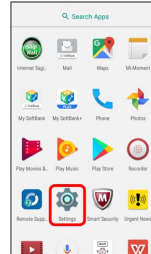

2

Accounts

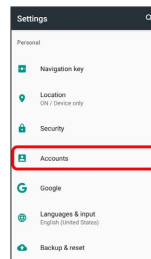

Accounts settings open.

3

Add account → Select account to add → Follow onscreen instructions

Account is added.

+ Setting Applications to Sync for Each Account

In Accounts settings, Tap type of account → Tap account to sync → Tap sync item

· Tap sync item to toggle on (●) / off (○).

About Phone

About Phone

Check handset status. Items that can be checked/set are the following.

Item	Description
My phone name	Check handset name.
Software Update	Make settings for system update.
Status	Check condition of handset.
Legal information	Check copyright information, terms of use, etc.
Model	Check model number.
Android version	Check the Android version.
Android security patch level	Check the security patch level.
Baseband version	Check the baseband version.
Kernel version	Check the kernel version.
Build number	Check the build number.
Hardware version	Check the hardware version.

1

In Home Screen, ^ (Applications List) → (Settings)

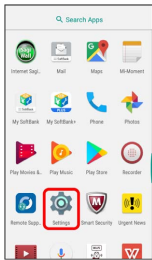

2

About phone

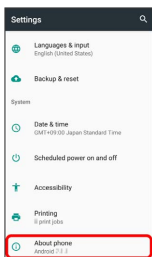

3

Check each item

 Check handset information.

For Assistance

Specifications.....	80
Customer Service.....	80

Specifications

Handset

Item	Description
Dimensions (W x H x D)	Approx. 72 x 144 x 8.7 mm
Weight	Approx. 137 g
Continuous Talk Time	Approx. 610 minutes (3G) Approx. 660 minutes (GSM) Approx. 540 minutes (VoLTE)
Continuous Standby Time	Approx. 520 hours (3G) Approx. 410 hours (GSM) Approx. 370 hours (4G: AXGP) Approx. 350 hours (4G: FDD-LTE)
Charging Time	Approx. 165 minutes
Maximum Output	1.82 W (3G: 2.1 GHz) 1.804 W (3G: 900 MHz) 1.128 W (GSM) 1.536 W (4G: AXGP) 2.26 W (4G: FDD-LTE, 2.1 GHz) 2.324 W (4G: FDD-LTE, 1.7 GHz) 2.288 W (4G: FDD-LTE, 900 MHz)
Communication Speed	SoftBank 4G: Up to 110 Mbps (Down)/Up to 10 Mbps (Up) SoftBank 4G LTE: Up to 112.5 Mbps (Down)/Up to 37.5 Mbps (Up) 3G High speed (HSUPA): Up to 5.76 Mbps 3G High speed (HSDPA): Up to 14 Mbps ULTRA SPEED (HSPA+): Up to 21 Mbps

Battery (ZEBBD1)

Item	Description
Voltage	3.85 V
Type	Lithium-ion
Capacity	2400 mAh

Customer Service

For SoftBank handset or service information, call General Information. For repairs, call Customer Assistance.

SoftBank Customer Support

General Information

From a SoftBank handset, dial toll free at 157
From a landline/IP phone, dial toll free at 0800-919-0157

Customer Assistance (Repairs/Lost Handsets)

From a SoftBank handset, dial toll free at 113
From a landline/IP phone, dial toll free at 0800-919-0113
If you cannot reach a toll free number, use the number (charges apply) below for your service area:
Hokkaido Area, Tohoku Area, Hokuriku Area, Kanto & Koshinetsu Area: 022-380-4380
Kansai Area: 06-7669-0180
Chugoku Area, Shikoku Area, Kyushu & Okinawa Area: 092-687-0010

Smartphone Technical Support Center

For Smartphone Operations

From a SoftBank handset, dial toll free at 151
From a landline/IP phone, dial toll free at 0800-1700-151

SoftBank Global Call Center

From outside Japan, dial +81-92-687-0025 (toll free from SoftBank handsets)

If handset is lost/stolen, call this number immediately (international charges apply)

Safety Precautions



Safety Precautions.....	82
Materials.....	91
Important Product Information.....	91
General Notes.....	94

Safety Precautions

Read safety precautions before using handset.
Observe precautions to avoid injury to self or others, or damage to property.







Safety Precautions

These labels indicate the degree of risk from improper use.

Label	Description
 DANGER	Great risk of death or serious injury ¹ from improper use
 WARNING	Risk of death or serious injury ¹ from improper use
 CAUTION	Risk of minor injury ² or damage to property ³ from improper use

- 1 Serious injury includes: Loss of eyesight, physical injury, physical burns (high-temperature and low-temperature), electric shock, bone fracture, poisoning and other conditions having side effects or requiring hospitalization or long term treatment.
- 2 Minor injury includes: Physical injury, physical burns (high-temperature and low-temperature), electric shock, and other conditions not requiring hospitalization or long-term treatment.
- 3 Damage to property includes: Extended damage to buildings and household property and/or to pets and livestock.

These symbols indicate prohibited/compulsory actions.

Mark	Descriptions
	Prohibited actions
	Disassembly prohibited
	Exposure to liquids prohibited
	Use with wet hands prohibited
	Compulsory actions
	Unplug from outlet

Handset, USIM Card, AC Charger (Sold Separately), Micro USB Cable (Sold Separately), Battery (Optional Accessory)

DANGER



Do not use, store, leave in a high-temperature or in a place where heat accumulates (near fire or heat appliances, under kotatsu or bedding, in direct sunlight, inside a car in the hot sun, etc.)

May cause fire, burns, injury, electric shock, etc.



Do not put in or place nearby a microwave oven, IH cooking heater, or high-pressure container such as pressure cooker.

May cause fire, burns, injury, electric shock, etc.



Do not subject to or place directly on sand, soil or mud. Do not touch with sanded hand.

May cause fire, burns, injury, electric shock, etc.



Do not charge Battery when handset or accessory is wet with water or other liquids (drinking water, sweat, sea water, urine of pet, etc.)

May cause fire, burns, injury, electric shock, etc.



Do not apply strong pressure to or break handset. Do not hit or insert handset in something when carrying it in a pocket.

May cause fire, burns, injury, etc. due to ignition, rupture, heat generation, or damage by fluid leakage of Battery.

* Examples

- Sit or squat while handset is put in a pocket of trousers or skirt
- Get handset caught in a door or door of car while in a pocket of jacket
- Stomp handset on something soft such as sofa, bed, bedding, or on a floor



Do not disassemble or modify.

May cause fire, burns, injury, electric shock, etc.



Do not wet with water or other liquids (drinking water, sweat, sea water, urine of pet, etc.).

May cause fire, burns, injury, electric shock, etc.



Do not put water or other liquids (drinking water, sweat, sea water, urine of pet, etc.) into Earphone Port or External Device Port.

May cause fire, burns, injury, electric shock, etc.



Use optional accessories specified by SoftBank.

Using unspecified accessories may cause fire, burns, injury, electric shock, etc.

WARNING



Do not drop, stomp, throw or subject to strong force, impact, or vibration.

May cause fire, burns, injury, electric shock, etc.



Do not allow conductive object (e.g. metal part, lead of pencil) to contact Earphone Port, or do not allow dust to enter inside of it.

May cause fire, burns, injury, electric shock, etc.



Do not cover or wrap with bedding etc. while using or charging.

May cause fire, burns, etc.



Stop charging if it is not complete even after the specified charging time.

Overcharge may occur resulting in fire, burns, injury, etc.



Power off handset before entering an area where flammable gas may be generated such as a gas station or where dust is generated, and stop charging.

Using in a place where flammable gas etc. is generated may cause explosion, fire, etc.



Take the following actions if abnormal smell, sound, smoke, heat generation, discoloration, distortion, etc. is found while using, charging, or storing.

- Unplug from an outlet.
- Power off handset.
- Remove Battery from handset.

Failure to do the above action may cause fire, burns, injury, electric shock, etc.

⚠ CAUTION

Prohibited

Do not use damaged handset or related accessories.

May cause fire, burns, injury, etc.



Prohibited

Do not place handset on unstable place such as wobbly table or tilted place. Be extra careful while the vibrator is set.

Handset or related accessories may drop resulting in injury etc.



Prohibited

Do not use or store handset or related accessories in a humid, dusty, or extremely hot place.

May cause fire, burns, electric shock, etc.



Prohibited

Do not allow a child to use handset or related accessories in improper manner. Guardians should instruct proper use of them.

Improper use may cause injury etc.



Prohibited

Do not leave within reach of infants.

May cause accidental swallowing, injury, electric shock, etc.



Compulsory

Handset may become hot if used continuously for a long time or while charging. Take care not to touch handset for a long time by accident such as falling asleep.

Handset, Battery or AC Charger may become hot while using applications, call function, data communication, video viewing for a long time, or while charging. Touching hot part for a long time may cause redness, itching or rash of skin, or low-temperature burns, etc. depending on your physical condition.

Handset**⚠ DANGER**

Prohibited

Do not puncture with a nail (or a sharp object), hit with a hammer (or something hard), stomp, or otherwise subject handset to excessive force.

May cause fire, burns, injury, etc.

WARNING



Prohibited

Do not light up or flash Camera Flash close to other people's eyes. Keep a safe distance especially from infants.

May cause impaired eyesight etc. Or may blind or frighten people causing accidents such as injury.



Prohibited

Do not light up or flash Camera Flash toward a driver of car etc.

May hinder driving and cause accidents etc.



Prohibited

Do not look at Display for a long time when it is repeatedly blinking.

May cause spasm, loss of consciousness, etc.



Prohibited

Do not put water or other liquids (drinking water, sweat, sea water, urine of pet, etc.), metal parts, flammable objects into USIM Card Slot or SD Card Slot.

Do not inset USIM Card or SD Card into the wrong slot or orientation.

May cause fire, burns, injury, electric shock, etc.



Prohibited

Do not expose Camera lens to direct sunlight etc. for a long time.

May cause fire, burns, injury, etc. due to light-collecting of lens.



Compulsory

Power off handset or set to Airplane mode before boarding an airplane.

Use of handset on airplane is restricted; follow the instructions given by airline company.

Cancel setting if it includes auto-power-on function.

Radio wave of handset may affect electronic devices of airplane.

Prohibited actions while using handset on an airplane may be punishable by law.



Compulsory

In a hospital, follow the instructions given by the medical facility.

Power off handset in a place where handset use is prohibited.

Cancel setting if it includes auto-power-on function.

Radio wave of handset may affect electronic devices or medical electronic devices.



Compulsory

Always keep handset away from your ear when calling hands-free, sounding ringtone loudly, or in standby mode.

Adjust sound volume adequately when playing games, videos, or music with earphone/microphone etc. connected to handset.

Handset sounds at high volume when calling hands-free. Even in standby mode, sudden ringtone or alarm may sound. Listening to sound at high volume for a long time may cause ear disability such as hardness of hearing.

Sound at high volume hinders hearing surrounding sound and it may cause accidents.



Compulsory

If you have a heart condition, take care with the vibration and ringtone volume.

Sudden vibration or ringtone may frighten you and affect your heart.



Compulsory

If you wear a medical electronic device, check with the manufacturer or vendor on radio wave effects before using handset.

Radio wave of handset may affect medical electronic devices.



Compulsory

Power off handset near electronic devices operating on high precision control or very weak signals.

Radio wave of handset may cause malfunctions of medical electronic devices.

* Take additional care near these devices:

Hearing aids, implanted pacemakers or defibrillators, other medical electronic devices, other automatic control devices. If you are using an implanted pacemaker or defibrillator, or other medical electronic device, check with the manufacturer or vendor on radio wave effects.



Compulsory

If Display or Camera lens is broken, be careful of broken glass or exposed inside of handset.

Touching broken or exposed part may cause burns, injuries, or electric shock, etc.



Compulsory

Do not allow pet etc. to bite handset.

May cause fire, burns, injury, etc. due to ignition, rupture, heat generation, or fluid leakage of Battery.

⚠ CAUTION

Prohibited

If Display is broken, do not allow the leaked internal substance to contact your face or hands, or clothes.

May cause injuries etc. of your eyes or skin.

If internal substance etc. gets into your eyes or mouth, or come in contact with your skin or clothes, rinse with clean water immediately. Also, if it gets into your eyes or mouth, immediately consult a doctor after rinsing.



Prohibited

When removing Battery Cover, do not apply unnecessary force.

Battery Cover may be broken and cause injury etc.



Prohibited

When attaching Battery Cover, do not get a part of your body such as a finger caught.

May cause injury etc.



Prohibited

Do not use handset with Battery Cover removed.

May cause burns, injury, electric shock, etc.



Compulsory

Before using handset in a car, check with the car manufacturer or vendor on effects of radio wave.

Handset radio wave may affect vehicle's electronic devices depending on car type. In that case, immediately stop using handset.



Compulsory

If use of handset develops skin problem, immediately stop using and consult a doctor.

Use of handset may cause itching, rash, eczema, etc. depending on your physical condition.

For material of each part of handset, see "[Materials](#)."



Compulsory

Handset has magnetic parts on Speaker and Earpiece; make sure that no metal strip (e.g. a blade of cutter, staple) is adhered.

Adhered metals may cause injury etc.



Compulsory

Watch Display in a sufficiently bright place at a certain distance.

Watching in a dark place or at a close distance may deteriorate eyesight.

Battery (Optional Accessory)

Check the battery type with label of Battery before using or disposing.

Label	Battery Type
Li-ion 00	Lithium-ion battery

DANGER



Prohibited

Do not allow metal object (e.g. necklace or hair pin), conductive object, etc. to touch metal contacts.

Do not carry or store Battery together with them.

Metal contacts may short-circuit and cause fire, burns, injury, etc.



Prohibited

Do not forcibly attach Battery to handset if not easy to attach. Also, do not remove Battery from handset if not easy to remove.

May cause fire, burns, injury, etc.



Prohibited

Do not throw in fire or apply heat.

May cause fire, burns, injury, etc.



Prohibited

Do not puncture with a nail (or a sharp object), hit with a hammer (or something hard), stomp, or otherwise subject Battery to excessive force.

May cause fire, burns, injury, etc.



Compulsory

Make sure of Battery orientation when attaching to handset.

Attaching with incorrect orientation may cause fire, burns, injury, etc. due to ignition, rupture, heat generation, or fluid leakage of Battery.



Compulsory

If internal substance etc. of Battery gets into your eyes, immediately rinse with clean water without rubbing, and then consult a doctor.

Internal substance of Battery may cause loss of eyesight, affect health, etc.

WARNING

Prohibited

Do not use Battery if abnormal smell, heat generation, discoloration, distortion, etc. is found.

May cause fire, burns, injury, etc.



Compulsory

If internal substance leaks from Battery or abnormal smell is found, immediately stop using and keep away from fire.

Leaked fluid may catch fire and may cause ignition, rupture, etc.



Compulsory

Do not allow pets etc. to bite Battery.

May cause fire, burns, injury, etc. due to ignition, rupture, heat generation, or fluid leakage of Battery.

CAUTION

Prohibited

Do not allow the leaked internal substance etc. of Battery to contact your face or hands, or clothes.

May cause injuries etc. of your eyes or skin.

If internal substance etc. gets into your eyes or mouth, or come in contact with your skin or clothes, rinse with clean water immediately. Also, if it gets into your eyes or mouth, immediately consult a doctor after rinsing.



Prohibited

Do not dispose of Battery with regular trash.

May cause fire, burns, injury, etc. Also, it may cause environmental harm. When Battery is no longer used, tape the metal contacts to insulate, and then bring it into a sales outlet such as a SoftBank shop, or follow the municipality instructions for recycling.



Prohibited

Do not use of charge wet Battery

May cause fire, burns, injury, etc.

AC Charger (Sold Separately), Micro USB Cable (Sold Separately)

WARNING



Prohibited

Do not use AC Charger or Micro USB Cable if the cord is damaged.

May cause fire, burns, electric shock, etc.



Prohibited

Do not use AC Charger or Micro USB Cable in humid place such as a bathroom.

May cause fire, burns, electric shock, etc.



Prohibited

If it thunders, do not touch AC Charger or Micro USB Cable.

May cause electric shock.



Prohibited

Do not short-circuit the charging terminal when AC Charger is plugged into an outlet. Also, do not allow the charging terminal to contact a part of your body such as your hand or finger.

May cause fire, burns, electric shock, etc.



Prohibited

Do not put heavy objects on the cord of AC Charger or Micro USB Cable, or pull the cord strongly.

May cause fire, burns, electric shock, etc.



Prohibited

When plugging or unplugging AC Charger to or from an outlet, do not allow metal objects such as a metal strap to come in contact.

May cause fire, burns, electric shock, etc.



Prohibited

Do not use a travel converter for overseas use when charging with AC Charger.

May cause ignition, heat generation, electric shock.



Prohibited

When AC Charger is connected to handset, do not apply unnecessary force to the connection part.

May cause fire, burns, injury, electric shock, etc.



Do Not Use Wet Hands

Do not touch the cord of AC Charger, Micro USB Cable, charging terminal, or power plug with wet hands.

May cause fire, burns, electric shock, etc.



Compulsory

Use AC Charger at the specified power supply and voltage.

Also, use AC Charger for global use when charging overseas.

Using at improper power supply or voltage may cause fire, burns, electric shock, etc.

AC Charger: 100V AC (Household AC power outlet only)

AC Charger for global use: (Household AC power outlet only)



Compulsory

Wipe off dust on the power plug.

Using with dust adhered may cause fire, burns, electric shock, etc.



Compulsory

Firmly insert the power plug of AC Charger into an outlet.

Failure to do so may cause fire, burns, electric shock, etc.



Compulsory

When unplugging AC Charger from an outlet, grasp the main unit of AC Charger; do not apply force such as pulling the cord.

Pulling the cord of AC Charger may damage the cord and cause fire, burns, electric shock, etc.



Compulsory

Insert or remove the connector of AC Charger straight to or from the port of handset; do not apply force such as pulling the cord.

Improper inserting or removing may cause fire, burns, injury, electric shock, etc.



Compulsory

Stop using AC Charger immediately if the charging terminal is deformed or bent. Do not use it after bending it back.

Using with deformed charging terminal may cause fire, burns, injury, electric shock, etc. due to short-circuit.



Disconnect Power Source

Unplug AC Charger from an outlet when not used.

Leaving the power plug connected may cause fire, burns, electric shock, etc.



Disconnect Power Source

If water or other liquids (drinking water, sweat, sea water, urine of pet, etc.) is on equipment, immediately disconnect the power plug of AC Charger from an outlet.

Failure to do so may cause fire, burns, electric shock due to short-circuit by the liquid.



Disconnect Power Source

When cleaning, disconnect the power plug from an outlet.

Failure to do so may cause fire, burns, electric shock, etc.

⚠ CAUTION

Prohibited

Do not touch AC Charger for a long time when it is plugged into an outlet.

May cause burns, etc.

USIM Card**⚠ CAUTION**

Compulsory

When handling USIM Card, be careful of the notch so as not hurt your fingers or other body parts.

Notch may be sharp and may cause injury etc.

Handset Use & Electronic Medical Equipment**⚠ WARNING**

Compulsory

Persons with an implanted pacemaker or defibrillator should keep handset as least 15 cm away from the device when carrying or using.

Radio wave may adversely affect operation of medical electronic devices.



Compulsory

Before using a medical electronic device other than an implanted pacemaker or implanted defibrillator outside a medical facility (for home treatment etc.), check with the manufacturer on radio wave effects.

Radio wave may adversely affect operation of medical electronic devices.



Compulsory

Disable handset transmissions (e.g. airplane mode) or power off handset in a situation where you are in a crowd etc. and may get close to others at less than 15 cm.

There may be someone who is wearing a medical electronic device such as an implanted pacemaker or defibrillator. Radio wave may affect operations of medical electronic devices.



Compulsory

For using handset in medical facilities, follow the instruction given by each medical facility.

Radio wave may adversely affect operation of medical electronic devices.

Materials

Handset

Parts	Material/Finishing
Exterior case (Display)	PC+20%GF/Matte coating
Battery Cover	PC + PET + Fiberglass/Back side: Silkscreen printing
Earpiece	Metal mesh/PVD high-lighted
Power Key, Volume Up/Down Key	PC/Matte coating
Camera (Lens)	Nano glass/Back side: Silkscreen printing
Camera ring	Stainless steel/PVD electroplating
Touchscreen	Glass/Back side: Silkscreen printing
External Device Port	Stainless steel/Burring
Screw	Structural carbon steel/Nylok process
Speaker mesh	PET
USIM Card Slot	Copper-Nickel-Zinc alloy
Panel of Camera Flash	PMMA
Antenna sticker	PE

Battery (ZEBBD1) (Optional Accessory)

Parts	Material/Finishing
Main unit	PC + ABS
Port	Copper-Gold plating/Nickel plating
Wetting detectable sticker	Water-soluble paper/OPP film
Print label	PET

Important Product Information

General Use

- Handset employs radio waves. Signals may be disrupted even within service areas if you are indoors, underground, inside a tunnel or inside a vehicle. If you move to a location with poor signal strength, a call or video viewing may be suddenly cut off.
 - When using handset in public places, take care not to annoy other people around you. Use of handset is prohibited in some public places such as in theaters or on buses and trains.
 - Handset conforms to the Radio Law and the technical standards based on the Telecommunications Business Act. And as a certification, "Technical Compliance Mark (TM)" is depicted on the label on Battery installation part. If the certification is invalid due to disassembling, modification, etc., never use handset because it violates the Radio Law and the Telecommunications Business Act.
 - Use of handset near a landline phone, TV or radio may affect the image and sound quality of the equipment.
 - Handset employs a digital system to maintain a high level of communication quality even at very low signal levels. However, calls may be suddenly cut off when the signal strength becomes too weak.
 - The digital system provides a high level of privacy protection. However, the possibility of someone eavesdropping on your conversation exists as long as radio waves are used.
 - Data stored on handset may be corrupted or lost in the following instances:
 - Handset is used improperly.
 - Handset is exposed to static electricity or electric noise.
 - Handset is turned off during operation.
 - Battery is completely discharged.
 - Handset malfunctions or is sent for repairs.
 SoftBank Corp. accepts no liability whatsoever for the corruption or loss of stored data. Be sure to keep a separate memo of important data to limit damage caused by data corruption or loss to a minimum.
 - Be sure to charge Battery before using handset for the first time or if handset has not been used for a long time. When Battery is stored for a long time, it discharges over time even if it is not used.
 - When handset is used for extended periods of time, especially in high temperature conditions, handset surface could become hot. Keep handset touching your skin for a long time may cause low-temperature burn.
 - Prolonged use or repeatedly flashing Display or other light may adversely affect the body. If you feel discomfort or pain, immediately discontinue use and consult a doctor.
 - This product and its accessories may be covered by Japan's export control regulations ("Foreign Exchange and Foreign Trade Act" and other related laws and regulations). And, they are also under coverage of the Export Administration Regulations of U.S. When exporting and reexporting this product and its accessories, take necessary procedures on your responsibility and expense.
- For details, contact Ministry of Economy, Trade and Industry of Japan or US Department of Commerce.

- If you use a hearing aid, handset may interfere with operations of some hearing aids. If any interference is found, contact the manufacturer or distributor of the hearing aid.
- Turn off handset in or near places where explosives are handled. Handset use may lead to an explosion, or affect explosion devices.
- Do not forget your security code for unlocking screen if set. If you forget the security code and unlocking screen is no longer possible, take the necessary procedures at the nearest SoftBank shop. In that case, the contents saved or set by user are lost.
- A variety of applications can be installed to handset from "Google Play™" provided by Google Inc. SoftBank Corp. makes no guarantee whatsoever with regard to the nature (quality, reliability, legality, suitability for a purpose, validity of information, accuracy, etc.) of these applications that you yourself have installed, or with regard to any problems (viruses, etc.) resulting from them.

Precautions

- Avoid exposing handset to rain, snow or high humidity. Handset is not waterproof.
- Do not use handset in extreme temperatures, direct sunlight and humid or dusty places.
- Do not drop handset or subject it to excessive shock.
- To clean handset, wipe it with a dry soft cloth. Do not use alcohol, thinner, benzene or other solvents. Doing so may cause discoloration and remove the printed logo.
- When removing Battery Cover, do not touch metal part of USIM Card Slot. Doing so may cause handset to malfunction due to static electricity.
- Battery is not sufficiently charged when you purchased handset. Charge Battery before using handset.
- Do not remove Battery if handset is powered on. May cause malfunction.
- If Battery is removed from handset for a long period of time or left with low-battery level, the contents saved or set by user may be lost or altered. SoftBank Corp. is not liable for any loss arose from the data loss or alteration.
- Battery is a consumable product; it is a lithium-ion-type battery. Available time gradually decreases by charging and discharging repeatedly. When available time is shortened, replace with new one.
- Do not dispose of old Battery after being replaced or removed from handset as regular trash. Tape the terminal of old Battery to insulate or put it into a plastic bag, and then bring it to a SoftBank shop or recycle shop. If your municipality collects old batteries, dispose following the rules.
- When removing Battery, make sure to put your fingernail into the groove of handset and lift the one side of Battery. Forcibly removing may damage the terminals.
- Handset Display pixels may be missing or remain lit. This is not a defect or malfunction. If Display is left on for a long period of time, pictures may be permanently burned into it.
- Make sure a commercially available headset with microphone is securely plugged into Earphone Port. Failing to do so may generate noise on the other party's phone during calls.
- Do not turn the volume up too high while using a commercially available headset with microphone. Exposure to high sound levels may impair hearing and prolonged use may cause hearing damage regardless of the volume level. Sound leakage may annoy other people and surrounding sounds may not be heard clearly when walking, resulting in an accident.
- Grasp plug to remove a commercially available headset with microphone. Pulling cable may cause damage or malfunction.
- When you replace handset or send it for repair, messages and other data stored in handset cannot be transferred to another handset.

Camera Flash

- Do not use Camera Flash in extremely hot/cold places or high humidity. May shorten Camera Flash's usable life.
- Camera Flash use limited to its usable life. Camera Flash will gradually dim with use.

Camera

- Observe proper etiquette when using Camera.
- Do not expose Camera Lens to direct sunlight. Sunlight concentrated through Lens may cause handset to malfunction.
- Practice taking and previewing pictures before using Camera on important occasions like wedding ceremonies.
- Do not commercially use or transfer pictures taken with Camera without the permission of the copyright holder (photographer), except for personal use.
- Do not use Camera in locations where taking photos or recording videos is prohibited.

Urgent News (Application)

- Notification from Urgent News application is enabled by default.
- An alert tone sounds when an alert is received, even in Silent mode.
- Alerts are not received during calls/transmissions or in poor signal conditions.
- Depending on usage/situation, handset may receive alerts for other areas or no alerts.
- Standby Time may decrease when notification setting is enabled.
- SoftBank Corp. cannot be held liable for any damages associated with this service, including accidents resulting from received information, reception timing or reception failure.

Bluetooth®

- Do not use handset in the following places.
 - Near microwave ovens; magnetic field, static electricity, or electromagnetic interference is generated
 - Near devices which use around 2.4 GHz radio wave (radio wave may not reach depending on environment)
- Handset wireless channel uses the same frequency bands as the following equipment or radio stations
 - Industrial, scientific and medical equipment
 - Radio stations for identifying mobile units used in manufacturing lines
 - Premises radio stations (radio stations requiring a license)
- Notes on Using Bluetooth®

To avoid radio wave interference when using Bluetooth, take care as follows.

 1. Before using handset, confirm that premises radio stations or specified lower power radio stations for identifying mobile units are not in use nearby.
 2. In the event of handset causing radio wave interference with a radio station for identifying mobile unit, immediately change the frequency of handset.
 3. Also, in the event of handset causing radio wave interference with specified lower power radio stations for identifying the mobile units, contact [Customer Service](#).
- Frequency Band

This radio equipment uses 2.4 GHz frequency band.

FH: FH-SS modulation
 XX: Other modulation
 8: Maximum interference range of 80 m

2.4FH4/XX8/DS4/OF4

Wi-Fi (Wireless LAN)

- Use of Wi-Fi (Wireless LAN) is restricted in some countries. Before using Wi-Fi overseas, confirm the legal regulation of the country/region where you stay.
- Do not use Wi-Fi near magnetic devices such as electronic appliances, AV/OA devices or in a place where electromagnetic wave is generated. Magnetic/electromagnetic waves may decrease the communication speed or disable communication, or may cause noises (especially when using a microwave oven).
- If there are multiple Wi-Fi access points nearby, handset may not search a target access point correctly.
- Handset uses the same frequency band used by the following equipment or radio station for the wireless channel.
 - Industrial, scientific and medical equipment
 - Radio stations for identifying mobile units used in the manufacturing lines of plants
 - Premises radio stations (radio stations requiring a license)
- Notes on Using Wi-Fi (Wireless LAN)
To avoid radio wave interference when using Wi-Fi, take care as follows.
 1. Before using handset, confirm that premises radio stations or specified lower power radio stations for identifying mobile units are not in use nearby.
 2. In the event of handset causing radio wave interference with a radio station for identifying mobile unit, immediately change the frequency of handset.
 3. Also, in the event of handset causing radio wave interference with specified lower power radio stations for identifying the mobile units or amateur radio stations, contact [Customer Service](#).
- Frequency Band
This radio equipment uses 2.4 GHz frequency band.
 - DS: DS-SS modulation
 - 4: Maximum interference range of 40 m
 - OF: OFDM modulation
 - 4: Maximum interference range of 40 m

2.4FH4/XX8/DS4/OF4

General Notes

Copyrights

- Copyright laws protect sounds, images, computer programs, databases, other materials and copyright holders. Duplicated material is limited to private use only. Use of materials beyond this limit or without permission of copyright holders, such as by copying (including altering data format), modifying, transferring to anyone else, or making available over a network, may constitute copyright infringement, and be subject to criminal punishment. Comply with copyright laws when making copies with handset camera or using images captured with handset camera.

Portrait Rights

- Portrait rights protect individuals' right to refuse to be photographed or to refuse unauthorized publication/use of their photographs. Portrait rights consist of the right to privacy, which is applicable to all persons, and the right to publicity, which protects the interests of celebrities. Therefore, photographing others including celebrities and publicizing/distributing their photographs without permission is illegal; use handset camera responsibly.

Specific Absorption Rate (SAR) for This Product (for Japan)

This mobile phone [Libero 2] meets Japanese technical regulations* and international guidelines for exposure to radio waves.

The Japanese technical regulations for exposure to radio frequency energy established permitted levels of radio frequency energy, based on standards developed by independent scientific organizations through periodic and thorough evaluation of scientific studies.

The regulation employs a unit of measurement known as the Specific Absorption Rate, or SAR.

The SAR limit is 2 watts/kilogram (W/kg) averaged over ten grams of tissue.

The limit includes a substantial safety margin designed to assure the safety of all persons, regardless of age and health.

The value of the limit is equal to the value given in international guidelines recommended by ICNIRP**, which is in collaboration with the World Health Organization (WHO).

The highest SAR value for this mobile phone is 0.667 W/kg* ** when tested for use at the ear, and 1.896 W/kg*** when worn on the body in the below manner****

While there may be differences between the SAR levels of various phones and at various positions, all phones meet the Japanese technical regulations.

Although the SAR is determined at the highest certified power level, the actual SAR of the phone during operation can be well below the maximum value.

Use at positions other than at the ear****

This mobile phone may be used at positions other than at the ear. By using an accessory such as a belt clip holster that maintains a 0.5 cm separation with no metal (parts) between it and the body and the mobile phone, this mobile phone will comply with international guidelines for radio wave protection.

* The technical regulation is provided in Article 14-2 of the Ministry Ordinance Regulating Radio Equipment.

** International Commission on Non-Ionizing Radiation Protection

*** The value is under simultaneous transmission use conditions.

The World Health Organization has announced that "A large number of studies have been performed over the last two decades to assess whether mobile phones pose a potential health risk. To date, no adverse health effects have been established as being caused by mobile phone use."

For more information about SAR, see the following websites:

- Ministry of Internal Affairs and Communications (MIC)
<http://www.tele.soumu.go.jp/e/sys/ele/body/index.htm>
- Association of Radio Industries and Businesses (ARIB)
<http://www.arib-emf.org/01denpa/denpa02-02.html>
(Japanese)

This mobile phone [Libero 2] is confirmed to comply with guidelines relating to effects of radio wave exposure as

set forth by the Federal Communications Commission (FCC). Refer to the following.

FCC RF Exposure Information

Your handset is a radio transmitter and receiver. It is designed and manufactured not to exceed the emission limits for exposure to radio frequency (RF) energy set by the Federal Communications Commission of the U.S. Government.

The guidelines are based on standards that were developed by independent scientific organization through periodic and thorough evaluation of scientific studies. The standards include a substantial safety margin designed to assure the safety of all persons, regardless of age and health.

The exposure standard for wireless handsets employs a unit of measurement known as the Specific Absorption Rate, or SAR. The SAR limit set by the FCC is 1.6 W/kg. The tests are performed in positions and locations (e.g. at the ear and worn on the body) as required by the FCC for each model.

The highest SAR value for this model handset as reported to the FCC when tested for use at the ear is 0.416 W/kg, and when worn on the body in a holder or carry case, is 0.852 W/kg. Body-worn Operation; This device was tested for typical body-worn operations with the handset kept 1.0 cm from the body. To maintain compliance with FCC RF exposure requirements, use accessories that maintain a 1.0 cm separation distance between the user's body and the handset. The use of beltclips, holsters and similar accessories should not contain metallic components in its assembly.

The use of accessories that do not satisfy these requirements may not comply with FCC RF exposure requirements, and should be avoided. The FCC has granted an Equipment Authorization for this model handset with all reported SAR levels evaluated as in compliance with the FCC RF emission guidelines. SAR information on this model handset is on file with the FCC and can be found under the Display Grant section of <http://www.fcc.gov/oet/ea/> after searching on FCC ID :SRQ-602ZT.

Additional information on Specific Absorption Rates (SAR) can be found on the FCC website at

<https://www.fcc.gov/general/radio-frequency-safety-0>

The World Health Organization has stated that present scientific information does not indicate the need for any special precautions for the use of mobile devices. They note that if you want to reduce your exposure then you can do so by limiting the length of calls or using a hands-free device to keep the mobile phone away from the head and body.

World Health Organization

<http://www.who.int/emf>

List of Specific Absorption Rates (SAR) for radio waves by smartphone/3G model

<https://www.softbank.jp/mobile/support/sar/> (Japanese)

[FCC Compliance]

This device complies with Part 15 of the FCC Rules.

Operation is subject to the following two conditions: (1) this device may not cause harmful interference, and (2) this device must accept any interference received, including interference that may cause undesired operation.

Note: This equipment has been tested and found to comply with the limits for a Class B digital device, pursuant to part 15 of the FCC Rules. These limits are designed to provide reasonable protection against harmful interference in a residential installation. This equipment generates, uses and can radiate radio frequency energy and, if not installed and used in accordance with the instructions, may cause harmful

interference to radio communications. However, there is no guarantee that interference will not occur in a particular installation. If this equipment does cause harmful interference to radio or television reception, which can be determined by turning the equipment off and on, the user is encouraged to try to correct the interference by one or more of the following measures:

- Reorient or relocate the receiving antenna.
- Increase the separation between the equipment and receiver.
- Connect the equipment into an outlet on a circuit different from that to which the receiver is connected.
- Consult the dealer or an experienced radio/TV technician for help.

Libero 2 User Guide Index

A	
About Phone.....	77
About the User Guide.....	3
Accessing Instructions on Handset.....	3
Accounts Settings.....	76
Airplane Mode.....	20
Applications.....	18
Apps Settings.....	75
B	
Basic Operation.....	16
Battery.....	7
C	
Capturing Still Images/Videos.....	52
Charging Battery.....	12
Confirmation when First Launching Applications.....	17
Connecting by Wi-Fi.....	62
Customer Service.....	80
D	
Display Settings.....	74
G	
General Notes.....	94
Google Play.....	24
H	
Handset Settings.....	72
Home Screen Basics.....	32
I	
Important Product Information.....	91
Internal Memory and SD Card.....	9
L	
Listening to Music (Play Music).....	58
Locking Screen.....	28
M	
Making Calls while Abroad.....	68
Materials.....	91
Messaging.....	44

N

Notifications Settings.....74

O

Opening & Replying to S! Mail/SMS.....46

Optional Services.....38

P

Parts & Functions.....6

Phone Number.....19

Photos.....54

Placing/Answering Calls.....36

Play Music.....58

Power On/Off.....13

S

Safety Precautions.....82

Security Codes/Operation Password.....26

Sending S! Mail/SMS.....44

Silent Mode.....19

SIM PIN.....27

Sound Settings.....75

Specifications.....80

Status Bar.....32

T

Text Entry.....21

U

Updating Software.....28

USIM Card.....8

Using a Google Account.....22

Using Bluetooth® Function.....63

Using Chrome.....49

Using Contacts.....40

Using Gmail.....47

Using Notifications Window/Quick Settings.....33

Using Touchscreen.....13

V

Viewing Captured Still Images/Videos (Photos).....54

W

Wi-Fi Settings.....73

Libero 2 User Guide

November 2017, First Edition
SoftBank Corp.

Visit [SoftBank Shop](#) for assistance

Model : Libero 2
Manufacturer : ZTE Corporation